

NO. OF COPIES RECEIVED	
DISTRIBUTION	
SANTA FE	
FILE	
U.S.G.S.	
LAND OFFICE	
OPERATOR	

NEW MEXICO OIL CONSERVATION COMMISSION

**RECEIVED**

APR 22 1975

Form C-101  
Revised 1-1-65

5A. Indicate Type of Lease STATE <input checked="" type="checkbox"/> FEE <input type="checkbox"/>
5. State Oil & Gas Lease No. L-3358
7. Unit Agreement Name
8. Farm or Lease Name Nash Unit
9. Well No. 2
10. Field and Pool, or Wildcat Undesignated
12. County Eddy

APPLICATION FOR PERMIT TO DRILL, DEEPEN, OR PLUG BACK

1a. Type of Work b. Type of Well OIL WELL <input type="checkbox"/> GAS WELL <input checked="" type="checkbox"/> OTHER <input type="checkbox"/> DEEPEN <input type="checkbox"/> PLUG BACK <input type="checkbox"/> SINGLE ZONE <input type="checkbox"/> MULTIPLE ZONE <input checked="" type="checkbox"/>	
2. Name of Operator Mesa Petroleum Co. ✓	
3. Address of Operator 904 Gihls Tower West, Midland, Texas 79701	
4. Location of Well UNIT LETTER <u>E</u> LOCATED <u>1350</u> FEET FROM THE <u>North</u> LINE AND <u>1300</u> FEET FROM THE <u>West</u> LINE OF SEC. <u>18</u> TWP. <u>23S</u> RGE. <u>30E</u> NMPM	
21. Elevations (Show whether DF, RI, etc.) 3022 GR	21A. Kind & Status Plug. Bond Blanket
21B. Drilling Contractor McVay	
22. Approx. Date Work will start July 1, 1975	

PROPOSED CASING AND CEMENT PROGRAM

SIZE OF HOLE	SIZE OF CASING	WEIGHT PER FOOT	SETTING DEPTH	SACKS OF CEMENT	EST. TOP
17 1/2	13 3/8	48	300	350	Circ. to surf.
12 1/4	9 5/8	36	3400	1000	Circ. to surf.
8 3/4	7	23-26	11,100	250	9500
6	4 1/2	13.5	14,000	325	Top of liner

Surface hole will be drilled to 300' without BOP's. Below the surface casing, 12" API 3000 psi BOP's will be used to casing shoe depth at 3400'. Salt brine will be used to drill this portion of the hole to prevent unnecessary hole enlargement. After the 9 5/8" casing is set, 10" API 5000 psi BOP's will be used to total depth. Controlled polymer brine mud will be used to drill to total depth. Maximum mud weight required to overbalance formation pressure is anticipated to be 12.2 PPG at approximately 12,100', based on experience gained while drilling the immediate offset well (Nash Unit # 1) - located in Section 13, T23S, R29E). BOP's will be thoroughly tested before penetrating this abnormally pressured section, also 7" casing will have been set at approximately 11,100'.

IN ABOVE SPACE DESCRIBE PROPOSED PROGRAM: IF PROPOSAL IS TO DEEPEN OR PLUG BACK, GIVE DATA ON PRESENT PRODUCTIVE ZONE AND PROPOSED NEW PRODUCTIVE ZONE. GIVE BLOWOUT PREVENTER PROGRAM, IF ANY.

I hereby certify that the information above is true and complete to the best of my knowledge and belief.

Signed Michael P. Houston Title Division Engineer Date April 18, 1975

(This space for State Use) XC: 10 NMOC, 1-mec, 1-RHN, 1-Lmc, 1-JLF, 1-m+m, 1-D+M  
10 - Partners, 2 Potash Lessers, 1-mph

APPROVED BY \_\_\_\_\_ TITLE \_\_\_\_\_ DATE \_\_\_\_\_

CONDITIONS OF APPROVAL, IF ANY:

**MEXICO OIL CONSERVATION COMMISSION**  
**WELL LOCATION AND ACREAGE DEDICATION PLAT**

Form C-102  
 Supersedes C-128  
 Effective 1-1-65

All distances must be from the outer boundaries of the Section

<b>Mesa Petroleum Company</b>			<b>Lease Nash Unit</b>		<b>Well No. 2</b>
<b>E</b>	<b>Section 18</b>	<b> Township 23 South</b>	<b>Range 30 East</b>	<b>County Eddy</b>	
Location of Well: <b>1350</b> feet from the <b>North</b> line and <b>1300</b> feet from the <b>West</b> line					
<b>3022.1</b>	<b>Producing Formation Morrow</b>	<b>Pool Undesignated</b>		<b>Dedicated Acreage: 640</b>	<b>Sec. 18 Acres</b>

Outline the acreage dedicated to the subject well by colored pencil or hatchure marks on the plat below.

2 If more than one lease is dedicated to the well, outline each and identify the ownership thereof (both as to working interest and royalty).

3 If more than one lease of different ownership is dedicated to the well, have the interests of all owners been consolidated by communitization, unitization, force-pooling, etc?

X Yes ☐ No If answer is "yes," type of consolidation Unitization (Nash Unit)

If answer is "no," list the owners and tract descriptions which have actually been consolidated. (Use reverse side of this form if necessary.)

No allowable will be assigned to the well until all interests have been consolidated (by communitization, unitization, forced-pooling, or otherwise) or until a non-standard unit, eliminating such interests, has been approved by the Commission.

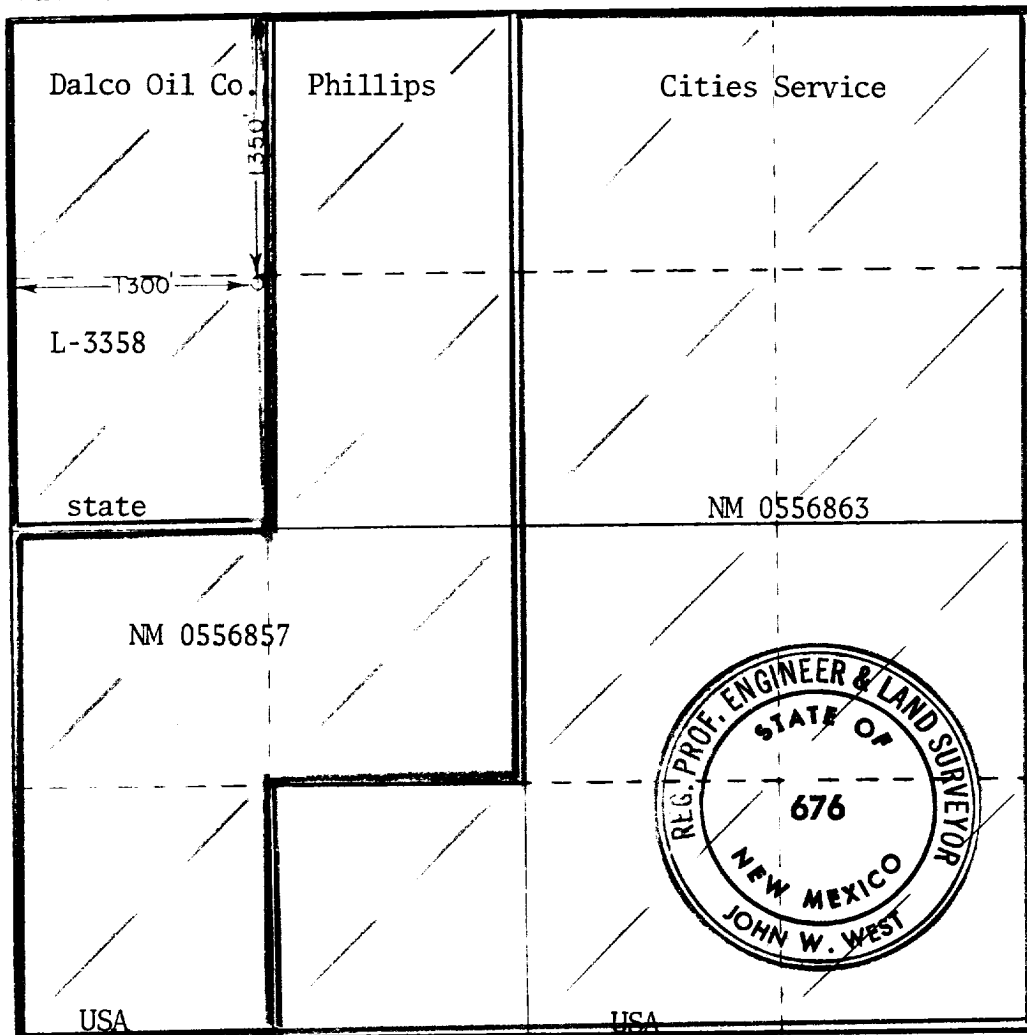

**CERTIFICATION**

I hereby certify that the information contained herein is true and complete to the best of my knowledge and belief.

*Michael P. Houston*

<b>Name</b>	<b>Michael P. Houston</b>
<b>Position</b>	<b>Division Engineer</b>
<b>Company</b>	<b>Mesa Petroleum Co.</b>
<b>Date</b>	<b>April 18, 1975</b>

I hereby certify that the well location shown on this plat was plotted from field notes of actual surveys made by me or under my supervision, and that the same is true and correct to the best of my knowledge and belief.

<b>Date Surveyed</b>	<b>April 15, 1975</b>
<b>Registered Professional Engineer and/or Land Surveyor</b>	

*John W. West*

**Certificate No. 676**

