

N. M. O. C. C. COPY
UNITED STATES
DEPARTMENT OF THE INTERIOR
GEOLOGICAL SURVEYSUBMIT IN TRIPLICATE*
(Other instructions on
reverse side)Form approved. *Copy to SF*
Budget Bureau No. 42-R425.

30-015-21765

APPLICATION FOR PERMIT TO DRILL, DEEPEN, OR PLUG BACK

1a. TYPE OF WORK DRILL <input checked="" type="checkbox"/> DEEPEN <input type="checkbox"/> PLUG BACK <input type="checkbox"/>		5. LEASE DESIGNATION AND SERIAL NO. NM-0415688-A	
b. TYPE OF WELL OIL WELL <input checked="" type="checkbox"/> GAS WELL <input type="checkbox"/> OTHER <input type="checkbox"/>		6. IF INDIAN, ALLOTTEE OR TRIBE NAME "	
2. NAME OF OPERATOR AMOCO PRODUCTION COMPANY		7. UNIT AGREEMENT NAME OLD INDIAN DRAW UNIT FEDERAL	
3. ADDRESS OF OPERATOR BOX 367, ANDREWS, TEXAS 79714		8. FARM OR LEASE NAME "	
4. LOCATION OF WELL (Report location clearly and in accordance with any State requirements.)* At surface 2323 FNL x 1974 FWL Sec 18 (UNIT F, SE 1/4 NW 1/4) At proposed prod. zone		9. WELL NO. 7	
14. DISTANCE IN MILES AND DIRECTION FROM NEAREST TOWN OR POST OFFICE*		10. FIELD AND POOL, OR WILDCAT INDIAN DRAW- DEL	
16. DISTANCE FROM PROPOSED* LOCATION TO NEAREST PROPERTY OR LEASE LINE, FT. (Also to nearest drilg. unit line, if any)		11. SEC. T., R., M., OR BLK. AND SURVEY OR AREA 18-22-28 NMPM	
18. DISTANCE FROM PROPOSED LOCATION* TO NEAREST WELL, DRILLING, COMPLETED, OR APPLIED FOR, ON THIS LEASE, FT.		12. COUNTY OR PARISH EDDY	
21. ELEVATIONS (Show whether DF, RT, GR, etc.) 3077.1 GL		13. STATE N.M.	
17. NO. OF ACRES IN LEASE		19. PROPOSED DEPTH 3450'	
20. ROTARY OR CABLE TOOLS ROTARY		22. APPROX. DATE WORK WILL START* UPON NID APPROVAL	

PROPOSED CASING AND CEMENTING PROGRAM

SIZE OF HOLE	SIZE OF CASING	WEIGHT PER FOOT	SETTING DEPTH	QUANTITY OF CEMENT
12 1/4"	8 5/8"	24#	400'	Circulate
7 1/8"	5 1/2"	14-15.5#	3450'	Sufficient to tie back into surface pipe.

after drilling, logs shall be run & evaluations made,
perforating and/or stimulating as necessary in
attempting commercial production.

MUD PROGRAM: O-SCP: Water & native mud.
SCP-TD: Beane &

BOP PROGRAM: Attached

MAR 30 1976

O. C. C.
ARTESIA OFFICE

IN ABOVE SPACE DESCRIBE PROPOSED PROGRAM: If proposal is to deepen or plug back, give data on present productive zone and proposed new productive zone. If proposal is to drill or deepen directionally, give pertinent data on subsurface locations and measured and true vertical depths. Give blowout preventer program, if any.

24.

SIGNED

Roy R. Gaskum

TITLE ADMINISTRATIVE ASSISTANT

DATE

FEB 25 1976

(This space for Federal or State office use)

PERMIT NO.

APPROVAL DATE

MAR 22 1976

DISTRICT ENGINEER

TITLE

DATE

APPROVED BY

CONDITIONS OF APPROVAL, IF ANY:

0+4-USGS-ART
1-DIV
1-SUSP
1-RRY
2-BASS
1-MARATHON

*See Instructions On Reverse Side

NEW MEXICO OIL CONSERVATION COMMISSION
WELL LOCATION AND ACREAGE DEDICATION FORM

Form C-102
 Supersedes C-128
 Effective 1-1-65

All distances must be from the outer boundaries of the Section

Operator Amoco Production Company			Lease Old Indian Draw Unit		Well No. 7
Unit Letter F	Section 18	Township 22 South	Range 28 East	County Eddy	

Actual Well Location of Well:

1974	feet from the West	line and	2323	feet from the North	line
Ground Level Elev. 3077.1	Producing Formation DELAWARE		Pool INDIAN DRAW- DELAWARE	Estimated Acreage 40	

1. Outline the acreage dedicated to the subject well by colored pencil or hatchure marks on the plat below.
2. If more than one lease is dedicated to the well, outline each and identify the ownership thereof (both as to working interest and royalty).
3. If more than one lease of different ownership is dedicated to the well, have the interests of all owners been consolidated by communitization, unitization, force-pooling, etc?

☐ Yes ☐ No If answer is "yes," type of consolidation _____

If answer is "no," list the owners and tract descriptions which have actually been consolidated. (Use reverse side of this form if necessary.) _____

No allowable will be assigned to the well until all interests have been consolidated (by communitization, unitization, forced-pooling, or otherwise) or until a non-standard unit, eliminating such interests, has been approved by the Commission.

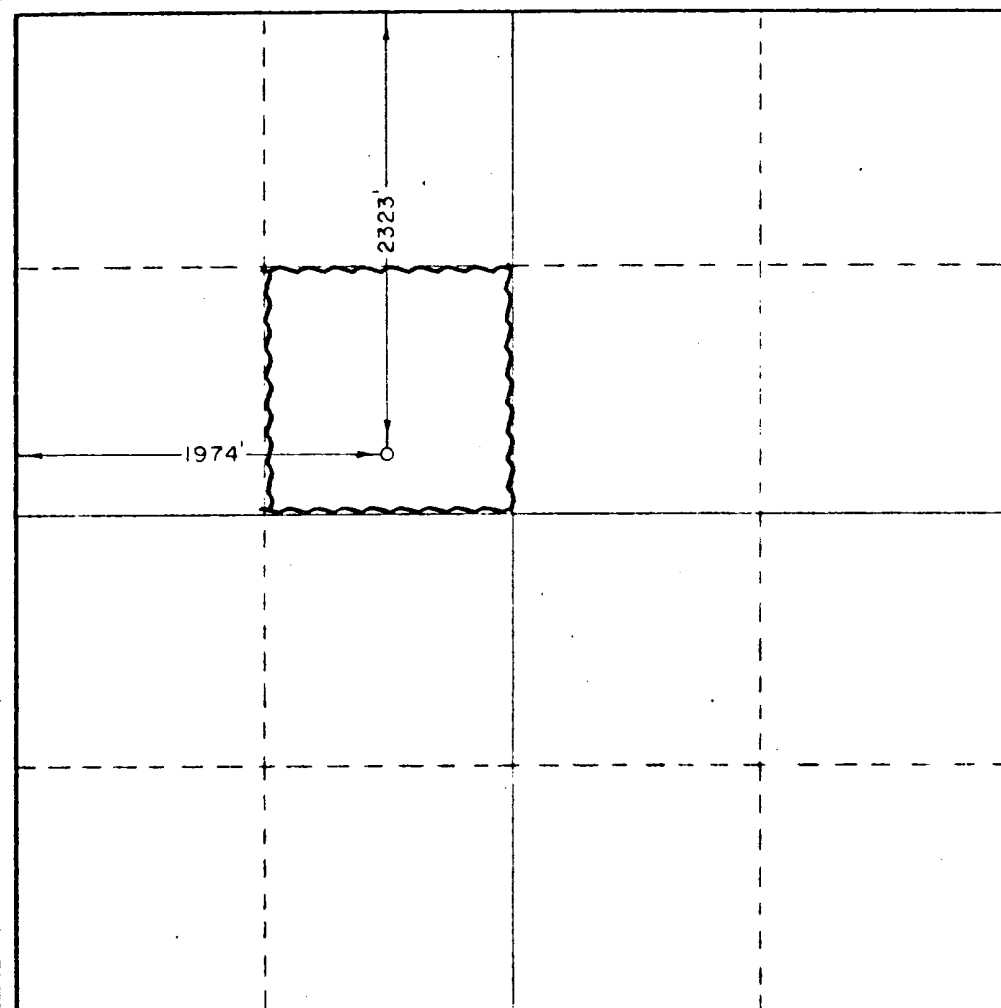

CERTIFICATION

I hereby certify that the information contained herein is true and complete to the best of my knowledge and belief.

Ray R. Yorkum
 Position _____

ADMINISTRATIVE ASSISTANT,

Company

AMOCO PRODUCTION COMPANY

Date

FEB 25 1976

I hereby certify that the well location shown on this plat was plotted from field notes of actual surveys made by me or under my supervision, and that the same is true and correct to the best of my knowledge and belief.

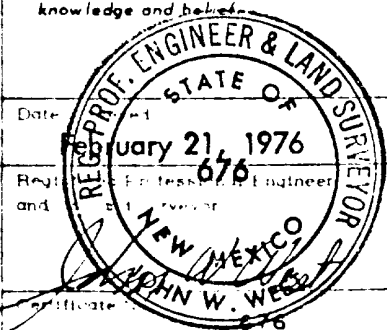

55

9936.95
14929.78

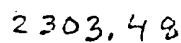

OLD INDIAN DRAW UNIT FED LSE (Part M)
SEC 18 & 19 T-22S R-28 E, EDDY CO N.M.

R-28-E

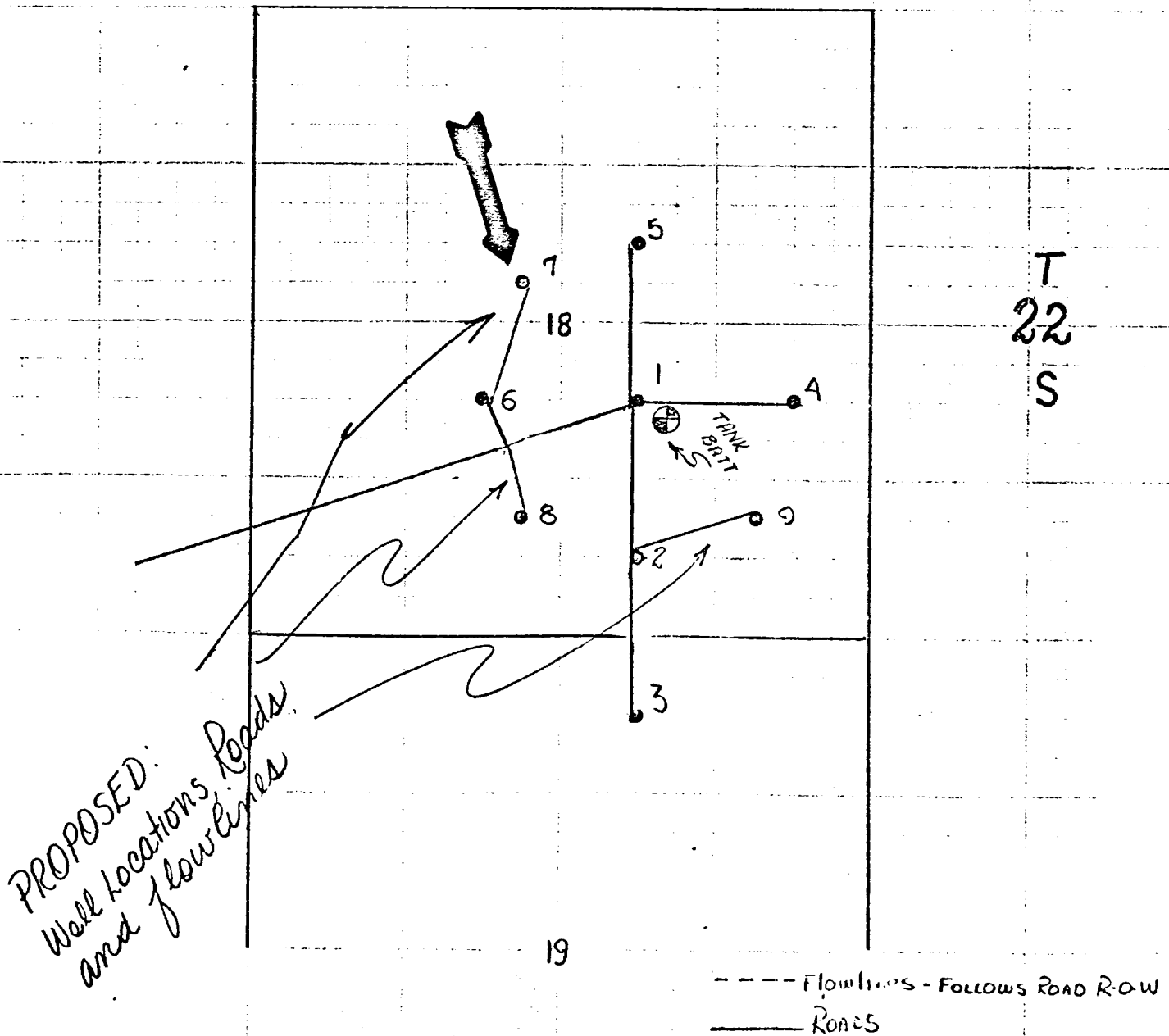

LOCATION DIMENSIONS

TRASH PIT
8'x20'x6'

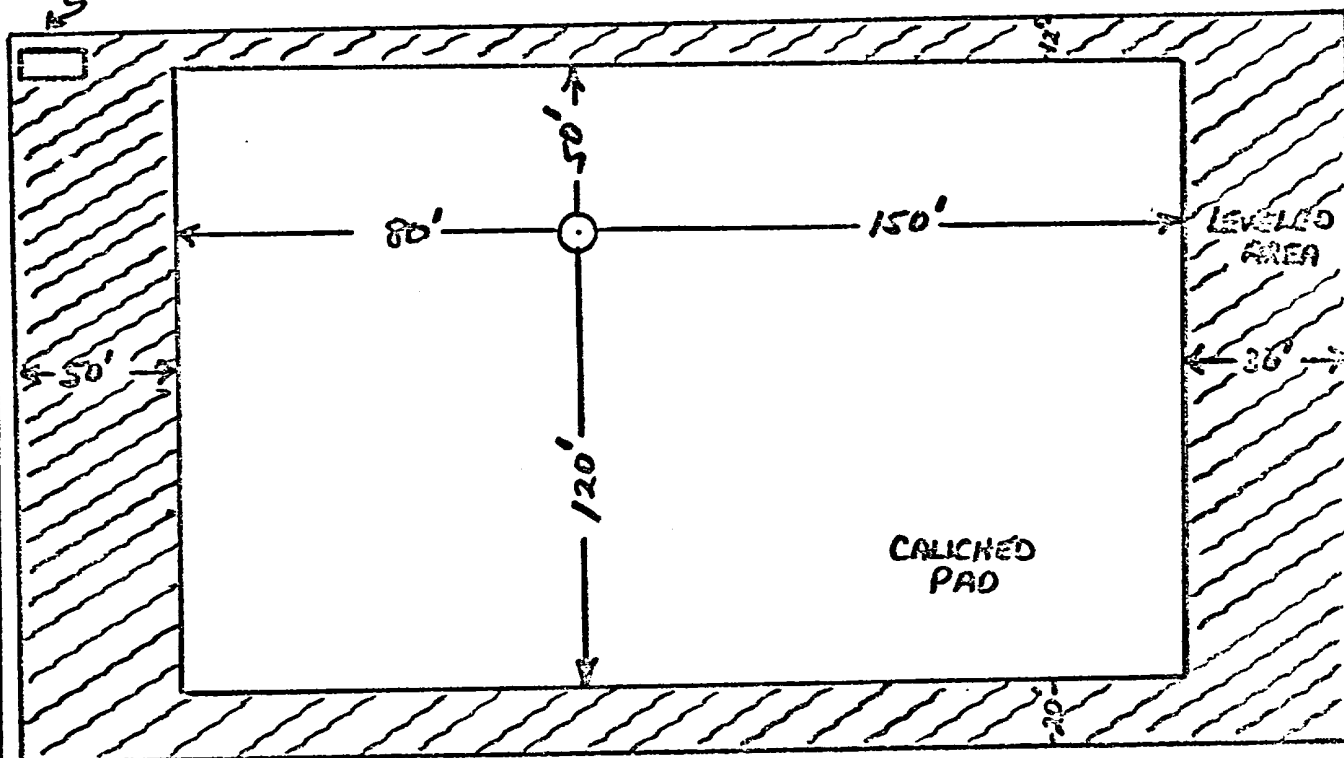

CELLAR SIZE
5'x5'x4'

Amoco Production Company

OLD INDIAN DRAW UNIT FEDERAL, WELL No. 7
F-18-22-28 NMPM, EDDY Co. N.M.

SCALE: *None*

DRG.
NO.

8' x 27'

WATER
TANK
12' x 23'

SUCTION PIT
8' x 8'

MUD
PUMP

LIGHT
PLANT

RESERVE
PIT

WORKING PIT
60'

SUBSTRUCTURE
10' x 34' ⊗-HOLE

DOG HOUSE

ROD
CLOSING
UNIT
25' TO HOLE

PIPE RACKS 54'

CATWALK + V-DOOR 63'

PIPE & CASING RACK 63'

DERICK
STRAND

26'

35'

Amoco Production Company

SCALE:

GENERAL RIG LAYOUT
OLD INDIAN DRAW UNIT FED #7
F-18-22-28, EDDY Co. N.M.

DRG.
NO.

ATTACHMENT TO FORM 9-331C

APPLICATION FOR PERMIT TO DRILL

LEASE OLD INDIAN DRAW UNIT FED WELL NO. 7

LOCATION UNIT F SEC 18, T-22-S, R-28-E

POOL INDIAN DRAW-DELAWARE

COUNTY EDDY

The undersigned hereby states that Amoco's representative, Mr. D.C. PEURIFOR JR., personally contacted L.J. CALLEY, CARLSBAD, NM the ~~owner~~/lessee of the surface land where the proposed work is to be conducted and advised him of the proposed work, the construction site and pertinent roads included in the project. It is further stated that, upon being fully advised of the extent of the work and the effect upon the surface, said owner has consented to the said work and that agreement as to the compensation for damages to the surface estate has been reached.

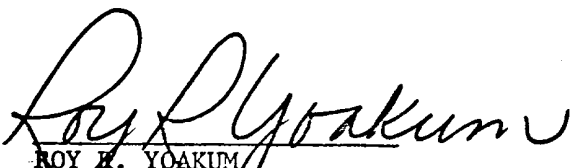
ROY R. YOAKUM
Administrative Assistant

2-25-76
DATE

UNITED STATES
DEPARTMENT OF THE INTERIOR
GEOLOGICAL SURVEY

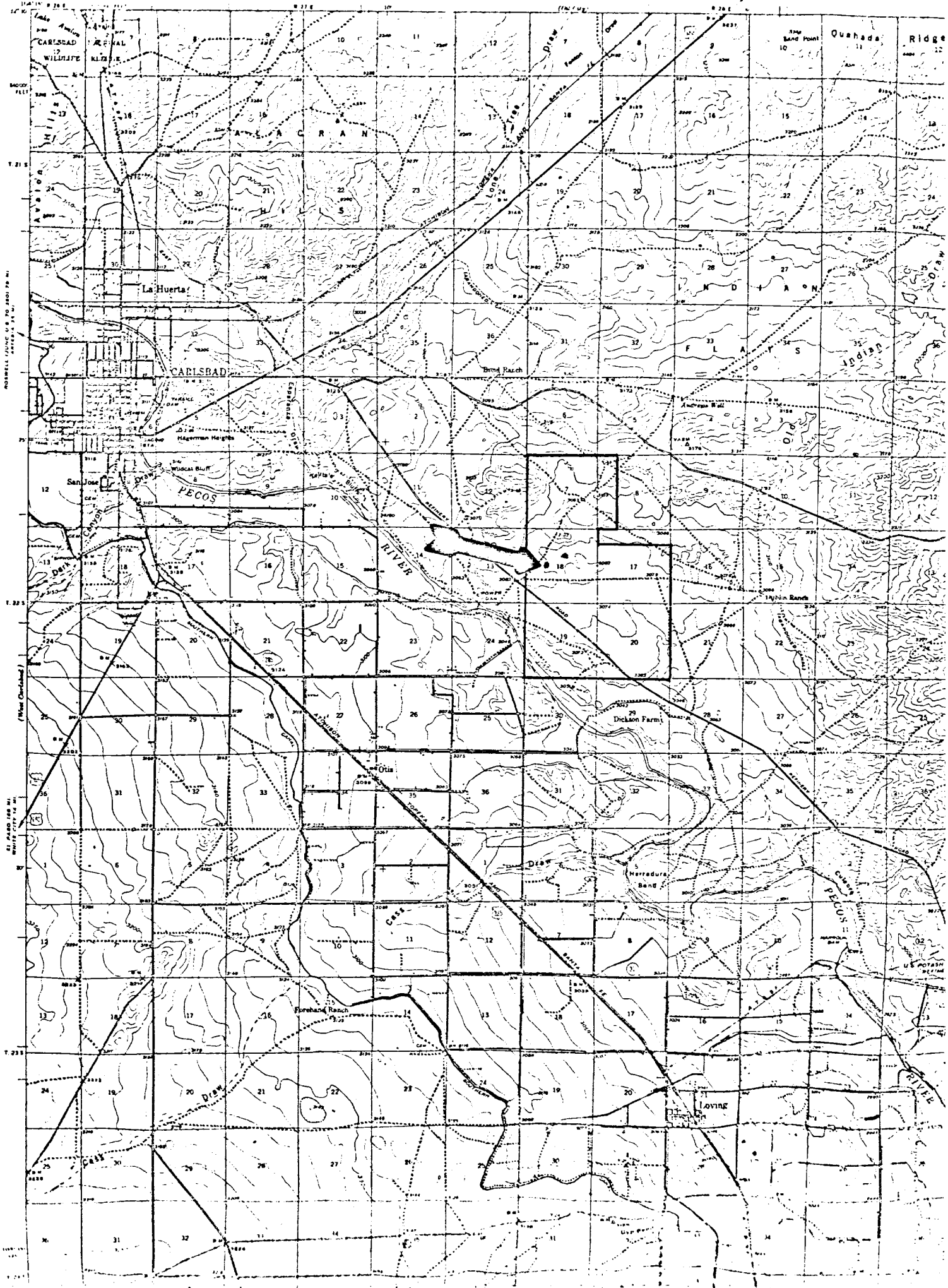

OLD INDIAN DRAW UNIT FED WELL #7
INDIAN DRAW-DELAWARE POOL
ETDV ON N.M.

LEASE & WELL NUMBER OLD INDIAN DRAW UNIT FED #7
LOCATION F-18-22-28 NMPM, EDDY Co. NM

PROPOSED DEVELOPMENT PLAN FOR SURFACE USE.

1. Existing roads including location of exit from main highway.
(SEE ATTACHED MAP) TO CONSTRUCT APPX 1320' COMPACTED CALICHE ROAD. 12' W X 6" THICK. W X C Caliche.
2. Planned access roads. ROAD TO BE FROM WELL #6 TO WELL No. 7
(SEE ATTACHED MAP)
3. Location of existing wells
(SEE ATTACHED MAP)
4. Lateral roads to well locations
(SEE ATTACHED MAP)
5. Location of Tank Batteries & Flow Lines.
(SEE ATTACHED MAP)
6. Location and type of water supply.
Fresh & Pure Water to be hauled
_____ Piped from _____
7. Methods for handling waste disposal
All waste material will be pitted, burned, buried or hauled from location. Suitable trash pits or containers will be provided at location for containment.
8. & 9. Location of camps and airstrips.
X None _____ SEE ATTACHED MAP
10. Location of layout to include position of rig, mud pits, reserve pits, burn pits, pipe racks, etc.
Rig Layout, etc. (SEE ATTACHED)
Drilling Pad 230' X 170' X 6" Compacted _____ Surfaced
11. Plans for restoration of Surface
X Producing well - all pits to be cut, filled and levelled.
X Dry hole - all pits to be cut, filled and complete location cleaned and levelled.
12. Other information that may be used in evaluating the impact on environment.
TERRAIN - FLAT.

Field personnel responsible for compliance of Development Plan for Surface Use.

O. R. WILLIAMS, AREA FOREMAN, BOX 68, HOBBS, NM (PR 393-2167)

ATTACHMENT D
NOTES

1. Blow-out preventers and master valve to be fluid operated and all fittings must be in good condition, 3,000# W.P. (6,000 p.s.i. test), minimum.
2. Equipment through which bit must pass shall be as large as the inside diameter of the casing that is being drilled through.
3. Nipple above blow-out preventer shall be same size as casing being drilled through.
4. Kelly cock required, 3,000# W.P. (6,000 p.s.i. test), minimum.
5. OMSCO or comparable safety valve must be available on rig floor at all times with proper connection or sub, 3,000# W.P. (6,000 p.s.i. test), minimum.
6. Blow-out preventers and master valve while drilling intermediate hole to 6,000' may be 2,000# W.P. (4,000 p.s.i. test), minimum.
7. Choke assembly, beyond second valve from cross, may be positioned (Optional) outside of derrick foundation.
8. Spool or cross may be eliminated if connections are available in the lower part of the blow-out preventer body.
9. Plug valves - gate valves are optional. Valves shown as 2" are minimum size.
10. Casing head and casing head spool, including attached valves, to be furnished by Pan American.
11. Rams in preventers will be installed as follows:

When drilling, use:

Top Preventer - Drill pipe rams
Bottom Preventer - Blind rams or master valve

When running casing, use:

Top Preventer - Casing rams
Bottom Preventer - Blind rams or master valve.

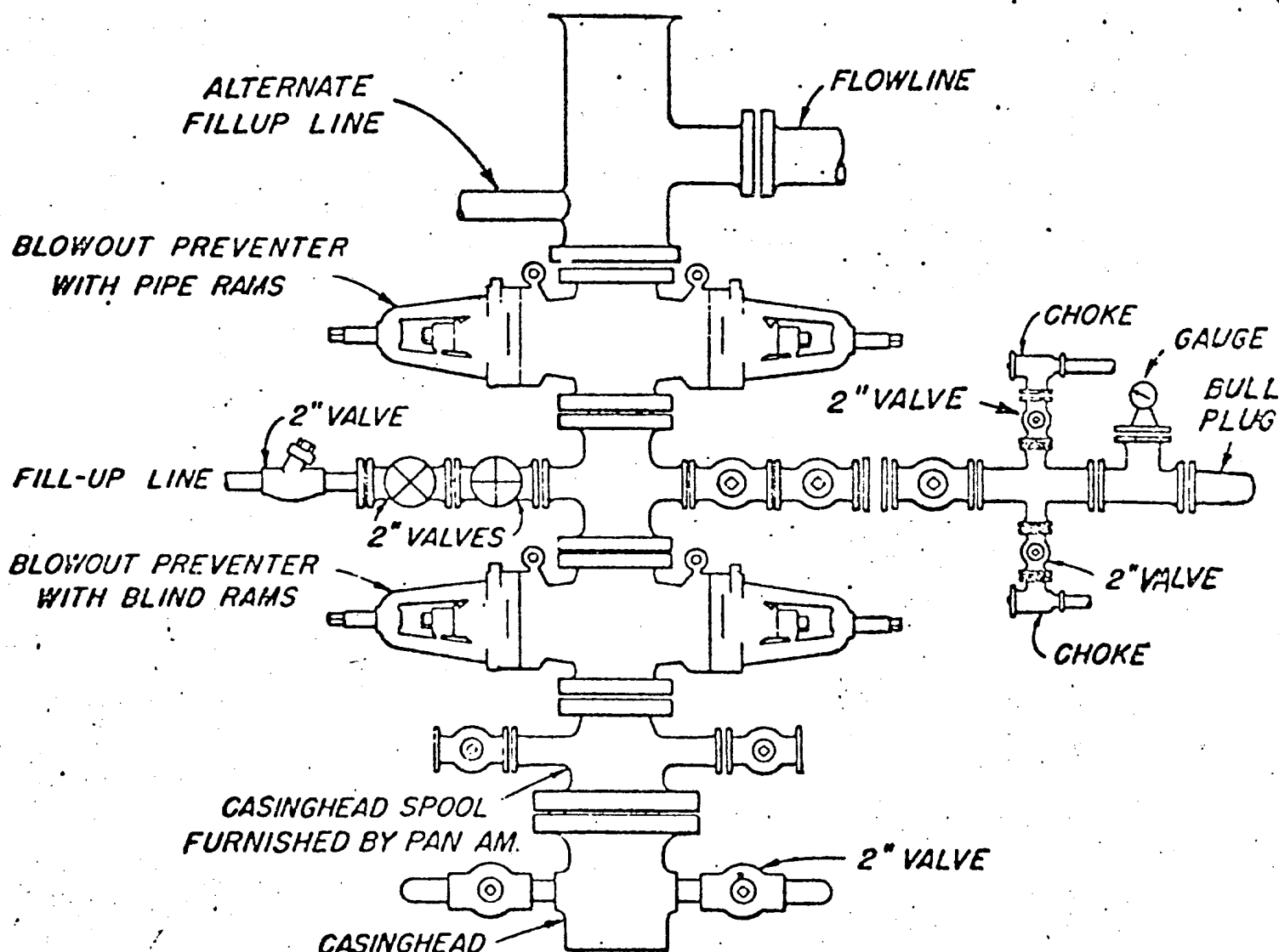

**BLOWOUT PREVENTER HOOK-UP
PAN AMERICAN PETROLEUM CORP.**

EXHIBIT D-1 MODIFIED

JUNE 1, 1962