

Exhibit B
WELL LOCATION AND ACREAGE SURVEY
Surface Use and Operations Plan

All distances must be from the outer boundaries of the Section.

RECEIVED
JUL 13 1976
U.S. GEOLOGICAL SURVEY
ARTESIA, NEW MEXICO

Operator THE EASTLAND OIL CO.			Lease Union-Federal		
Unit Letter L	Section 11	Township 22 South	Range 27 East	County Eddy	
Action: Footage Location of Well: <div style="display: flex; justify-content: space-between;"> 1980 feet from the south line and 660 feet from the west line </div>					
Ground Level Elev. 3101.8	Producing Formation Delaware	Pool Esperanza	Dedicated Acreage: 40 Acres		

1. Outline the acreage dedicated to the subject well by colored pencil or hachure marks on the plat below.
2. If more than one lease is dedicated to the well, outline each and identify the ownership thereof (both as to working interest and royalty).
3. If more than one lease of different ownership is dedicated to the well, have the interests of all owners been consolidated by communitization, unitization, force-pooling, etc?

☐ Yes ☒ No If answer is "yes," type of consolidation _____

If answer is "no," list the owners and tract descriptions which have actually been consolidated. (Use reverse side of this form if necessary.) _____

No allowable will be assigned to the well until all interests have been consolidated (by communitization, unitization, forced-pooling, or otherwise) or until a non-standard unit, eliminating such interests, has been approved by the Commission.

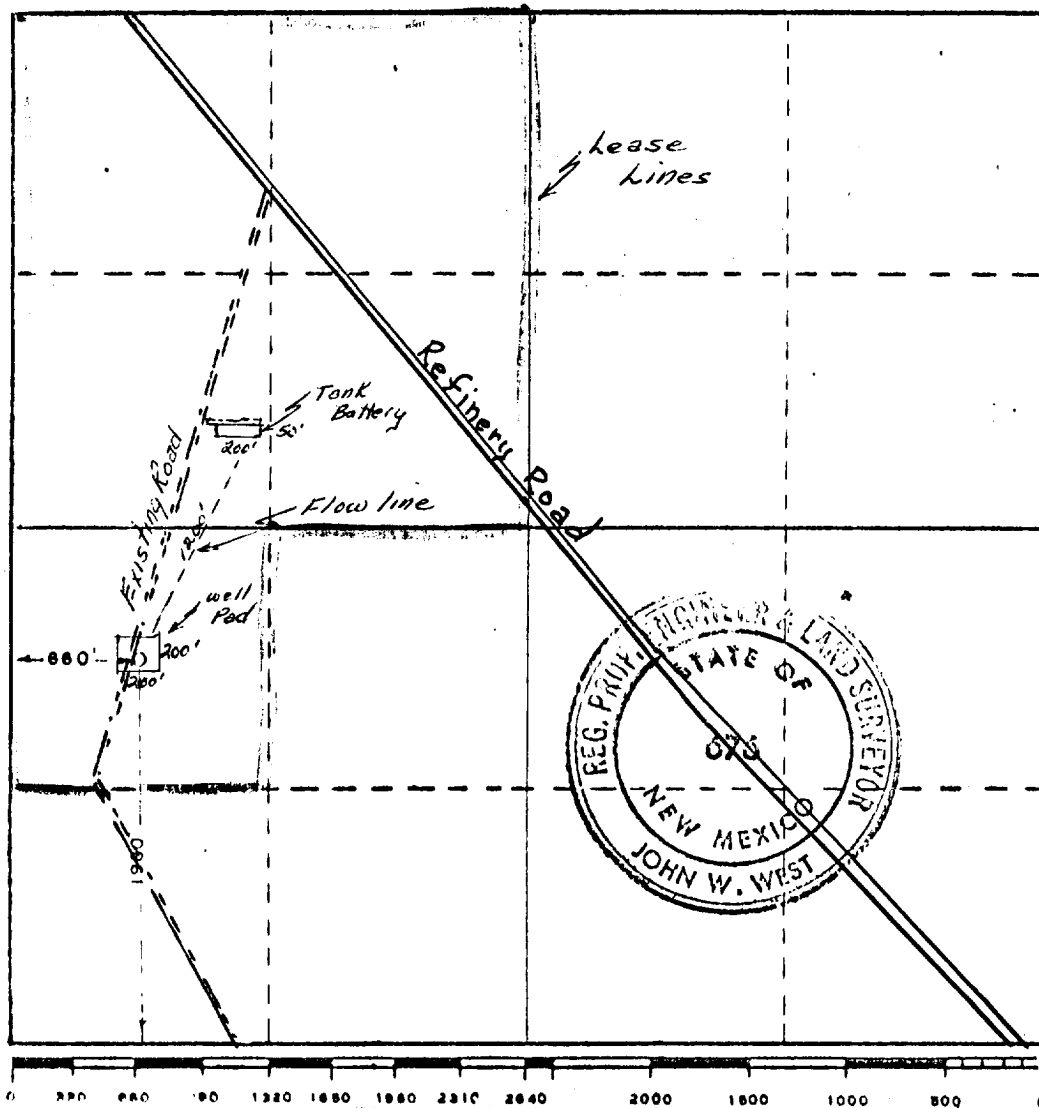

CERTIFICATION

I hereby certify that the information contained herein is true and complete to the best of my knowledge and belief.

Name *George D. Neal*
George D. Neal

Position
Superintendent

Company
The Eastland Oil Company

Date
June 16, 1976

I hereby certify that the well location shown on this plat was plotted from field notes of actual surveys made by me or under my supervision, and that the same is true and correct to the best of my knowledge and belief.

Date Surveyed
May 2, 1974

Registered Professional Engineer and/or Land Surveyor

John W. West
Certificate No. **676**