

Form C-102  
Supersedes C-128  
Effective 1-1-65

Operator <b>The Eastland Oil Company</b>		Lease <b>Harroun - Fed. Com.</b>		Well No. <b>1</b>
Tract Letter <b>L</b>	Section <b>29</b>	Township <b>22 South</b>	Range <b>28 East</b>	County <b>Eddy</b>
Actual Footage Location of Well: <b>2310</b> feet from the <b>South</b> line and <b>660</b> feet from the <b>West</b> line				
Ground Level Elev. <b>3037.1</b>	Producing Formation <b>Delaware</b>	Pool <b>Undesignated Delaware</b>		Dedicated Acreage: <b>40</b> Acres

- No allowable will be assigned to the well until all interests have been consolidated (by communitization, unitization, forced-pooling, or otherwise) or until a non-standard unit, eliminating such interests, has been approved by the Commission.

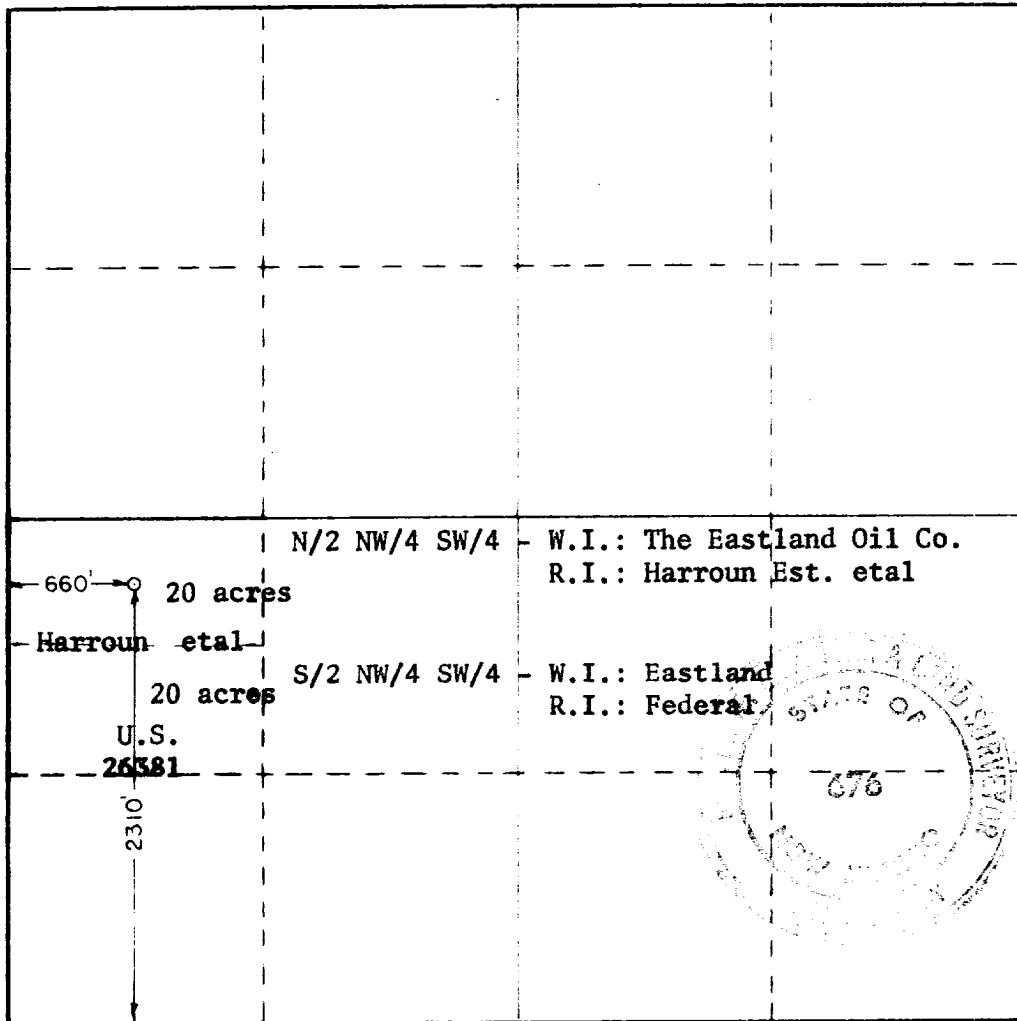

Certificate No.

676