

**UNITED STATES
DEPARTMENT OF THE INTERIOR**

GEOLOGICAL SURVEY

APPLICATION FOR PERMIT TO DRILL, DEEPEN, OR PLUG BACK

30-015-22414
5. LEASE DESIGNATION AND SERIAL NO.

NM 26381

6. IF INDIAN, ALLOTTEE OR TRIBE NAME

7. UNIT AGREEMENT NAME

8. FARM OR LEASE NAME

Toles Federal

9. WELL NO.

1

10. FIELD AND POOL, OR WILDCAT

Undesignated Delaware

11. SEC., T., R., M., OR BLK.
AND SURVEY OR AREA

Sec 29, T22S, R28E

12. COUNTY OR PARISH

Eddy

13. STATE

New Mexico

1a. TYPE OF WORK

DRILL ☒

PLUG BACK ☐

b. TYPE OF WELL

OIL
WELL ☒

GAS
WELL ☐

OTHER ☐

MULTIPLE
ZONE ☒

2. NAME OF OPERATOR

The Eastland Oil Company

3. ADDRESS OF OPERATOR

704 Western United Life Bldg., Midland, Texas 79701

4. LOCATION OF WELL (Report location clearly and in accordance with any State requirements.*)

At surface
330 feet FSL and 2283 feet FEL

At proposed prod. zone

Same

14. DISTANCE IN MILES AND DIRECTION FROM NEAREST TOWN OR POST OFFICE*

4 miles east of Otis, New Mexico

15. DISTANCE FROM PROPOSED*

LOCATION TO NEAREST
PROPERTY OR LEASE LINE, FT.
(Also to nearest drilg. line, if any) **330'**
(330')

16. NO. OF ACRES IN LEASE

**O.C.B.
ARTESIA, OFFICE
120**

17. NO. OF ACRES ASSIGNED
TO THIS WELL

40

18. DISTANCE FROM PROPOSED LOCATION*

TO NEAREST WELL, DRILLING, COMPLETED,
OR APPLIED FOR, ON THIS LEASE, FT.

19. PROPOSED DEPTH

2600

20. ROTARY OR CABLE TOOLS

Cable Tools

21. ELEVATIONS (Show whether DF, RT, GR, etc.)

3015' GR, 3016' DF

22. APPROX. DATE WORK WILL START*

February 20, 1978

23.

PROPOSED CASING AND CEMENTING PROGRAM

SIZE OF HOLE	SIZE OF CASING	WEIGHT PER FOOT	SETTING DEPTH	QUANTITY OF CEMENT
10"	8-5/8"	24#	350'	*250 sacks Class C, 2% CaCl ₂
8"	4-1/2"	9.5#	2500'	*300 sacks Lite
				200 sacks 50-50 poz-mix

*Cement calculated to circulate

Toles Federal #1 is to be drilled with a cable tool rig to a depth of 2600 feet in the Delaware sand expected to produce oil at 2500 feet. No other producing zones are anticipated. Additional geological tops are: surface - Quaternary, Anhydrite - 1,700', Delaware Lime - 2400', and Delaware Sand - 2500'. It is planned to drill an 8" hole to the top of the first sand and reduce to 6" hole. Casing will be set on top of the sand using a packer shoe.

A 1000 psi test control head will be installed on the 8" surface casing. No abnormal pressure or temperature is anticipated. In the event that shallow surface water is encountered, 10" conductor pipe will be set thru the water zone and pulled before cementing surface casing. At total depth, a Gamma Ray log will be run from T.D. to surface. Anticipated starting date is February 20, 1978 with 30 days required for completion.

IN ABOVE SPACE DESCRIBE PROPOSED PROGRAM: If proposal is to deepen or plug back, give data on present productive zone and proposed new productive zone. If proposal is to drill or deepen directionally, give pertinent data on subsurface locations and measured and true vertical depths. Give blowout preventer program, if any.

24.

SIGNED

George L. Neal

TITLE

Superintendent

DATE

Dec. 27, 1977

(This space for Federal or State office use)

PERMIT NO.

APPROVAL DATE

FEB 6 - 1978

APPROVED BY

CONDITIONS OF APPROVAL, IF ANY:

Joe S. Lara

TITLE

ACTING DISTRICT ENGINEER

DATE

FEB 6 - 1978

THIS APPROVAL IS RESCINDED IF OPERATIONS
ARE NOT COMMENCED WITHIN 3 MONTHS.
EXPIRES **MAY 6 - 1978**

*See Instructions On Reverse Side

Instructions

General: This form is designed for submitting proposals to perform certain well operations, as indicated, on all types of lands and leases for appropriate action by either a Federal or a State agency, or both, pursuant to applicable Federal and/or State laws and regulations. Any necessary special instructions concerning the use of this form and the number of copies to be submitted, particularly with regard to local, area, or regional procedures and practices, either are shown below or will be issued by, or may be obtained from, the local Federal and/or State office.

Item 1: If the proposal is to redrill to the same reservoir at a different subsurface location or to a new reservoir, use this form with appropriate notations. Consult applicable State or Federal regulations concerning subsequent work proposals or reports on the well.

Item 4: If there are no applicable State requirements, locations on Federal or Indian land should be described in accordance with Federal requirements. Consult local State or Federal office for specific instructions.

Item 14: Needed only when location of well cannot readily be found by road from the land or lease description. A plat, or plats, separate or on this reverse side, showing the roads to, and the surveyed location of, the well, and any other required information, should be furnished when required by Federal or State agency offices.

Items 15 and 18: If well is to be, or has been directionally drilled, give distances for subsurface location of hole in any present or objective production zone.

Item 22: Consult applicable Federal or State regulations, or appropriate officials, concerning approval of the proposal before operations are started.

NEW MEXICO OIL CONSERVATION COMMISSION
WELL LOCATION AND ACREAGE DEDICATION PLAT

Form C-122
Supersedes C-128
Effective 1-1-65

EXHIBIT B

All distances must be from the outer boundaries of the Section

The Eastland Oil Co.			To Les Federal			Well No. 1		
Section	29	22 South	28 East	Eddy				
330	feet from the	South	2283	feet from the	East			
Ground Level Elevation	3015.5		Underlying Ownership		Undesignated Delaware		Section Acreage	
		Delaware				40		

1. Outline the acreage dedicated to the subject well by colored pencil or hatchure marks on the plat below.
2. If more than one lease is dedicated to the well, outline each and identify the ownership thereof (both as to working interest and royalty)
3. If more than one lease of different ownership is dedicated to the well, have the interests of all owners been consolidated by communitization, unitization, force-pooling, etc?

RECEIVED

DEC 29 1977

**U.S. GEOLOGICAL SURVEY
ARTESIA, NEW MEXICO**

☐ Yes ☐ No If answer is "yes," type of consolidation _____

If answer is "no," list the owners and tract descriptions which have actually been consolidated. (Use reverse side of this form if necessary.) _____

No allowable will be assigned to the well until all interests have been consolidated (by communitization, unitization, forced-pooling, or otherwise) or until a non-standard unit, eliminating such interests, has been approved by the Commission.

RECEIVED

FEB 7 1978

**O. C. C.
ARTESIA, OFFICE**

CERTIFICATION

I hereby certify that the information contained herein is true and complete to the best of my knowledge and belief.

George D. Neal

George D. Neal

Superintendent

The Eastland Oil Company

December 27, 1977

I hereby certify that the well location shown on this plat was plotted from field notes of actual surveys made by me or under my supervision, and that the same is true and correct to the best of my knowledge and belief.

December 16, 1977

Date Surveyed

Registered Professional Engineer
and/or Registered Surveyor

Earl Whit

Certificate No.

676

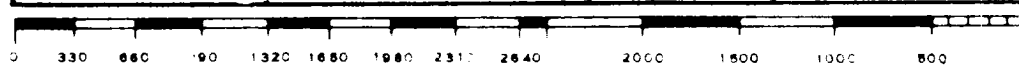
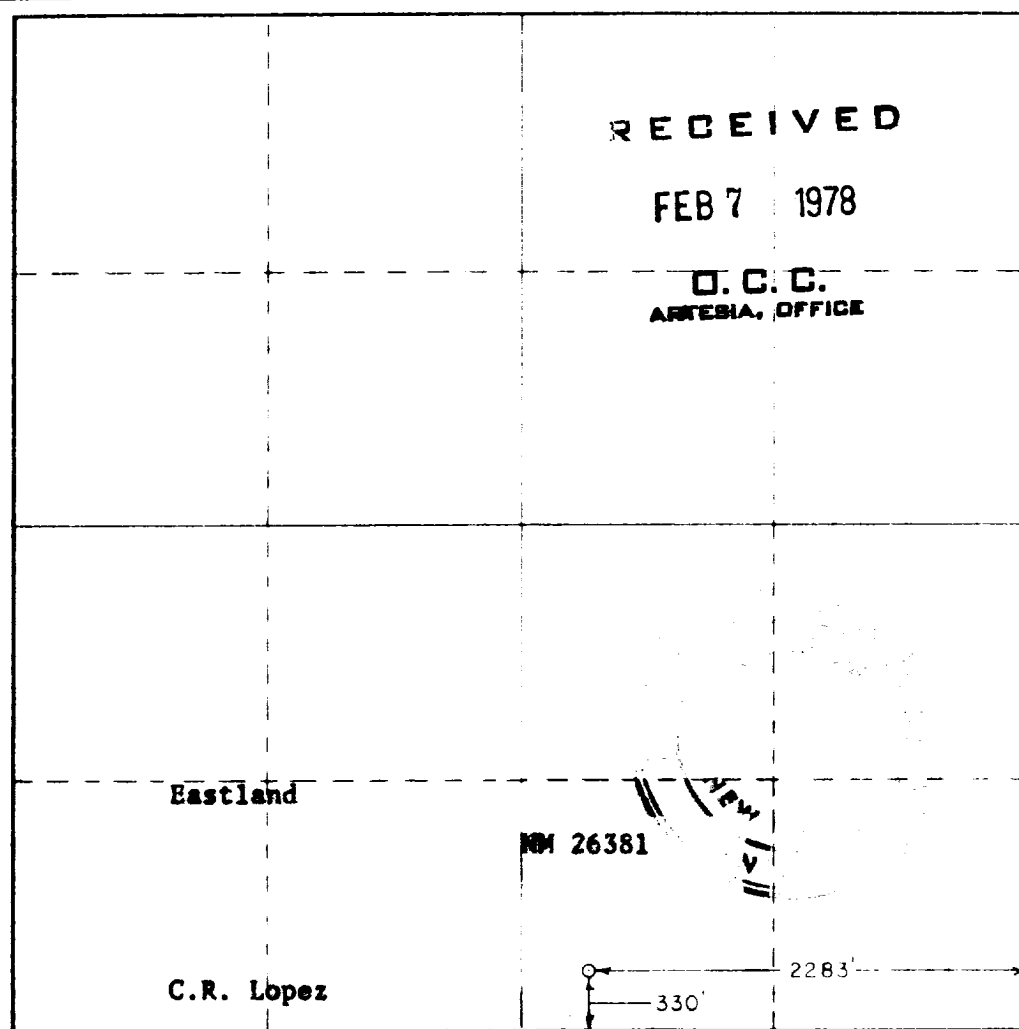

THE EASTLAND OIL COMPANY
TOLES FEDERAL WELL No.1
330' FSL and 2283' FEL, Sec. 29, T22S, R28E
Eddy County, New Mexico

RECEIVED

DEC 29 1977

U. S. GEOLOGICAL SURVEY
ARTESIA, NEW MEXICO

Surface Use and Operations Plan

1. Existing roads: USGS topographic map marked as Exhibit A shows existing roads with exit from the main highway, US 285. A public road extends from the highway east to within one mile of the location. Eastland's caliche road on private land will be extended to the proposed location using an unimproved road that passes south of the location. Approximately 330 feet of this road will be caliched to a maximum width of 12 feet on the Toles Federal lease.
2. Planned access roads: No additional access roads will be needed. No fences will be crossed and no cattle guards will be used.
3. Location of existing wells: All wells within a one-mile radius of the proposed location are marked on Exhibit A.
4. Location of tank batteries, production facilities, and production, gathering, and service lines: The C. R. Lopez "A" tank battery and well are shown on the plat marked Exhibit B. Since the Toles Federal #1 will be a one-well lease on 40 acres, it is planned to place the production facilities at the well site. This location is indicated on Exhibit B. A firewall to contain possible spills will be built around the tank battery and produced formation water will be contained in a tank at the battery location.
5. Location and type of water supply: Water needed for drilling will be trucked from Carlsbad. No water supply will be developed on the lease.
6. Source of construction materials: Caliche for road and location will be hauled from a private pit in the SW/4 SW/4 of Section 29. Surface material moved to level the location will be retained to refill pits.
7. Method for handling waste disposal: Waste material including cuttings, gargage, and drilling fluids will be contained in pits at the location. Incendiary material will be burned on location and other items will be hauled away. Since this well is to be drilled by cable tools, drilling fluids will be minimal. After drying, pits will be covered.
8. Ancillary facilities: No camps or airstrips will be required.
9. Well site layout: Exhibit C
10. Plans for restoring the surface: If the test results in a dry hole, the pad and access road will be ripped. The location will be leveled and all pits covered within 60 days of completion. The original slope of the well site will be restored to insure adequate drainage.

11. Other information: The surface location is deep soil with limited grass cover. There is a slope or drainage northeast to the Pecos river which is about 350 feet from the location. A natural drainage ditch from west to east lies about 100 feet north of the location. It is proposed to build a 3 foot high earthen dike on the north, east, and west sides of the location to insure drainage around the pad and to the river.

Access roads to the location will cross private land to within 330 feet of the location and will then be on Federal surface.

12. Lessee's or operators representative:

George D. Neal
704 Western United Life Building
Midland, Texas 79701
Telephone: A/C 915 683-6293

13. I hereby certify that I, or persons under my supervision, have inspected the proposed drillsite and access route; that I am familiar with the conditions which presently exist; that the statements made in this plan are, to the best of my knowledge, true and correct; and, that the work associated with the operations proposed herein will be performed by The Eastland Oil Company and its contractors and subcontractors in conformity with this plan and the terms and conditions under which it is approved.

December 27, 1977



George D. Neal
Superintendent

Exhibit A



The Eastland Oil Co. Toles Federal #1
Eddy Co. Contour interval 10 feet
Datum is mean sea level New Mexico

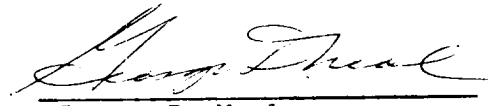
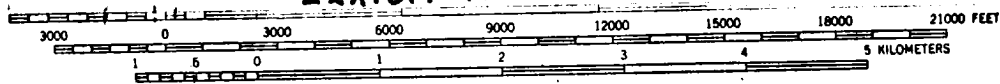
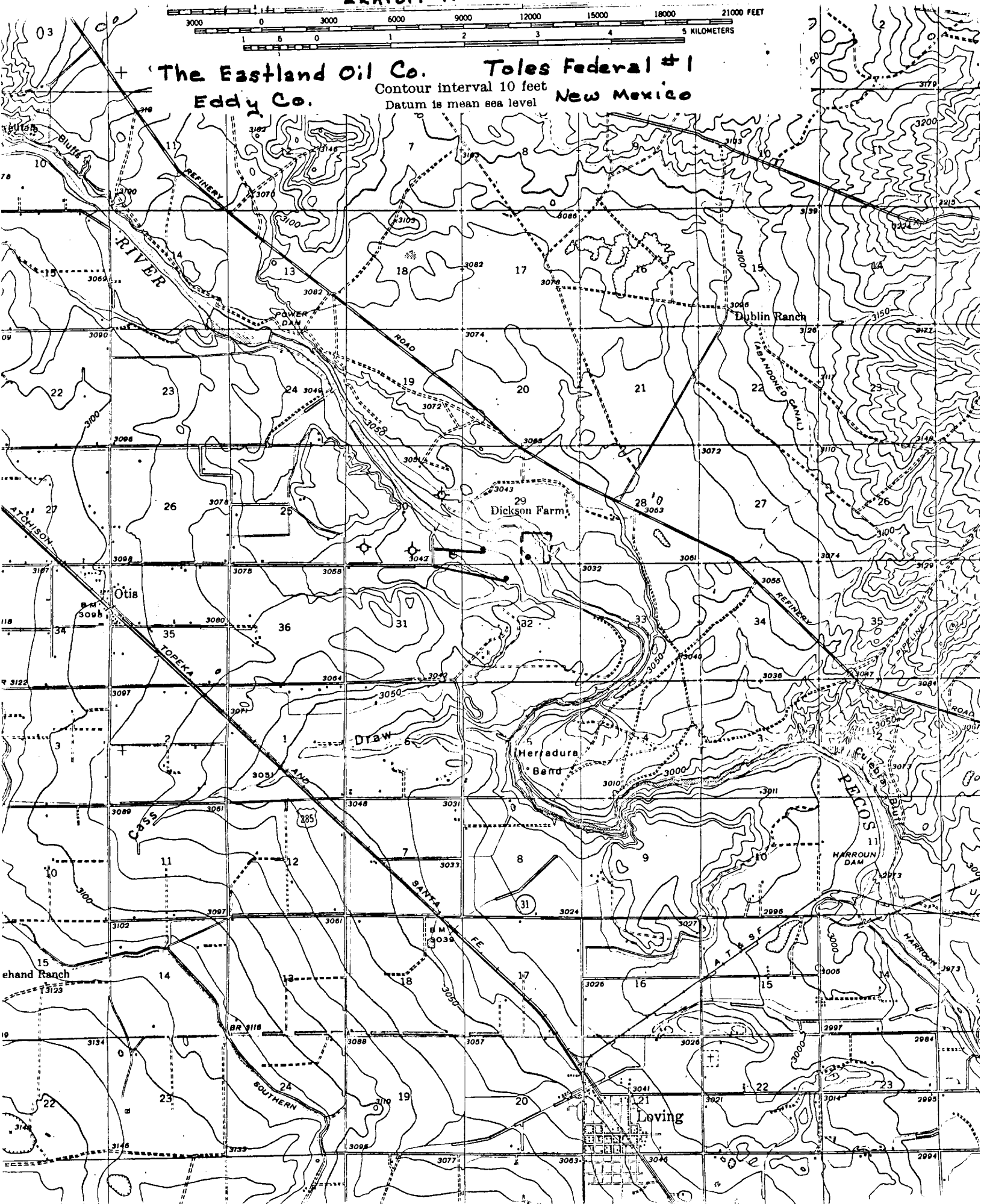

NEW MEXICO OIL CONSERVATION COMMISSION
WELL LOCATION AND ACREAGE DEDICATION PLAT

Form C-102
Supersedes C-128
Effective 1-1-65

EXHIBIT B

All distances must be from the outer boundaries of the Section

Operator The Eastland Oil Co.			Lease ToLes Federal		Well No. 1
Unit Letter O	Section 29	Township 22 South	Range 28 East	County Eddy	
Actual Footage Location of Well:					
330	feet from the	South	line and	2283	feet from the East line
Ground Level Elev 3015.5	Producing Formation Delaware		Pool Undesignated Delaware		Dedicated Acreage: 40 Acres

1. Outline the acreage dedicated to the subject well by colored pencil or hatchure marks on the plat below.
2. If more than one lease is dedicated to the well, outline each and identify the ownership thereof (both as to working interest and royalty).
3. If more than one lease of different ownership is dedicated to the well, have the interests of all owners been consolidated by communitization, unitization, force-pooling, etc?

☐ Yes ☐ No If answer is "yes," type of consolidation _____

If answer is "no," list the owners and tract descriptions which have actually been consolidated. (Use reverse side of this form if necessary.) _____

No allowable will be assigned to the well until all interests have been consolidated (by communitization, unitization, forced-pooling, or otherwise) or until a non-standard unit, eliminating such interests, has been approved by the Commission.

RECEIVED

FEB 7 1978

O. C. C.
ARTESIA, OFFICE

CERTIFICATION

I hereby certify that the information contained herein is true and complete to the best of my knowledge and belief.

George D. Neal

Name
George D. Neal

Position
Superintendent

Company
The Eastland Oil Company

Date
December 27, 1977

I hereby certify that the well location shown on this plat was plotted from field notes of actual surveys made by me or under my supervision, and that the same is true and correct to the best of my knowledge and belief.

December 16, 1977

Date Surveyed

Registered Professional Engineer and/or Land Surveyor

W. West

Certificate No. **676**

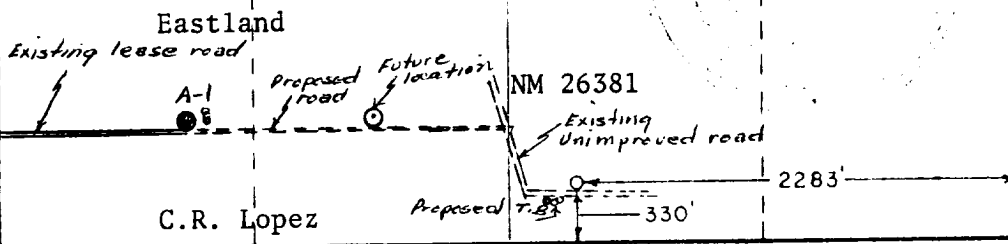

The Eastland Oil Company
TOLES Federal #1
Exhibit C



Scale: 1" = 50'

