

Submit to Appropriate
District Office
State Lease - 6 copies
Fee Lease - 5 copies

State of New Mexico
Energy, Minerals and Natural Resources Department

Form C-101
Revised 1-1-89

ASK
DP

DISTRICT I
P.O. Box 1980, Hobbs, NM 88240

DISTRICT II
P.O. Drawer DD, Artesia, NM 88210

DISTRICT III
1000 Rio Brazos Rd., Aztec, NM 87410

OIL CONSERVATION DIVISION

P.O. Box 2088
Santa Fe, New Mexico 87504-2088

SEP - 9 1991

APPLICATION FOR PERMIT TO DRILL, DEEPEN, OR PLUG BACK					
1a. Type of Work: DRILL <input type="checkbox"/> RE-ENTER <input type="checkbox"/> DEEPEN <input type="checkbox"/> PLUG BACK <input checked="" type="checkbox"/>					
b. Type of Well: OIL WELL <input checked="" type="checkbox"/> GAS WELL <input type="checkbox"/> OTHER <input type="checkbox"/> SINGLE ZONE <input type="checkbox"/> MULTIPLE ZONE <input type="checkbox"/>					
2. Name of Operator Parker and Parsley Development					
3. Address of Operator P.O. Box 3178, Midland, Texas 79702-3178					
4. Well Location Unit Letter <u>H</u> : <u>1980</u> Feet From The <u>North</u> Line and <u>990</u> Feet From The <u>East</u> Line Section <u>27</u> Township <u>23S</u> Range <u>28E</u> NMPM <u>Eddy</u> County					
10. Proposed Depth 6265		11. Formation Brushy Canyon		12. Rotary or C.T. W/O Unit	
13. Elevations (Show whether DF, RT, GR, etc.) 3035 GL		14. Kind & Status Plug. Bond Blanket Bond		15. Drilling Contractor N/A	
16. Approx. Date Work will start ASAP					
17. PROPOSED CASING AND CEMENT PROGRAM					
SIZE OF HOLE	SIZE OF CASING	WEIGHT PER FOOT	SETTING DEPTH	SACKS OF CEMENT	EST. TOP

It is proposed to plug back from the Bone Springs and recompleate the Brushy Canyon as follows:

- 1) Set CR @ 6265' and squeeze Bone Springs perfs 6274'-7036' (184 holes) w/ 450 sks Class H cmt.
- 2) Run CBL and perf Brushy Canyon f/ 6257'-6058' (12 holes).
- 3) Frac using 50,000 gals XL and 150,000# 20/40 sd.
- 4) Put well on production test.

APPROVAL VALID FOR 180 DAYS
PERMIT EXPIRES 3/11/92
UNLESS DRILLING UNDERWAY

IN ABOVE SPACE DESCRIBE PROPOSED PROGRAM: IF PROPOSAL IS TO DEEPEN OR PLUG BACK, GIVE DATA ON PRESENT PRODUCTIVE ZONE AND PROPOSED NEW PRODUCTIVE ZONE. GIVE BLOWOUT PREVENTER PROGRAM, IF ANY.

I hereby certify that the information above is true and complete to the best of my knowledge and belief.

SIGNATURE Randy R. Johnson TITLE Sr. Oper. Engineer DATE 9/5/91

TYPE OR PRINT NAME Randy R. Johnson

TELEPHONE NO. 915-683-4768

(This space for State Use)

ORIGINAL SIGNED BY
MIKE WILLIAMS

SEP 13 1991

APPROVED BY SUPERVISOR, DISTRICT II TITLE DATE

CONDITIONS OF APPROVAL, IF ANY:

OIL CONSERVATION DIVISION

P.O. Box 2088
Santa Fe, New Mexico 87504-2088

DISTRICT I
P.O. Box 1980, Hobbs, NM 88240

DISTRICT II
P.O. Drawer DD, Artesia, NM 88210

DISTRICT III
1000 Rio Brazos Rd., Aztec, NM 87410

WELL LOCATION AND ACREAGE DEDICATION PLAT

All Distances must be from the outer boundaries of the section

Operator Parker & Parsley Development			Lease Pardue Farms 27		Well No. 1
Unit Letter H	Section 27	Township 23 South	Range 28 East	County Eddy	
Actual Footage Location of Well: 1980 feet from the North line and 990 feet from the East line					
Ground level Elev. 3035.5	Producing Formation Brushy Canyon		Pool East Loving Delaware		Dedicated Acreage: 40 Acres

1. Outline the acreage dedicated to the subject well by colored pencil or hatchure marks on the plat below.

2. If more than one lease is dedicated to the well, outline each and identify the ownership thereof (both as to working interest and royalty).

3. If more than one lease of different ownership is dedicated to the well, have the interest of all owners been consolidated by communitization, unitization, force-pooling, etc.?

☒ Yes ☐ No If answer is "yes" type of consolidation Operating Agreement

If answer is "no" list the owners and tract descriptions which have actually been consolidated. (Use reverse side of this form if necessary.)

No allowable will be assigned to the well until all interests have been consolidated (by communitization, unitization, forced-pooling, or otherwise) or until a non-standard unit, eliminating such interest, has been approved by the Division.

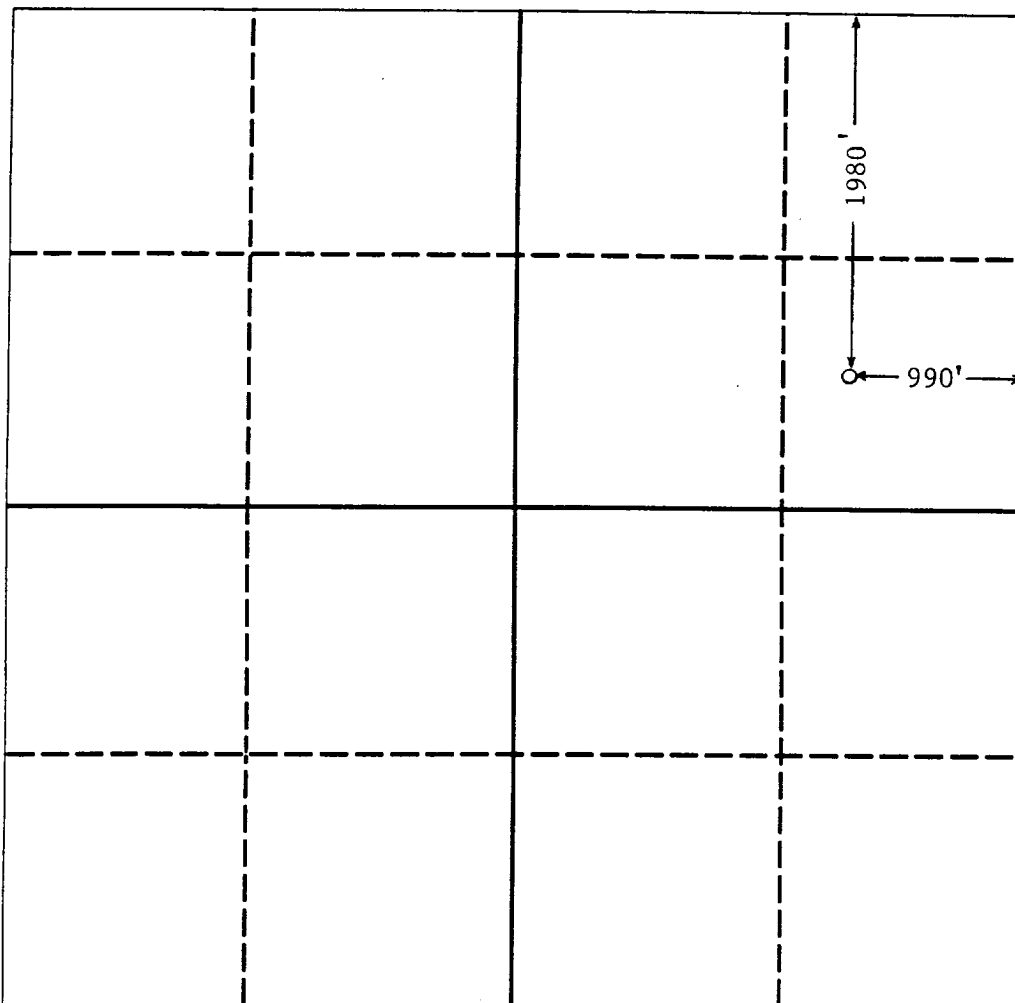

0 330 660 990 1320 1650 1980 2310 2640 2000 1500 1000 500 0

OPERATOR CERTIFICATION

I hereby certify that the information contained herein is true and complete to the best of my knowledge and belief.

Signature
Randy R. Johnson
Printed Name
Randy R. Johnson
Position
Sr. Engineer
Company
Parker & Parsley Dev.
Date
9/5/91

SURVEYOR CERTIFICATION

I hereby certify that the well location shown on this plat was plotted from field notes of actual surveys made by me or under my supervision, and that the same is true and correct to the best of my knowledge and belief.

Date Surveyed
Signature & Seal of
Professional Surveyor

Certificate No.

WELL LOCATION AND ACREAGE DEDICATION PLAT

Supersedes Circular
Effective 1-1-68

All distances must be from the outer boundaries of the Section

Operator MADDOX ENERGY CORP.			Lease PARDUE FARMS 27		Well No. 1
Unit Letter H	Section 27	Township 23 SOUTH	Range 28 EAST	County EDDY	
Actual Footage Location of Well: 1980 feet from the NORTH line and 990 feet from the EAST line					
Minimum Level Elev 3035.5	Producing Formation Horrow		Pool Undesignated		Dedicated Acreage 320

- Outline the acreage dedicated to the subject well by colored pencil or hachure marks on the plat below.
- If more than one lease is dedicated to the well, outline each and identify the ownership thereof (both as to working interest and royalty).
- If more than one lease of different ownership is dedicated to the well, have the interests of all owners been consolidated by communitization, unitization, force-pooling, etc?

☐ Yes ☒ No If answer is "yes," type of consolidation _____

If answer is "no," list the owners and tract descriptions which have actually been consolidated. (Use reverse side of this form if necessary.) NONE

No allowable will be assigned to the well until all interests have been consolidated (by communitization, unitization, forced-pooling, or otherwise) or until a non-standard unit, eliminating such interests, has been approved by the Commission.

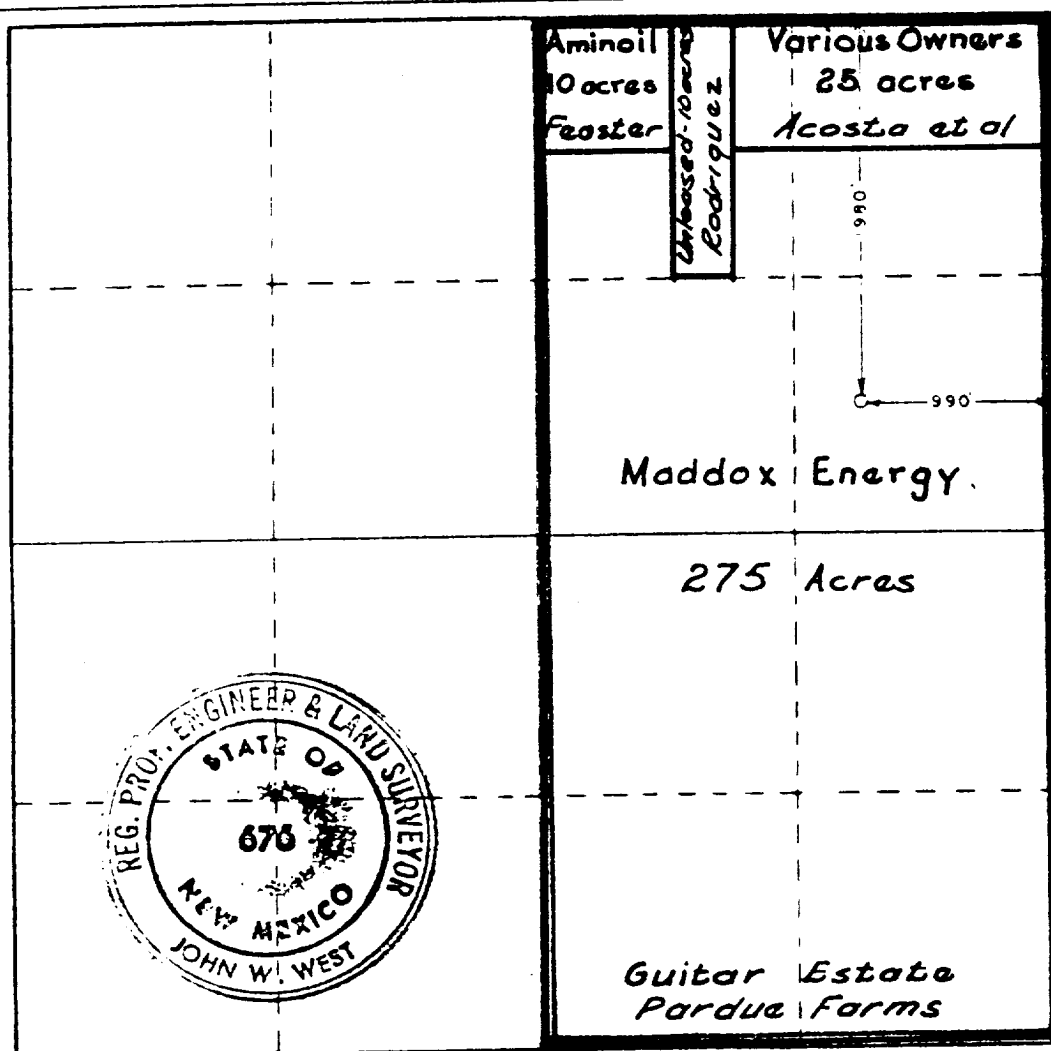

CERTIFICATION

I hereby certify that the information contained herein is true and complete to the best of my knowledge and belief

B. D. Baker

Name **B. D. Baker**

Position **Consulting Engineer**

Company **Maddox Energy Corp**

Date **July 25, 1978**

I hereby certify that the well location shown on this plat was plotted from field notes of actual surveys made by me or under my supervision, and that the same is true and correct to the best of my knowledge and belief

Date Surveyed

JULY 20, 1978

Registered Professional Engineer and/or Land Surveyor

Ronald J. Eidson

Certificate No. **John W. West 676**

Ronald J. Eidson 3239

330 660 990 1320 1650 1980 2310 2640 2970 3300 3630 3960 4290 4620 4950 5280 5610 5940 6270 6600 6930 7260 7590 7920 8250 8580 8910 9240 9570 9900 0