

NO. OF COPIES RECEIVED	5
DISTRIBUTION	
SANTA FE	1
FILE	1 ✓
U.S.G.S.	2
LAND OFFICE	
OPERATOR	1

NEW MEXICO OIL CONSERVATION COMMISSION

RECEIVED

30-015-22647

Form C-101  
Revised 1-1-65

SEP 15 1980

O. C. D.

ARTESIA, OFFICE

5A. Indicate Type of Lease

STATE ☐

FEE ☒

5. State Oil &amp; Gas Lease No.

## APPLICATION FOR PERMIT TO DRILL, DEEPEN, OR PLUG BACK

1a. Type of Work		7. Unit Agreement Name	
b. Type of Well DRILL <input checked="" type="checkbox"/> DEEPEN <input type="checkbox"/> PLUG BACK <input type="checkbox"/> OIL WELL <input checked="" type="checkbox"/> GAS WELL <input type="checkbox"/> OTHER / Re-Entry <input type="checkbox"/> SINGLE ZONE <input checked="" type="checkbox"/> MULTIPLE ZONE <input type="checkbox"/>		8. Farm or Lease Name Queen "B"	
2. Name of Operator MADDOX ENERGY CORPORATION		9. Well No. 1	
3. Address of Operator The Blanks Building, Suite 906, Midland, Texas 79701		10. Field and Pool, or Willcat Wildcat Bone Springs	
4. Location of Well UNIT LETTER D LOCATED 760 FEET FROM THE North LINE AND 990 FEET FROM THE West LINE OF SEC. 26 TWP. 23-S RGE. 28-E NMPM		17. County Eddy	
19. Proposed Depth 6950'		19A. Formation Bone Springs	
20. Rotary or C.T. Rotary			
21. Elevations (show whether DT, RT, etc.) 3022.5' G.L.		21A. Kind & Status Plug. Bond Active	
21B. Drilling Contractor Mack Chase, Inc.		22. Approx. Date Work will start	

23.

## PROPOSED CASING AND CEMENT PROGRAM

SIZE OF HOLE	SIZE OF CASING	WEIGHT PER FOOT	SETTING DEPTH	SACKS OF CEMENT	EST. TOP
	13 3/8"	48#	370'	425	Circulated
	8 5/8"	24#	2599'	1000	Circulated
7 7/8"	4 1/2"	10.5-11.6#	6925'	400	2450'

BOP's:

Surface to 6950' - 10" double ram hydraulic preventers

Refer to original plat dated August 2, 1978.

This well was originally drilled by Amoco Production Co. to a TD of 9777' and was P&A on September 4, 1978. It is proposed to drill out plugs to approximately 7000', log and run 4 1/2" casing to TD. Sufficient cement will be used to tie back into the 8 5/8" casing which is set at 2599' and up to approximately 2450'. Casing will be perforated within the interval approximately 6300'-6800' with 50± shots, 1 SPF, and acidize with 15,000 gallons acid. Well will be swabbed and put on production.

APPROVAL VALID  
FOR 30 DAYS U.  
DRILLING COMME

EXPIRES 1-7-81

IN ABOVE SPACE DESCRIBE PROPOSED PROGRAM; IF PROPOSAL IS TO DEEPEN OR PLUG BACK, GIVE DATA ON PRESENT PRODUCTIVE ZONE AND PROPOSED NEW PRODUCTIVE ZONE. GIVE BLOWOUT PREVENTER PROGRAM, IF ANY.

I hereby certify that the information above is true and complete to the best of my knowledge and belief.

Signed Quindra B. Cary Title Operations Manager Date September 9, 1980

(This space for State Use)

APPROVED BY W.A. Gussert TITLE SUPERVISOR, DISTRICT II DATE OCT 7 1980

CONDITIONS OF APPROVAL, IF ANY:

NSL must be approved prior to producing the well  
NSL 1274 10-24-80

30-015-22647  
10-24-80

NEW MEXICO OIL CONSERVATION COMMISSION  
WELL LOCATION AND ACREAGE DEDICATION PLAT

Form C-102  
Supersedes C-128  
Effective 1-1-65

All distances must be from the outer boundaries of the Section.

Operator <b>MADDOX ENERGY CORPORATION</b>			Lease <b>Queen "B"</b>		Well No. <b>1</b>
Unit Letter <b>D</b>	Section <b>26</b>	Township <b>23 South</b>	Range <b>28 East</b>	County <b>Eddy</b>	
Actual Footage Location of Well: <b>760</b> feet from the <b>North</b> line and <b>990</b> feet from the <b>West</b> line					
Ground Level Elev. <b>3022.5</b>	Producing Formation <b>Bone Springs</b>		Pool <b>Wildcat - Bone Springs</b>		Dedicated Acreage: <b>4.40</b> Acres

1. Outline the acreage dedicated to the subject well by colored pencil or hatchure marks on the plat below.
2. If more than one lease is dedicated to the well, outline each and identify the ownership thereof (both as to working interest and royalty).
3. If more than one lease of different ownership is dedicated to the well, have the interests of all owners been consolidated by communitization, unitization, force-pooling, etc?

☒ Yes ☐ No If answer is "yes," type of consolidation Operating Agreement

If answer is "no," list the owners and tract descriptions which have actually been consolidated. (Use reverse side of this form if necessary.)

No allowable will be assigned to the well until all interests have been consolidated (by communitization, unitization, forced-pooling, or otherwise) or until a non-standard unit, eliminating such interests, has been approved by the Commission.

<div style="border: 1px solid black; padding: 10px; margin: 10px;"> <p>SEE AMOCO'S PLAT ATTACHED.</p> </div>	CERTIFICATION	
	<p>I hereby certify that the information contained herein is true and complete to the best of my knowledge and belief.</p>	
	<p><i>Audra B. Cary</i></p>	
	<p>Name <b>Audra B. Cary</b></p>	
	<p>Position <b>Operations Manager</b></p>	
<p>Company <b>MADDOX ENERGY CORPORATION</b></p>		
<p>Date <b>September 9, 1980</b></p>		
<p>I hereby certify that the well location shown on this plat was plotted from field notes of actual surveys made by me or under my supervision, and that the same is true and correct to the best of my knowledge and belief.</p>		
<p>Date Surveyed</p>		
<p>Registered Professional Engineer and/or Land Surveyor</p>		
<p>Certificate No.</p>		

0 330 660 990 1320 1650 1980 2310 2640 2000 1500 1000 500 0

## WELL LOCATION AND ACREAGE DEDICATION PLAT

Supersedes C-128  
Effective 1-1-65

All distances must be from the outer boundaries of the Section

Owner Amoco Production Co.			Lease Queen B			Well No. 1		
Unit Letter D	Section 26	Township 23 South	Range 28 East	County Eddy				
Actual Footage Location of Well:								
760		feet from the North line and		990		feet from the West line		
Ground Level Elev. 3022.5		Producing Formation BONE SPRINGS		Pool <del>Wildcat</del> WILD CAT BONE SPRINGS		Dedicated Acreage: 40		Acres

1. Outline the acreage dedicated to the subject well by colored pencil or hachure marks on the plat below.
2. If more than one lease is dedicated to the well, outline each and identify the ownership thereof (both as to working interest and royalty).
3. If more than one lease of different ownership is dedicated to the well, have the interests of all owners been consolidated by communitization, unitization, force-pooling, etc?

☐ Yes ☐ No If answer is "yes," type of consolidation \_\_\_\_\_

If answer is "no," list the owners and tract descriptions which have actually been consolidated. (Use reverse side of this form if necessary.) \_\_\_\_\_

No allowable will be assigned to the well until all interests have been consolidated, (by communitization, unitization, forced-pooling, or otherwise) or until a non-standard unit, eliminating such interests, has been approved by the Commission.

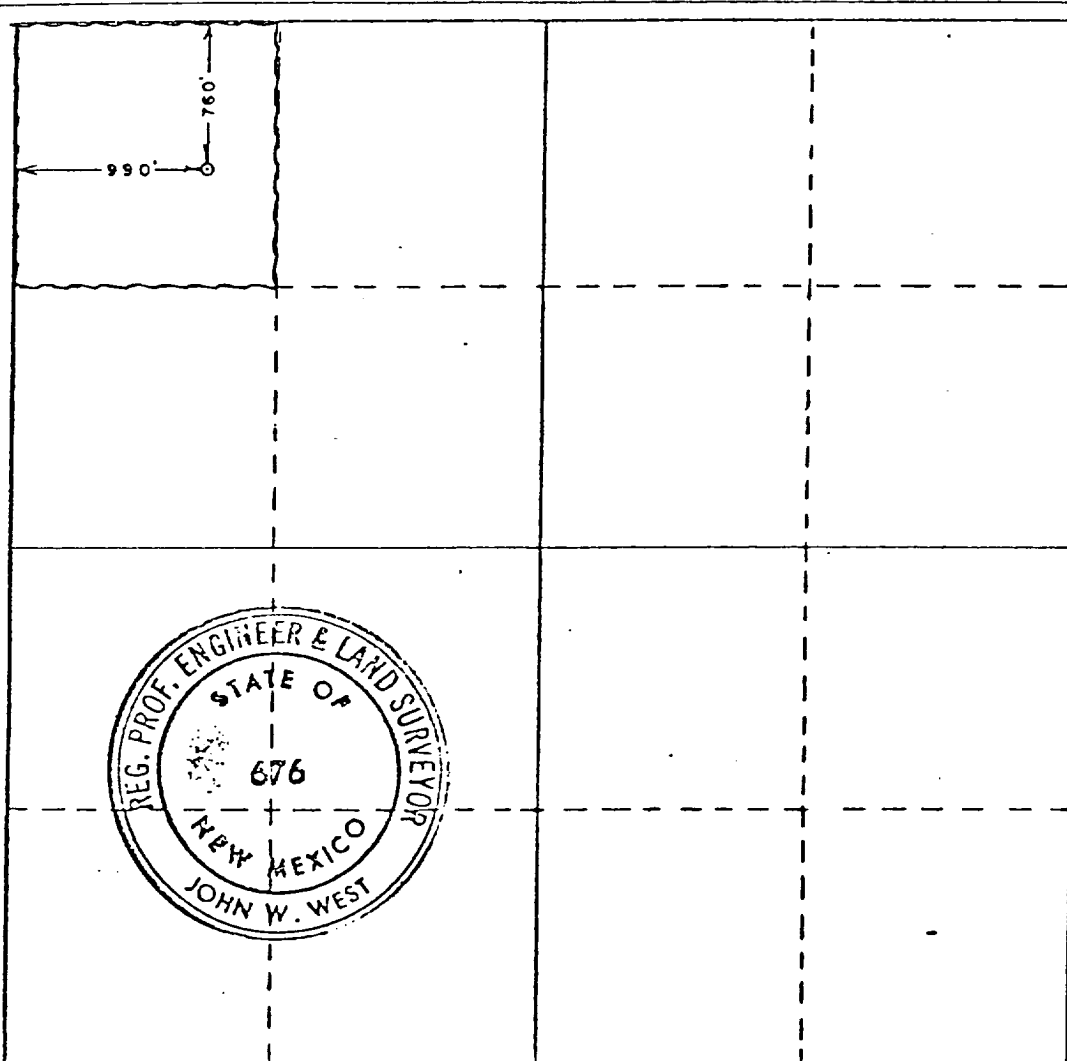

## CERTIFICATION

I hereby certify that the information contained herein is true and complete to the best of my knowledge and belief.

Name  
*Randy Atkins*  
Position  
ADMINISTRATIVE ANALYST  
Company  
AMOCO PRODUCTION CO.  
Date  
8-2-78

I hereby certify that the well location shown on this plat was plotted from field notes of actual surveys made by me or under my supervision, and that the same is true and correct to the best of my knowledge and belief.

Date Surveyed  
July 31, 1978

Registered Professional Engineer  
and/or Land Surveyor

*John W. West*

Certificate No. John W. West 676  
Ronald J. Eldson 3239

330 840 190 1320 1680 1980 2210 2440 2600 1800 1000 800