

NO. OF COPIES RECEIVED	1
DISTRIBUTION	
SANTA FE	1
FILE	1
U.S.G.S.	2
LAND OFFICE	1
OPERATOR	1

NEW MEXICO OIL CONSERVATION COMMISSION

RECEIVED

AUG 31 1978

O. C. C.
ARTESIA, OFFICE

30-015-22679

Form C-101
Revised 1-1-65

5A. Indicate Type of Lease	STATE <input checked="" type="checkbox"/>	FEE <input type="checkbox"/>
5. State Oil & Gas Lease No.	L-6867-3	

APPLICATION FOR PERMIT TO DRILL, DEEPEN, OR PLUG BACK

1a. Type of Work		7. Unit Agreement Name	
b. Type of Well DRILL <input checked="" type="checkbox"/> DEEPEN <input type="checkbox"/> PLUG BACK <input type="checkbox"/> OIL WELL <input checked="" type="checkbox"/> GAS WELL <input type="checkbox"/> OTHER <input type="checkbox"/> SINGLE ZONE <input checked="" type="checkbox"/> MULTIPLE ZONE <input type="checkbox"/>		8. Farm or Lease Name State 32	
2. Name of Operator The Eastland Oil Company		9. Well No. 1	
3. Address of Operator P.O. Drawer 3488, Midland, Texas 79702		10. Field and Pool, or Wildcat Herradura Bend - Delaware	
4. Location of Well UNIT LETTER L LOCATED 2160 FEET FROM THE South LINE AND 330 FEET FROM THE West LINE OF SEC. 32 TWP. 22S RGE. 28E NMPM		12. County Eddy	
19. Proposed Depth 2600		19A. Formation Delaware	20. Rotary or C.T. Cable Tools
21. Elevations (Show whether DF, RI, etc.) 3065' GR	21A. Kind & Status Plug. Bond Blanket on file	21B. Drilling Contractor Cortez Drilling Co.	22. Approx. Date Work will start Sept. 10, 1978

23.

PROPOSED CASING AND CEMENT PROGRAM

SIZE OF HOLE	SIZE OF CASING	WEIGHT PER FOOT	SETTING DEPTH	SACKS OF CEMENT	EST. TOP
10"	8-5/8	24	375'	250	Circulated
8"	4-1/2	9.5	2500'	200 sx 50-50 pozmix. 300 sx light	Circulated

Approx 100' of 10-3/4" conductor will be run if necessary and pulled before cementing 8-5/8" casing.

Control head installed on 8-5/8" surface casing.

APPROVAL VALID
FOR 90 DAYS UNLESS
DRILLING COMMENCED,

EXPIRES 12-1-78

IN ABOVE SPACE DESCRIBE PROPOSED PROGRAM: IF PROPOSAL IS TO DEEPEN OR PLUG BACK, GIVE DATA ON PRESENT PRODUCTIVE ZONE AND PROPOSED NEW PRODUCTIVE ZONE. GIVE BLOWOUT PREVENTER PROGRAM, IF ANY.

I hereby certify that the information above is true and complete to the best of my knowledge and belief.

Signed George Dheal Title Superintendent Date August 29, 1978

(This space for State Use)

APPROVED BY W. A. Gressett TITLE SUPERVISOR, DISTRICT II DATE SEP - 1 1978

CONDITIONS OF APPROVAL, IF ANY:

**MEXICO OIL CONSERVATION COMMISSION
WELL LOCATION AND ACREAGE DEDICATION PLAT**

Form C-102
Supersedes C-128
Effective 1-1-65

All distances must be from the outer boundaries of the Section

Operator The Eastland Oil Co.			Lease State 32		Well No. 1
Section Letter L	Section 32	Township 22 South	Range 28 East	County Eddy	
Actual Footage Location of Well: 2160 feet from the South line and 330 feet from the West line					
Ground Level Elev. 3065	Producing Formation Delaware		Pool <i>Hand</i> Herradura Bend Del.		Dedicated Acreage: 40 Acres

1. Outline the acreage dedicated to the subject well by colored pencil or hatchure marks on the plat below.
2. If more than one lease is dedicated to the well, outline each and identify the ownership thereof (both as to working interest and royalty).
3. If more than one lease of different ownership is dedicated to the well, have the interests of all owners been consolidated by communitization, unitization, force-pooling, etc?

☐ Yes ☐ No If answer is "yes," type of consolidation _____

If answer is "no," list the owners and tract descriptions which have actually been consolidated. (Use reverse side of this form if necessary.) _____

No allowable will be assigned to the well until all interests have been consolidated (by communitization, unitization, forced-pooling, or otherwise) or until a non-standard unit, eliminating such interests, has been approved by the Commission.

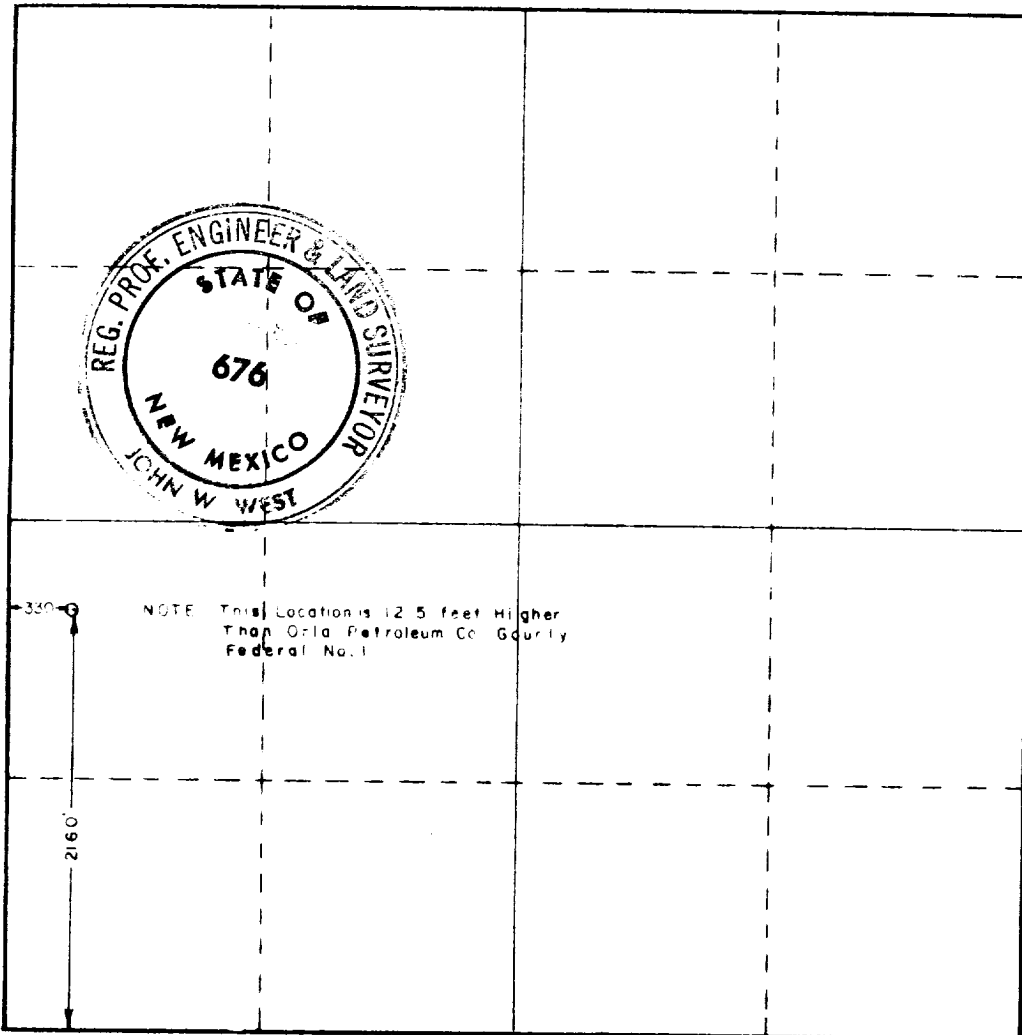

CERTIFICATION

I hereby certify that the information contained herein is true and complete to the best of my knowledge and belief.

George D. Neal
Name

George D. Neal

Position

Superintendent

Company

The Eastland Oil Company

Date

August 29, 1978

I hereby certify that the well location shown on this plat was plotted from field notes of actual surveys made by me or under my supervision, and that the same is true and correct to the best of my knowledge and belief.

Date Surveyed

August 25, 1978

Registered Professional Engineer and/or Land Surveyor

John W. West

Certificate No. **John W. West 676**

Ronald J. Eidson 3239

