

**MEXICO OIL CONSERVATION COMMISSION IN
WELL LOCATION AND ACREAGE DEDICATION PLAT**

Form C-102
Supersedes C-128
Effective 1-1-65

All distances must be from the outer boundaries of the Section

Operator Amoco Production Company			Lease Teledyne "20" Gas Com		Well No. 1
Tract Letter C	Section 20	Township 23 South	Range 29 East	County Eddy	
Actual Footage Location of Well: 660 feet from the North line and 2080 feet from the West line					
Ground Level Elev. 2963.3	Producing Formation Morrow	Pool Und. Morrow		Dedicated Acreage: 320 Acres	

1. Outline the acreage dedicated to the subject well by colored pencil or hachure marks on the plat below.
2. If more than one lease is dedicated to the well, outline each and identify the ownership thereof (both as to working interest and royalty).
3. If more than one lease of different ownership is dedicated to the well, have the interests of all owners been consolidated by communitization, unitization, force-pooling, etc?

☐ Yes ☐ No If answer is "yes," type of consolidation **Communitization**

If answer is "no," list the owners and tract descriptions which have actually been consolidated. (Use reverse side of this form if necessary.) _____

No allowable will be assigned to the well until all interests have been consolidated (by communitization, unitization, forced-pooling, or otherwise) or until a non-standard unit, eliminating such interests, has been approved by the Commission.

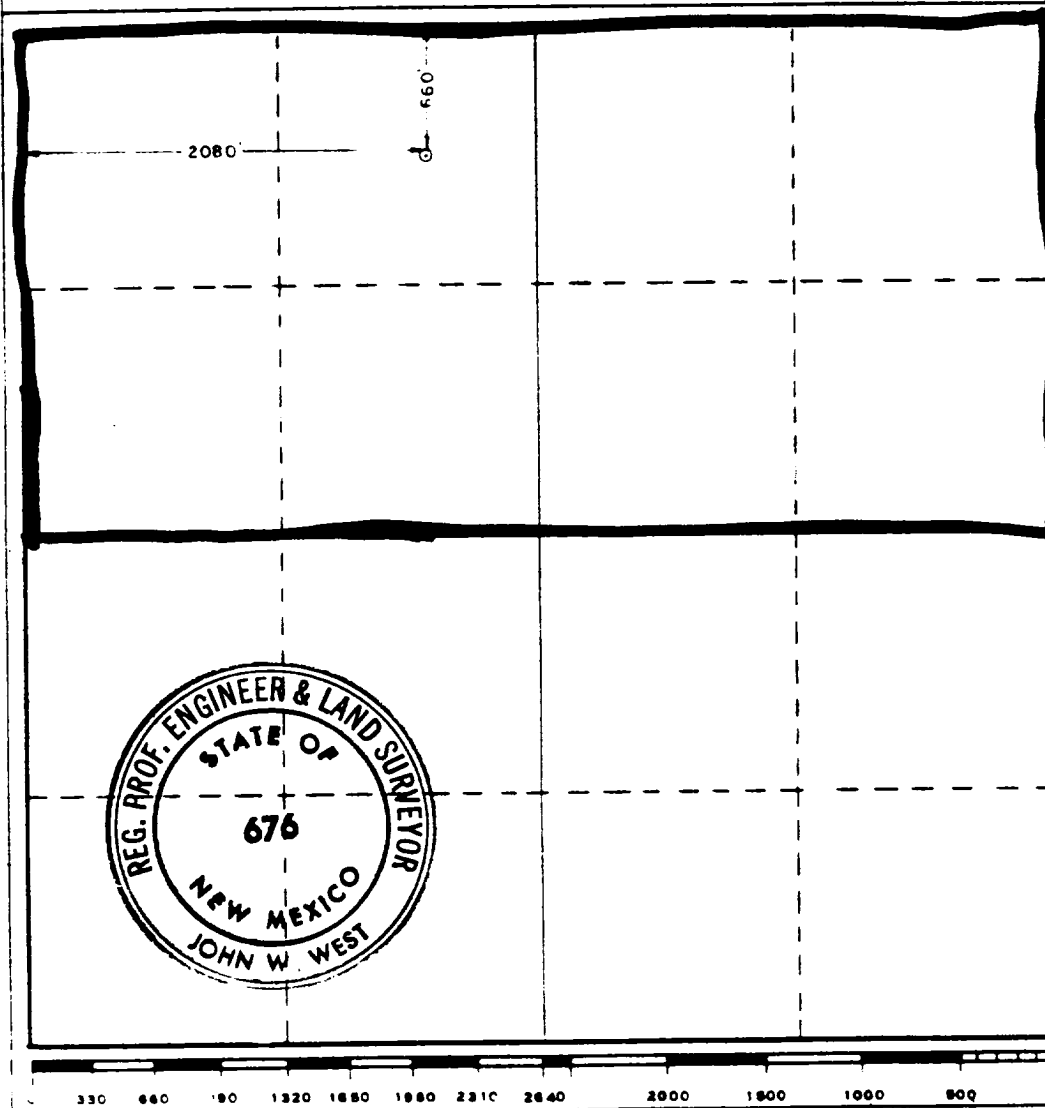

CERTIFICATION

I hereby certify that the information contained herein is true and complete to the best of my knowledge and belief.

Name **H. J. Bensen**
 Position **Stf. Admin. Analyst**
 Company **Amoco Production Company**
 Date **July 6, 1992**

I hereby certify that the well location shown on this plat was plotted from field notes of actual surveys made by me or under my supervision, and that the same is true and correct to the best of my knowledge and belief.

Date Surveyed **November 18, 1978**
 Registered Professional Engineer and/or Land Surveyor
John W. West
 Certificate No. **John W. West 676**
Ronald J. Eldson 3239