

for HNG OIL COMPANY Lease WILLIAMS COM. 38 Well No. 1
Letter C Section 35 Township 23 S Range 28 E County EDDY

Footage Location of Well: 660 feet from the NORTH line and 2310 feet from the WEST line
Dedicated Acreage: 320 Acres
Producing Formation: Morrow Pool: *and. Malaga morrow*
d Level Elev. 3016'

Outline the acreage dedicated to the subject well by colored pencil or hachure marks on the plat below.
If more than one lease is dedicated to the well, outline each and identify the ownership thereof (both as to working interest and royalty).
If more than one lease of different ownership is dedicated to the well, have the interests of all owners been consolidated by communitization, unitization, force-pooling, etc?
☒ Yes ☒ No If answer is "yes," type of consolidation TO BE ed Force-Pooling
If answer is "no," list the owners and tract descriptions which have actually been consolidated. (Use reverse side of this form if necessary.)
No allowable will be assigned to the well until all interests have been consolidated (by communitization, unitization, forced-pooling, or otherwise) or until a non-standard unit, eliminating such interests, has been approved by the Commission.

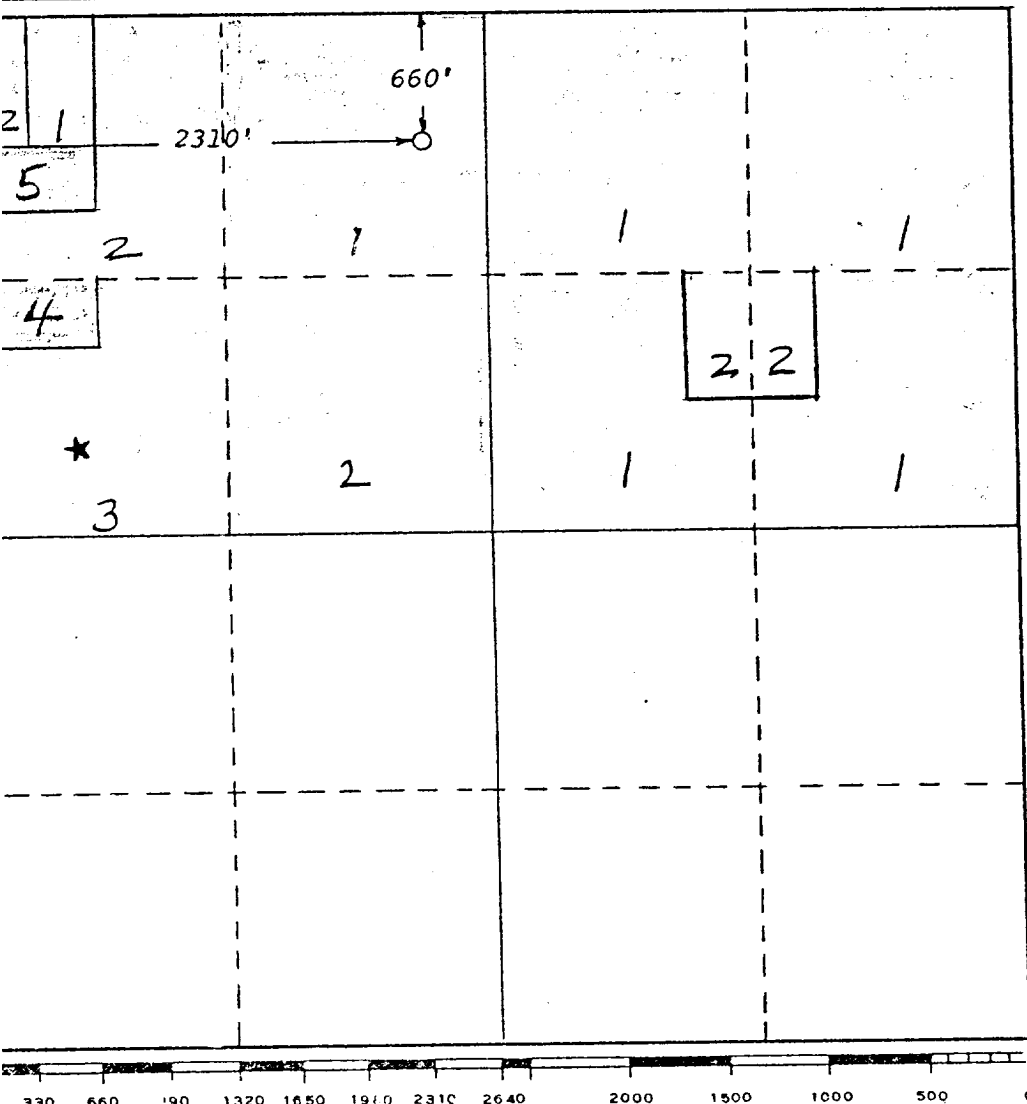

CERTIFICATION
I hereby certify that the information contained herein is true and complete to the best of my knowledge and belief.
Name: *Betty A. Gildon*
Betty A. Gildon
Position: Regulatory Clerk
Company: HNG Oil Company
Date: December 12, 1978
I hereby certify that the well location shown on this plat was plotted from field notes of actual surveys made by me or under my supervision, and that the same is true and correct to the best of my knowledge and belief.
GARY D. BOSWELL
Date Surveyed: 12-24-78
No. 6689
Registered Professional Engineer and/or Land Surveyor
Certificate No. 6689

Thomas B. Elliott Dispatching