

NEW MEXICO OIL CONSERVATION COMMISSION
WELL LOCATION AND ACREAGE DEDICATION PLAT

Form C-102
Supersedes C-128
Effective 1-1-65

All distances must be from the outer boundaries of the Section.

Operator HNG OIL COMPANY		Lease WILLIAMS 35 COM.		Well No. 1
Unit Letter C	Section 35	Township 23 S	Range 28 E	County EDDY
Actual Portage Location of Well:				
660 feet from the NORTH		line and 2310		feet from the WEST
Ground Level Elev. 3016'	Producing Formation Atoka	Pool land South Culebra Bluff	Dedicated Acreage: 320 Acres	

1. Outline the acreage dedicated to the subject well by colored pencil or hachure marks on the plat below.
2. If more than one lease is dedicated to the well, outline each and identify the ownership thereof (both as to working interest and royalty).
3. If more than one lease of different ownership is dedicated to the well, have the interests of all owners been consolidated by communitization, unitization, force-pooling, etc?

☐ Yes ☒ No If answer is "yes," type of consolidation To be force-pooled

If answer is "no," list the owners and tract descriptions which have actually been consolidated. (Use reverse side of this form if necessary.)

No allowable will be assigned to the well until all interests have been consolidated (by communitization, unitization, forced-pooling, or otherwise) or until a non-standard unit, eliminating such interests, has been approved by the Commission.

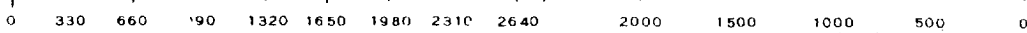
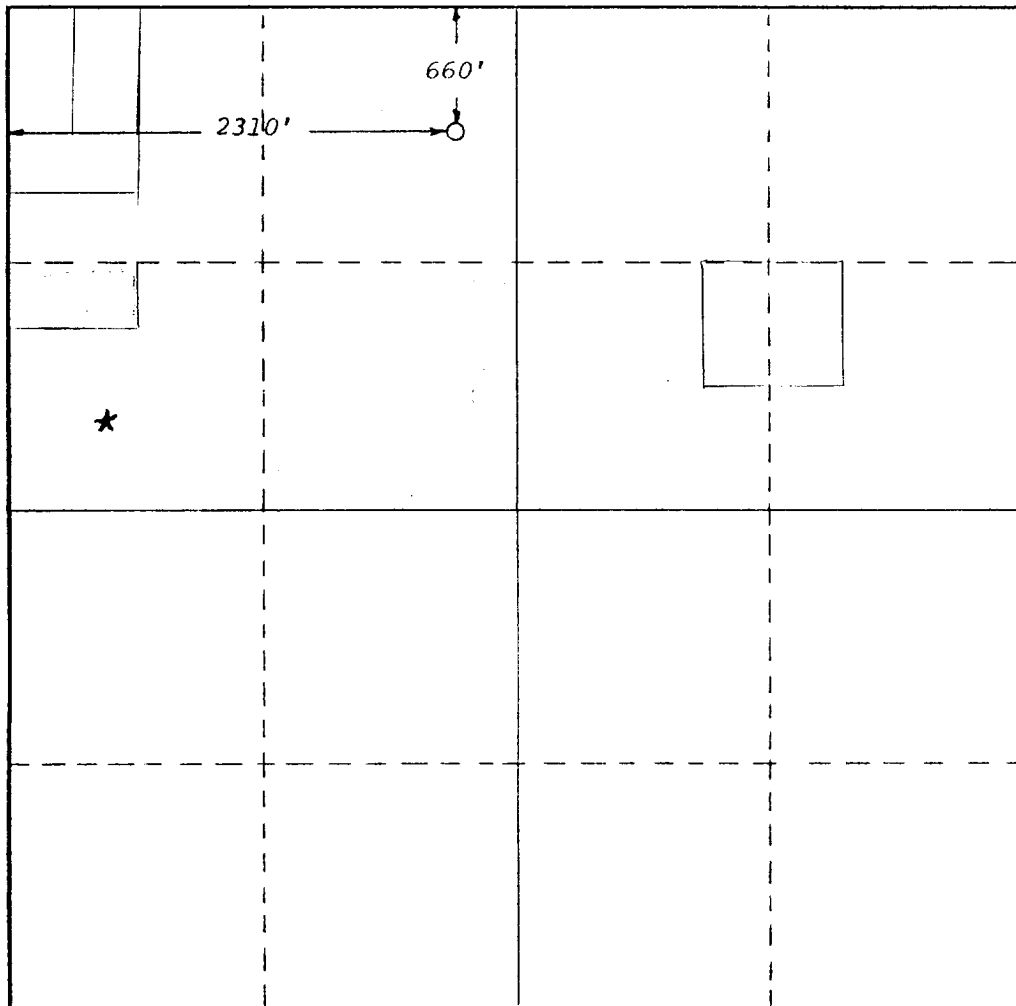

RECEIVED

APR 17 1979

CERTIFICATION

O. C. C.

I hereby certify that the information contained herein is true and complete to the best of my knowledge and belief.

Betty A. Gildon

Name

Betty A. Gildon

Position

Regulatory Clerk

Company

HNG Oil Company

Date

April 11, 1979

I hereby certify that the well location shown on this plat was plotted from field notes of actual surveys made by me or under my supervision, and that the same is true and correct to the best of my knowledge and belief.

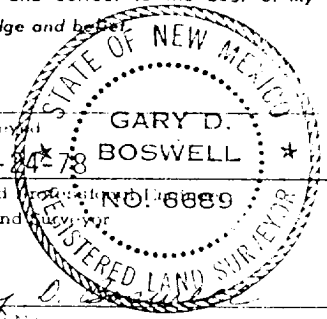

Date Surveyed

11-24-78

Registered Professional Engineer and/or Land Surveyor

Gary D. Boswell
Certified by

6639