

Submit to Appropriate  
District Office  
State Lease - 6 copies  
Fee Lease - 5 copies

State of New Mexico  
Energy, Minerals and Natural Resources Department

Form C-101  
Revised 1-1-89

OIL CONSERVATION DIVISION

RECEIVED

MAY -2 '90

DISTRICT I  
P.O. Box 1980, Hobbs, NM 88240

DISTRICT II  
P.O. Drawer DD, Artesia, NM 88210

DISTRICT III  
1000 Rio Brazos Rd., Aztec, NM 87410

P.O. Box 2088  
Santa Fe, New Mexico 87504-2088

API NO. (assigned by OCD on New Wells)

5. Indicate Type of Lease

STATE ☐

FEE ☒

6. State Oil & Gas Lease No.

APPLICATION FOR PERMIT TO DRILL, DEEPEN, OR PLUG BACK

1a. Type of Work:

DRILL ☐

RE-ENTER ☐

DEEPEN ☐

PLUG BACK ☒

b. Type of Well:

OIL  
WELL ☒

GAS  
WELL ☐

OTHER ☐

SINGLE  
ZONE ☒

MULTIPLE  
ZONE ☐

7. Lease Name or Unit Agreement Name

South Culebra Bluff

2. Name of Operator

RB Operating Company

8. Well No.

4

3. Address of Operator

2412 N. Grandview, Suite 201, Odessa, Texas 79761

9. Pool name or Wildcat

South Culebra Bluff (Delaware)

4. Well Location

Unit Letter A : 660 Feet From The North Line and 560 Feet From The East Line

Section 23

Township 23S

Range 28E

NMPM Eddy

County

10. Proposed Depth

6300'

11. Formation

Delaware

12. Rotary or C.T.

13. Elevations (Show whether DF, RT, GR, etc.)

2987.1 GR

14. Kind & Status Plug. Bond

Blanket

15. Drilling Contractor

16. Approx. Date Work will start

17. PROPOSED CASING AND CEMENT PROGRAM

SIZE OF HOLE	SIZE OF CASING	WEIGHT PER FOOT	SETTING DEPTH	SACKS OF CEMENT	EST. TOP
17 1/2	13 3/8		440	550	Surface
12 1/4	7 5/8		6185	6200	
6 1/2	4 1/2		9800	475	

1. Set CIBP @ 6300' with 2 sacks cement on top.
2. Perforate 6183, 89, 6200, 16, 18, 21, 22, 43, & 44.
3. Swab Test and evaluate.
4. Acidize and frac as needed.

APPROVAL VALID FOR 180 DAYS  
PERMIT EXPIRES 11/16/90  
UNLESS DRILLING UNDERWAY

IN ABOVE SPACE DESCRIBE PROPOSED PROGRAM: IF PROPOSAL IS TO DEEPEN OR PLUG BACK, GIVE DATA ON PRESENT PRODUCTIVE ZONE AND PROPOSED NEW PRODUCTIVE ZONE. GIVE BLOWOUT PREVENTER PROGRAM, IF ANY.

I hereby certify that the information above is true and complete to the best of my knowledge and belief.

SIGNATURE

TITLE Area Manager

DATE 4/24/90

TYPE OR PRINT NAME F.D. Schoch

(915)

TELEPHONE NO. 362-6302

(This space for State Use)

ORIGINAL SIGNED BY  
MIKE WILLIAMS

CONSERVATION, DISTRICT IV

APPROVED BY

TITLE

DATE

CONDITIONS OF APPROVAL, IF ANY:

MAY 16 1990

NEW MEXICO OIL CONSERVATION COMMISSION  
WELL LOCATION AND ACREAGE DEDICATION PLAT

Form C-102  
Supersedes C-128  
Effective 1-1-65

All distances must be from the outer boundaries of the Section

Operator RB Operating Company		Lease South Culebra Bluff		Well No. 54	
Tract Letter A	Section 23	Township 23 South	Range 28 East	County Eddy	
Actual Footage Location of Well: 660 feet from the North line and 560 feet from the East line					
Ground Level Elev. 2987.1	Producing Formation		Pool South Culebra Bluff (Delaware)	Dedicated Acreage: 40 Acres	

1. Outline the acreage dedicated to the subject well by colored pencil or hatchure marks on the plat below.
2. If more than one lease is dedicated to the well, outline each and identify the ownership thereof (both as to working interest and royalty).
3. If more than one lease of different ownership is dedicated to the well, have the interests of all owners been consolidated by communitization, unitization, force-pooling, etc?

☐ Yes ☐ No If answer is "yes," type of consolidation \_\_\_\_\_

If answer is "no," list the owners and tract descriptions which have actually been consolidated. (Use reverse side of this form if necessary.) \_\_\_\_\_

No allowable will be assigned to the well until all interests have been consolidated (by communitization, unitization, forced-pooling, or otherwise) or until a non-standard unit, eliminating such interests, has been approved by the Commission.

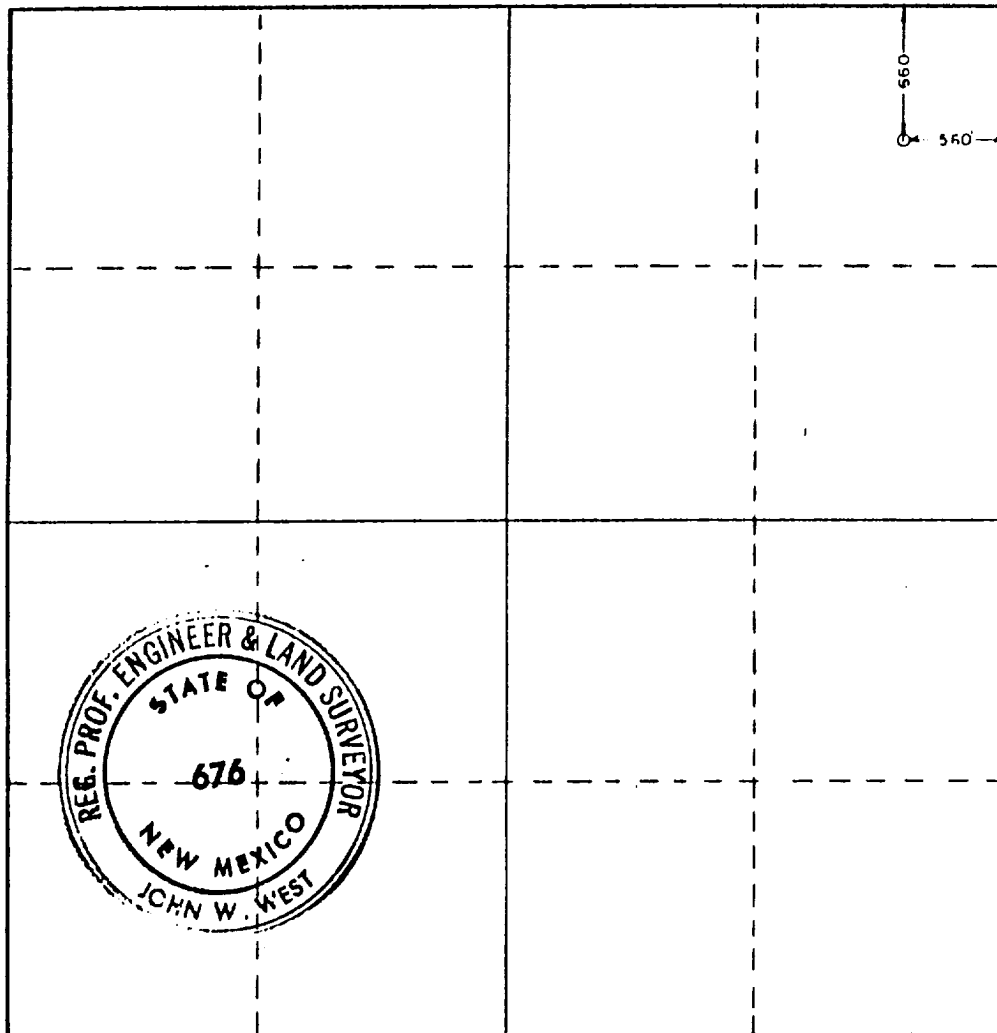

CERTIFICATION

I hereby certify that the information contained herein is true and complete to the best of my knowledge and belief.

Name

E.D. Schoch

Position

Area Manager

Company

RB Operating Company

Date

4/24/90

I hereby certify that the well location shown on this plat was plotted from field notes of actual surveys made by me or under my supervision, and that the same is true and correct to the best of my knowledge and belief.

Date Surveyed

April 18, 1990

Registered Professional Engineer  
and/or Land Surveyor

*John W. West*

Certificate No. John W. West

676

Ronald J. Eldon

3239