

UNITED STATES
DEPARTMENT OF THE INTERIOR
GEOLOGICAL SURVEY

MAY 15 1980

30-015-23323

O. C. D.

APPLICATION FOR PERMIT TO DRILL, DEEPEN, OR PLUG BACK

1a. TYPE OF WORK

DRILL ☒DEEPEN ☐PLUG BACK ☐

b. TYPE OF WELL

OIL
WELL ☒GAS
WELL ☐

OTHER

SINGLE
ZONE ☒MULTIPLE
ZONE ☐

2. NAME OF OPERATOR

Cities Service Company

3. ADDRESS OF OPERATOR

Box 1919 Midland, TX 79702

4. LOCATION OF WELL (Report location clearly and in accordance with any State requirements.)*

At surface 1980' FSL, 330 FWL of Section 24, Township
23S, Range 23E, Eddy County, NM
At proposed prod. zone
same as above

14. DISTANCE IN MILES AND DIRECTION FROM NEAREST TOWN OR POST OFFICE*

30 miles SW of Carlsbad, NM

15. DISTANCE FROM PROPOSED*

LOCATION TO NEAREST
PROPERTY OR LEASE LINE, FT.
(Also to nearest drlg. unit line, if any)

330'

18. DISTANCE FROM PROPOSED LOCATION*
TO NEAREST WELL, DRILLING COMPLETED,
OR APPLIED FOR, ON THIS LEASE, FT.

16. NO. OF ACRES IN LEASE

320

19. PROPOSED DEPTH

1100'

17. NO. OF ACRES ASSIGNED
TO THIS WELL

40

20. ROTARY OR CABLE TOOLS

Rotary

21. ELEVATIONS (Show whether DF, RT, GR, etc.)

4106.6 GR

22. APPROX. DATE WORK WILL START*

June 25, 1980

23.

PROPOSED CASING AND CEMENTING PROGRAM

SIZE OF HOLE	SIZE OF CASING	WEIGHT PER FOOT	SETTING DEPTH	QUANTITY OF CEMENT
9-7/8"	7" OD	20	300'	Circulate w/200 sx
6 1/4"	4 1/2" OD	9.5	1100'	Circulate w/200 sx

It is proposed to drill to a total depth of 1100' to test the San Andres formation. The blow out prevention program is as follows:

1. one set of blind rams.
2. one set of drill pipe rams.

The acreage assigned to this well is not dedicated to any gas gatherer.

RECEIVED

APR 16 1980

U.S. GEOLOGICAL SURVEY
ARTESIA, NEW MEXICO

IN ABOVE SPACE DESCRIBE PROPOSED PROGRAM: If proposal is to deepen or plug back, give data on present productive zone and proposed new productive zone. If proposal is to drill or deepen directionally, give pertinent data on subsurface locations and measured and true vertical depths. Give blowout preventer program, if any.

24.

SIGNED

TITLE Region Oper. Mgr.

DATE 4/17/80

(This space for Federal or State office use)

PERMIT NO.

APPROVAL DATE

5-14-80

APPROVED BY

TITLE

DATE

CONDITIONS OF APPROVAL, IF ANY:

*See Instructions On Reverse Side

Instructions

General: This form is designed for submitting proposals to perform certain well operations, as indicated, on all types of lands and leases for appropriate action by either a Federal or a State agency, or both, pursuant to applicable Federal and/or State laws and regulations. Any necessary special instructions concerning the use of this form and the number of copies to be submitted, particularly with regard to local, area, or regional procedures and practices, either are shown below or will be issued by, or may be obtained from, the local Federal and/or State office.

Item 1: If the proposal is to redrill to the same reservoir at a different subsurface location or to a new reservoir, use this form with appropriate notations. Consult applicable State or Federal regulations concerning subsequent work proposals or reports on the well.

Item 4: If there are no applicable State requirements, locations on Federal or Indian land should be described in accordance with Federal requirements. Consult local State or Federal office for specific instructions.

Item 14: Needed only when location of well cannot readily be found by road from the land or lease description. A plat, or plats, separate or on this reverse side, showing the roads to, and the surveyed location of, the well, and any other required information, should be furnished when required by Federal or State agency offices.

Items 15 and 18: If well is to be, or has been directionally drilled, give distances for subsurface location of hole in any present or objective production zone.

Item 22: Consult applicable Federal or State regulations, or appropriate officials, concerning approval of the proposal before operations are started.

**NEW MEXICO OIL CONSERVATION COMMISSION
WELL LOCATION AND ACREAGE DEDICATION PLAT**

Form C-102
Supersedes C-128
Effective 1-4-65

All distances must be from the outer boundaries of the Section

Operator Cities Service Co.			Lease Federal F		Well No. 1
Unit Letter L	Section 24	Township 23 South	Range 23 East	County Eddy	
Actual Footage Location of Well: <div style="display: flex; justify-content: space-between;"> 1980 feet from the South line and 330 feet from the West line </div>					
Ground Level Elev. 4106.6	Producing Formation Wildcat	Pool Wildcat SF	Dedicated Acreage: 320-40 Acres		

1. Outline the acreage dedicated to the subject well by colored pencil or hachure marks on the plat below.
2. If more than one lease is dedicated to the well, outline each and identify the ownership thereof (both as to working interest and royalty).
3. If more than one lease of different ownership is dedicated to the well, have the interests of all owners been consolidated by communitization, unitization, force-pooling, etc?

☐ Yes ☐ No If answer is "yes," type of consolidation _____

If answer is "no," list the owners and tract descriptions which have actually been consolidated. (Use reverse side of this form if necessary.) _____

No allowable will be assigned to the well until all interests have been consolidated (by communitization, unitization, forced-pooling, or otherwise) or until a non-standard unit, eliminating such interests, has been approved by the Commission.

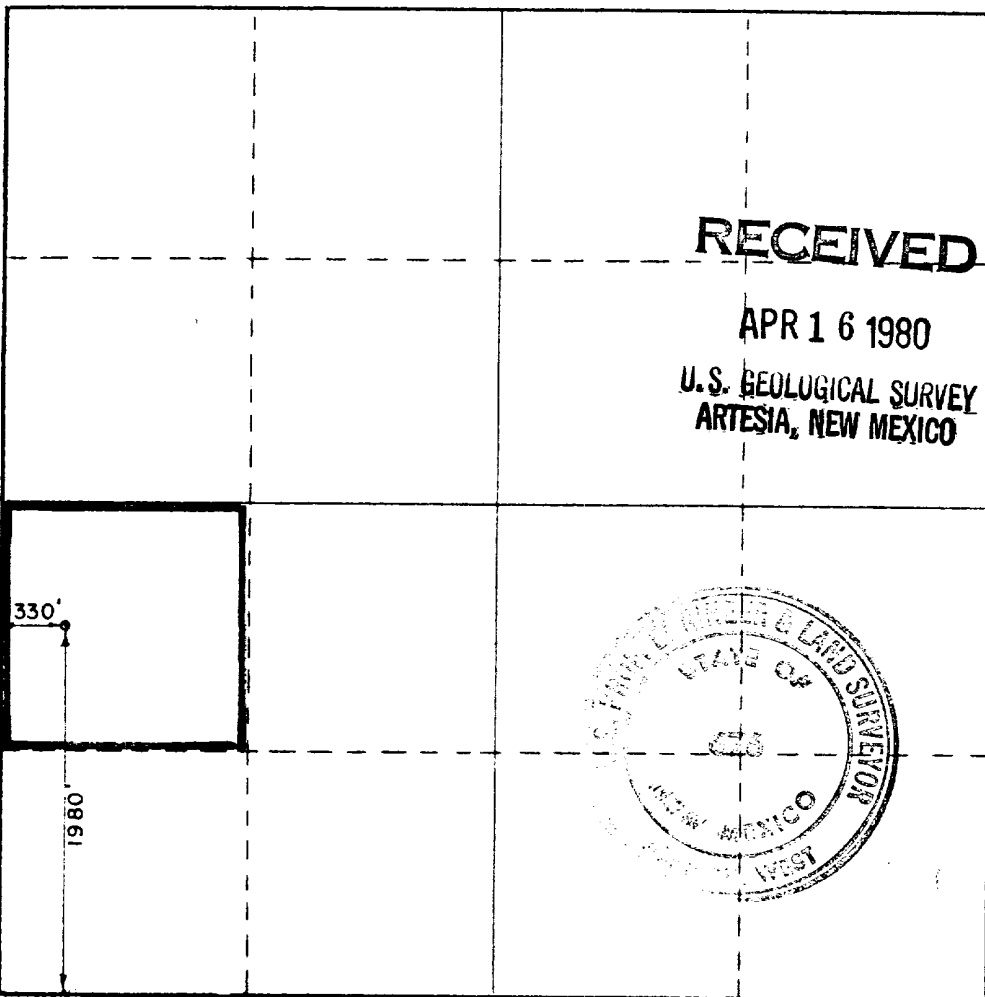

CERTIFICATION

I hereby certify that the information contained herein is true and complete to the best of my knowledge and belief.

Name *Spindler*
 Position Region Oper. Mgr.
 Company Cities Service Co.
 Date 4/17/80

I hereby certify that the well location shown on this plat was plotted from field notes of actual surveys made by me or under my supervision, and that the same is true and correct to the best of my knowledge and belief.

Date Surveyed 4-3-1980
 Registered Professional Engineer and/or Land Surveyor

John W. West
 Certificate No. **JOHN W. WEST 676**
PATRICK A. ROMERO 6663
Ronald J. Eidson 3239





N.M.O.C.D. COPY

United States Department of the Interior

MAY 15 1980

GEOLOGICAL SURVEY

P. O. Drawer U
Artesia, New Mexico 88210

O. C. D.
ARTESIA, OFFICE

May 14, 1980

Cities Service Company
P. O. Box 1919
Midland, Texas 79702

Gentlemen:

CITIES SERVICE COMPANY Federal F No. 1 1980 FSL 330 FWL Sec. 24 T.23S R.23E Eddy County Lease No. NM-11951

Above Data Required on Well Sign

Your APPLICATION FOR PERMIT TO DRILL the above-described well to a depth of 1,100 feet to test the San Andres formation is hereby approved subject to compliance with the OIL AND GAS OPERATING REGULATIONS (30 CFR 221) and the following conditions:

1. Drilling operations authorized are subject to compliance with the GENERAL REQUIREMENTS FOR OIL AND GAS OPERATIONS ON FEDERAL LEASES, dated July 1, 1978.
2. Prior to commencing construction of road, pad, or other associated developments, operator will provide the dirt contractor with a copy of the SURFACE USE PLAN and this approval including the GENERAL REQUIREMENTS.
3. All access roads will be limited to a 12 foot wide driving surface, excluding turnarounds. Surface disturbance associated with road construction will be limited to 20 feet in width.
4. Submit a Daily Report of Operations from spud date until the Well Completion Report (form 9-330) is filed. The progress report should be not less than 8" x 5" in size and each page should identify the well.
5. All permanent above-ground structures and equipment shall be painted in accordance with the attached Painting Requirements. The color used should simulate Sandstone Brown (Federal Standard No. 595A, color 20318 or 30318).
6. Notify the Survey by telephone 24 hours prior to spudding well.
7. Cement behind the 7" and 4-1/2" casing must be circulated.
8. Notify Survey in sufficient time to witness the cementing of the 4-1/2" casing.

9. Special Stipulations:

- a. Access road will be constructed as illustrated on attached map.
 - b. Low water crossings will be constructed at locations illustrated on attached map. Crossings will be constructed along existing stream contours and will not impede water flow.
10. Please have anyone contacting the Survey in regard to this well to identify the well with all of the information required above for the well sign.

Sincerely yours,

(Orig. Sgd.) GEORGE H. STEWART

George H. Stewart
Acting District Engineer

BLOWOUT PREVENTER DIAGRAM
3000# W.P.

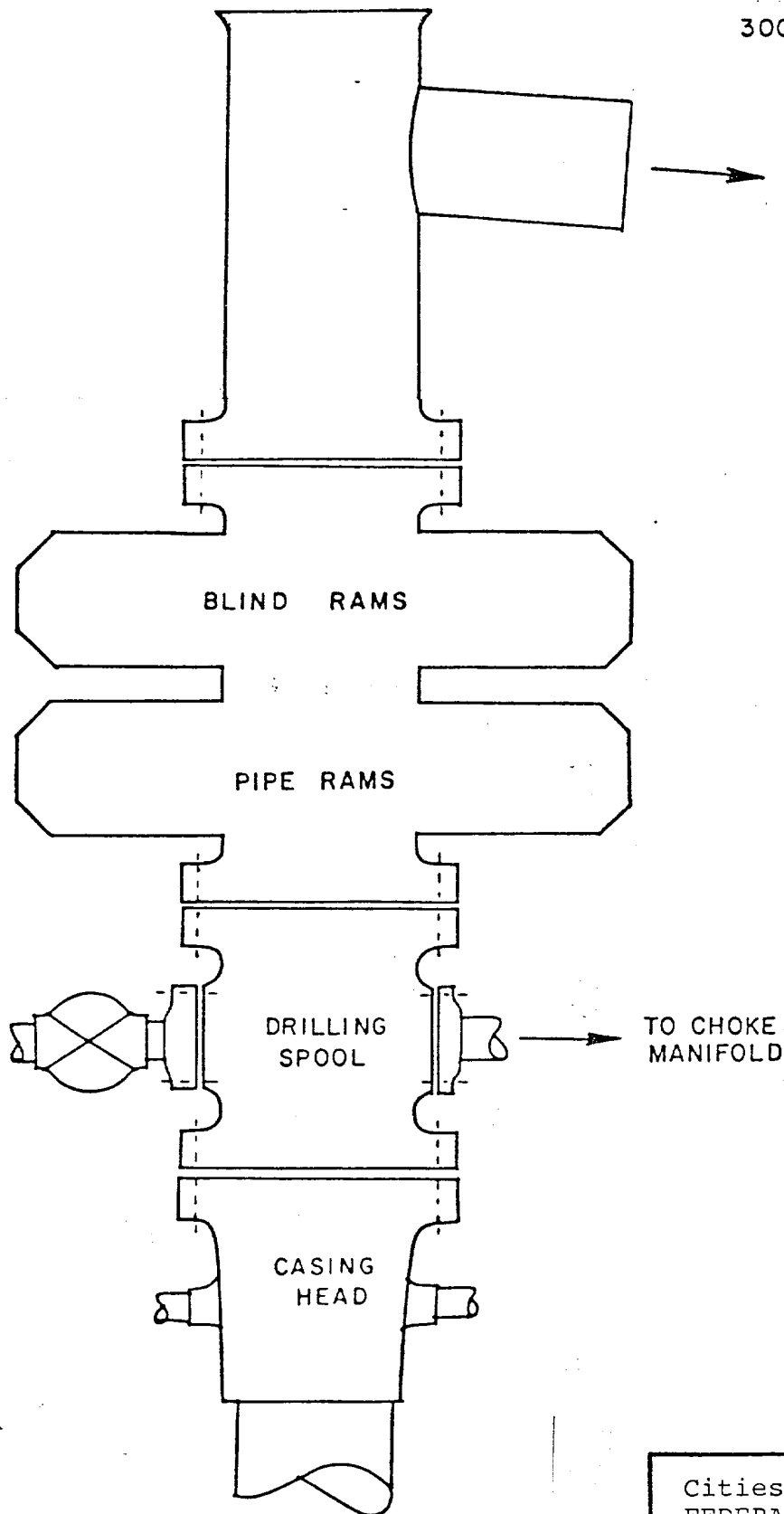

Cities Service Co.'s
FEDERAL "F" NO. 1
1980' FSL & 330' FWL
Section 24-23S-23E
Eddy County, New Mexico
Lse #NM-11951



CITIES SERVICE COMPANY
ENERGY RESOURCES GROUP

Box 1919
Midland, Texas 79702
(915) 684-7131

April 14 1980
RECEIVED

APR 16 1980

**U.S. GEOLOGICAL SURVEY
ARTESIA, NEW MEXICO**

United States Department of the Interior
Geological Survey
P. O. Drawer "U"
Artesia, New Mexico 88210

RE: Application for Permit to Drill
Federal "F" No. 1
Eddy County, New Mexico

Gentlemen:

Cities Service Company respectfully requests permission to drill the Federal "F" No. 1, located 1980' FSL and 330' FWL, Section 24-23S-23E, Eddy County, New Mexico, Lease No. NM-11951.

The location, work area and access road have been staked. It is approximately 30 miles southwest of Carlsbad, New Mexico in the Bandana Point Area.

In accordance with the requirements stipulated in NTL-6 of the National Environmental Policy Act, our Application for Permit to Drill and supporting evidence is hereby submitted:

1. Form 9-331C, Application for Permit to Drill.
2. Form C-102, Well Location and Acreage Dedication Plat certified by John W. West, Registered Land Surveyor #676 in the State of New Mexico.
3. The elevation of the unprepared ground is 4106.6 feet above sea level.
4. The geologic name of the surface formation is Permian Queen.
5. Rotary drilling equipment will be utilized to drill the well to TD 1100' and run casing. This equipment will then be rigged down and the well will be completed with a pulling unit.
6. Proposed total depth is 1100 feet.

7. Estimated tops of important geologic markers:

Permian Queen	Surface
San Andres	800'
San Andres Porosity	1070'
TD	1100'

8. Estimated depths at which anticipated water, oil, gas or other mineral bearing formations are expected to be encountered:

A. Primary objective San Andres Porosity 1070'.

9. The proposed casing program is as follows:

Surface: 7" OD 20# H40 ST&C new casing
Production: 4-1/2" OD 9.5# H40 ST&C new casing

10. Casing setting depth and cementing program:

A. 7" OD surface set at 300'. Circulate cement with 200 sacks Class "C" with 2% CaCl.

B. 4-1/2" OD production string set at 1100'. Circulate cement with 200 sacks Class "C" with 2% CaCl.

11. Pressure Control Equipment.

0 - 300' None

300 - 1100' 8" 3000# ram type preventers with one set blind rams and one set pipe rams (manual operation).

The kelly will be equipped with a kelly cock, and a drill string safety valve in the open position will be available on the rig floor.

12. Mud Program

0 - 300' Fresh water spud mud with LCM if needed

300 - 1100' Fresh water with LCM for seepage. Prior to drilling the San Andres porosity and running 4-1/2" production casing add gel to increase viscosity to 35-40 seconds.

13. Testing, Logging and Coring Program
 - A. Testing Program: None
 - B. Mud Logging Program: None
 - C. Electric Logging Program:
 - 1) GR/Cal CNL-FDC
 - 2) DLL-MSFL (Schlumberger Logs)
 - D. Coring Program: None
14. No abnormal temperature, pressure or H₂S gas is anticipated.
15. Anticipated starting date: June 25, 1980
16. The Multi-Point Surface Use and Operations Plan for submission to the Bureau of Land Management is attached.
17. If the District Engineer needs further information to evaluate this proposal, please advise.

Yours Very truly,



E. Y. Wilder
Region Operations Manager
Southwest Region
E & P Division

EYW:bak

attachments

NEW MEXICO
(EDDY COUNTY)
BANDANNA POINT QUADRANGLE
15-MINUTE SERIES

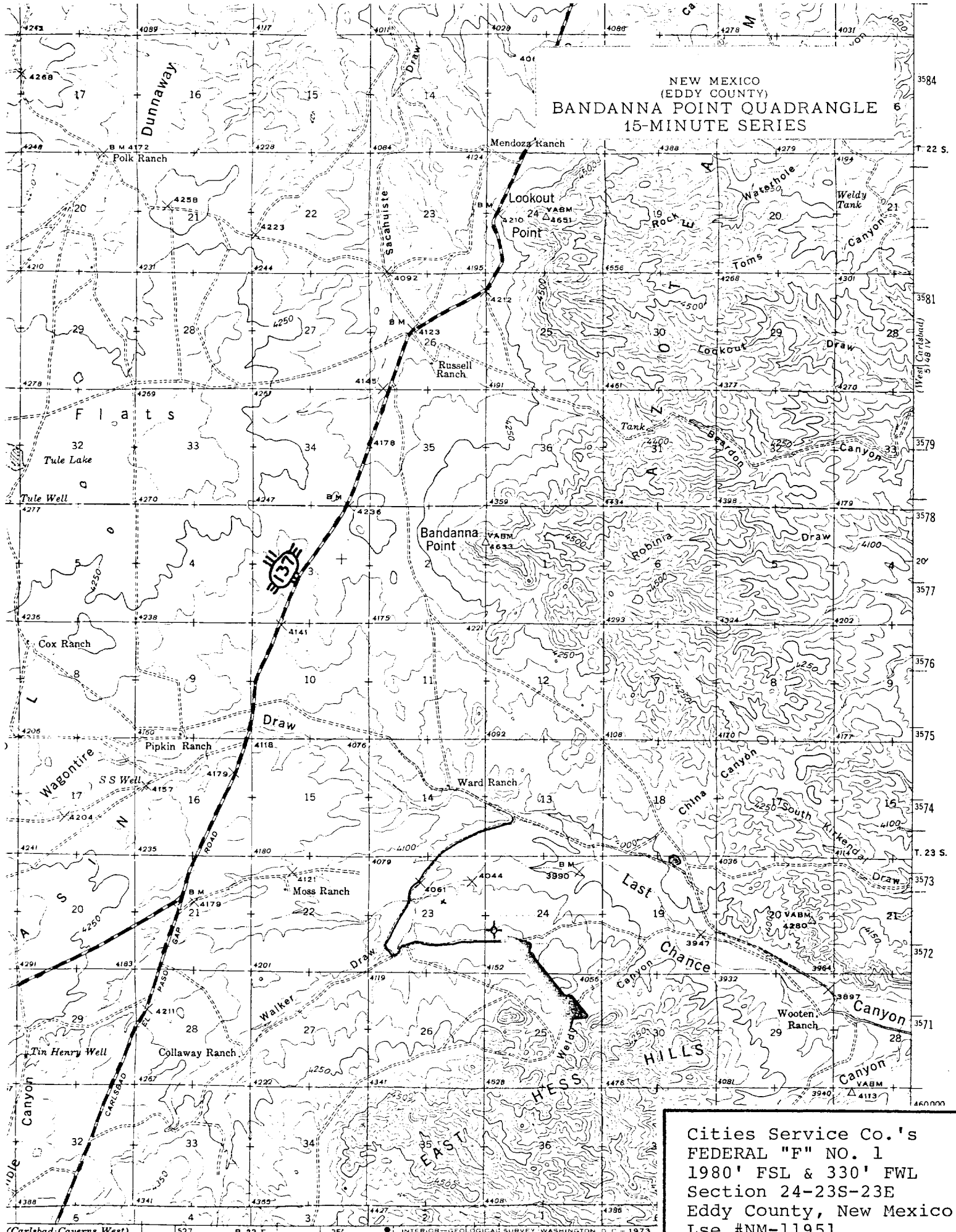

Cities Service Co.'s
FEDERAL "F" NO. 1
1980' FSL & 330' FWL
Section 24-23S-23E
Eddy County, New Mexico
Lse #NM-11951

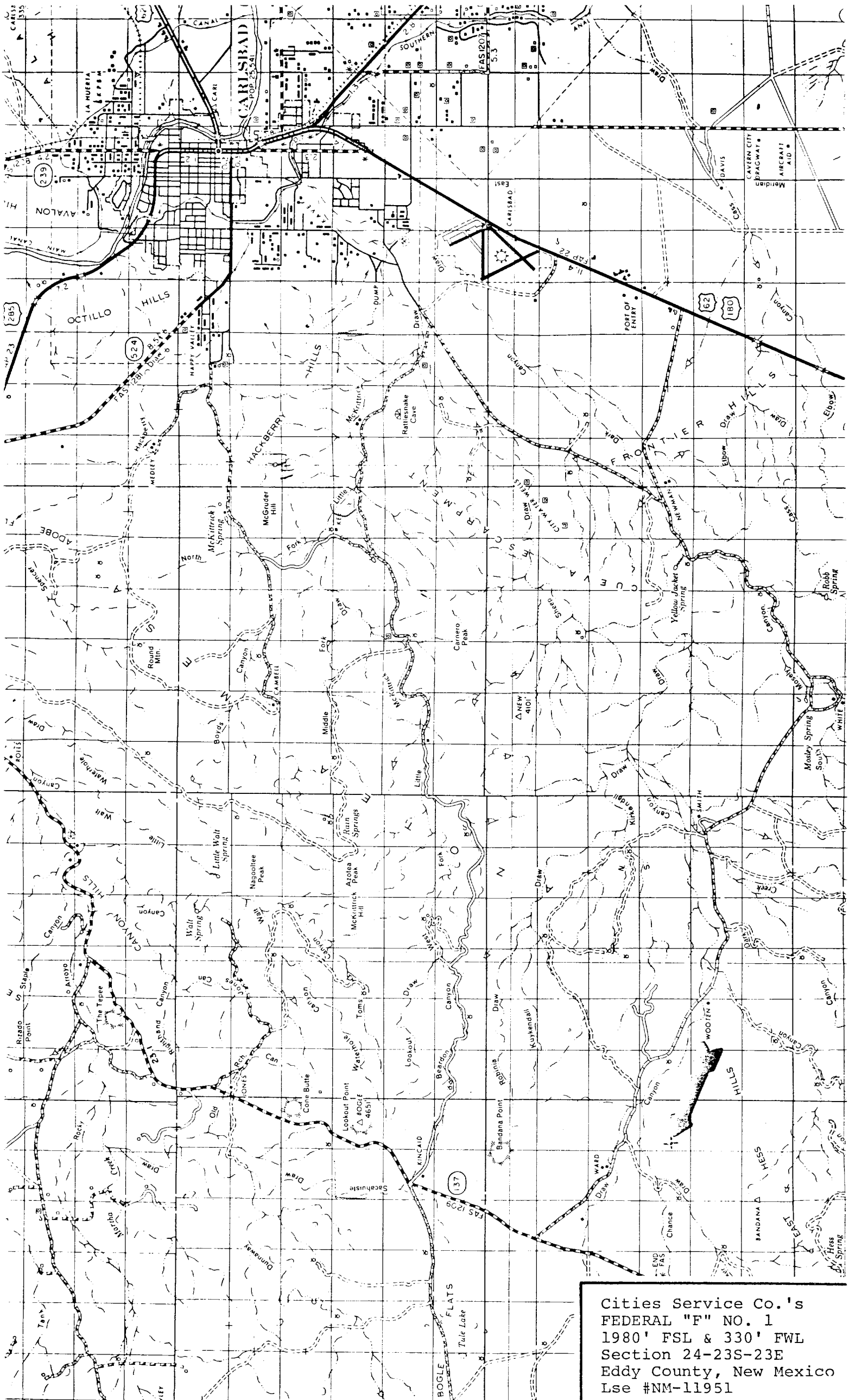

Cities Service Co.'s
FEDERAL "F" NO. 1
1980' FSL & 330' FWL
Section 24-23S-23E
Eddy County, New Mexico
Lse #NM-11951