

NEW MEXICO OIL CONSERVATION COMMISSION
WELL LOCATION AND ACREAGE DEDICATION PLAT

Form C-102
Supersedes C-128
Effective 1-1-65

All distances must be from the outer boundaries of the Section.

Operator Yates Petroleum Corporation		Lease Lechuguilla Canyon Unit		Well No. 8
Unit Letter K	Section 10	Township 24 South	Range 24 East	County Eddy
Actual Footage Location of Well: 2180 feet from the South line and 1905 feet from the West line				
Ground Level Elev. 4177	Producing Formation MORROW	Pool WUDCAT	Dedicated Acreage: 320 Acres	

1. Outline the acreage dedicated to the subject well by colored pencil or hachure marks on the plat below.
2. If more than one lease is dedicated to the well, outline each and identify the ownership thereof (both as to working interest and royalty).
3. If more than one lease of different ownership is dedicated to the well, have the interests of all owners been consolidated by communitization, unitization, force-pooling, etc?

☒ Yes ☐ No If answer is "yes," type of consolidation UNITIZATION

If answer is "no," list the owners and tract descriptions which have actually been consolidated. (Use reverse side of this form if necessary.)

No allowable will be assigned to the well until all interests have been consolidated (by communitization, unitization, forced-pooling, or otherwise) or until a non-standard unit, eliminating such interests, has been approved by the Commission.

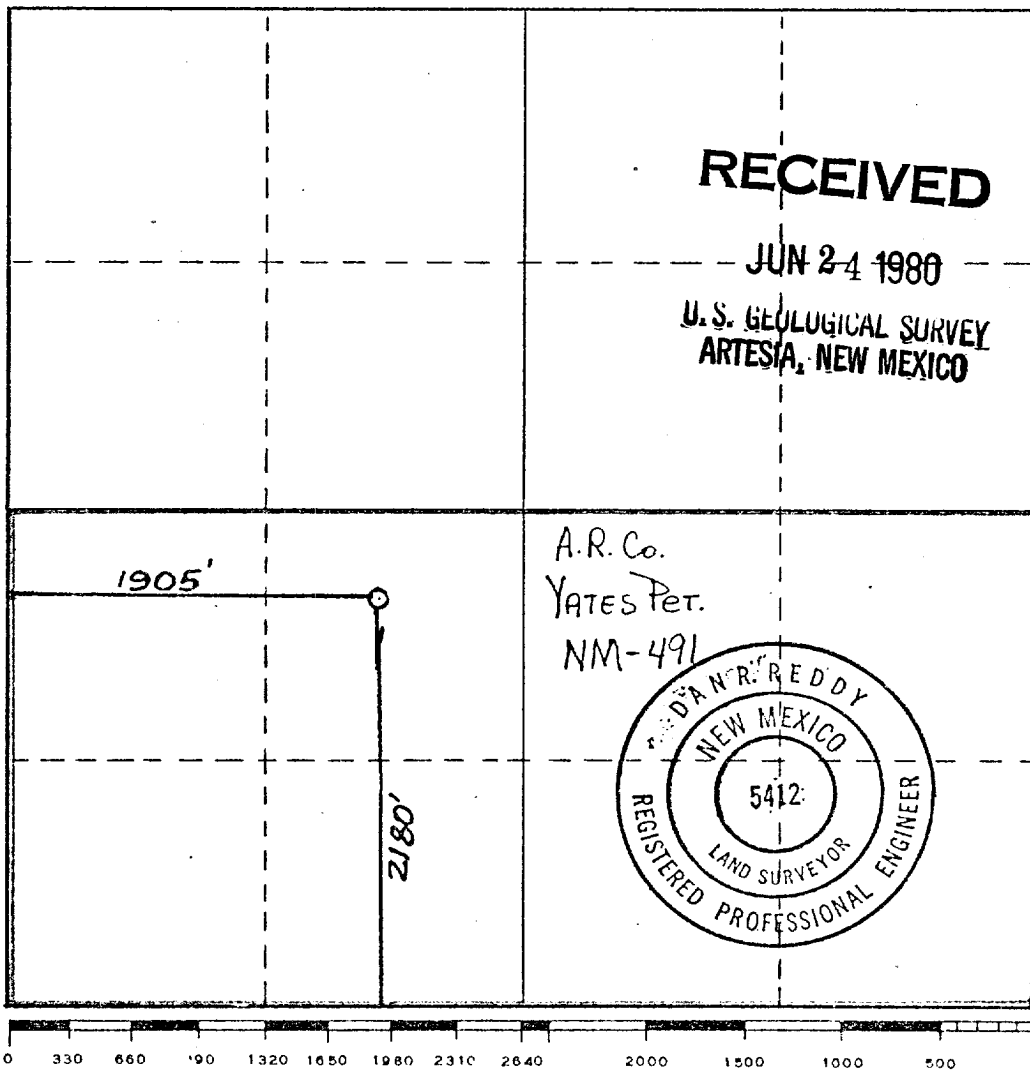

CERTIFICATION

I hereby certify that the information contained herein is true and complete to the best of my knowledge and belief.

John A. Lopez
Name
JOHANNY A. LOPEZ
Position
REGULATORY COORDINATOR
Company
YATES PETROLEUM CORPORATION
Date
6-24-80

I hereby certify that the well location shown on this plat was plotted from field notes of actual surveys made by me or under my supervision, and that the same is true and correct to the best of my knowledge and belief.

Date Surveyed
6/13/80
Registered Professional Engineer and/or Land Surveyor
Dan R. Reddy
Certificate No.
NMPE&LS #5412