

MEXICO OIL CONSERVATION COMMISSION
WELL LOCATION AND ACREAGE DEDICATION PLAT

Form C-102
 Supersedes C-128
 Effective 1-1-65

All distances must be from the outer boundaries of the Section.

Operator Coquina Oil Corporation			Lease Harroun Com.		Well No. 1
Unit Letter B	Section 33	Township 22S	Range 28E	County Eddy	
Actual Postage Location of Well: <div style="display: flex; justify-content: space-between; align-items: center;"> 660 feet from the North line and 1980 feet from the East line </div>					
Ground Level Elev. 3064'	Producing Formation Morrow	Pool Undesignated (Dublin Ranch Morrow)		Dedicated Acreage: 320 Acres	

1. Outline the acreage dedicated to the subject well by colored pencil or hachure marks on the plat below.
2. If more than one lease is dedicated to the well, outline each and identify the ownership thereof (both as to working interest and royalty).
3. If more than one lease of different ownership is dedicated to the well, have the interests of all owners been consolidated by communitization, unitization, force-pooling, etc?

☐ Yes ☒ No If answer is "yes," type of consolidation _____

If answer is "no," list the owners and tract descriptions which have actually been consolidated. (Use reverse side of this form if necessary.) None - Communitization will be filed after completion of well.

No allowable will be assigned to the well until all interests have been consolidated (by communitization, unitization, forced-pooling, or otherwise) or until a non-standard unit, eliminating such interests, has been approved by the Commission.

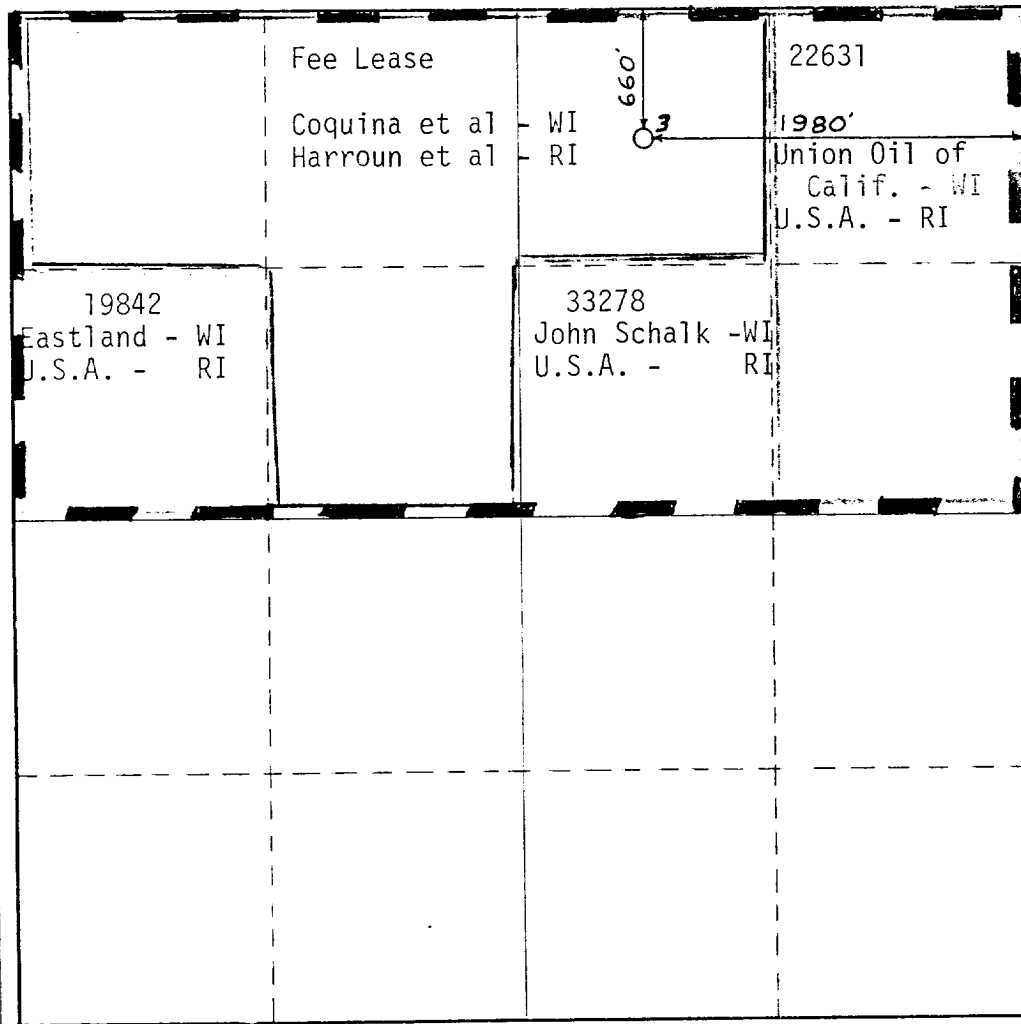

CERTIFICATION

I hereby certify that the information contained herein is true and complete to the best of my knowledge and belief.

A. L. Crain

Name

A. L. Crain

Position

Drilling Manager

Company

Coquina Oil Corporation

Date

October 29, 1980

I hereby certify that the well location shown on this plat was plotted from field notes of actual surveys made by me or under my supervision, and that the same is true and correct to the best of my knowledge and belief.

Date Surveyed

Aug 19, 1980

Registered Professional Engineer
 and/or Land Surveyor

Myrtle E. Shous

Certificate No.

2189

31 640 90 1320 1650 1980 2310 2640 2000 1500 1000 500 0