

NO. OF COPIES RECEIVED	5
DISTRIBUTION	
SANTALE	1
FILE	1
U.S.G.S.	2
LAND OFFICE	
OPERATOR	1

RECEIVED
NEW MEXICO OIL CONSERVATION COMMISSION

DEC 31 1980

O. C. D.
LAND OFFICE

30-015-23592
Form C-101
Revised 1-1-65

5A. Indicate Type of Lease	
STATE <input type="checkbox"/>	FEE <input checked="" type="checkbox"/>

5. State Oil & Gas Lease No.

APPLICATION FOR PERMIT TO DRILL, DEEPEN, OR PLUG BACK

1a. Type of Work		7. Unit Agreement Name	
b. Type of Well DRILL <input checked="" type="checkbox"/> DEEPEN <input type="checkbox"/> PLUG BACK <input type="checkbox"/> OIL WELL <input checked="" type="checkbox"/> GAS WELL <input type="checkbox"/> OTHER <input type="checkbox"/> SINGLE ZONE <input checked="" type="checkbox"/> MULTIPLE ZONE <input type="checkbox"/>		8. Farm or Lease Name Onsurez	
2. Name of Operator Delta Drilling Company ✓		9. Well No. 1	
3. Address of Operator P. O. Box 3467, Midland, Texas 79702		10. Field and Pool, or Wildcat South Culebra Bone Spring	
4. Location of Well UNIT LETTER C LOCATED 660 FEET FROM THE North LINE AND 1980 FEET FROM THE West LINE OF SEC. II TWP. 23S RGE. 28E NMPM		12. County Eddy	
19. Proposed Depth 9800		19A. Formation Bone Spring	20. Rotary or C.T. Rotary
21. Elevations (Show whether DF, RI, etc.) 2989.3 Gr.	21A. Kind & Status Plug, Bond Blanket	21B. Drilling Contractor Delta Drilling Company	22. Approx. Date Work will start 1/1/81

23.

PROPOSED CASING AND CEMENT PROGRAM

SIZE OF HOLE	SIZE OF CASING	WEIGHT PER FOOT	SETTING DEPTH	SACKS OF CEMENT	EST. TOP
17-1/2"	13-3/8"	48	450'	600	Surface
11"	8-5/8"	24	2800'	950	Surface
7-7/8"	5-1/2"	17	9800'	1100	2500'

Mud Program: Drill with native mud to 450'. Drill from 450' to 2800' with 10# brine. Drill from 2800' to T.D. with cut brine 9.2#. BOP sketch attached.

APPROVAL VALID
FOR 90 DAYS UNLESS
DRILLING COMMENCED,

EXPIRES 3-31-81

IN ABOVE SPACE DESCRIBE PROPOSED PROGRAM: IF PROPOSAL IS TO DEEPEN OR PLUG BACK, GIVE DATA ON PRESENT PRODUCTIVE ZONE AND PROPOSED NEW PRODUCTIVE ZONE. GIVE BLOWOUT PREVENTER PROGRAM, IF ANY.

I hereby certify that the information above is true and complete to the best of my knowledge and belief.

Signed [Signature] J. A. Coon Title Division Production Manager Date 12/22/80

(This space for State Use)

APPROVED BY [Signature] TITLE SUPERVISOR, DISTRICT 1 DATE DEC 31 1980

CONDITIONS OF APPROVAL, IF ANY:

NEW MEXICO OIL CONSERVATION COMMISSION
WELL LOCATION AND ACREAGE DEDICATION PLAT

RECEIVED

Form O-124
Supersedes O-124
Effective 1-1-65

JUL 2 1981

All distances must be from the outer boundaries of the Section

Lease Delta Drillins Co.			O. C. O. Well Antonio Onsurez		
Section C	Range 11	Township 23 South	Range 28 East	County Eddy County, N.M.	
Acres in the Section 660		feet from the North line and		feet from the West line	
Producing Formation 2939.30		Bone Spring		Pool South Culebra Bluff (Bone Spring)	
				Section Area 80	

- Outline the acreage dedicated to the subject well by colored pencil or hatchure marks on the plat below.
- If more than one lease is dedicated to the well, outline each and identify the ownership thereof (both as to working interest and royalty).
- If more than one lease of different ownership is dedicated to the well, have the interests of all owners been consolidated by communitization, unitization, force-pooling, etc?

☐ Yes ☒ No If answer is "yes," type of consolidation _____

If answer is "no," list the owners and tract descriptions which have actually been consolidated (Use reverse side of this form if necessary.) Antonio and Gloria Onsurez, Margaret Spence

No allowable will be assigned to the well until all interests have been consolidated (by communitization, unitization, forced-pooling, or otherwise) or until a non-standard unit, eliminating such interests, has been approved by the Commission.

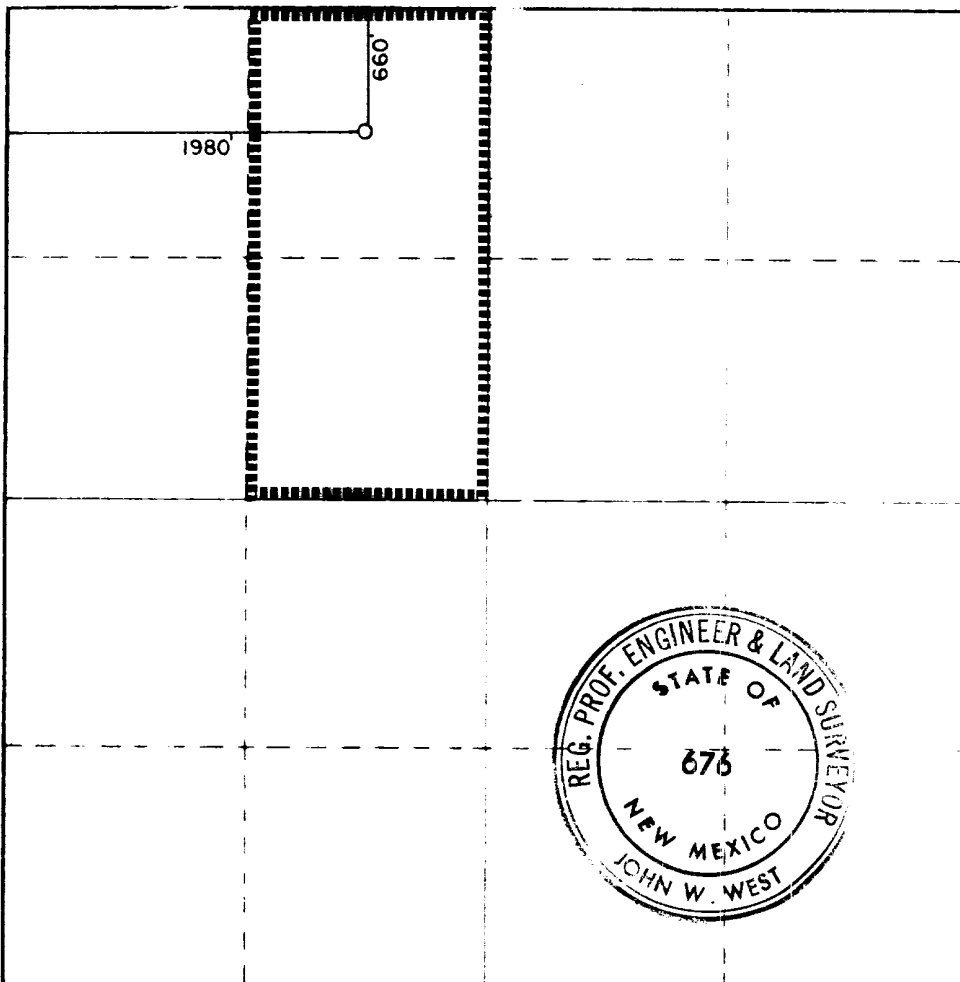

CERTIFICATION

I hereby certify that the information contained herein is true and complete to the best of my knowledge and belief

Ron Brown

Ron Brown

Production Engineer

Delta Drilling Company

6-29-81

I hereby certify that the well location shown on this plat was plotted from field notes of actual surveys made by me or under my supervision and that the same is true and correct to the best of my knowledge and belief

12-15-80

John W. West

State No. **JOHN W. WEST** 678
PATRICK A. ROMERO 6663
Ronald J. Edison 3239

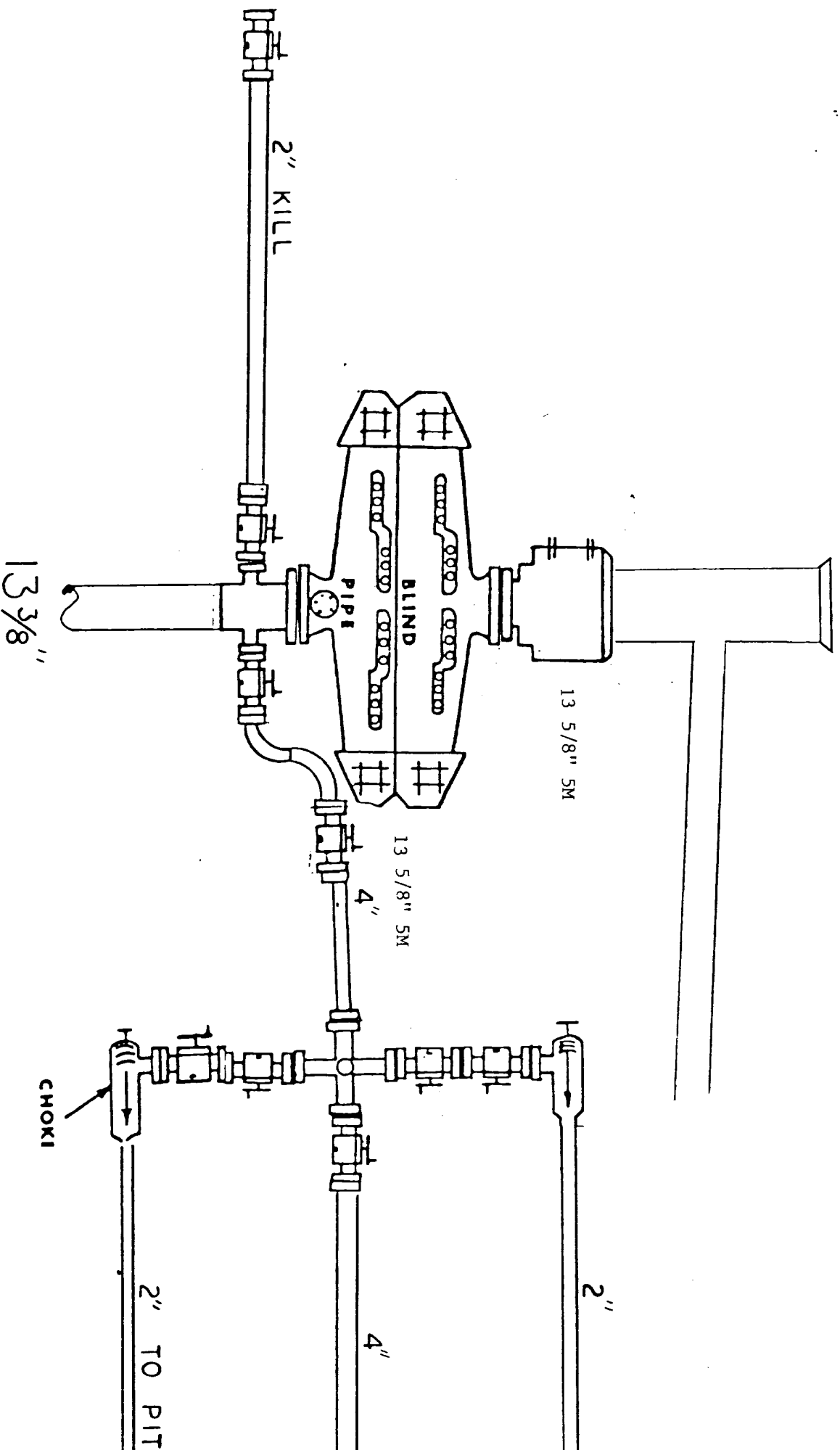

FIRST NIPPLE-UP

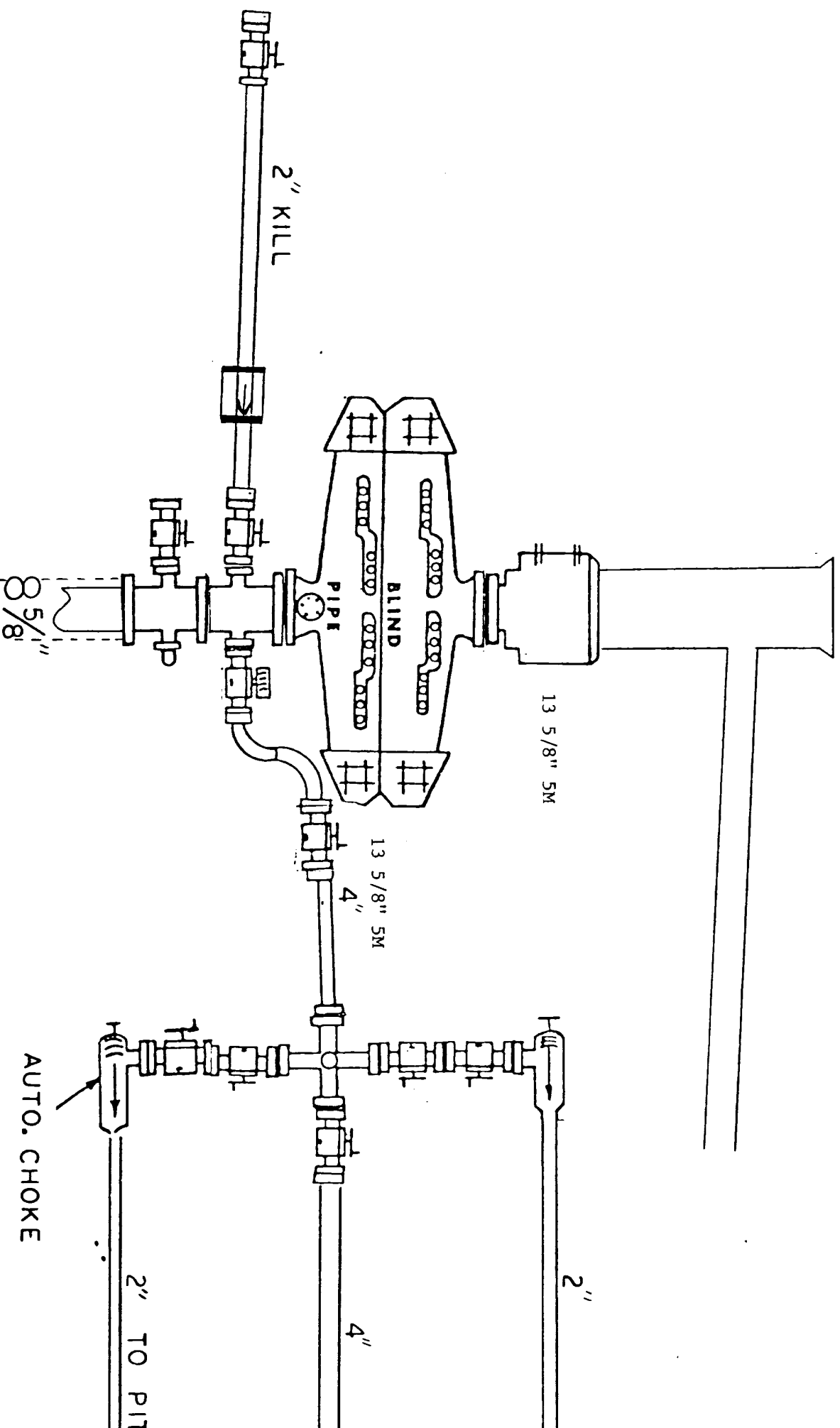

SECOND NIPPLE - UP