

NEW MEXICO OIL CONSERVATION COMMISSION
WELL LOCATION AND ACREAGE DEDICATION PLAT

Form O-102
Supersedes O-128
Effective 1-1-65

All distances must be from the outer boundaries of the Section

| | | | | |
|---|----------------------|-----------------------------------|-------------------------|-----------------------|
| Operator W. A. MONCRIEF, JR. | | Lease BALDRIDGE FEDERAL | | Well No. 2 |
| Unit Letter B | Section 14 | Township 24 South | Range 24 East | County Eddy |
| Actual Footage Location of Well: 196 feet from the North line and 1427 feet from the East line Ground Level Elev. 4242.0 Producing Formation MORROW BALDRIDGE CANYON MORROW Dedicated Acreage 320 Acres | | | | |

1. Outline the acreage dedicated to the subject well by colored pencil or hachure marks on the plat below.
2. If more than one lease is dedicated to the well, outline each and identify the ownership thereof (both as to working interest and royalty).
3. If more than one lease of different ownership is dedicated to the well, have the interests of all owners been consolidated by communitization, unitization, force-pooling, etc?

☐ Yes ☐ No If answer is "yes?" type of consolidation _____

If answer is "no," list the owners and tract descriptions which have actually been consolidated. (Use reverse side of this form if necessary.) _____

No allowable will be assigned to the well until all interests have been consolidated (by communitization, unitization, forced-pooling, or otherwise) or until a non-standard unit, eliminating such interests, has been approved by the Commission.

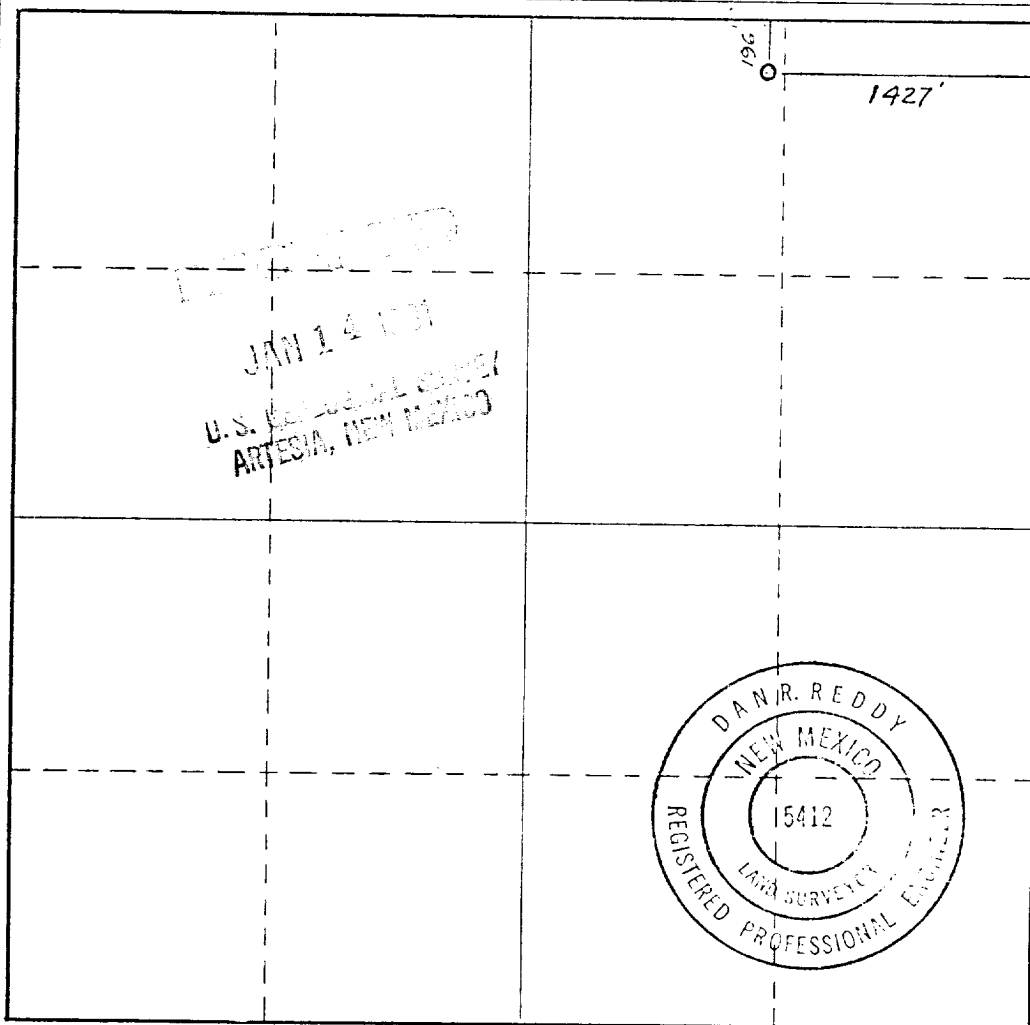

CERTIFICATION

I hereby certify that the information contained herein is true and complete to the best of my knowledge and belief.

Dewey E. Thornton

Name
Dewey E. Thornton

Position
Exploration Manager

Company
W.A. MONCRIEF, JR.

Date
JANUARY 5, 1981

I hereby certify that the well location shown on this plat was plotted from field notes of actual surveys made by me or under my supervision, and that the same is true and correct to the best of my knowledge and belief.

Date Surveyed
December 27, 1980

Registered Professional Engineer and/or Land Surveyor

Dan R. Reddy

Certificate No.
NEW MEXICO 15412

0 330 660 990 1320 1650 1980 2310 2640 2970 3300 3630 3960 4290 4620 4950 5280 5610 5940 6270 6600 6930 7260 7590 7920 8250 8580 8910 9240 9570 9900



STATE OF NEW MEXICO
ENERGY AND MINERALS DEPARTMENT
OIL CONSERVATION DIVISION

February 6, 1981

BRUCE KING
GOVERNOR

LARRY KEHOE
SECRETARY

POST OFFICE BOX 2088
STATE LAND OFFICE BUILDING
SANTA FE, NEW MEXICO 87501
(505) 827-2434

RECEIVED

FEB 09 1981

W. A. Moncrief, Jr.
400 Metro Building
Midland, Texas 79701

O. C. D.
ARTESIA, OFFICE

Attention: Dewey E. Thornton

Administrative Order NSL-1312

Gentlemen:

Reference is made to your application for a non-standard location for your Baldrige Federal Well No. 2 to be located 1427 feet from the East line and 196 feet from the North line of Section 14, T-24-S, R-24-E, NMPM, Baldrige Canyon Morrow Pool, Eddy County, New Mexico.

By authority granted me under the provisions of Rule 104 F of the Division Rules and Regulations, the above-described unorthodox location is hereby approved.

Sincerely,

JOE D. RAMEY,
Director

JDR/dr

cc: Oil Conservation Division - Artesia
Oil & Gas Engineering Committee - Hobbs
U. S. Geological Survey - Artesia