

NEW MEXICO OIL CONSERVATION COMMISSION
WELL LOCATION AND ACREAGE DEDICATION PLAT

Form C-102
Supersedes C-128
Effective 1-1-65

All distances must be from the outer boundaries of the Section

Operator Phillips Petroleum Company		Lease Malaga C		Well No. 1
Unit Letter E	Section 36	Township 23 South	Range 28 East	County Eddy
Actual Well Location of Well:				
1980 feet from the North line and		660 feet from the West line		
Ground Level Elev. 2989.6 (Unprepared)	Producing Formation Morrow	Pool Wildcat-Morrow (Gas)	Dedicated Acreage: 320 Acres	

- Outline the acreage dedicated to the subject well by colored pencil or hatchure marks on the plat below.
- If more than one lease is dedicated to the well, outline each and identify the ownership thereof (both as to working interest and royalty).
- If more than one lease of different ownership is dedicated to the well, have the interests of all owners been consolidated by communitization, unitization, force-pooling, etc?

☐ Yes ☐ No If answer is "yes," type of consolidation _____

If answer is "no," list the owners and tract descriptions which have actually been consolidated. (Use reverse side of this form if necessary.) _____

No allowable will be assigned to the well until all interests have been consolidated (by communitization, unitization, forced-pooling, or otherwise) or until a non-standard unit, eliminating such interests, has been approved by the Commission.

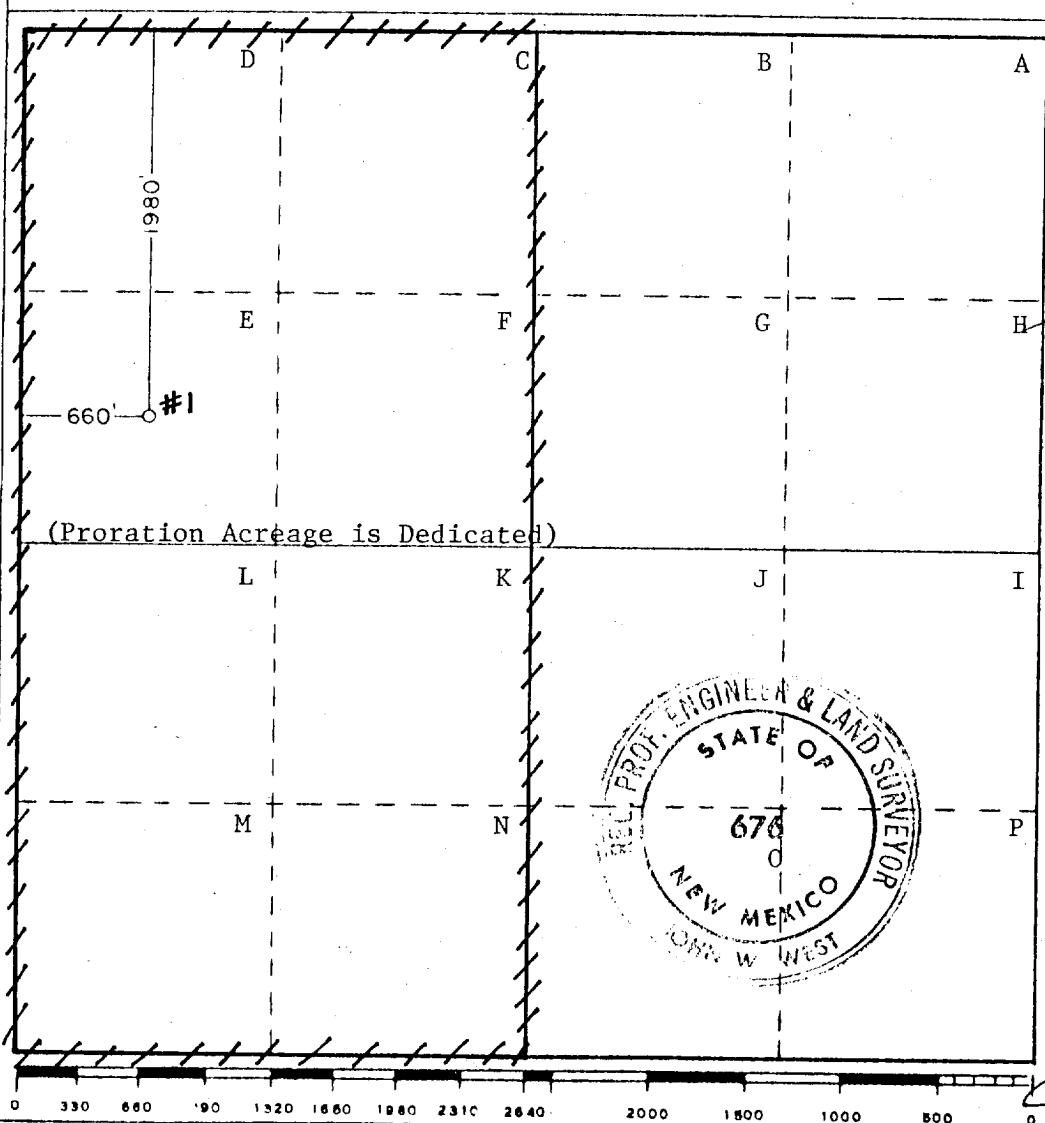

CERTIFICATION

I hereby certify that the information contained herein is true and complete to the best of my knowledge and belief.

[Signature]
Name

W.J. Mueller

Position

Sr. Engineering Specialist

Company

Phillips Petroleum Company

Date

March 2, 1981

I hereby certify that the well location shown on this plat was plotted from field notes of actual surveys made by me or under my supervision, and that the same is true and correct to the best of my knowledge and belief.

Date Surveyed

2/4/81

Registered Professional Engineer and/or Land Surveyor

[Signature]

Certificate No. **JOHN W. WEST 678**
PATRICK A. ROMERO 8868
Ronald J. Eidson 3239