

NEW MEXICO OIL CONSERVATION COMMISSION  
WELL LOCATION AND ACREAGE DEDICATION PLAT

Form C-102  
Supersedes C-128  
Effective 1-1-65

All distances must be from the outer boundaries of the Section.

MAR 1982

Operator <b>Amoco Production Company</b>			Lease <b>Federal BL</b>			Well No. <b>Q C O 1</b>
Unit Letter <b>B</b>	Section <b>17</b>	Township <b>23-S</b>	Range <b>24-E</b>	County <b>ARTESIA, OFFICE</b>		
Actual Footage Location of Well: <b>300</b> feet from the <b>North</b> line and <b>2600</b> feet from the <b>East</b> line						
Ground Level Elev. <b>4225.0</b>	Producing Formation <b>Atoka</b>		Pool <b>Wildcat Atoka</b>		Dedicated Acreage: <b>320</b> Acres	

1. Outline the acreage dedicated to the subject well by colored pencil or hatchure marks on the plat below.
2. If more than one lease is dedicated to the well, outline each and identify the ownership thereof (both as to working interest and royalty).
3. If more than one lease of different ownership is dedicated to the well, have the interests of all owners been consolidated by communitization, unitization, force-pooling, etc?

☐ Yes ☐ No If answer is "yes," type of consolidation \_\_\_\_\_

If answer is "no," list the owners and tract descriptions which have actually been consolidated. (Use reverse side of this form if necessary.) \_\_\_\_\_

No allowable will be assigned to the well until all interests have been consolidated (by communitization, unitization, forced-pooling, or otherwise) or until a non-standard unit, eliminating such interests, has been approved by the Commission.

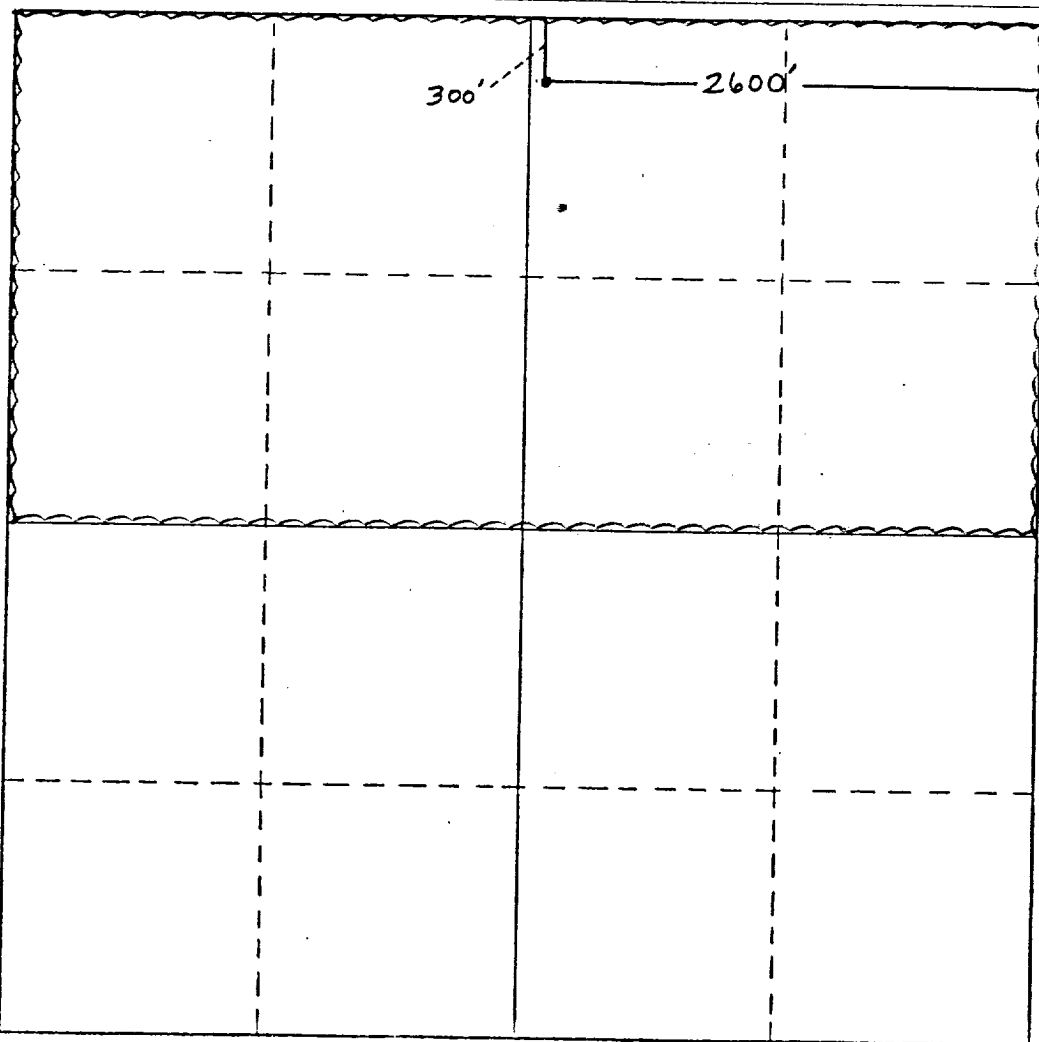

CERTIFICATION

I hereby certify that the information contained herein is true and complete to the best of my knowledge and belief.

Name Mark Freeman  
Position Assist. Admin. Analyst  
Company Amoco Production Company  
Date 3-11-82

I hereby certify that the well location shown on this plat was plotted from field notes of actual surveys made by me or under my supervision, and that the same is true and correct to the best of my knowledge and belief.

Date Surveyed \_\_\_\_\_

Registered Professional Engineer and/or Land Surveyor \_\_\_\_\_

Certificate No. \_\_\_\_\_

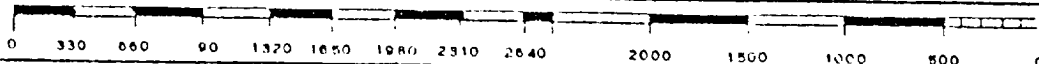

## OIL CONSERVATION DIVISION

P.O. DRAWER DD

ARTESIA, NM 88210

RECEIVED

NOTICE OF GAS CONNECTION

JUL 8 1982

DATE July 6, 1982

O. C. D.

ARTESIA, OFFICE

This is to notify the Oil Conservation Division that connection for the purchase of  
gas from the Amoco Production Company  
OPERATOR

Federal BL #1 CPD

Eddy

B17-23S-24E

LEASE &amp; WELL

COUNTY

UNIT S-T-R

Wildcat Atoka

El Paso Natural Gas Company

POOL

NAME OF PURCHASER

was made on June 30, 1982  
DATE

35886-01  
SITE CODE & SITE WELL NUMBER

El Paso Natural Gas Co.

PURCHASER

  
REPRESENTATIVE

Assistant Chief Division Dispatcher

TITLE

TRE: b1

cc: Operator  
Oil Conservation Division - Santa Fe, NM  
M. E. McEuen  
R. L. Tabb  
Production Control Dept.  
Measurement Dept.  
Earl Smith  
Bob Sledge - Contracts Adm. Dept.  
File