

NEW MEXICO OIL CONSERVATION COMMISSION
WELL LOCATION AND ACREAGE DEDICATION PLAT

Form C-128
Supersedes C-128
Effective 1-1-65

All distances must be from the outer boundaries of the Section.

Operator COQUINA OIL CORPORATION			Lease SWEARINGEN		Well No. 1
Unit Letter J	Section 4	Township 23-S	Range 28-E	County EDDY	
Actual Footage Location of Well: 1650 feet from the SOUTH line and 1980 feet from the EAST line					
Ground Level Elev: 3014	Producing Formation Morrow	Pool Name Dublin Ranch	Dedicated Acreage: 320 Acres		

1. Outline the acreage dedicated to the subject well by colored pencil or hachure marks on the plat below.
2. If more than one lease is dedicated to the well, outline each and identify the ownership thereof (both as to working interest and royalty).
3. If more than one lease of different ownership is dedicated to the well, have the interests of all owners been consolidated by communitization, unitization, force-pooling, etc?

☐ Yes ☐ No If answer is "yes," type of consolidation _____

If answer is "no," list the owners and tract descriptions which have actually been consolidated. (Use reverse side of this form if necessary.) _____

No allowable will be assigned to the well until all interests have been consolidated (by communitization, unitization, forced-pooling, or otherwise) or until a non-standard unit, eliminating such interests, has been approved by the Commission.

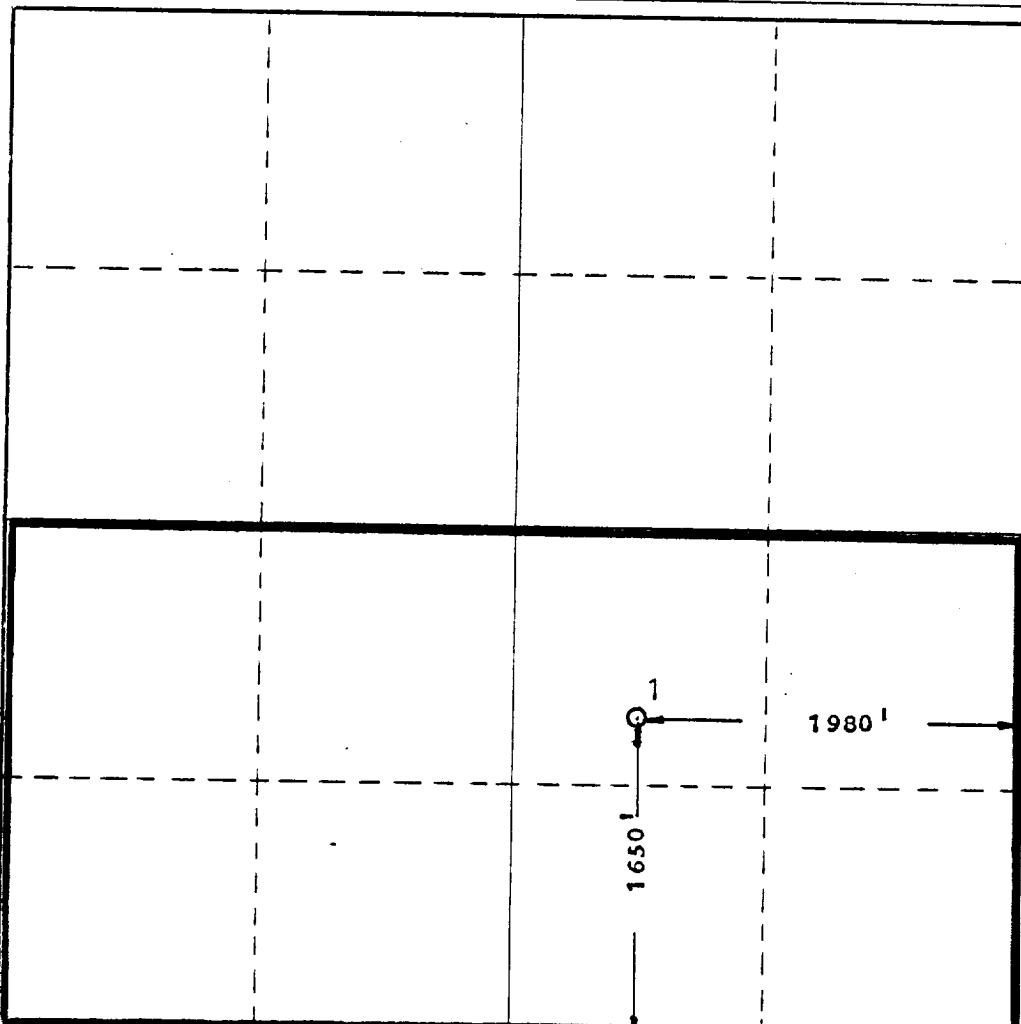

CERTIFICATION

I hereby certify that the information contained herein is true and complete to the best of my knowledge and belief.

Billy M. Priebe
Name

Billy M. Priebe

Position
Drilling Manager

Company
Coquina Oil Corporation

Date
June 2, 1981

I hereby certify that the well location shown on this plat was plotted from field notes of actual surveys made by me or under my supervision, and that the same is true and correct to the best of my knowledge and belief.

Date Surveyed
May 28, 1981

Registered Professional Engineer and/or Land Surveyor

Wm. E. Shows
Certificate No.

2189

330 660 990 1320 1650 1980 2310 2640 2000 1500 1000 500 0