

Submit to Appropriate
District Office
State Lease - 6 copies
Fee Lease - 5 copies

State of New Mexico
Energy, Minerals and Natural Resources Department

Form C-101
Revised 1-1-89

DISTRICT I
P.O. Box 1980, Hobbs, NM 88240

DISTRICT II
P.O. Drawer DD, Artesia, NM 88210

DISTRICT III
1000 Rio Brazos Rd., Aztec, NM 87410

OIL CONSERVATION DIVISION
P.O. Box 2088
Santa Fe, New Mexico 87504-2088

RECEIVED

JAN 24 '91

API NO. (assigned by OCD on New Wells) 30-015-23907	
5. Indicate Type of Lease STATE <input type="checkbox"/> FEE <input checked="" type="checkbox"/>	
6. State Oil & Gas Lease No.	
7. Lease Name or Unit Agreement Name Williams	
8. Well No. 1	
9. Pool name or Wildcat S. Culebra Bluff Und. Delaware	
10. Proposed Depth 6400'	
11. Formation Delaware	12. Rotary or C.T. Rotary
13. Elevations (Show whether DF, RT, GR, etc.) 2993' GL	14. Kind & Status Plug. Bond Blanket
15. Drilling Contractor Pride	16. Approx. Date Work will start 2-1-91

APPLICATION FOR PERMIT TO DRILL, DEEPEN, OR PLUG BACK

1a. Type of Work:
DRILL ☐ RE-ENTER ☒ DEEPEN ☐ PLUG BACK ☐
b. Type of Well:
OIL WELL ☒ GAS WELL ☐ OTHER ☐
SINGLE ZONE ☒ MULTIPLE ZONE ☐

2. Name of Operator
Bird Creek Resources, Inc.

3. Address of Operator
810 South Cincinnati, Suite 110 Tulsa, OK 74119

4. Well Location
Unit Letter N : 660 Feet From The South Line and 1980 Feet From The West Line
Section 25 Township 23S Range 28E NMPM Eddy County

10. Proposed Depth 6400'		11. Formation Delaware	12. Rotary or C.T. Rotary
13. Elevations (Show whether DF, RT, GR, etc.) 2993' GL	14. Kind & Status Plug. Bond Blanket	15. Drilling Contractor Pride	16. Approx. Date Work will start 2-1-91

17. PRESENT PROPOSED CASING AND CEMENT PROGRAM

SIZE OF HOLE	SIZE OF CASING	WEIGHT PER FOOT	SETTING DEPTH	SACKS OF CEMENT	EST. TOP
17 1/2"	13 3/8"	48#	0-422'	amt. circulated	Sep., 1981
11"	8 5/8"	24#	0-2503'	amt. circulated	Sep., 1981
7 7/8"	4 1/2"	10.50#	0-7254'	TOC. @ 950'	Sep., 1981

Well was P&A by Dinero in 1984 as follows:

CIBP @ 6400'
25 sxs. plug @ 6050-6400'
25 sxs. plug @ 2300-2650'
25 sxs. plug @ 990-1350'
25 sxs. @ 250'-600'
10 sxs. @ Surface

APPROVAL VALID FOR 180 DAYS
PERMIT EXPIRES 7/28/91
UNLESS DRILLING UNDERWAY

We propose to reenter well, drill all plugs out to CIBP 6400'. We will attempt to test several Delaware sands. Top of Bone Spring @ 6392', Bone Spring perms @ 6460-7130', TD 7254'. See attached schematic.

IN ABOVE SPACE DESCRIBE PROPOSED PROGRAM: IF PROPOSAL IS TO DEEPEN OR PLUG BACK, GIVE DATA ON PRESENT PRODUCTIVE ZONE AND PROPOSED NEW PRODUCTIVE ZONE. GIVE BLOWOUT PREVENTER PROGRAM, IF ANY.

I hereby certify that the information above is true and complete to the best of my knowledge and belief.

SIGNATURE Bill M. Burks TITLE Agent DATE 1-23-91
TYPE OR PRINT NAME Bill M. Burks 918-582-3855 TELEPHONE NO.

(This space for State Use)

ORIGINAL SIGNED BY
MIKE WILLIAMS

APPROVED BY SUPERVISOR, DISTRICT II TITLE DATE JAN 25 1991

CONDITIONS OF APPROVAL, IF ANY:

Submit to Appropriate
District Office
State Lease - 4 copies
Fee Lease - 3 copies

State of New Mexico
Energy, Minerals and Natural Resources Department

Form C-102
Revised 1-1-89

OIL CONSERVATION DIVISION

P.O. Box 2088
Santa Fe, New Mexico 87504-2088

DISTRICT I
P.O. Box 1980, Hobbs, NM 88240

DISTRICT II
P.O. Drawer DD, Artesia, NM 88210

DISTRICT III
1000 Rio Brazos Rd., Aztec, NM 87410

WELL LOCATION AND ACREAGE DEDICATION PLAT

All Distances must be from the outer boundaries of the section

Operator Bird Creek Resources, Inc.			Lease Williams		Well No. 1
Unit Letter N	Section 25	Township 23S	Range 28E	County Eddy	
Actual Footage Location of Well: 660 feet from the South line and 1980 feet from the West line					
Ground level Elev. 2993'	Producing Formation Delaware		Pool S. Culebra Bluff		Dedicated Acreage: 40 Acres

1. Outline the acreage dedicated to the subject well by colored pencil or hatchure marks on the plat below.

2. If more than one lease is dedicated to the well, outline each and identify the ownership thereof (both as to working interest and royalty).

3. If more than one lease of different ownership is dedicated to the well, have the interest of all owners been consolidated by communitization, unitization, force-pooling, etc.?

☒ Yes

☐ No

If answer is "yes" type of consolidation **Communitization**

If answer is "no" list the owners and tract descriptions which have actually been consolidated. (Use reverse side of this form if necessary.)

No allowable will be assigned to the well until all interests have been consolidated (by communitization, unitization, forced-pooling, or otherwise) or until a non-standard unit, eliminating such interest, has been approved by the Division.

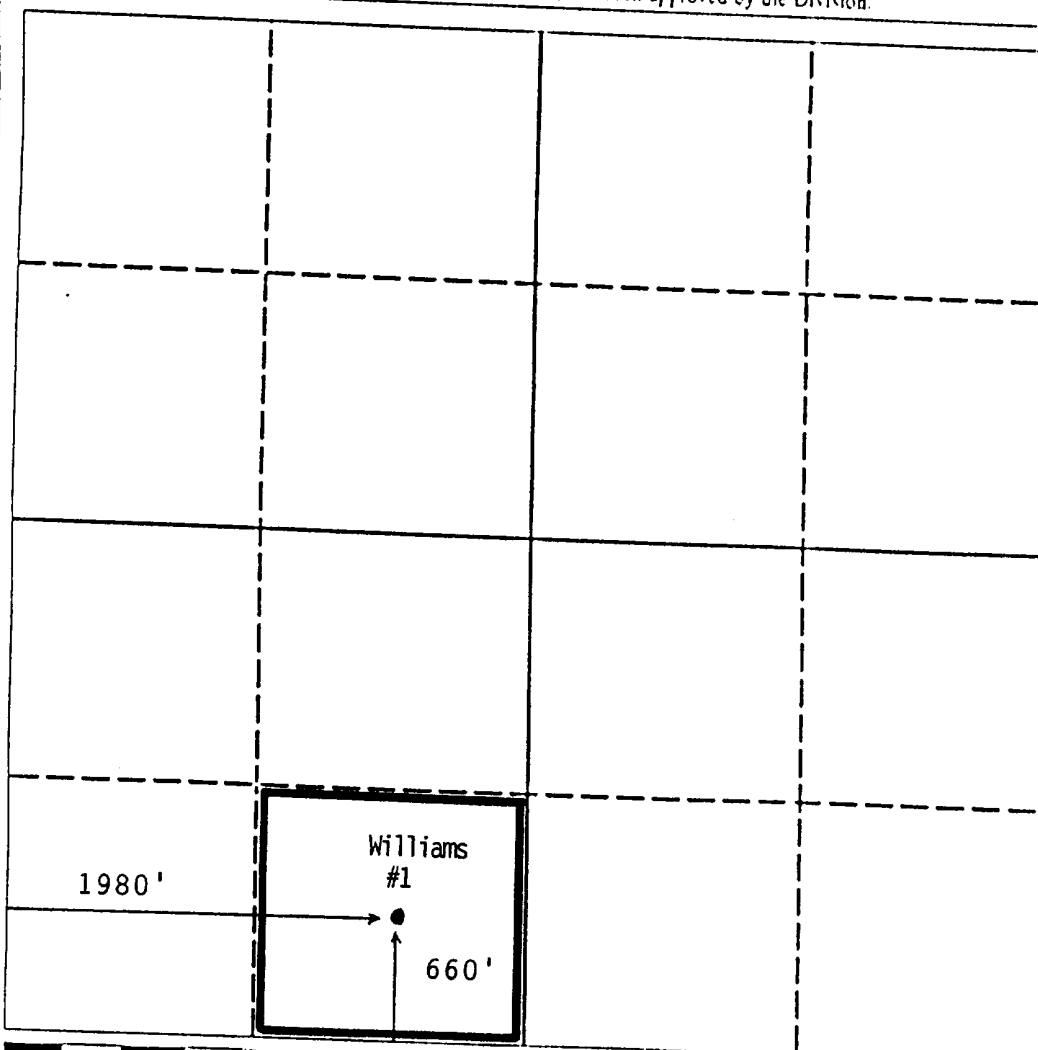

OPERATOR CERTIFICATION

I hereby certify that the information contained herein is true and complete to the best of my knowledge and belief.

Signature

Bill M. Burks

Printed Name

Agent

Position

Bird Creek Resources, Inc.

Company

1-23-91

Date

SURVEYOR CERTIFICATION

I hereby certify that the well location shown on this plat was plotted from field notes of actual surveys made by me or under my supervision, and that the same is true and correct to the best of my knowledge and belief.

Date Surveyed

Signature & Seal of
Professional Surveyor

Certificate No.

BOP STACK

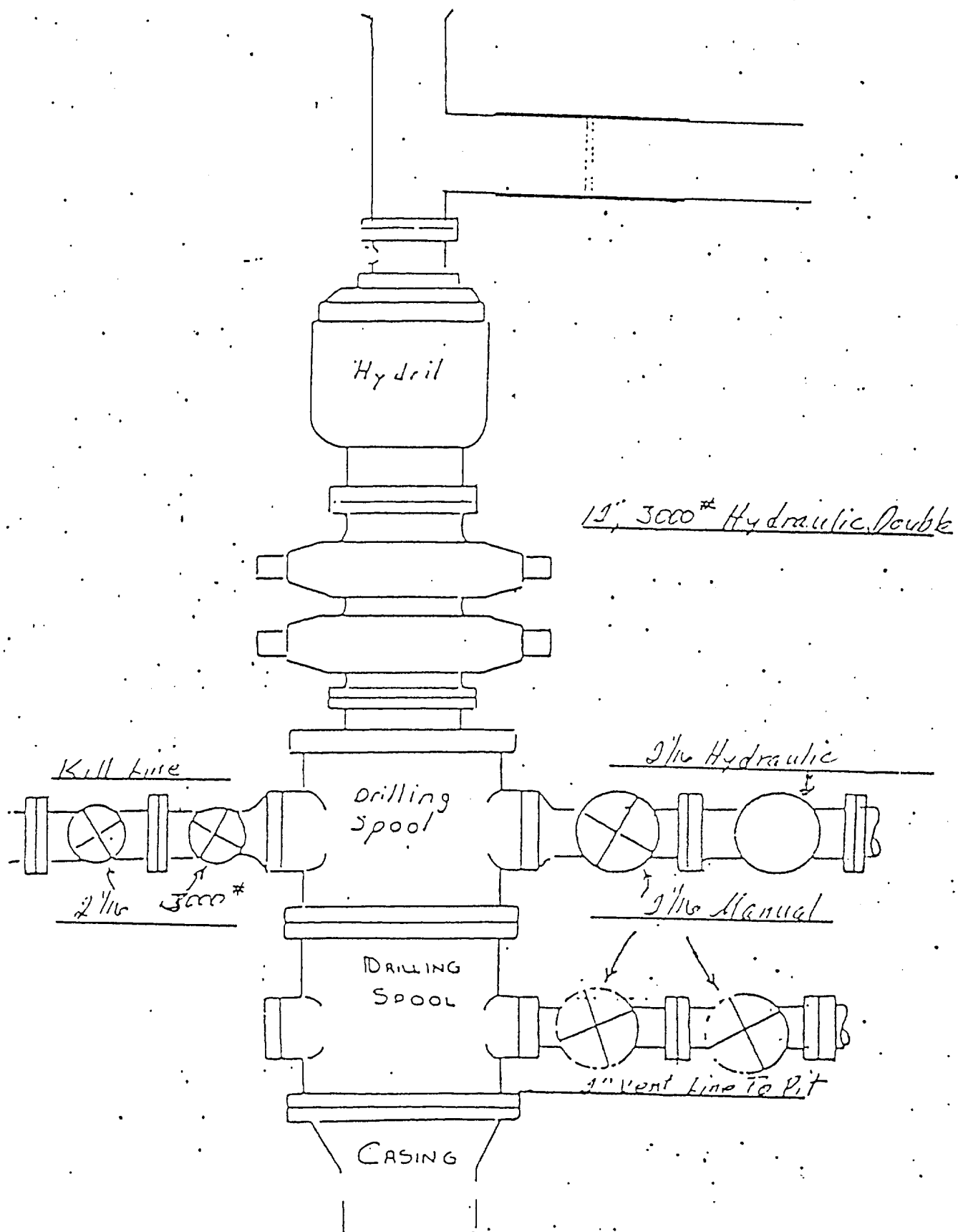

Current Status
1-23-91

DINERO'S Williams #1
Unit N Sec. 25-23S-28E
Eddy Co., NM 2993' GL

10 sx. plug @ surface w/ marker

25 sx. plug @ 250-600'

25 sx. plug @ 1000-1350'

25 sx. plug @ 2300-2650'

25 sx. plug @ 6050-6400'

35' cmt. @ 6865-6900'

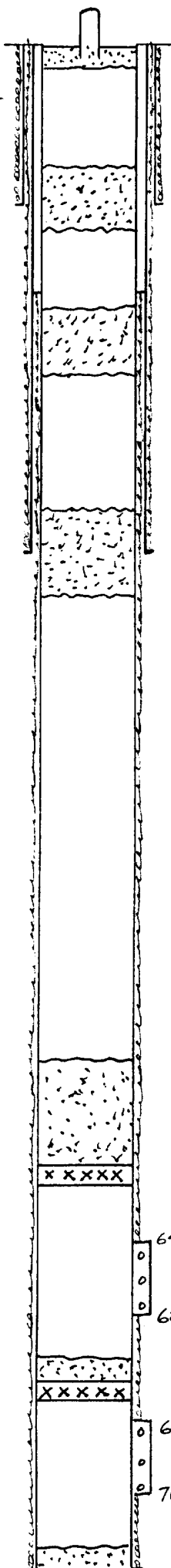

13 3/8", 48# csq. @ 0-422'
Cmt. circ. 9-81

TOC behind 4 1/2" csq. @ 950'

8 5/8", 24# csq. @ 0-2503'
Cmt. circ. 9-81

Delaware Sand @ 2600-6392'

Bone Spring @ 6392-TD'

4 1/2" CIBP @ 6400'

6460'

Bone Spring perfs, 51 holes

6868'

4 1/2" CIBP @ 6900'

6940'

7130' Bone Spring perfs, 31 holes

TD 7254' (10-81)