

NEW MEXICO OIL CONSERVATION COMMISSION
WELL LOCATION AND ACREAGE DEDICATION PLAT

Form C-102
Supersedes C-128
Effective 1-1-83

All distances must be from the outer boundaries of the Section.

Operator C & K PETROLEUM, INC.			Lease EXXON-FEDERAL COM			Well No. 2		
Unit Letter 11	Section 17	Township -24-S		Range -26-E	County EDDY			
Actual Footage Location of Wells								
1400		feet from the SOUTH		line and		1650		feet from the EAST line
Ground Level Elev. 3430		Producing Formation PENNSYLVANIAN		Pool WHITE CITY (PENN)		Dedicated Acreage 640 Acres		

1. Outline the acreage dedicated to the subject well by colored pencil or hachure marks on the plat below.
2. If more than one lease is dedicated to the well, outline each and identify the ownership thereof (both as to working interest and royalty). (SEE REVERSE SIDE)
3. If more than one lease of different ownership is dedicated to the well, have the interests of all owners been consolidated by communitization, unitization, force-pooling, etc?

☒ Yes ☐ No If answer is "yes," type of consolidation Communitization No. SW-808

If answer is "no," list the owners and tract descriptions which have actually been consolidated. (Use reverse side of this form if necessary.)

No allowable will be assigned to the well until all interests have been consolidated (by communitization, unitization, forced-pooling, or otherwise) or until a non-standard unit, eliminating such interests, has been approved by the Commission.

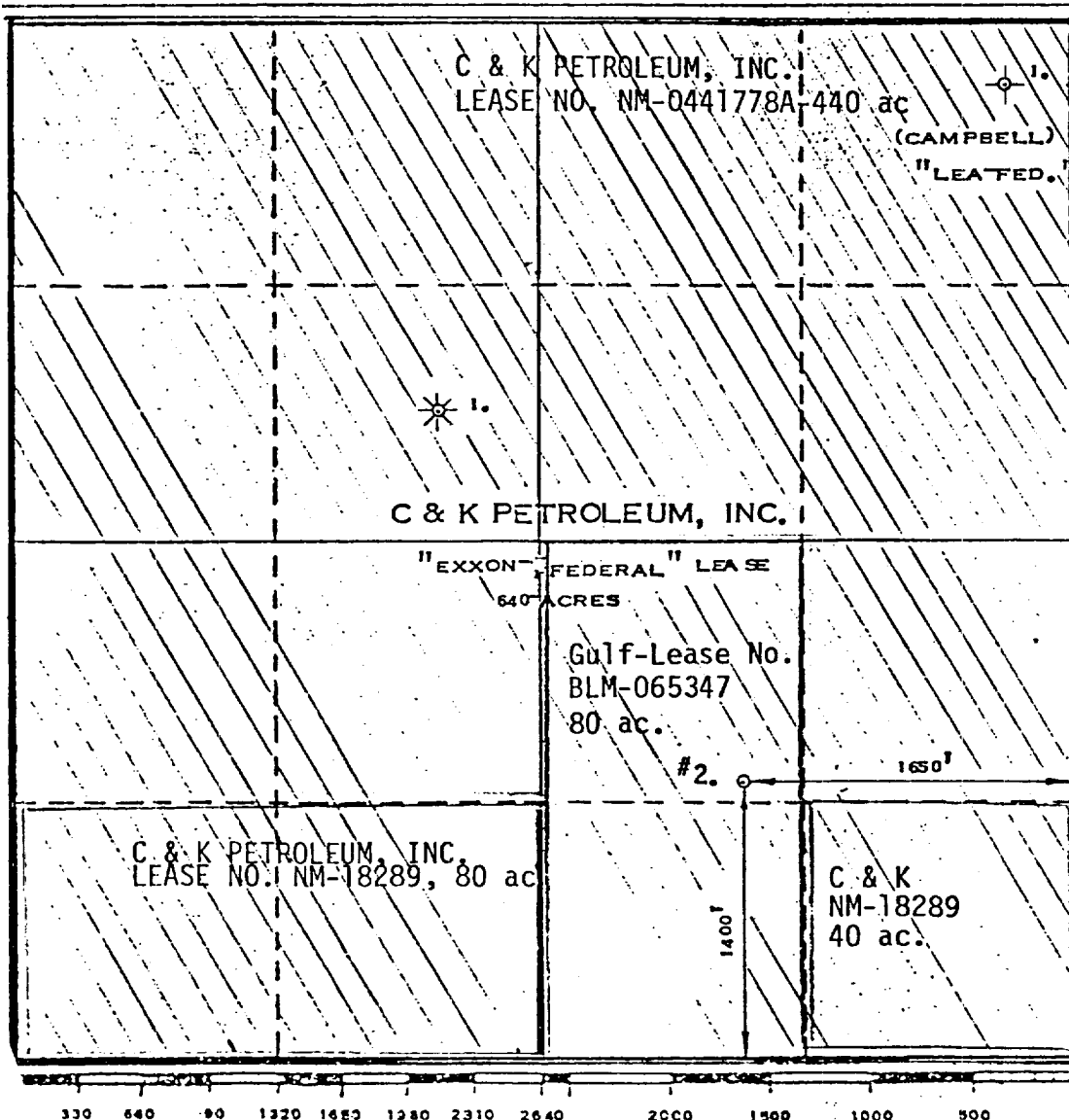

CERTIFICATION

I hereby certify that the information contained herein is true and complete to the best of my knowledge and belief.

Michael W. Gore

Name

MICHAEL W. GORE

Position

DRILLING SUPERINTENDENT

Company

C & K PETROLEUM, INC.

Date

JUNE 18, 1982

I hereby certify that the well location shown on this plat was plotted from field notes of actual surveys made by me or under my supervision, and that the same is true and correct to the best of my knowledge and belief.

Date Surveyed

MAY 12, 1982

Registered Professional Engineer and/or Land Surveyor

Max A. Schumann Jr.
MAX A. SCHUMANN JR.

Certificate No.

1510