

NEW MEXICO OIL CONSERVATION COMMISSION
WELL LOCATION AND ACREAGE DEDICATION PLAT

RECEIVED

Form C-162
Supersedes C-128
Effective 1-1-81

JAN 7 1982

All distances must be from the outer boundaries of the Section.

Operator COQUINA OIL CORP.			Lease NICHOLS			O. C. D. Well No. 1 ARTESIA, OFFICE		
Unit Letter C	Section 21	Township 22 SOUTH	Range 27 EAST	County EDDY				
Actual Footage Location of Well: 990 feet from the NORTH line and 2270 feet from the WEST line								
Ground Level Elev. 3110.0	Producing Formation MORROW			Pool UNDESIGNATED			Dedicated Acreage: 320 Acres	

1. Outline the acreage dedicated to the subject well by colored pencil or hatchure marks on the plat below.
2. If more than one lease is dedicated to the well, outline each and identify the ownership thereof (both as to working interest and royalty).
3. If more than one lease of different ownership is dedicated to the well, have the interests of all owners been consolidated by communitization, unitization, force-pooling, etc?

☒ Yes ☐ No If answer is "yes," type of consolidation VOLUNTARY POOLING

If answer is "no," list the owners and tract descriptions which have actually been consolidated. (Use reverse side of this form if necessary.)

No allowable will be assigned to the well until all interests have been consolidated (by communitization, unitization, forced-pooling, or otherwise) or until a non-standard unit, eliminating such interests, has been approved by the Commission.

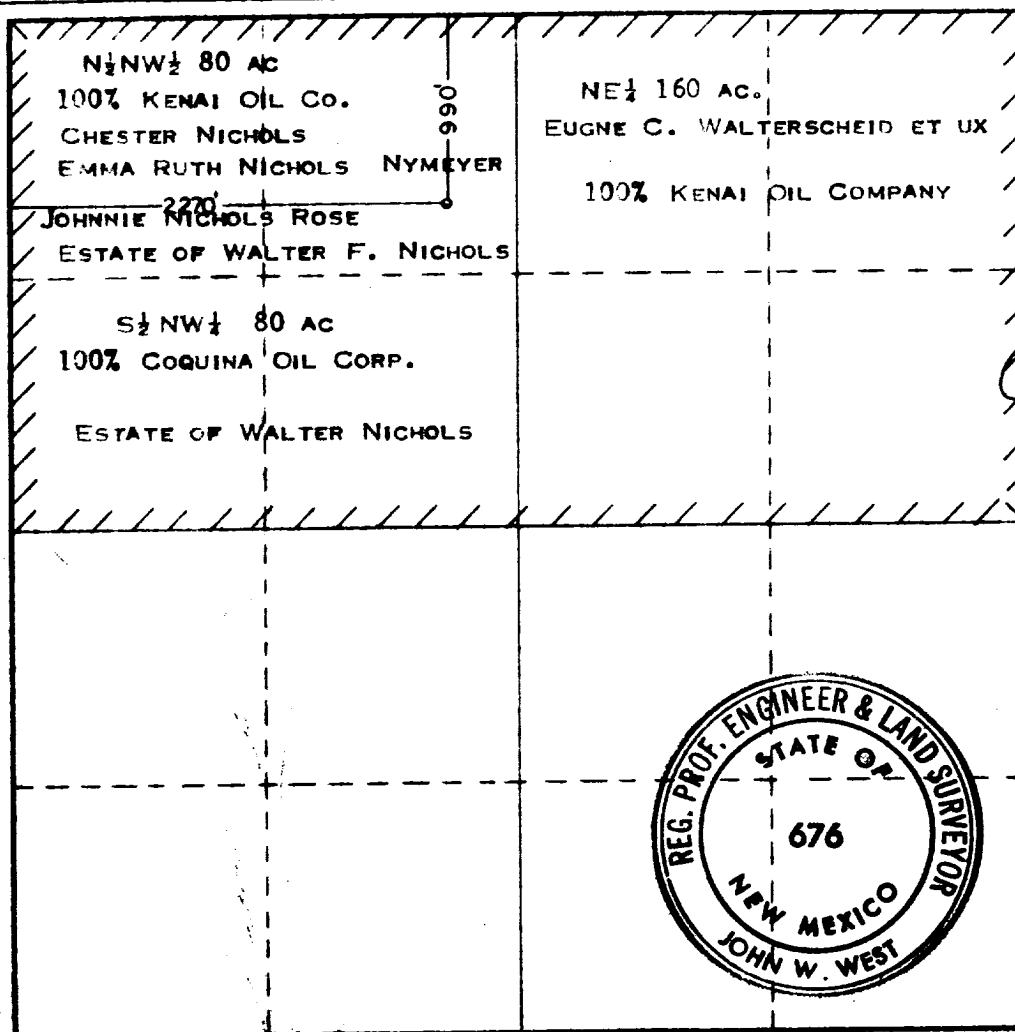

CERTIFICATION

I hereby certify that the information contained herein is true and complete to the best of my knowledge and belief.

Name John W. West
Position
AGENT

Company
COQUINA OIL CORP.

Date
1-6-1982

I hereby certify that the well location shown on this plat was plotted from field notes of actual surveys made by me or under my supervision, and that the same is true and correct to the best of my knowledge and belief

Date Surveyed
12-5-81

Registered Professional Engineer and/or Land Surveyor

Certificate No. **JOHN W. WEST 476**
PATRICK A. BARNES 2208
Ronald J. Edgus 2239