

All distances must be from the outer boundaries of the Section.

|  |                                 |                 |                                       |                |                                 |
|--|---------------------------------|-----------------|---------------------------------------|----------------|---------------------------------|
| Operator<br>Graham Royalty, Ltd.   |                                 |                 | Lease<br>Nichols                      |                | Well No.<br>1                   |
| Unit Letter<br>C   | Section<br>21                   | Township<br>22S | Range<br>27E                          | County<br>Eddy |                                 |
| Actual Footage Location of Well:<br>990 feet from the North line and 2,270 feet from the West line |                                 |                 |                                       |                |                                 |
| Ground Level Elev.<br>3,111.0'   | Producing Formation<br>Wolfcamp |                 | Pool<br>Carlsbad Wolfcamp, East (Gas) |                | Dedicated Acreage:<br>320 Acres |

1. Outline the acreage dedicated to the subject well by colored pencil or hachure marks on the plat below.
2. If more than one lease is dedicated to the well, outline each and identify the ownership thereof (interest and royalty).
3. If more than one lease of different ownership is dedicated to the well, have the interests of all owners been consolidated by communitization, unitization, force-pooling, etc?

☒ Yes ☐ No If answer is "yes," type of consolidation Voluntary Pooling O. C. D.  
ARTESIA, OFFICE

If answer is "no," list the owners and tract descriptions which have actually been consolidated. (Use reverse side of this form if necessary.)

No allowable will be assigned to the well until all interests have been consolidated (by communitization, unitization, forced-pooling, or otherwise) or until a non-standard unit, eliminating such interests, has been approved by the Division.

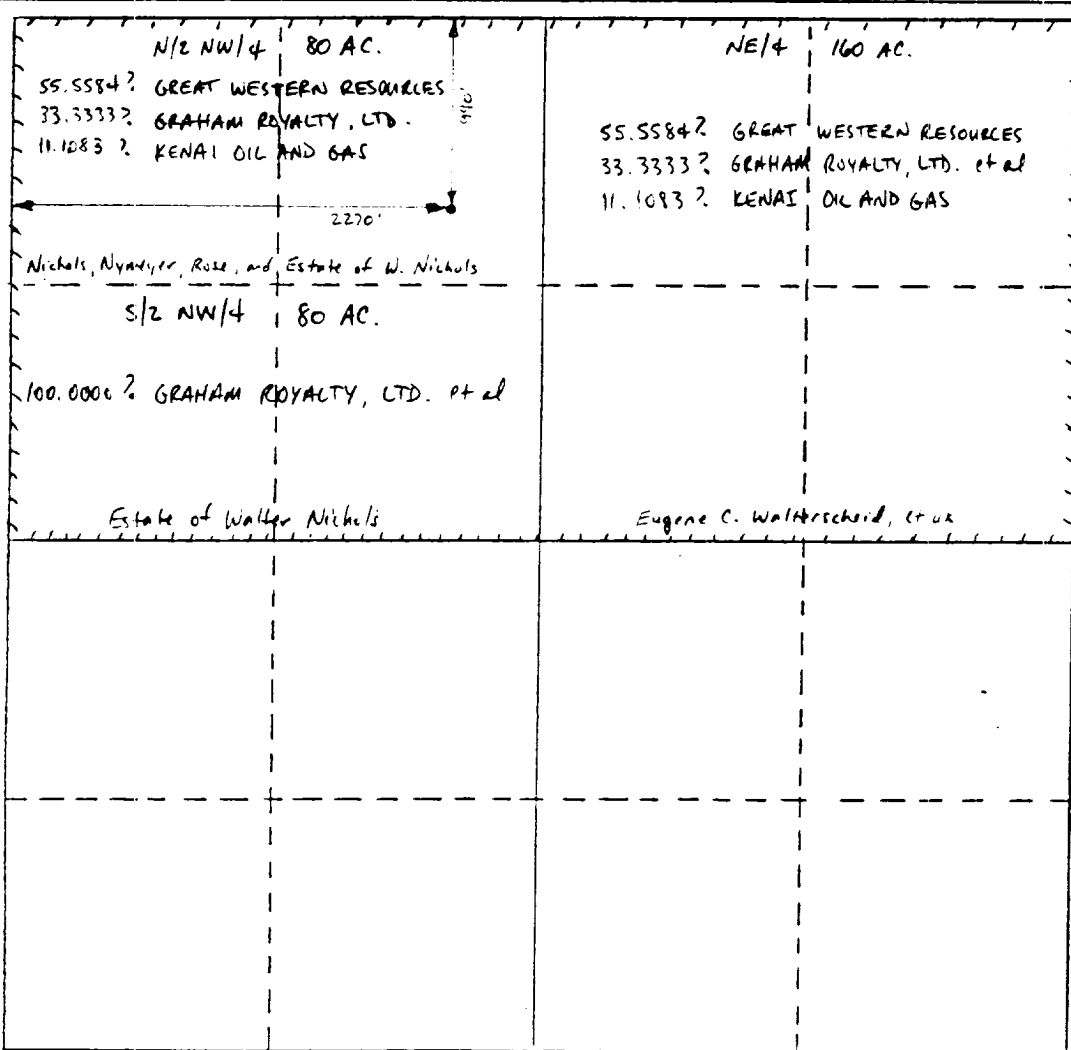

CERTIFICATION

I hereby certify that the information contained herein is true and complete to the best of my knowledge and belief.

Name Jay E. Johnson  
Position District Engineer  
Company Graham Royalty, Ltd.

Date 8/3/88

I hereby certify that the well location shown on this plat was plotted from field notes of actual surveys made by me or under my supervision, and that the same is true and correct to the best of my knowledge and belief.

Date Surveyed

Registered Land Surveyor

Certificate No.

