

MEXICO OIL CONSERVATION COMMIS
WELL LOCATION AND ACREAGE DEDICATION PLAT

Form C-102
 Supersedes C-128
 Effective 1-1-65

All distances must be from the outer boundaries of the Section.

Operator SUN EXPLORATION & PRODUCTION CO.			Lease PECOS IRRIGATION CO.		Well No. 1
Unit Letter G	Section 10	Township 23-S	Range 28-E	County EDDY	
Actual Footage Location of Well: 1980 feet from the NORTH line and 2130 feet from the EAST line					
Ground Level Elev. 3019'	Producing Formation Atoka, Morrow		Pool NE Leving	Dedicated Acreage: 320 Acres	

1. Outline the acreage dedicated to the subject well by colored pencil or hachure marks on the plat below.
2. If more than one lease is dedicated to the well, outline each and identify the ownership thereof (both as to working interest and royalty).
3. If more than one lease of different ownership is dedicated to the well, have the interests of all owners been consolidated by communitization, unitization, force-pooling, etc?

☒ Yes ☐ No If answer is "yes," type of consolidation UNITIZATION AGREEMENT

If answer is "no," list the owners and tract descriptions which have actually been consolidated. (Use reverse side of this form if necessary.) _____

No allowable will be assigned to the well until all interests have been consolidated (by communitization, unitization, forced-pooling, or otherwise) or until a non-standard unit, eliminating such interests, has been approved by the Commission.

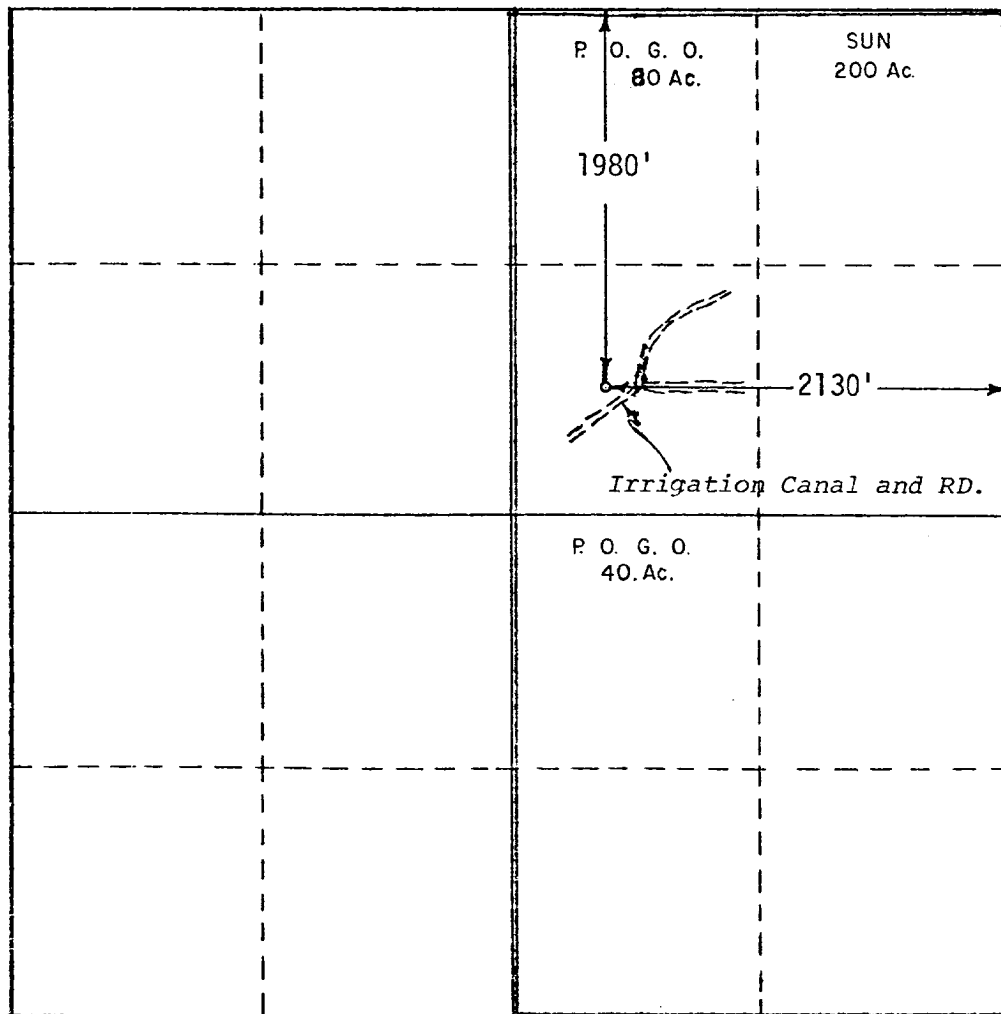

CERTIFICATION

I hereby certify that the information contained herein is true and complete to the best of my knowledge and belief.

Sue Clark

Name
 Production Staff Associate
 Position
 Sun Exploration & Production
 Company
 February 22, 1982
 Date

I hereby certify that the well location shown on this plat was plotted from field notes of actual surveys made by me or under my supervision, and that the same is true and correct to the best of my knowledge and belief.

FEBRUARY 18, 1982

Date Surveyed
GARY D. BOSWELL
 Registered Professional Engineer
 and/or Land Surveyor

Gary D. Boswell
 Certificate No.

6689

