

NEW MEXICO OIL CONSERVATION COMMISSION
WELL LOCATION AND ACREAGE DEDICATION PLAT

REL- 9 1982
O. C. D. ARTESIA, OFFICE
Form C-102
Supersedes C-128
Effective 1-4-65
AMENDED

All distances must be from the outer boundaries of the Section.

Operator SUN GAS COMPANY		Lease PECOS IRRIGATION CO.		Well No. 1	
Unit Letter G	Section 10	Township 23-S	Range 28-E	County EDDY	
Actual Footing - Location of Well: 1980' feet from the NORTH line and 2130' feet from the EAST line					
Ground Level Elev. 3019'	Producing Formation Morrison atoka		Pool S. Culberson Bluff atoka	Dedicated Acreage: 320 Acres	

1. Outline the acreage dedicated to the subject well by colored pencil or hatchure marks on the plat below.
2. If more than one lease is dedicated to the well, outline each and identify the ownership thereof (both as to working interest and royalty).
3. If more than one lease of different ownership is dedicated to the well, have the interests of all owners been consolidated by communitization, unitization, force-pooling, etc?

☐ Yes ☐ No If answer is "yes," type of consolidation _____

If answer is "no," list the owners and tract descriptions which have actually been consolidated. (Use reverse side of this form if necessary.) _____

No allowable will be assigned to the well until all interests have been consolidated (by communitization, unitization, force-pooling, or otherwise) or until a non-standard unit, eliminating such interests, has been approved by the Commission.

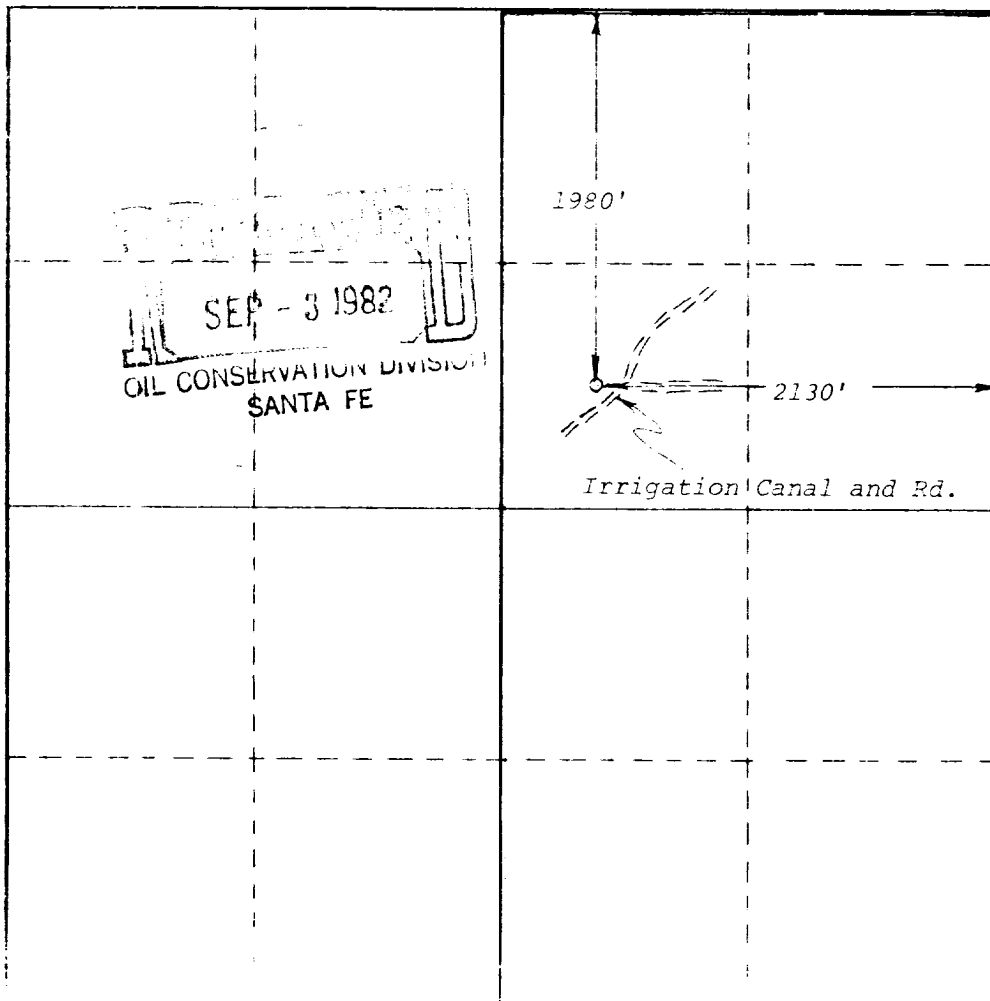

CERTIFICATION

I hereby certify that the information contained herein is true and complete to the best of my knowledge and belief.

Name
Production Staff Associate
Position
Sun Exploration & Production Co.
Company
August 30, 1982
Date

I hereby certify that the well location shown on this plat was plotted from field notes of actual surveys made by me or under my supervision, and that the same is true and correct to the best of my knowledge and belief.

February 18, 1982

Date Surveyed
Gary D. Boswell

Registered Professional Engineer and/or Land Surveyor

Gary D. Boswell