

NE MEXICO OIL CONSERVATION COMMISSION
WELL LOCATION AND ACREAGE DEDICATION PLAT

Form C-102
Supersedes C-128
Effective 1-1-65

All distances must be from the outer boundaries of the Section

Operator H N G Oil Company			Lease Pardue 30 Com		Well No. 1
Unit Letter E	Section 30	Township 23 South	Range 28 East	County Eddy	
Actual Footage Location of Well: 1980 feet from the north line and 983 feet from the west line					
Ground Level Elev. 3089.3'	Producing Formation Morrow	Pool Unit North-South West Loving-Wildeat		Dedicated Acreage: 320 Acres	

1. Outline the acreage dedicated to the subject well by colored pencil or hatchure marks on the plat below.
2. If more than one lease is dedicated to the well, outline each and identify the ownership thereof (both as to working interest and royalty).
3. If more than one lease of different ownership is dedicated to the well, have the interests of all owners been consolidated by communitization, unitization, force-pooling, etc?

☐ Yes ☐ No If answer is "yes," type of consolidation Communitization agreement being
circulated for execution. (OVER)

If answer is "no," list the owners and tract descriptions which have actually been consolidated. (Use reverse side of this form if necessary.) _____

No allowable will be assigned to the well until all interests have been consolidated (by communitization, unitization, forced-pooling, or otherwise) or until a non-standard unit, eliminating such interests, has been approved by the Commission.

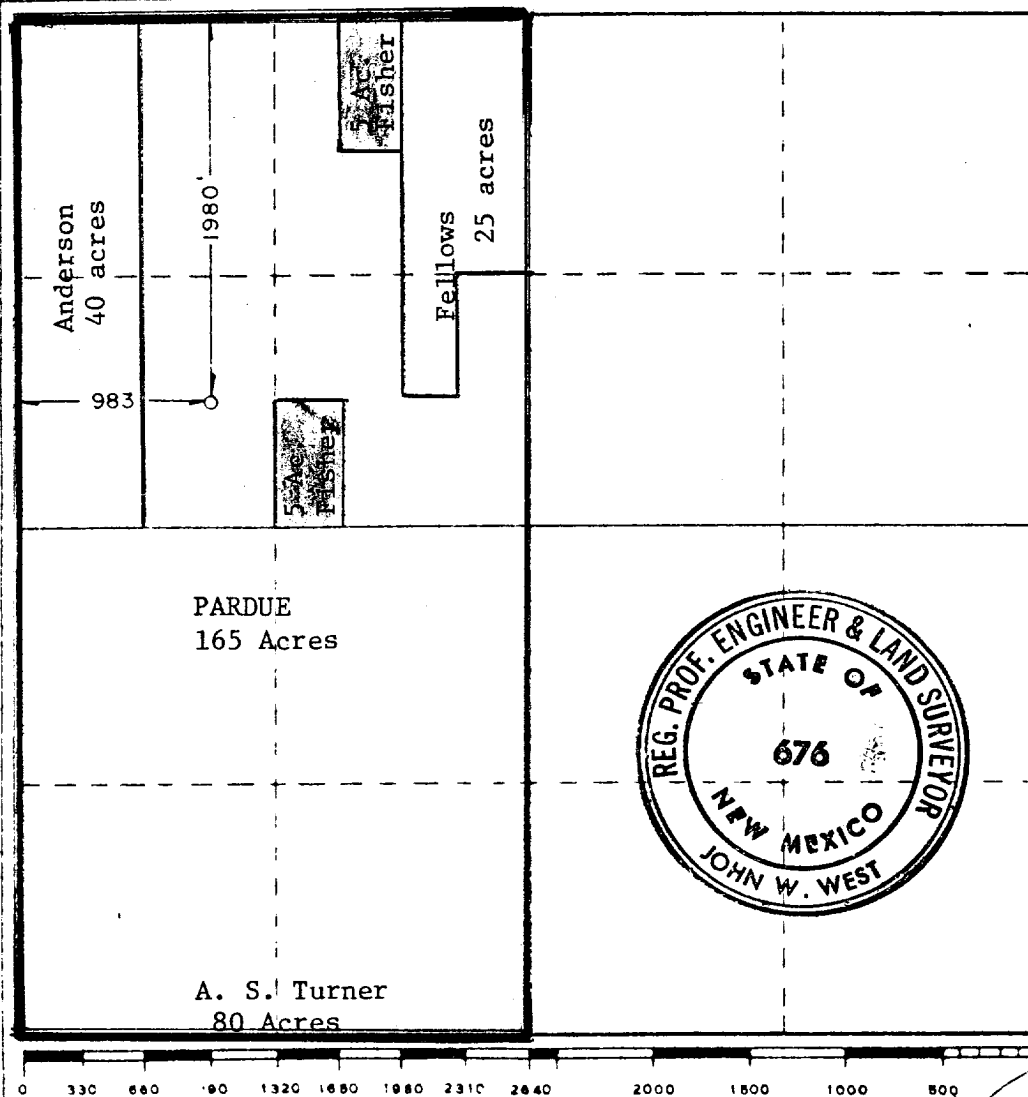

CERTIFICATION

I hereby certify that the information contained herein is true and complete to the best of my knowledge and belief

Betty Gildon

Name

Betty Gildon

Position

Regulatory Analyst

Company

HNG OIL COMPANY

Date

April 14, 1982

I hereby certify that the well location shown on this plat was plotted from field notes of actual surveys made by me or under my supervision, and that the same is true and correct to the best of my knowledge and belief.

Date Surveyed

4-3-82

Registered Professional Engineer and/or Land Surveyor

John W. West

Certificate No. **JOHN W. WEST 676**
PATRICK A. ROMERO 16063
Ronald J. Eidson 3239

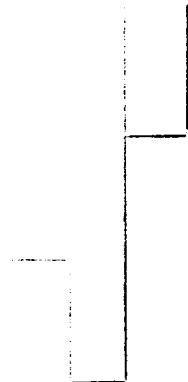

<input checked="" type="checkbox"/>	JAMES ISBELL etal
<input type="checkbox"/>	ROY MCKAY
<input type="checkbox"/>	HNG OIL COMPANY

285 acres	Pardue Farms 165 Ac. 3/16 RI
	Catherine Tipton Anderson, etal 40 Ac. 3/16 RI
	A. S. Turner 80 Ac. 3/16 RI
25 acres	Leland Fellows, etal 3/16 RI
10 acres	Charles Fisher, etal 3/16 RI