

NEW MEXICO OIL CONSERVATION COMMISSION
WELL LOCATION AND ACREAGE DEDICATION PLAT

Form C-102
Supersedes C-128
Effective 1-1-65

All distances must be from the outer boundaries of the Section.

Operator W. A. MONCRIEF JR.		Lease RIDGE FEDERAL		Well No. 1
Unit Letter C	Section 23	Township 24 South	Range 24 East	County Eddy
Actual Footage Location of Well: 487 feet from the North line and 1620 feet from the West line				
Ground Level Elev: 4639	Producing Formation Morrow	Pool Baldrige Canyon Morrow	Dedicated Acreage: 320 Acres	

1. Outline the acreage dedicated to the subject well by colored pencil or hatchure marks on the plat below.
2. If more than one lease is dedicated to the well, outline each and identify the ownership thereof (both as to working interest and royalty).
3. If more than one lease of different ownership is dedicated to the well, have the interests of all owners been consolidated by communitization, unitization, force-pooling, etc?

☐ Yes ☐ No If answer is "yes," type of consolidation _____

If answer is "no," list the owners and tract descriptions which have actually been consolidated. (Use reverse side of this form if necessary.) _____

No allowable will be assigned to the well until all interests have been consolidated (by communitization, unitization, forced-pooling, or otherwise) or until a non-standard unit, eliminating such interests, has been approved by the Commission.

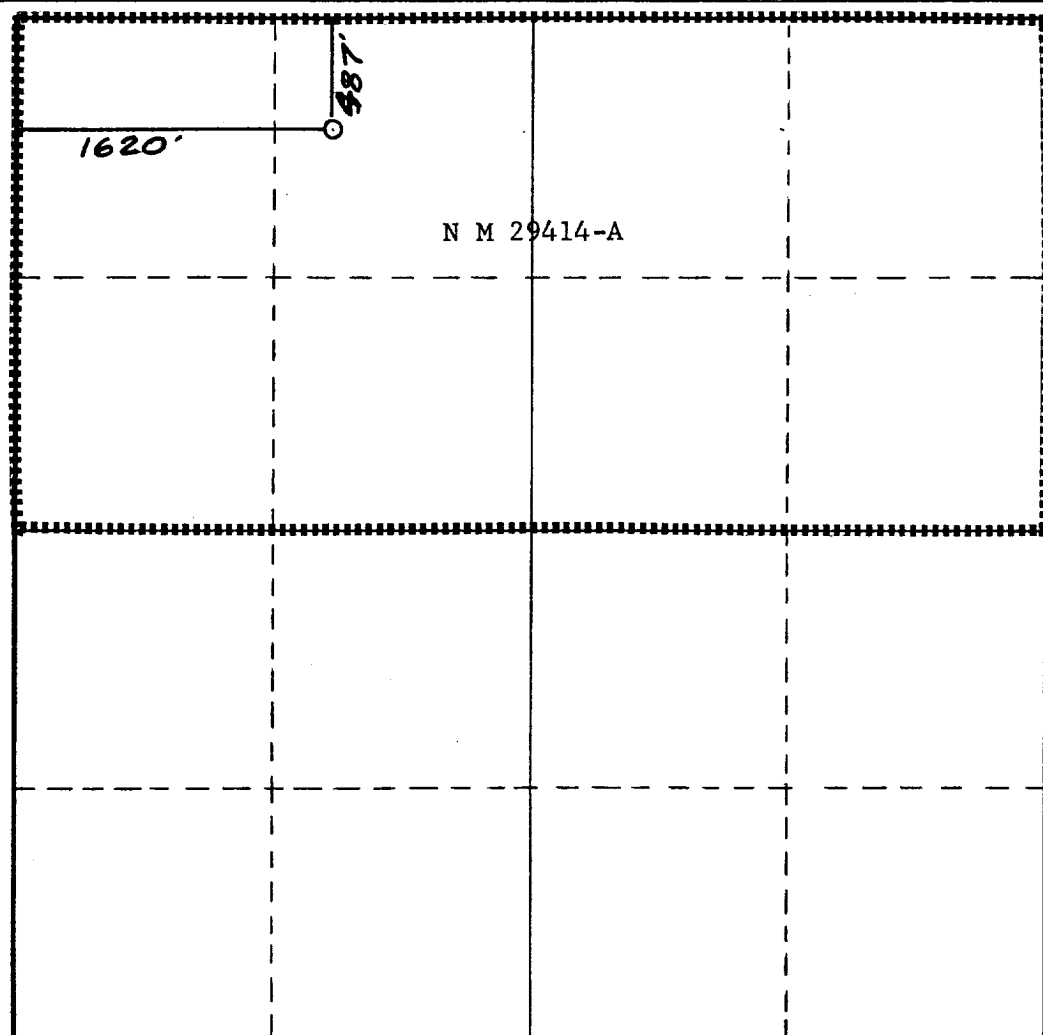

CERTIFICATION

I hereby certify that the information contained herein is true and complete to the best of my knowledge and belief.

Dewey E. Thornton

Name

Dewey E. Thornton

Position

Exploration Manager

Company

W.A. Moncrief, Jr.

Date

5-25-82

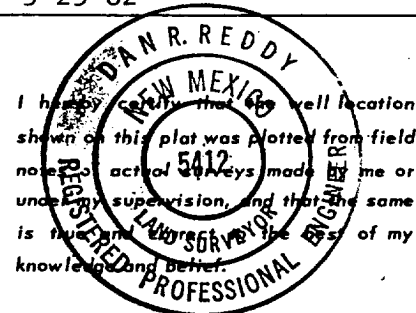

Date Surveyed

Apr. 3, 1982

Registered Professional Engineer
and/or Land Surveyor

Dan R. Reddy

Certificate No.

NMPE&LS 54120

0 330 660 990 1320 1650 1980 2310 2640 2970 3300 3630 3960 4290 4620 4950 5280 5610 5940 6270 6600 6930 7260 7590 7920 8250 8580 8910 9240 9570 9900 10230 10560 10890 11220 11550 11880 12210 12540 12870 13200 13530 13860 14190 14520 14850 15180 15510 15840 16170 16500 16830 17160 17490 17820 18150 18480 18810 19140 19470 19800 20130 20460 20790 21120 21450 21780 22110 22440 22770 23100 23430 23760 24090 24420 24750 25080 25410 25740 26070 26400 26730 27060 27390 27720 28050 28380 28710 29040 29370 29700 30030 30360 30690 31020 31350 31680 32010 32340 32670 33000