

Artesia, NM 88210  
UNITED STATESSUBMIT IN TRIPlicate\*  
(Other instructions on  
reverse side)Form approved.  
Budget Bureau No. 42-R1425.DEPARTMENT OF THE INTERIOR  
GEOLOGICAL SURVEY

## APPLICATION FOR PERMIT TO DRILL, DEEPEN, OR PLUG BACK

## 1a. TYPE OF WORK

DRILL ☒DEEPEN ☐PLUG BACK ☐

## b. TYPE OF WELL

OIL  
WELL ☐GAS  
WELL ☒

OTHER

SINGLE  
ZONE ☐MULTIPLE  
ZONE ☒

## 2. NAME OF OPERATOR

Cimarron Energy Corporation ✓

## 3. ADDRESS OF OPERATOR

P.O. Box 1525 Carlsbad, N.M. 88220 O.C.D. ARTESIA OFFICE

## 4. LOCATION OF WELL (Report location clearly and in accordance with any State requirements.)\*

At surface

580' 1980' FWL 660' FSL Sec. 34, T22S, R28E, N.M.P.M.  
At proposed prod. zone 591' Eddy County, New Mexico

N/A

## 14. DISTANCE IN MILES AND DIRECTION FROM NEAREST TOWN OR POST OFFICE\*

Approximately 7 miles from Carlsbad, N.M. East

## 15. DISTANCE FROM PROPOSED\*

LOCATION TO NEAREST  
PROPERTY OR LEASE LINE, FT.  
(Also to nearest drlg. unit line, if any)

660'

18. DISTANCE FROM PROPOSED LOCATION\*  
TO NEAREST WELL, DRILLING, COMPLETED,  
OR APPLIED FOR, ON THIS LEASE, FT.

None

## 16. NO. OF ACRES IN LEASE

400

## 19. PROPOSED DEPTH

12800

17. NO. OF ACRES ASSIGNED  
TO THIS WELL

320

## 20. ROTARY OR CABLE TOOLS

Rotary

## 21. ELEVATIONS (Show whether DF, RT, GR, etc.)

3028.5' GR 31'

## 22. APPROX. DATE WORK WILL START\*

As soon as possible

## 23. PROPOSED CASING AND CEMENTING PROGRAM

SIZE OF HOLE	SIZE OF CASING	WEIGHT PER FOOT	SETTING DEPTH	QUANTITY OF CEMENT
26"	20"	see Exhibit D	300'	CIRCULATE see Exhibit E
17 1/2"	13 3/8"	"	2500'	TIE-BACK TO SURFACE CASING.
12 1/4"	9 5/8"	"	10000'	"
8 1/2"	7"	"	11900'	"
6 1/2"	4 1/2"	"	12800'	"

Drilling Fluid Program: see Exhibit F

BOP Program: see Exhibit G

Gas not dedicated

IN ABOVE SPACE DESCRIBE PROPOSED PROGRAM: If proposal is to deepen or plug back, give data on present productive zone and proposed new productive zone. If proposal is to drill or deepen directionally, give pertinent data on subsurface locations and measured and true vertical depths. Give blowout preventer program, if any.

24.

SIGNED James W. Stewart TITLE Corporate Secretary DATE 27 June 1982

(This space for Federal or State office use)

PERMIT NO. Orig. Sgd.) GEORGE H. STEWART

APPROVAL DATE

APPROVED BY JUN 29 1982

TITLE

DATE

CONDITIONS OF APPROVAL, IF ANY:

JAMES A. CHAMBERLAIN  
DISTRICT SUPERVISOR

NMOCDA APPROVAL FOR NON-STD. LOC.

Posted ID-1  
7-16-82  
N. Lee + Apr

All distances must be from the outer boundaries of the Section.

Operator <b>Cimarron Energy Corporation</b>		Lease <b>Cimarron</b>		Well No. <b>1</b>
Unit Letter <b>N</b>	Section <b>34</b>	Township <b>22 South</b>	Range <b>28 East</b>	County <b>EDDY</b>
Actual Footage Location of Well:				
<b>591</b> feet from the <b>South</b> line and		<b>1585'</b> feet from the <b>West</b> line		
Ground Level Elev. <b>3035.7</b>	Producing Formation <b>Atoka/Morrow</b>	Pool <b>Wilcoat</b>	Dedicated Acreage: <b>320</b> Acres	

1. Outline the acreage dedicated to the subject well by colored pencil or hatchure marks on the plat below.
2. If more than one lease is dedicated to the well, outline each and identify the ownership thereof (both as to working interest and royalty).
3. If more than one lease of different ownership is dedicated to the well, have the interests of all owners been consolidated by communitization, unitization, force-pooling, etc?

☒ Yes ☐ No If answer is "yes," type of consolidation Communitization

If answer is "no," list the owners and tract descriptions which have actually been consolidated. (Use reverse side of this form if necessary.)

No allowable will be assigned to the well until all interests have been consolidated (by communitization, unitization, forced-pooling, or otherwise) or until a non-standard unit, eliminating such interests, has been approved by the Division.

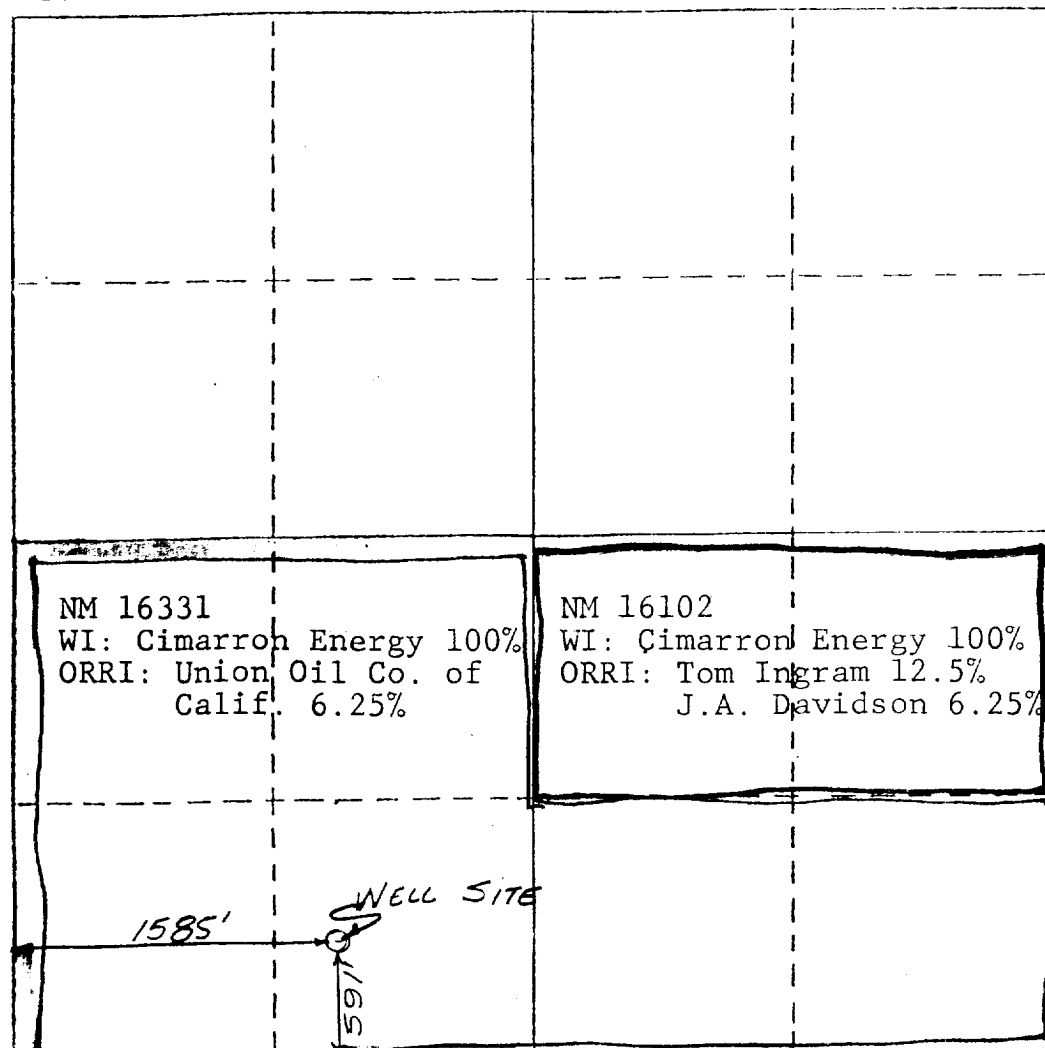

#### CERTIFICATION

I hereby certify that the information contained herein is true and complete to the best of my knowledge and belief.

*James W. Klipstine, Jr.*  
Name **James W. Klipstine, Jr.**

**Vice-President of Operations**  
Position

**CIMARRON ENERGY CORPORATION**  
Company

**July 1, 1982**  
Date

I hereby certify that the well location shown on this plat was plotted from field notes of actual surveys made by me or under my supervision, and that the same is true and correct to the best of my knowledge and belief.

**June 30, 1982**  
Date Surveyed

*Gary Robertson*  
Registered Professional Engineer  
and/or Land Surveyor

**NMLS 6692**

Certificate No.

## DESIGNATION OF OPERATOR

The undersigned is, on the records of the Bureau of Land Management, holder of lease

DISTRICT LAND OFFICE: Roswell District Office  
SERIAL NO.: NM 16331

and hereby designates

NAME: Cimarron Energy Corp.  
ADDRESS: P.O. Box 1525, Carlsbad, N.M. 88220

as his operator and local agent, with full authority to act in his behalf in complying with the terms of the lease and regulations applicable thereto and on whom the supervisor or his representative may serve written or oral instructions in securing compliance with the Operating Regulations with respect to (describe acreage to which this designation is applicable):

Township 22 South, Range 28 East, N.M.P.M.  
Section 34: SW/4, S/2 SE/4

containing 240 acres

It is understood that this designation of operator does not relieve the lessee of responsibility for compliance with the terms of the lease and the Operating Regulations. It is also understood that this designation of operator does not constitute an assignment of any interest in the lease.

In case of default on the part of the designated operator, the lessee will make full and prompt compliance with all regulations, lease terms, or orders of the Secretary of the Interior or his representative.

The lessee agrees promptly to notify the supervisor of any change in the designated operator.

EVIDENCE OF AUTHORITY OF ATTORNEY-  
IN-FACT IS NOT IN POSSESSION  
AND SUCH AUTHORITY IS STILL IN EFFECT.

UNION OIL COMPANY OF CALIFORNIA

BY: \_\_\_\_\_

(Signature of lessee) Attorney-in-Fact

\_\_\_\_\_  
(Date)

P. O. Box 3100, Midland, TX 79702

\_\_\_\_\_  
(Address)

EXHIBIT D  
Application For Drilling Permit

CIMARRON ENERGY CORPORATION  
Cimarron "RB" Federal Well #1  
1980' FWL 660' FSL Sec 34  
T22S R28E N.M.P.M. Eddy Co. N.M.

In conjunction with Form 9-331C, Application for Permit to Drill subject well, Cimarron Energy Corp. submits the following ten items of pertinent information in accordance with USGS requirements:

1. The geologic surface formation is Permian.
2. The estimated tops of geologic markers are as follows:

Tertiary	Surface
Delaware	2450'
Bone Springs	5980'
Wolfcamp	9280'
Cisco	10600'
Canyon	10890'
Strawn	11275'
Atoka Clastics	11520'
Atoka Carbonate	11680'
Morrow	12120'
Chester	12775'
TD	12800'

3. The estimated depths at which anticipated water, oil or gas formations are expected to be encountered:

Water: Approx. 250'

Oil or Gas:	Wolfcamp	9280' - 10600'
	Cisco	10600' - 10890'
	Canyon	10890' - 11275'
	Atoka	11520' - 11680'
	Morrow	12120' - 12775'

4. Proposed Casing Program: see Exhibit D
5. Pressure Control Equipment: see Exhibit G
6. Drilling Fluids Program: see Exhibit F
7. Auxillary Equipment: see Exhibit H
8. Testing, Logging, and Coring programs:

Drill Stem Tests( all DST's to be justified by  
a valid show of oil):

Delaware  
Wolfcamp  
Atoka  
Morrow

9. No abnormal pressures or temperatures are anticipated.
10. Anticipated Starting Date: As soon as possible but no later  
than 30 June 1982

SA:

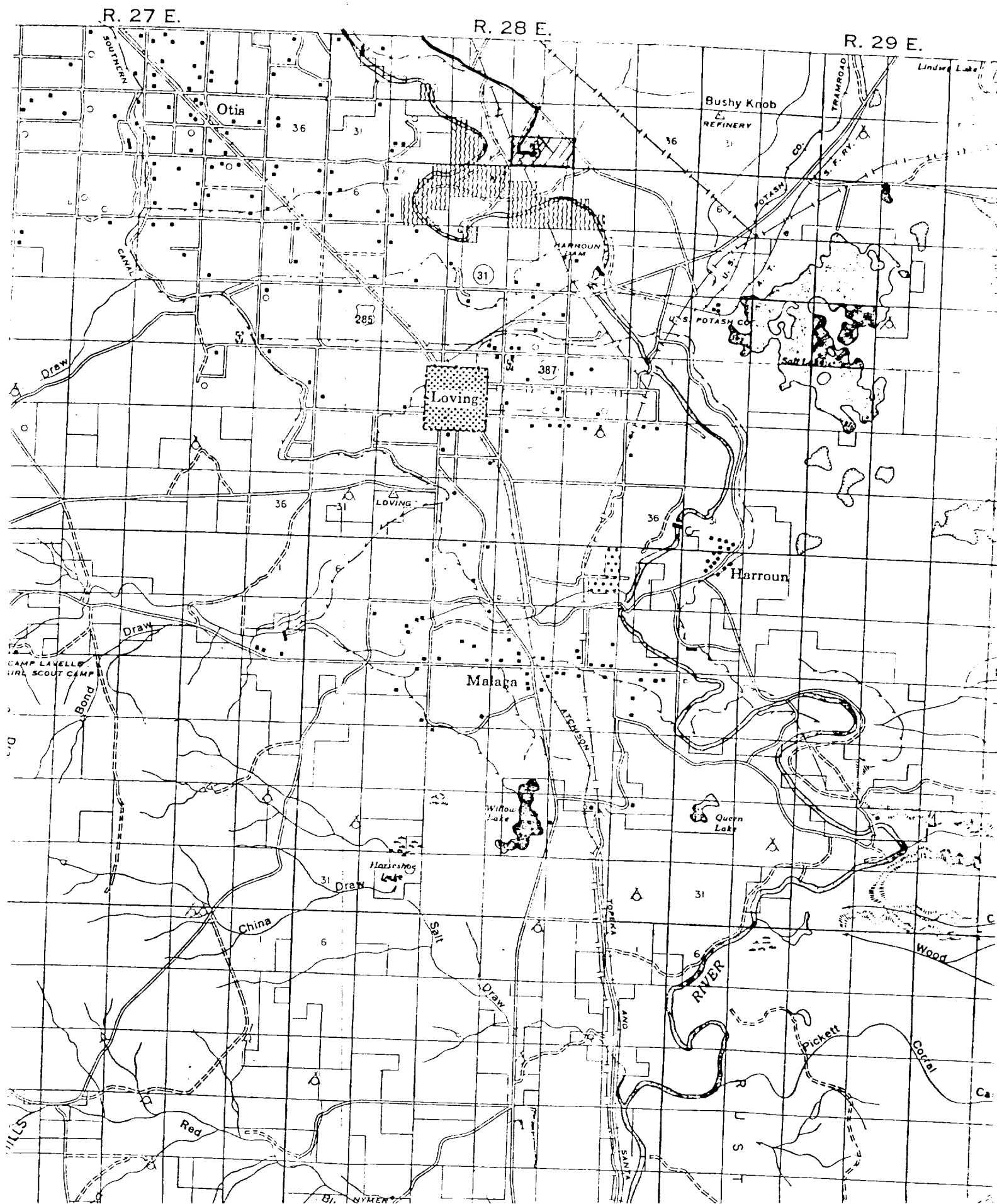

Exhibit G  
Cimarron Energy Corporation  
Cimarron "RB" Fed #1  
1980<sup>+</sup> FWL 660' FSL sec 34  
T22S R28E N.M.P.M. Eddy Co.  
New Mexico

BLOWOUT PREVENTER EQUIPMENT

Surface Casing - 20"

1. One 20", 2,000 psi, Type GK Hydrill preventer.

Intermediate Casing - 13 3/8"

1. One 12", 3,000 psi, double Cameron QRC preventer.
2. One 12", 3,000 psi, Type GK Hydrill preventer.
3. One 5,000 psi, choke manifold.
4. One 3,000 psi, drilling head and stripper.

Intermediate Casing - 9 5/8"

1. One 11", 10,000 psi, Cameron Type U double preventer.
2. One 11", 10,000 psi, Cameron Type U single preventer.
3. One 11", 5,000 psi, Type GK Hydrill preventer.
4. One 11", 3,000 psi, drilling head and stripper.
5. One 4 1/16", 10,000 psi, choke manifold with two 10,000 psi Swaco chokes.
6. One 4 1/16", 10,000 psi, manual and one 4 1/16", 10,000 psi, hydraulic valve between choke spool and choke manifold.
7. One 2 1/16", 10,000 psi, manual and one 2 1/16", 10,000 psi hydraulic valve between casing head spool and choke manifold.

Blowout preventer equipment will be hydraulically actuated with a six station, 3,000 psi Koomey accumulator with remote control station on the rig floor. Accumulator is to have sufficient capacity to close all pressure operated devices at one time and maintain a 25% reserve.

Intermediate Casing - 9 5/8" (Continued)

After each BOP stack is assembled, a plug will be set in the casinghead and the stack tested to rated working pressure.

All BOP equipment shall be checked for proper working order on each trip. Choke manifold and lines should be flushed periodically with water. Swaco chokes are to be checked on each tour by driller.

Blowout preventer drills are to be held not less than twice weekly by each drilling crew. All crew members are to be familiar with BOP and choke manifold operation and their respective duties in the event of a kick.