

U.S. CONSERVATION DIVISION

STATE OF NEW MEXICO
OIL AND MINERALS DEPARTMENT

P. O. BOX 2088
SANTA FE, NEW MEXICO 87501

Form C-102
Revised 10-1-78

All distances must be from the outer boundaries of the Section.

Owner Cimeron Energy			Lease Cimarron "RB"		Well No. 1
Section 34	Township 22 South	Range 28 East	County Eddy		

Postage Location of Well:
1980 feet from the **South** line and **660** feet from the **West** line.
 Level Elev. **940** Producing Formation **Atoka/Morrow** Pool **Wildcat** Dedicated Acreage: **320** Acres

Outline the acreage dedicated to the subject well by colored pencil or hatchure marks on the plat below.

If more than one lease is dedicated to the well, outline each and identify the ownership thereof (both as to working interest and royalty).

If more than one lease of different ownership is dedicated to the well, have the interests of all owners been consolidated by communitization, unitization, force-pooling, etc?

☒ Yes ☐ No If answer is "yes," type of consolidation Communitization #SCR-309

If answer is "no," list the owners and tract descriptions which have actually been consolidated. (Use reverse side of this form if necessary.)

No allowable will be assigned to the well until all interests have been consolidated (by communitization, unitization, forced-pooling, or otherwise) or until a non-standard unit, eliminating such interests, has been approved by the Division.

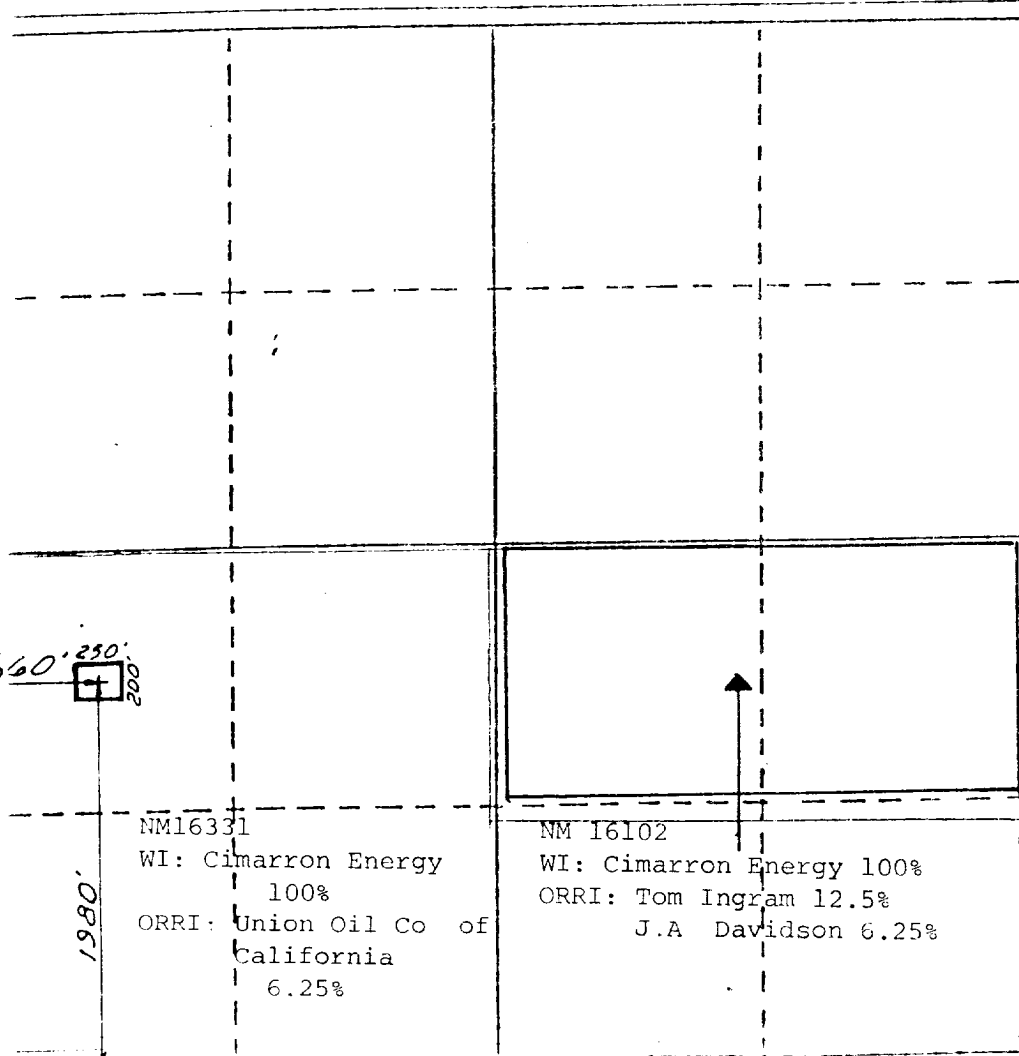

CERTIFICATION

I hereby certify that the information contained herein is true and complete to the best of my knowledge and beliefs.

Name James W. Klipstine
 Position Vice-President-Operations
 Company Cimarron Energy Corporation
 Date 10 August 1982

I hereby certify that the well location shown on this plat was plotted from field notes of actual surveys made by me or under my supervision, and that the same is true and correct to the best of my knowledge and belief.

July 28, 1982

Date Surveyed Gary Robertson
 Registered Professional Engineer and/or L.S. Surveyor

N.M.L.S. #6692