

DEPARTMENT OF THE INTERIOR
GEOLOGICAL SURVEY

(Other instructions on reverse side)

Budget Bureau No. 42-R1424

5. LEASE DESIGNATION AND SERIAL NO.

NM 17224

6. IF INDIAN, ALLOTTEE OR TRIBE NAME

SUNDRY NOTICES AND REPORTS ON WELLS

(Do not use this form for proposals to drill or to deepen or plug back to a different reservoir. Use "APPLICATION FOR PERMIT—" for such proposals.)

7. UNIT AGREEMENT NAME

8. FARM OR LEASE NAME

Queen Lake 19 Federal

9. WELL NO.

1

10. FIELD AND POOL, OR WILDCAT
Wildcat Atoka

11. SEC., T., R., M., OR BLK. AND SURVEY OR AREA

Sec. 19, T24S, R29E

12. COUNTY OR PARISH
Eddy

13. STATE
NM

1. OIL WELL ☐ GAS WELL ☒ OTHER

NM OIL CONS. COMMISSION

2. NAME OF OPERATOR
HNG OIL COMPANY

Drawer DD
Artesia, NM 88210

3. ADDRESS OF OPERATOR
P. O. Box 2267, Midland, Texas 79702

RECEIVED

4. LOCATION OF WELL (Report location clearly and in accordance with any State requirements. See also space 17 below.)
At surface

JAN 13 1983

O. C. D.

ARTESIA OFFICE

14. PERMIT NO.

15. ELEVATIONS (Show whether DF, RT, GR, etc.)
2956' GR

16.

Check Appropriate Box To Indicate Nature of Notice, Report, or Other Data

NOTICE OF INTENTION TO:

TEST WATER SHUT-OFF

FRACTURE TREAT

SHOOT OR ACIDIZE

REPAIR WELL

(Other)

PULL OR ALTER CASING

MULTIPLE COMPLETE

ABANDON*

CHANGE PLANS

SUBSEQUENT REPORT OF: 1/3/83

WATER SHUT-OFF

FRACTURE TREATMENT

SHOOTING OR ACIDIZING

(Other) See below

REPAIRING WELL

ALTERING CASING

ABANDONMENT*

(NOTE: Report results of multiple completion on Well Completion or Recompletion Report and Log form.)

17. DESCRIBE PROPOSED OR COMPLETED OPERATIONS (Clearly state all pertinent details, and give pertinent dates, including estimated date of starting any proposed work. If well is directionally drilled, give subsurface locations and measured and true vertical depths for all markers and zones pertinent to this work.)

Change producing formation from Morrow to Atoka. ✓

Perfs 12,154-12,163 (2 shot/ft. 20 holes .29" dia.)

Top Atoka 12,038'

Top Morrow 12,657'

18. I hereby certify that the foregoing is true and correct

SIGNED

David R. Glass

TITLE

Regulatory Analyst

DATE 1/7/83

(This space for Federal or State office use)

APPROVED BY
CONDITIONS OF APPROVAL

(ORIG. SGD.) DAVID R. GLASS

MINERALS MANAGEMENT SERVICE

• ROSWELL, NEW MEXICO

*See Instructions on Reverse Side

RECEIVED

JAN 11 1983

OIL & GAS
MINERALS MGMT. SERVICE
ROSWELL, NEW MEXICO

**NEW MEXICO OIL CONSERVATION COMMISSION
WELL LOCATION AND ACREAGE DEDICATION PLAT**

Form C-102
Supersedes C-128
Effective 1-1-65

All distances must be from the outer boundaries of the Section

Operator HNG Oil Company		Lease Queen Lake 19 Federal		Well No. 1
Unit Letter G	Section 19	Township 24 South	Range 29 East	County Eddy County
Actual Footage Location of Well:				
1950 feet from the North line and		1980 feet from the East line		
Ground Level Elev. 2956.0	Producing Formation Atoka	Pool Wildcat	Dedicated Acreage: 320 Acres	

1. Outline the acreage dedicated to the subject well by colored pencil or hatchure marks on the plat below.
2. If more than one lease is dedicated to the well, outline each and identify the ownership thereof (both as to working interest and royalty).
3. If more than one lease of different ownership is dedicated to the well, have the interests of all owners been consolidated by communitization, unitization, force-pooling, etc?

☐ Yes ☐ No If answer is "yes," type of consolidation _____

If answer is "no," list the owners and tract descriptions which have actually been consolidated. (Use reverse side of this form if necessary.) _____

No allowable will be assigned to the well until all interests have been consolidated (by communitization, unitization, forced-pooling, or otherwise) or until a non-standard unit, eliminating such interests, has been approved by the Commission.

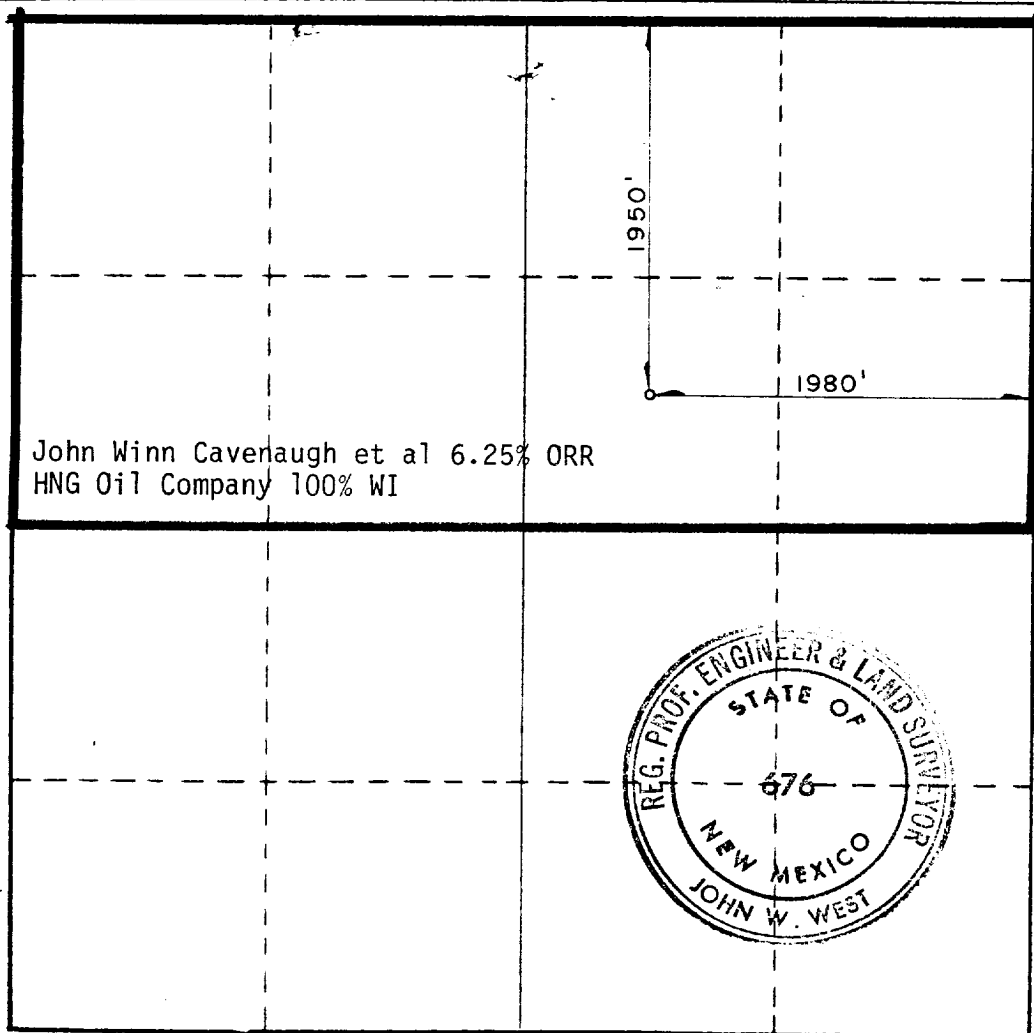

CERTIFICATION

I hereby certify that the information contained herein is true and complete to the best of my knowledge and belief.

Betty Gildon

Name
Betty Gildon

Position
Regulatory Analyst

Company
HNG OIL COMPANY

Date
January 7, 1983

I hereby certify that the well location shown on this plat was plotted from field notes of actual surveys made by me or under my supervision, and that the same is true and correct to the best of my knowledge and belief.

Date Surveyed
10/08/82

Registered Professional Engineer
and/or Land Surveyor

Certificate No. **JOHN W. WEST 676**
PATRICK A. ROMERO 6868
Ronald J. Eidson 3239

