

**NEW MEXICO OIL CONSERVATION COMMISSION
WELL LOCATION AND ACREAGE DEDICATION PLAT**

Form C-102
Supersedes C-128
Effective 1-1-65

All distances must be from the outer boundaries of the Section.

Operator THE EASTLAND OIL CO.			Lease FORTSON FED. COM.		Well No. 1
Unit Letter F	Section 12	Township 24 SOUTH	Range 28 EAST	County EDDY	
Actual Footage Location of Well:					
2140		feet from the WEST	line and 1830	feet from the NORTH	line
Ground Level Elev. 2957.9'	Producing Formation Morrow		Pool / Malaga		Dedicated Acreage: 320 Acres

1. Outline the acreage dedicated to the subject well by colored pencil or hachure marks on the plat below.
2. If more than one lease is dedicated to the well, outline each and identify the ownership thereof (both as to working interest and royalty).
3. If more than one lease of different ownership is dedicated to the well, have the interests of all owners been consolidated by communitization, unitization, force-pooling, etc?

☒ Yes ☐ No If answer is "yes," type of consolidation Communitization in progress

If answer is "no," list the owners and tract descriptions which have actually been consolidated. (Use reverse side of this form if necessary.) _____

No allowable will be assigned to the well until all interests have been consolidated (by communitization, unitization, forced-pooling, or otherwise) or until a non-standard unit, eliminating such interests, has been approved by the Commission.

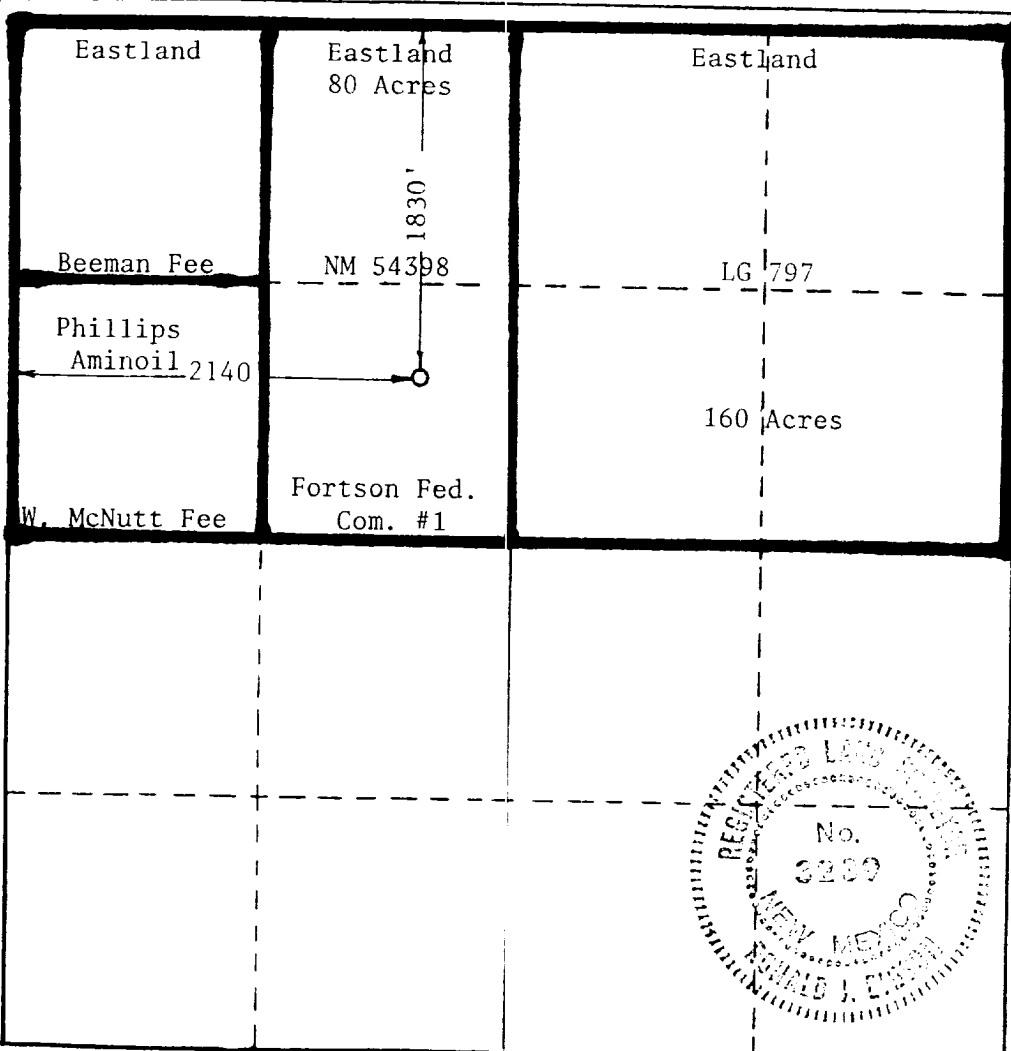

CERTIFICATION

I hereby certify that the information contained herein is true and complete to the best of my knowledge and belief.

Name
George D. Neal
Position
Vice President-Production
Company
The Eastland Oil Company
Date
October 18, 1982

I hereby certify that the well location shown on this plat was plotted from field notes of actual surveys made by me or under my supervision, and that the same is true and correct to the best of my knowledge and belief.

Date Surveyed
October 13, 1982
Registered Professional Engineer and/or Land Surveyor

Ronald J. Coulter
Certificate No. **JOHN W. WEST 676**
PATRICK A. ROMERO 6863

