

WELL LOCATION AND ACREAGE DEDICATION PLAT

Form C-102
Supersedes C-128
Effective 1-1-65

OCT 29 1982

All distances must be from the outer boundaries of the Section.

Operator JAKE L. HAMON			Lease STATE K 3328			O. C. F. Well No. ARTESIA, C. 1		
Unit Letter C	Section 36	Township 23 SOUTH	Range 26 EAST	County EDDY				
Actual Footage Location of Well: 660 feet from the NORTH line and 2080 feet from the WEST line								
Ground Level Elev. 3217.8	Producing Formation Morrow		Pool Und. S. Carlsbad Morrow			Dedicated Acreage: 320 Acres		

1. Outline the acreage dedicated to the subject well by colored pencil or hachure marks on the plat below.
2. If more than one lease is dedicated to the well, outline each and identify the ownership thereof (both as to working interest and royalty).
3. If more than one lease of different ownership is dedicated to the well, have the interests of all owners been consolidated by communitization, unitization, force-pooling, etc?

☐ Yes ☒ No If answer is "yes," type of consolidation _____

If answer is "no," list the owners and tract descriptions which have actually been consolidated. (Use reverse side of this form if necessary.) _____

No allowable will be assigned to the well until all interests have been consolidated (by communitization, unitization, forced-pooling, or otherwise) or until a non-standard unit, eliminating such interests, has been approved by the Commission. Farmout

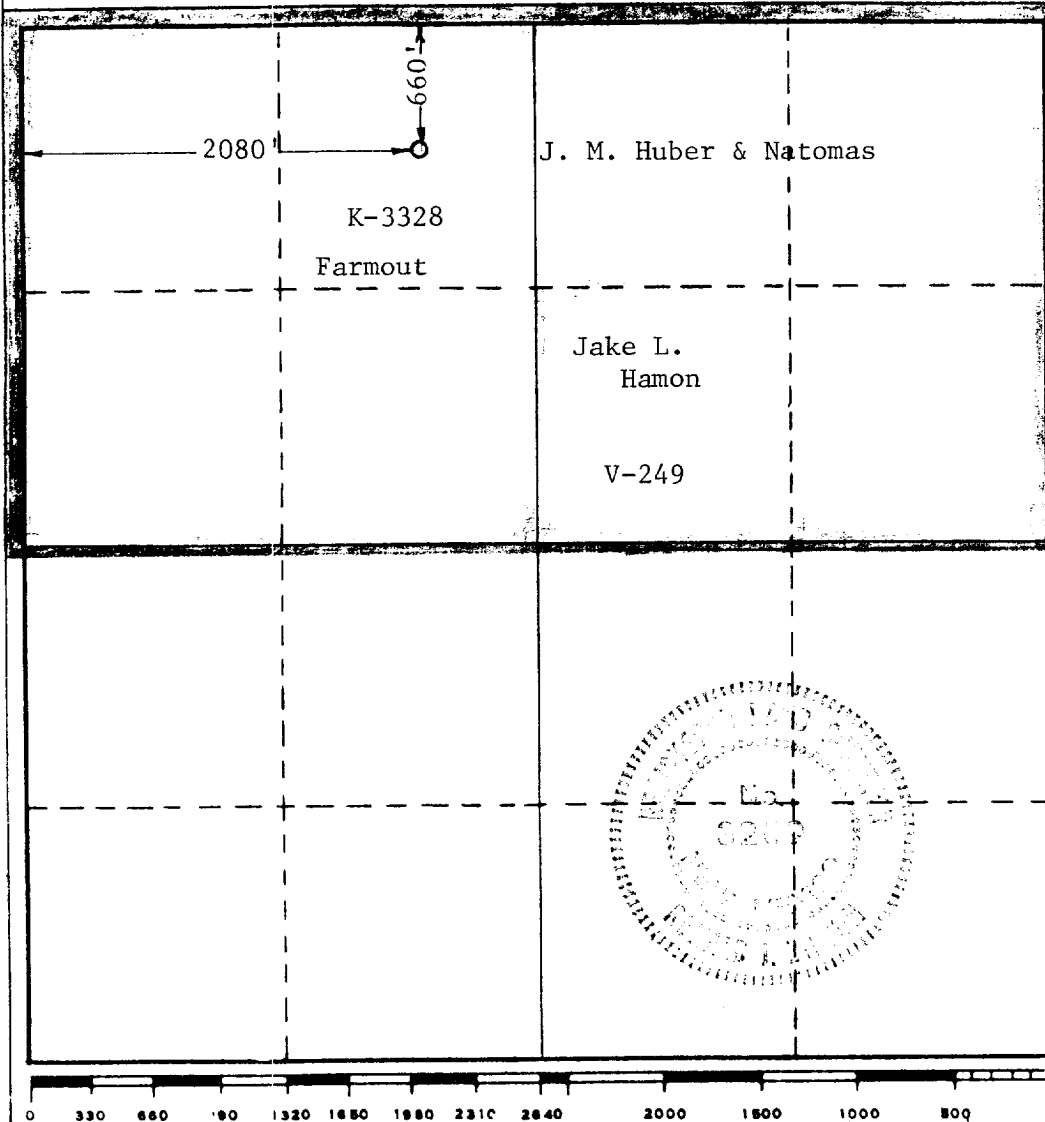

CERTIFICATION

I hereby certify that the information contained herein is true and complete to the best of my knowledge and belief.

[Signature]
Name

B. W. Cozart

Position

Drilling Foreman

Company

Jake L. Hamon

Date

10-27-82

I hereby certify that the well location shown on this plat was plotted from field notes of actual surveys made by me or under my supervision, and that the same is true and correct to the best of my knowledge and belief.

Date Surveyed

October 26, 1982

Registered Professional Engineer
and/or Land Surveyor

[Signature]
Certificate No. **JOHN W. WEST 676**
PATRICK A. ROMERO 6663
Ronald J. Eidson 3239