

NEW MEXICO OIL CONSERVATION COMMISSION
WELL LOCATION AND ACREAGE DEDICATION PLAT

Form C-102
Supersedes C-128
Effective 1-1-65

All distances must be from the outer boundaries of the Section

Operator Enron Oil & Gas Company			Lease LOVING 36 STATE			Well No. 1
Section N	Section 36	Township 23 SOUTH	Range 27 EAST	County EDDY		
Actual Well Location of Well: 660 feet from the SOUTH line and 2070 feet from the WEST line						
Ground Level Elev. 3121.4	Producing Formation Delaware		Pool Und	Dedicated Acreage: 160 Acres		

1. Outline the acreage dedicated to the subject well by colored pencil or hatchure marks on the plat below.
2. If more than one lease is dedicated to the well, outline each and identify the ownership thereof (both as to working interest and royalty).
3. If more than one lease of different ownership is dedicated to the well, have the interests of all owners been consolidated by communitization, unitization, force-pooling, etc?

☐ Yes ☐ No If answer is "yes," type of consolidation _____

If answer is "no," list the owners and tract descriptions which have actually been consolidated. (Use reverse side of this form if necessary.) _____

No allowable will be assigned to the well until all interests have been consolidated (by communitization, unitization, forced-pooling, or otherwise) or until a non-standard unit, eliminating such interests, has been approved by the Commission.

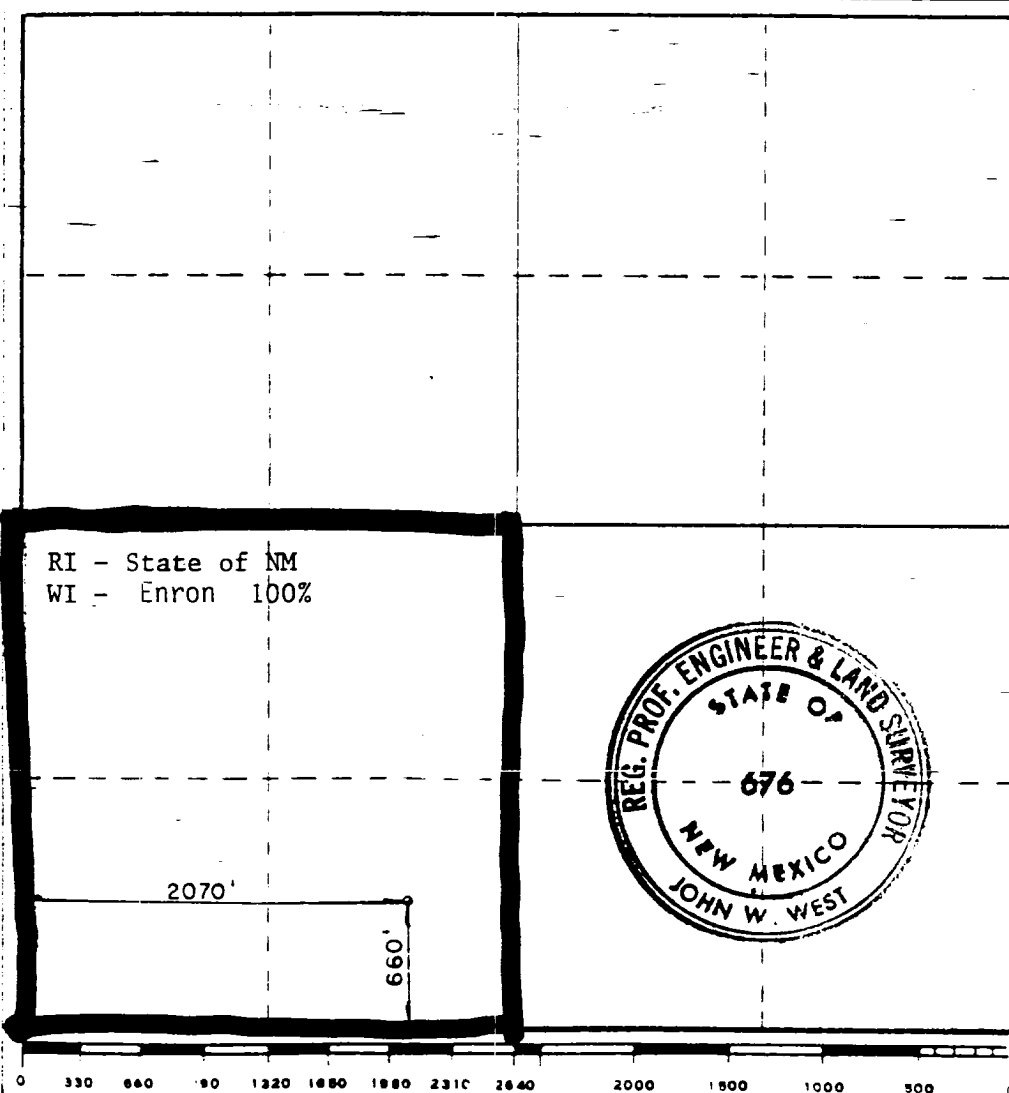

CERTIFICATION

I hereby certify that the information contained herein is true and complete to the best of my knowledge and belief.

Betty A. Gildon
Name

Betty A. Gildon

Position

Regulatory Analyst

Company

Enron Oil & Gas Company

Date

6/3/92

I hereby certify that the well location shown on this plat was plotted from field notes of actual surveys made by me or under my supervision, and that the same is true and correct to the best of my knowledge and belief.

Date Surveyed

DECEMBER 1, 1982

Registered Professional Engineer and/or Land Surveyor

John W. West

Certificate No

JOHN W. WEST N.M. #676