

UNITED STATES
DEPARTMENT OF THE INTERIOR
GEOLOGICAL SURVEY

APPLICATION FOR PERMIT TO DRILL, DEEPEN, OR PLUG BACK

1a. TYPE OF WORK

DRILL ☒DEEPEN ☐PLUG BACK ☐

b. TYPE OF WELL

OIL
WELL ☒GAS
WELL ☐OTHER ☐SINGLE
ZONE ☒MULTIPLE
ZONE ☐

2. NAME OF OPERATOR

Pogo Producing Company

3. ADDRESS OF OPERATOR

P.O. Box 10340 Midland, Texas 79702

4. LOCATION OF WELL (Report location clearly and in accordance with any State requirements.)*

At surface

660' FSL & 890' FEL

At proposed prod. zone

660' FSL & 890' FEL

14. DISTANCE IN MILES AND DIRECTION FROM NEAREST TOWN OR POST OFFICE*

2 miles North of Loving, New Mexico

15. DISTANCE FROM PROPOSED*

LOCATION TO NEAREST
PROPERTY OR LEASE LINE, FT.

660

(Also to nearest drlg. unit line, if any)

18. DISTANCE FROM PROPOSED LOCATION*

TO NEAREST WELL, DRILLING, COMPLETED,
OR APPLIED FOR, ON THIS LEASE, FT.

1226

21. ELEVATIONS (Show whether DF, RT, GR, etc.)

3044.8 GR

16. NO. OF ACRES IN LEASE

360

19. PROPOSED DEPTH

4400'

17. NO. OF ACRES ASSIGNED
TO THIS WELL

40

20. ROTARY OR CABLE TOOLS

Rotary

22. APPROX. DATE WORK WILL START*

March 15, 1983

23.

PROPOSED CASING AND CEMENTING PROGRAM

SIZE OF HOLE	SIZE OF CASING	WEIGHT PER FOOT	SETTING DEPTH	QUANTITY OF CEMENT
12 1/4	8 5/8	24	440	350 SXS CIRCULATE
7 7/8	5 1/2	14	4400	1200 SXS CIRCULATE

Proposal is to drill a well to test the Delaware formation. Cement will be circulated to the surface on the 8 5/8" and 5 1/2" casing strings. Completion or abandonment will be performed in accordance with prudent practices and MMS regulatory requirements.

Casing head gas is dedicated.

APPROVAL SUBJECT TO
GENERAL REQUIREMENTS AND
SPECIAL STIPULATIONS
ATTACHED

RECEIVED

FEB 7 1983

OIL & GAS
MINERALS MGMT. SERVICE
ROSWELL, NEW MEXICO

IN ABOVE SPACE DESCRIBE PROPOSED PROGRAM: If proposal is to deepen or plug back, give data on present productive zone and proposed new productive zone. If proposal is to drill or deepen directionally, give pertinent data on subsurface locations and measured and true vertical depths. Give blowout preventer program, if any.

24.

SIGNED

TITLE Division Operations Manager DATE 2/3/83

(This space for Federal or State office use)

PERMIT NO.

APPROVAL DATE

APPROVED BY

TITLE

DATE

CONDITIONS OF APPROVAL, IF ANY

APPROVED

FEB 28 1983

JAMES A. GILLHAM
DISTRICT SUPERVISOR

See Instructions On Reverse Side

Posted 2/22/83
SD-1041/200h
3-11-83

NEW MEXICO OIL CONSERVATION COMMISSION
WELL LOCATION AND ACREAGE DEDICATION RECEIVED

All distances must be from the outer boundary of the well. FEB 3 1983

Pogo Producing Co.		WEL		MIDLAND	
Well Number P	Section 9	Township 27 SOUTH	Range 08 EAST	County EDDY	
Actual Footage Location of Well:					
660 feet from the SOUTH line and		890 feet from the EAST line			
Ground Lve. Elev. 3044.8	Producing Formation Cherry Canyon	Pool Loving Cherry Canyon		Dedicated Acreage 40	

1. Outline the acreage dedicated to the subject well by colored pencil or hatchure marks on the plat below.
2. If more than one lease is dedicated to the well, outline each and identify the ownership thereof (both as to well interest and royalty).
3. If more than one lease of different ownership is dedicated to the well, have the interests of all owners been consolidated by communitization, unitization, force-pooling, etc?

☐ Yes ☐ No If answer is "yes," type of consolidation _____

If answer is "no," list the owners and tract descriptions which have actually been consolidated. (Use reverse side of this form if necessary.) _____

No allowable will be assigned to the well until all interests have been consolidated (by communitization, unitization, forced-pooling, or otherwise) or until a non-standard unit, eliminating such interests, has been approved by the Commission.

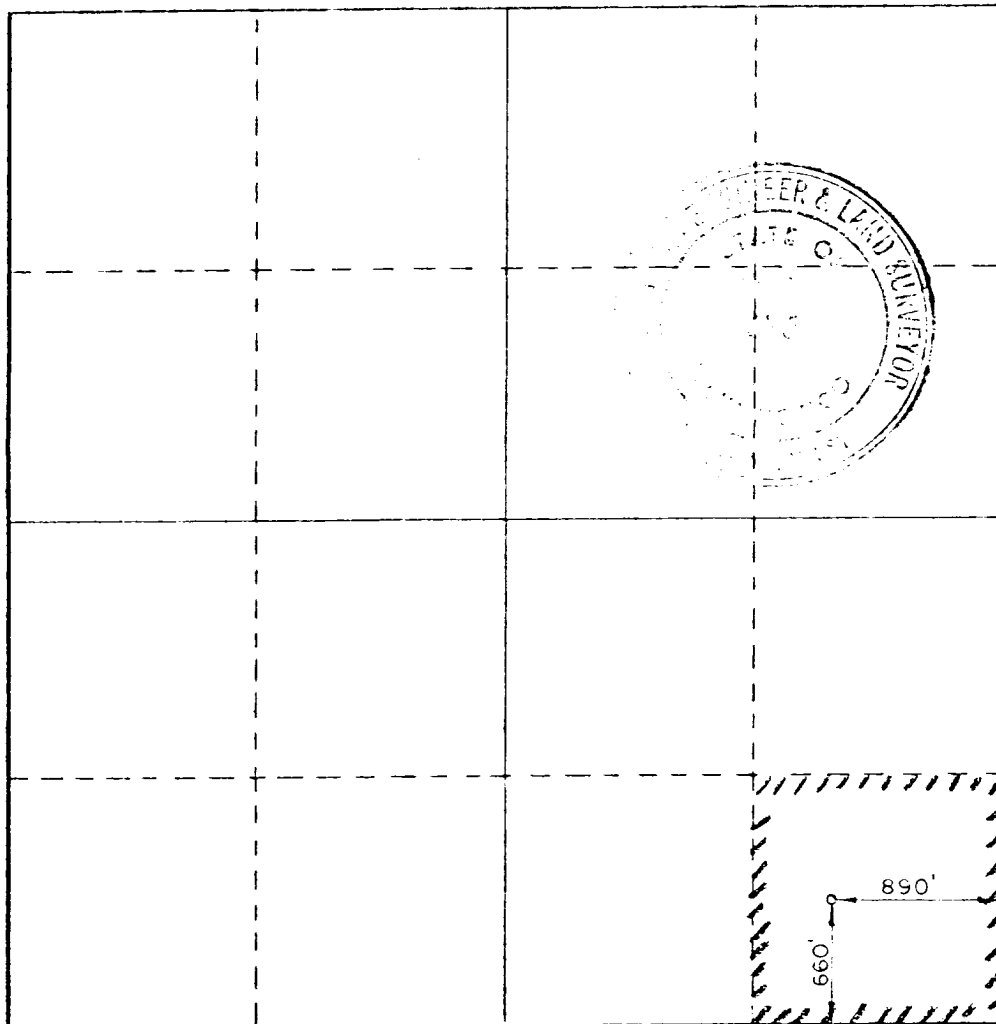

CERTIFICATION

I hereby certify that the information contained herein is true and complete to the best of my knowledge and belief.

B.J. Williams
Name

B.J. Williams

Position

Division Operations Manager

Company

Pogo Producing Company

Date

February 3, 1983

I hereby certify that the well location shown on this plat was plotted from field notes of actual surveys made by me or under my supervision, and that the same is true and correct to the best of my knowledge and belief.

2/1/83

Date Surveyed

Registered Professional Engineer and/or Land Surveyor

John W. West

Certificate No

JOHN W. WEST, NORTH

APPLICATION FOR DRILLING

Pogo Producing Company

NEL No. 3

Eddy County, New Mexico

In conjunction with permitting the captioned well for drilling in Section 9, T-23-S, R-28-E, Eddy County, New Mexico, Pogo Producing Company submits the following information in accordance with U.S.G.S. (NTL-6) letter dated July 1, 1976:

1. The surface formation is Quaternary Sand and gravel.
2. Estimated tops of geologic markers as follows:

Triassic Red Beds	-	575'
Rustler Anhydrite	-	1050'
Delaware Limestone	-	2570'
Bell Canyon	-	2595'
Cherry Canyon	-	3560'

3. The depth at which oil, gas or water is expected is: 3560'.
4. Casing Program and Cement:

All casing is new.

8 5/8"-24.0# K-55 STC @ 440' w/350 sxs Cl C w/2% CaCl plus 1/4# flocele per sk.
5 1/2"-14.0# K-55 STC @ 4400' w/900 sxs Lt w/1/4# flocele plus 5# gilsonite
per sk plus 300 sxs Cl C Neat.

5. Blowout Preventers:

From 440' to 4400' - 3000# WP, 6000# Test.

6. Circulating Medium:

An earthen pit will be used to hold drilling fluids and cuttings. The drilling mud program is as follows:

Natural mud to 440'. Seepage will be controlled by paper. Brine water to 4400' with a viscous sweep prior to logging and running casing.

7. No cores or DST's are planned.
8. Ten foot samples of cuttings will be caught from the base of the surface pipe (440') to total depth.
9. Adequate electrical and resistivity logs will be run from total depth to the base of the surface casing at 440', the gamma ray will be run to the surface.

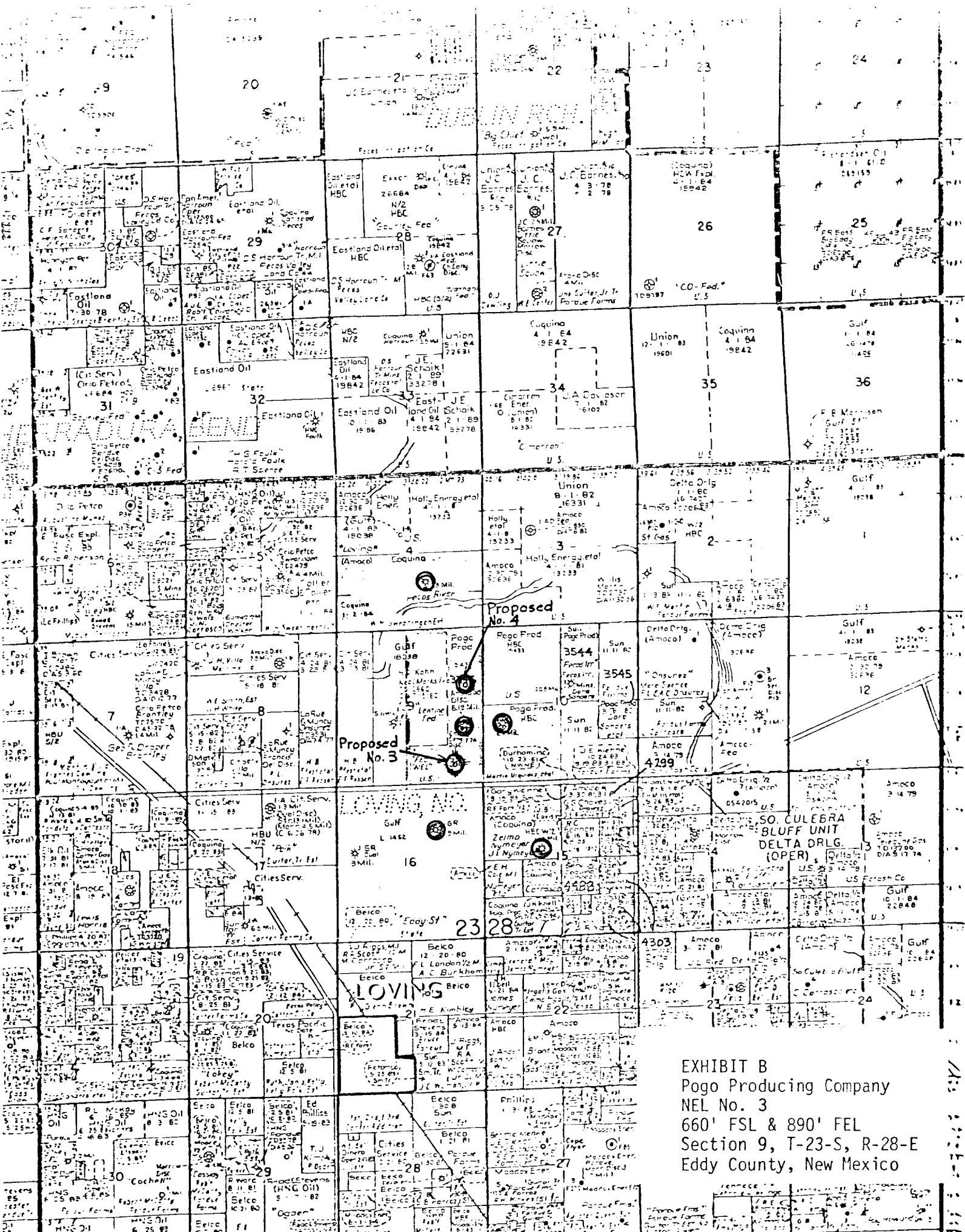

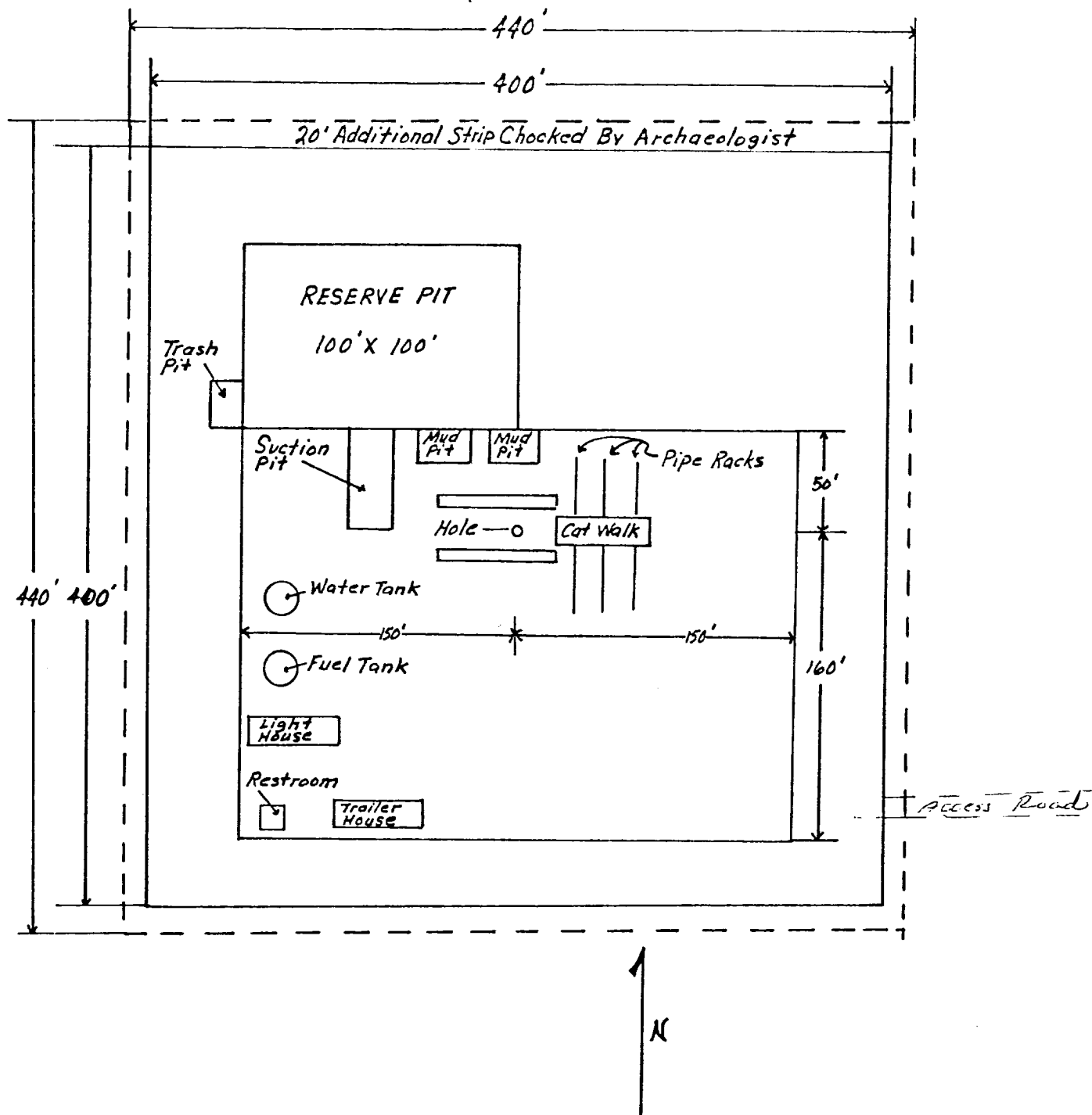
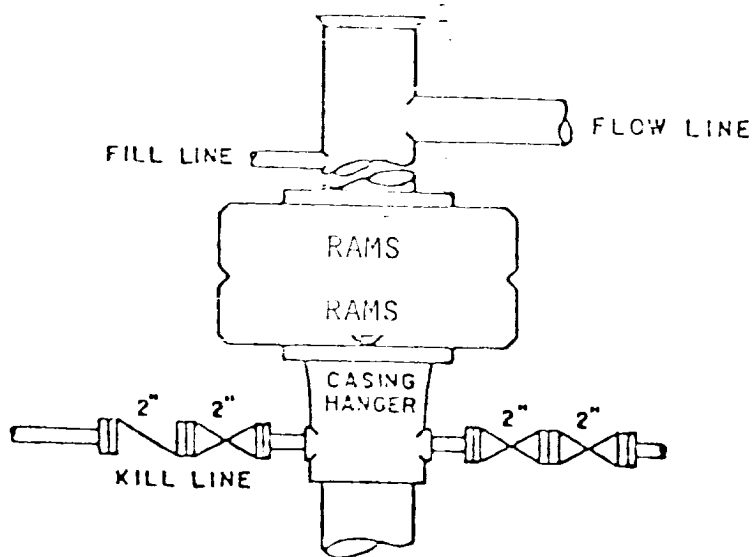

EXHIBIT C
 Pogo Producing Company
 NEL No. 3
 660' FSL & 890' FEL
 Section 9, T-23-S, R-28-E
 Eddy County, New Mexico



BOP STACK

BOP ARRANGEMENT