

NO. OF COPIES RECEIVED	
DISTRIBUTION	
SANTA FE	✓
FILE	✓
U.S.G.S.	2
LAND OFFICE	✓
OPERATOR	✓

NEW MEXICO OIL CONSERVATION COMMISSION

Form C-101
Revised 1-1-65

JUL 21 1983

O.C.D.

APPLICATION FOR PERMIT TO DRILL, DEEPEN, OR PLUG BACK

1a. Type of Work DRILL <input checked="" type="checkbox"/> DEEPEN <input type="checkbox"/> PLUG BACK <input type="checkbox"/>		5A. Indicate Type of Lease STATE <input checked="" type="checkbox"/> FEE <input type="checkbox"/>	
b. Type of Well OIL WELL <input checked="" type="checkbox"/> GAS WELL <input type="checkbox"/> OTHER <input type="checkbox"/>		5. State Oil & Gas Lease No. LH 2392	
2. Name of Operator Exxon Corporation		7. Unit Agreement Name ---	
3. Address of Operator P O Box 1600, Midland, TX 79702		8. Farm or Lease Name New Mexico "DU" State	
4. Location of Well UNIT LETTER F LOCATED 1673 FEET FROM THE North LINE AND 1809 FEET FROM THE West LINE OF SEC. 36 TWP. 22S RGE. 27E NMPM		9. Well No. 1	
		10. Field and Pool, or Wildcat Undesig. Herradura Bend	
		12. County EDDY	
		19. Proposed Depth 6100'	
		19A. Formation Bone Spring	
		20. Rotary or C.T. Rotary	
21. Elevations (Show whether DF, RT, etc.) GL 3075'		21A. Kind & Status Plug. Bond Blanket	
		21B. Drilling Contractor Unknown	
		22. Approx. Date Work will start 7/15/83	

23. PROPOSED CASING AND CEMENT PROGRAM					
SIZE OF HOLE	SIZE OF CASING	WEIGHT PER FOOT	SETTING DEPTH	SACKS OF CEMENT	EST. TOP
26"	20"	94#	40'	25 sx Redi-Mix	Surface
17 1/2"	13 3/8"	54.5#	600'	500 sx	Surface
11"	8 5/8"	24#	2300'	600 sx	Tie into Surf. Csg
7 7/8"	5 1/2"	14# + 15.5#	6100'	700 sx	Tie into Int. Csg

MUD: 0-600'/FW/8.4-8.8 PPG
600-6100'/CBW/8.8-9.5 PPG

BOP: 13 3/8"/Type II-C/2000 PSI
8 5/8"/Type II-C/2000 PSI

Mud Program + BOP's.
Diagrammatic Sketch & Specifications of BOP are Attached.

APPROVAL FOR 180 DAYS
EXPIRES 1-25-84
UNLESS DRILLING UNDERWAY

IN ABOVE SPACE DESCRIBE PROPOSED PROGRAM: IF PROPOSAL IS TO DEEPEN OR PLUG BACK, GIVE DATA ON PRESENT PRODUCTIVE ZONE AND PROPOSED NEW PRODUCTIVE ZONE. GIVE BLOWOUT PREVENTER PROGRAM, IF ANY.

I hereby certify that the information above is true and complete to the best of my knowledge and belief.

Signed Melba Knippling Title Unit Head Date 7/15/83

(This space for State Use)

APPROVED BY Mr. Walker TITLE OIL AND GAS INSPECTOR DATE JUL 25 1983

CONDITIONS OF APPROVAL, IF ANY:

Operator Exxon Corporation			Lease N. M. "DU" STATE		Well No. 1
Unit Letter F	Section 36	Township 22S	Range 27E	County EDDY	
Actual Footage Location of Well: 1673 feet from the NORTH line and 1809 feet from the WEST line					
Ground Level Elev. 3075	Producing Formation BONE SPRING		Pool UNDESIG. HERRADURA-BEND	Dedicated Acreage: 40 Acres	

- Outline the acreage dedicated to the subject well by colored pencil or hachure marks on the plat below.
- If more than one lease is dedicated to the well, outline each and identify the ownership thereof (both as to working interest and royalty).
- If more than one lease of different ownership is dedicated to the well, have the interests of all owners been consolidated by communitization, unitization, force-pooling, etc?

☐ Yes ☐ No If answer is "yes," type of consolidation _____

If answer is "no," list the owners and tract descriptions which have actually been consolidated. (Use reverse side of this form if necessary.) _____

No allowable will be assigned to the well until all interests have been consolidated (by communitization, unitization, forced-pooling, or otherwise) or until a non-standard unit, eliminating such interests, has been approved by the Commission.

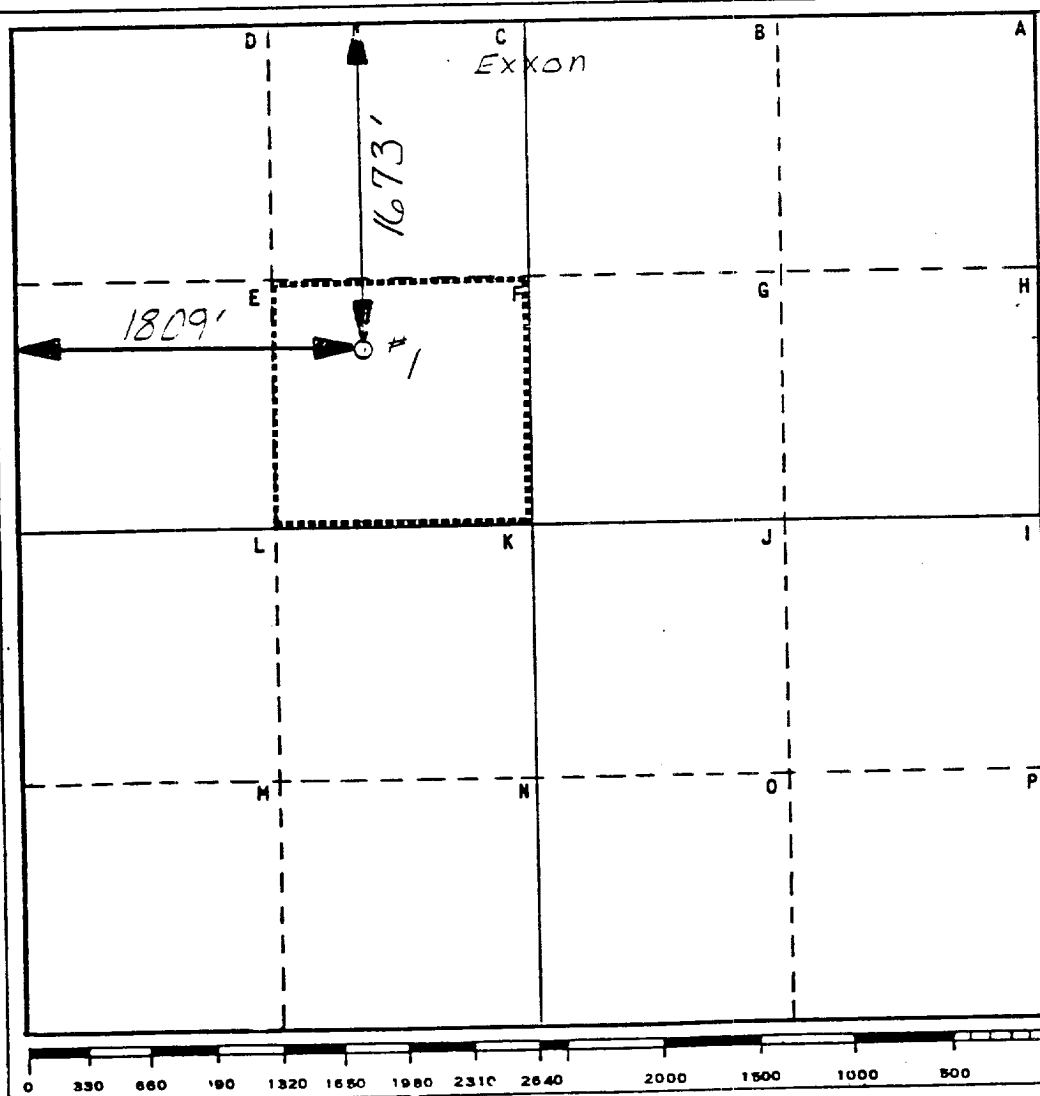

CERTIFICATION

I hereby certify that the information contained herein is true and complete to the best of my knowledge and belief.

Name Walter Knippling
 Position **UNIT HEAD**
 Company Exxon Corporation
 Box 1600 Midland, Texas
 Date 6-28-83

I hereby certify that the well location shown on this plat was plotted from field notes of actual surveys made by me or under my supervision, and that the same is true and correct to the best of my knowledge and belief.

Date Surveyed 6-23-83
 Registered Professional Engineer and/or Land Surveyor

Certificate No. 6157

7.2 Miles SE of CARLSBAD, New Mexico

C.E. Sec. File No. W-A-8179

BLOWOUT PREVENTER SPECIFICATION
EQUIPMENT DESCRIPTION

TYPE II-C

All equipment should be at least _____ psi WP or higher unless otherwise specified.

1. Bell nipple.
2. Hydril or Shaffer bag type preventer.
3. Ram type pressure operated blowout preventer with blind rams.
4. Flanged spool with one 4-inch and one 2-inch (minimum) outlet.
5. 2-inch (minimum) flanged plug or gate valve.
6. 2-inch by 2-inch by 2-inch (minimum) flanged tee.
7. 4-inch pressure operated gate valve.
8. 4-inch flanged gate or plug valve.
9. Ram type pressure operated blowout preventer with pipe rams.
10. Flanged type casing head with one side outlet (furnished by Exxon).
11. 2-inch threaded (or flanged) plug or gate valve (furnished by Exxon).
Flanged on 5000# WP, threaded on 3000# WP or less.
12. Needle valve (furnished by Exxon).
13. 2-inch nipple (furnished by Exxon).
14. Tapped bull plug (furnished by Exxon).
15. 4-inch flanged spacer spool.
16. 4-inch by 2-inch by 2-inch by 2-inch flanged cross.
17. 2-inch flanged plug or gate valve.
18. 2-inch flanged adjustable choke.
19. 2-inch threaded flange.
20. 2-inch XXH nipple.
21. 2-inch forged steel 90° Ell.
22. Cameron (or equal.) threaded pressure gage.
23. Threaded flange.

35. 2-inch flanged tee.
36. 3-inch (minimum) hose. (Furnished by Exxon).
37. Trip tank. (Furnished by Exxon).
38. 2-inch flanged plug or gate valve.
39. 2-1/2-inch pipe, 300' to pit, anchored.
40. 2-1/2-inch SE valve.
41. 2-1/2-inch line to steel pit or separator.

NOTES:

1. Items 3, 4 and 9 may be replaced with double ram type preventer with side outlets between the rams.
2. The two valves next to the stack on the fill and kill line to be closed unless drill string is being pulled.
3. Kill line is for emergency use only. This connection shall not be used for filling.
4. Replacement pipe rams and blind rams shall be on location at all times.
5. Only type U, LWS and QRC ram type preventers with secondary seals are acceptable for 5000 psi WP and higher BOP stacks.
6. Type E ram-type BOP's with factory modified side outlets may be used on 3000 psi or lower WP BOP stacks.

MIDLAND DRILLING ORGANIZATION BLOWOUT PREVENTER SPECIFICATION TYPE II - C

