

NEW MEXICO OIL CONSERVATION COMMISSION
WELL LOCATION AND ACREAGE DEDICATION PLAT

Form O-102
Supersedes O-128
Effective 1-1-83

All distances must be from the outer boundaries of the Section

Owner SANTA FE ENERGY CO.			Lease CARRASCO		Acres 1
Section D	Section 18	Township 23S	Range 28E	County EDDY	
Approximate Location of Well: <div style="display: flex; justify-content: space-between;"> 990 feet from the NORTH line and 990 feet from the WEST line </div>					
Ground Level Elev. 3059.0	Producing Formation <i>Morrow</i>	Pool North Loving Morrow		Dedicated Acreage 320	

- Outline the acreage dedicated to the subject well by colored pencil or hatchure marks on the plat below.
- If more than one lease is dedicated to the well, outline each and identify the ownership thereof (both as to working interest and royalty).
- If more than one lease of different ownership is dedicated to the well, have the interests of all owners been consolidated by communitization, unitization, force-pooling, etc?

Designation of Consolidated

☒ Yes ☐ No If answer is "yes," type of consolidation Gas Leasehold Estate

If answer is "no," list the owners and tract descriptions which have actually been consolidated. (Use reverse side of this form if necessary.)

No allowable will be assigned to the well until all interests have been consolidated (by communitization, unitization, forced-pooling, or otherwise) or until a non-standard unit, eliminating such interests, has been approved by the Commission.

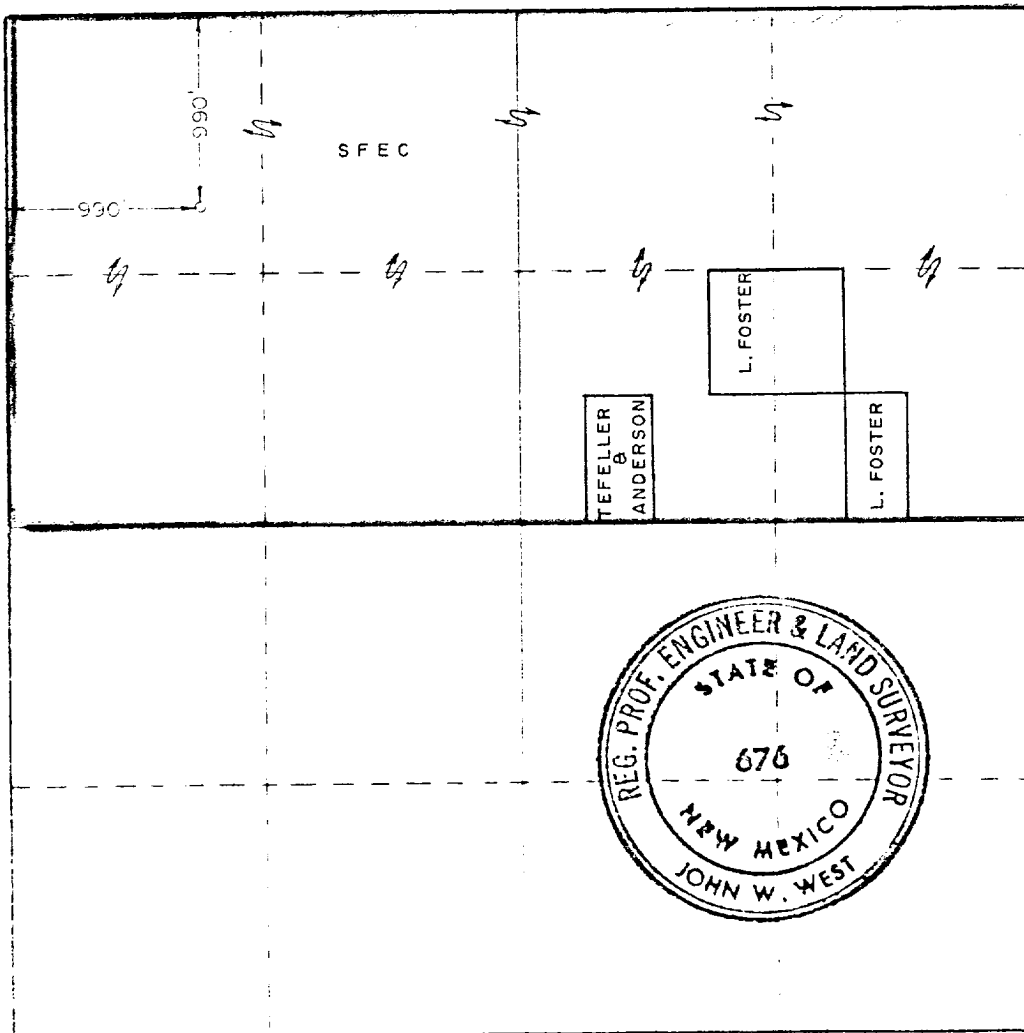

CERTIFICATION

I hereby certify that the information contained herein is true and complete to the best of my knowledge and belief.

MICHAEL R. BURTON

Michael R. Burton

Sr. Drilling Engineer

Santa Fe Energy Company

Date
10-28-83

I hereby certify that the well location shown on this plat was plotted from field notes of actual surveys made by me or under my supervision, and that the same is true and correct to the best of my knowledge and belief.

Date Surveyed
10/11/83

Registered Professional Engineer
and Land Surveyor

John W. West

Certification No. **JOHN W. WEST, 676**
RONALD J. ELLISON, 5749