

RECEIVED BY

88210 UNITED STATES
DEPARTMENT OF THE INTERIOR
GEOLOGICAL SURVEY

30-015-25211

5. LEASE DESIGNATION AND SERIAL NO.

LC-060613

6. IF INDIAN, ALLOTTEE OR TRIBE NAME

7. UNIT AGREEMENT NAME

Big Eddy Unit

8. FARM OR LEASE NAME

Big Eddy Unit

9. WELL NO.

110

10. FIELD AND POOL, OR WILDCAT

Undesignated Delaware

11. SEC., T., R., M., OR BLK.
AND SURVEY OR AREA

Section 9-T22S-R28E

12. COUNTY OR PARISH 13. STATE

Eddy

NM

1. CITY OR TOWN

ARTESIA, OFFICE

DRILL ☒DEEPEN ☐PLUG BACK ☐OIL
WELL ☒GAS
WELL ☐

OTHER

SINGLE
ZONE ☐MULTIPLE
ZONE ☐

2. NAME OF OPERATOR

MYCO INDUSTRIES, INC.

3. ADDRESS OF OPERATOR

207 South Fourth Street, Artesia, New Mexico 88210

4. LOCATION OF WELL (Report location clearly and in accordance with any State requirements.)*

At surface

2310' FNL and 330' FEL

At proposed prod. zone
same

14. DISTANCE IN MILES AND DIRECTION FROM NEAREST TOWN OR POST OFFICE*

Approximately 20 miles east of Carlsbad, New Mexico.

15. DISTANCE FROM PROPOSED*

LOCATION TO NEAREST
PROPERTY OR LEASE LINE, FT.
(Also to nearest drlg. unit line, if any)

330'

16. NO. OF ACRES IN LEASE

1156.51

17. NO. OF ACRES ASSIGNED
TO THIS WELL

40

18. DISTANCE FROM PROPOSED LOCATION*
TO NEAREST WELL, DRILLING, COMPLETED,
OR APPLIED FOR, ON THIS LEASE, FT.

1000'

19. PROPOSED DEPTH

6100'

20. ROTARY OR CABLE TOOLS

Rotary

21. ELEVATIONS (Show whether DF, RT, GR, etc.)

3137' GL

22. APPROX. DATE WORK WILL START*

ASAP

23.

PROPOSED CASING AND CEMENTING PROGRAM

| SIZE OF HOLE | SIZE OF CASING | WEIGHT PER FOOT | SETTING DEPTH | QUANTITY OF CEMENT |
|--------------|----------------|-----------------|---------------|--------------------|
| 12 1/4" | 8 5/8" | 24# K-55 | 400' | 300 sx circ. |
| 7 7/8" | 5 1/2" | 15.5# K-55 | 6100' | 900 sx circ. |

We propose to drill and test the Delaware and intermediate formations. Approximately 400' of surface casing will be set and cement circulated to shut off gravel and caving. If commercial, production casing will be run and cemented with adequate cover, perforated and stimulated as needed for production.

MUD PROGRAM: FW/LCM to 400', Brine & LCM to TD.

BOP PROGRAM: BOP's will be installed at the offset and tested daily.

GAS NOT DEDICATED.

IN ABOVE SPACE DESCRIBE PROPOSED PROGRAM: If proposal is to deepen or plug back, give data on present productive zone and proposed new productive zone. If proposal is to drill or deepen directionally, give pertinent data on subsurface locations and measured and true vertical depths. Give blowout preventer program, if any.

24.

SIGNED

TITLE Regulatory Agent

DATE 2/11/85

(This space for Federal or State office use.)

PERMIT NO.

APPROVAL DATE

APPROVED BY

TITLE

DATE

2-28-85

CONDITIONS OF APPROVAL, IF ANY:

APPROVAL SUBJECT TO
GENERAL REQUIREMENTS AND
SPECIAL STIPULATIONS
ATTACHED

W MEXICO OIL CONSERVATION COMMISSION
WELL LOCATION AND ACREAGE DEDICATION PLAT

Form C-102
Supersedes C-128
Effective 1-1-65

All distances must be from the outer boundaries of the Section.

| | | | | | |
|---|--|-------------------------------|---------------------------------------|-----------------------|----------------------------|
| Operator MYCO INDUSTRIES | | | Lease Big Eddy Unit | | Well No. 108 110 |
| Unit Letter H | Section 9 | Township 22 South | Range 28 East | County Eddy | |
| Actual Footage Location of Well: <div style="display: flex; justify-content: space-between;"> 2310 feet from the North line and 330 feet from the East line </div> | | | | | |
| Ground Level Elev. 3137. | Producing Formation DELAWARE | Pool UNDES DELAWARE | Dedicated Acreage: 40 Acres | | |

1. Outline the acreage dedicated to the subject well by colored pencil or hatchure marks on the plat below.
2. If more than one lease is dedicated to the well, outline each and identify the ownership thereof (both as to working interest and royalty).
3. If more than one lease of different ownership is dedicated to the well, have the interests of all owners been consolidated by communitization, unitization, force-pooling, etc?

☐ Yes ☐ No If answer is "yes," type of consolidation _____

If answer is "no," list the owners and tract descriptions which have actually been consolidated. (Use reverse side of this form if necessary.) _____

No allowable will be assigned to the well until all interests have been consolidated (by communitization, unitization, forced-pooling, or otherwise) or until a non-standard unit, eliminating such interests, has been approved by the Commission.

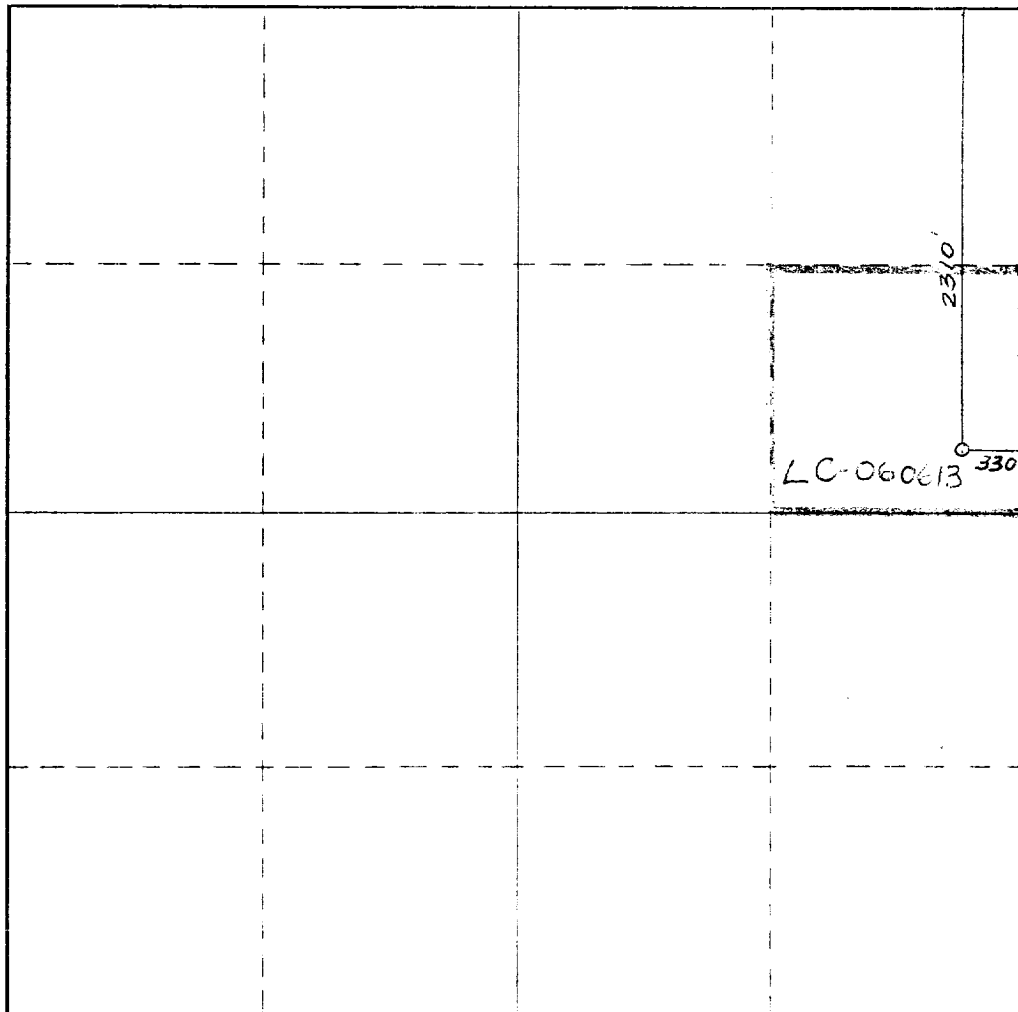

CERTIFICATION

I hereby certify that the information contained herein is true and complete to the best of my knowledge and belief.

Cy Cowan

Name

Cy Cowan

Position

Regulatory Agent

Company

Myco Industries, Inc.

Date

2/11/85

I hereby certify that the well location shown on this plat was plotted from field notes of actual surveys made by me or under my supervision, and that the same is true and correct to the best of my knowledge and belief.

Date Surveyed

January 23, 1985

Registered Professional Engineer
and/or Land Surveyor

Dan R. Reddy

Certificate No.

NM PE&LS NO. 5412

0 330 660 990 1320 1650 1980 2310 2640 2970 3300 3630 3960 4290 4620 4950 5280 5610 5940 6270 6600

EXHIBIT B

BOP DIAGRAM

RATED 3000[#]

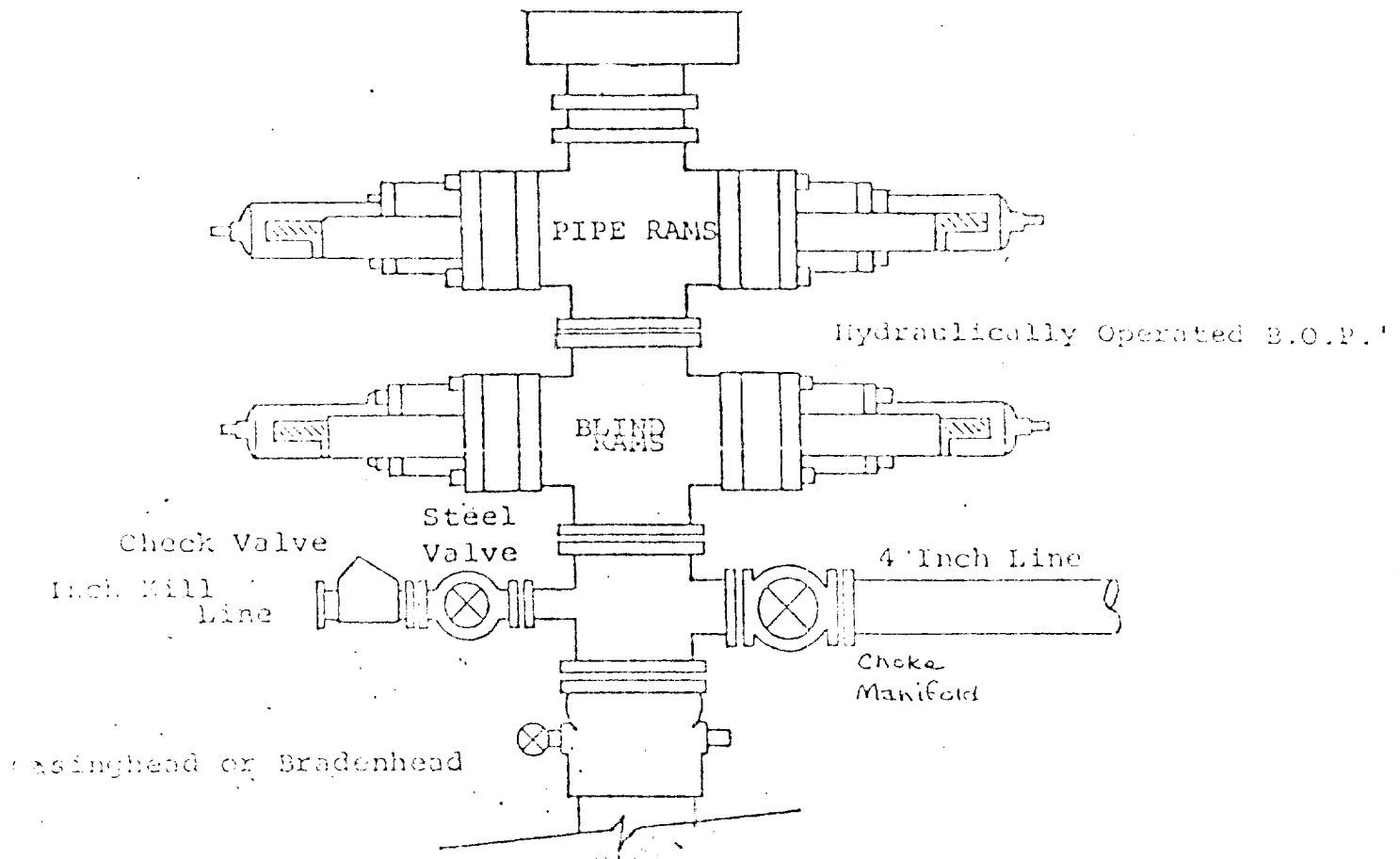

MYCC INDUSTRIES, INC.
Big Eddy Unit #110
2310' FNL and 330' FEL
Section 9-T22S-R28E
Eddy County, New Mexico

In conjunction with Form 9-331C, Application for Permit to Drill subject well, Myco Industries, Inc. submits the following ten items of pertinent information in accordance with BLM requirements.

1. The geologic surface formation is sand dunes.
2. The estimated tops of geologic markers are as follows:

| | |
|--------------|-------|
| Salt | 205' |
| Base of Salt | 2245' |
| Delaware | 2532' |
| Bone Springs | 5965' |
| TD | 6100' |
3. The estimated depths at which anticipated water, oil or gas formations are expected to be encountered:

Water: appr. 200-350'
Oil or Gas: 6100'
4. Proposed Casing Program: See Form 9-331C.
5. Pressure Control Equipment: See Form 9-331C and Exhibit B.
6. Mud Program: See Form 9-331C.
7. Auxiliary Equipment: Kelly Cock; pit level indicators and flow sensor equipment; sub with full-opening valve on floor, drill pipe connection.
8. Testing, Logging and Coring Program:

| | |
|--------------|--|
| Samples: | 10' samples caught out from under surface casing to TD. |
| DST's: | None. |
| Logging: | CNL-LDT TD to csg. w/GR-CNL to surface. DLL w/RxO TD to surface csg. Ept TD-csg. |
| Mud Logging: | One man unit 2000' - TD. |
9. No abnormal pressures or temperatures are anticipated.
10. Anticipated starting date: As soon as possible after approval

YATES PETROLEUM CORP.

Exhibit C

Pits East!

Reserve Pit
bottom to be at
ground level to
1 ft.

