

UNITED STATES  
DEPARTMENT OF THE INTERIOR  
BUREAU OF LAND MANAGEMENT

APPLICATION FOR PERMIT TO DRILL, DEEPEN, OR PLUG BACK

1a. TYPE OF WORK

DRILL ☐

DEEPEN ☐

PLUG BACK ☒

b. TYPE OF WELL

OIL  
WELL ☒

GAS  
WELL ☐

OTHER ☐

SINGLE  
ZONE ☒

MULTIPLE  
ZONE ☐

2. NAME OF OPERATOR

Pogo Producing Company

3. ADDRESS OF OPERATOR

P. O. Box 10340 Midland, Texas 79702

4. LOCATION OF WELL (Report location clearly and in accordance with any State requirements.)\*

At surface

660' FNL & 1980' FWL

At proposed prod. zone

660' FNL & 1980' FWL

14. DISTANCE IN MILES AND DIRECTION FROM NEAREST TOWN OR POST OFFICE\*

36 miles WNW of Jal, New Mexico

15. DISTANCE FROM PROPOSED\*

LOCATION TO NEAREST  
PROPERTY OR LEASE LINE, FT.  
(Also to nearest drlg. unit line, if any)

660'

16. NO. OF ACRES IN LEASE

640

17. NO. OF ACRES ASSIGNED  
TO THIS WELL

320

18. DISTANCE FROM PROPOSED LOCATION\*

TO NEAREST WELL, DRILLING COMPLETED,  
OR APPLIED FOR, ON THIS LEASE, FT.

1867' SE

19. PROPOSED DEPTH

Plug Back 7500'

20. ROTARY OR CABLE TOOLS

N/A

21. ELEVATIONS (Show whether DF, RT, GR, etc.)

3567' 3547.4' GR

22. APPROX. DATE WORK WILL START\*

10/02/89

PROPOSED CASING AND CEMENTING PROGRAM

SIZE OF HOLE	SIZE OF CASING	WEIGHT PER FOOT	SETTING DEPTH	QUANTITY OF CEMENT
17-1/2"	13-3/8"	48.5	800'	825 sxs. circ.
12-1/4"	10-3/4"	40.5 & 45.5	4530'	2000 sxs. circ.
9-1/2"	7-5/8"	26.40 & 29.70	11,855'	1500 sxs. - TOC 7700' Temp. Sur.
6-1/2"	5" liner	18	14,998'	300 sxs.

Proposal is to temporarily abandon existing perms in Morrow formation (14,460-14,723') and plug back to Brushy Canyon in Delaware formation (7,080-7,097').

Procedure: Packer will be retrieved @ 14,400'. CIBP set @ 14,400'+. Perf for cement job at 7500'. Set cement retainer @ 7400'. Cement 7-5/8" with 625 sacks Class "H" 7500 to 4500' (calc). Perf for prod. 7080-7097'. Stimulate with acid and sand.

IN ABOVE SPACE DESCRIBE PROPOSED PROGRAM: If proposal is to deepen or plug back, give data on present productive zone and proposed new productive zone. If proposal is to drill or deepen directionally, give pertinent data on subsurface locations and measured and true vertical depths. Give blowout preventer program, if any.

24.

SIGNED

R. L. Wright

TITLE Dist. Drlg. & Prod. Supt.

DATE September 21, 1989

(This space for Federal or State office use)

PERMIT NO.

APPROVAL DATE

APPROVED BY

Adam Salameh

TITLE

DATE

9/28/89

CONDITIONS OF APPROVAL, IF ANY:

\*See Instructions On Reverse Side

N MEXICO OIL CONSERVATION COMMISS  
WELL LOCATION AND ACREAGE DEDICATION PLAT

RECEIVED

Form O-11,  
Supersedes O-128  
Effective 1-1-85

MAY 01 1985

All distances must be from the outer boundaries of the Section

Location		Section		Township		Range		County	
1000 1000 1000 1000		20		21 SOUTH		31 EAST		EDDY	
Actual Surface Location of Well									
From		feet from the		NORTH		line and		feet from the	
3967.0		Morrow		Wildcat		320		Acres	

1. Outline the acreage dedicated to the subject well by colored pencil or hatchure marks on the plat below.
2. If more than one lease is dedicated to the well, outline each and identify the ownership thereof (both as to working interest and royalty).
3. If more than one lease of different ownership is dedicated to the well, have the interests of all owners been consolidated by communitization, unitization, force-pooling, etc?

☐ Yes ☐ No If answer is "yes," type of consolidation \_\_\_\_\_

If answer is "no," list the owners and tract descriptions which have actually been consolidated. (Use reverse side of this form if necessary.) \_\_\_\_\_

No allowable will be assigned to the well until all interests have been consolidated (by communitization, unitization, forced-pooling, or otherwise) or until a non-standard unit, eliminating such interests, has been approved by the Commission.

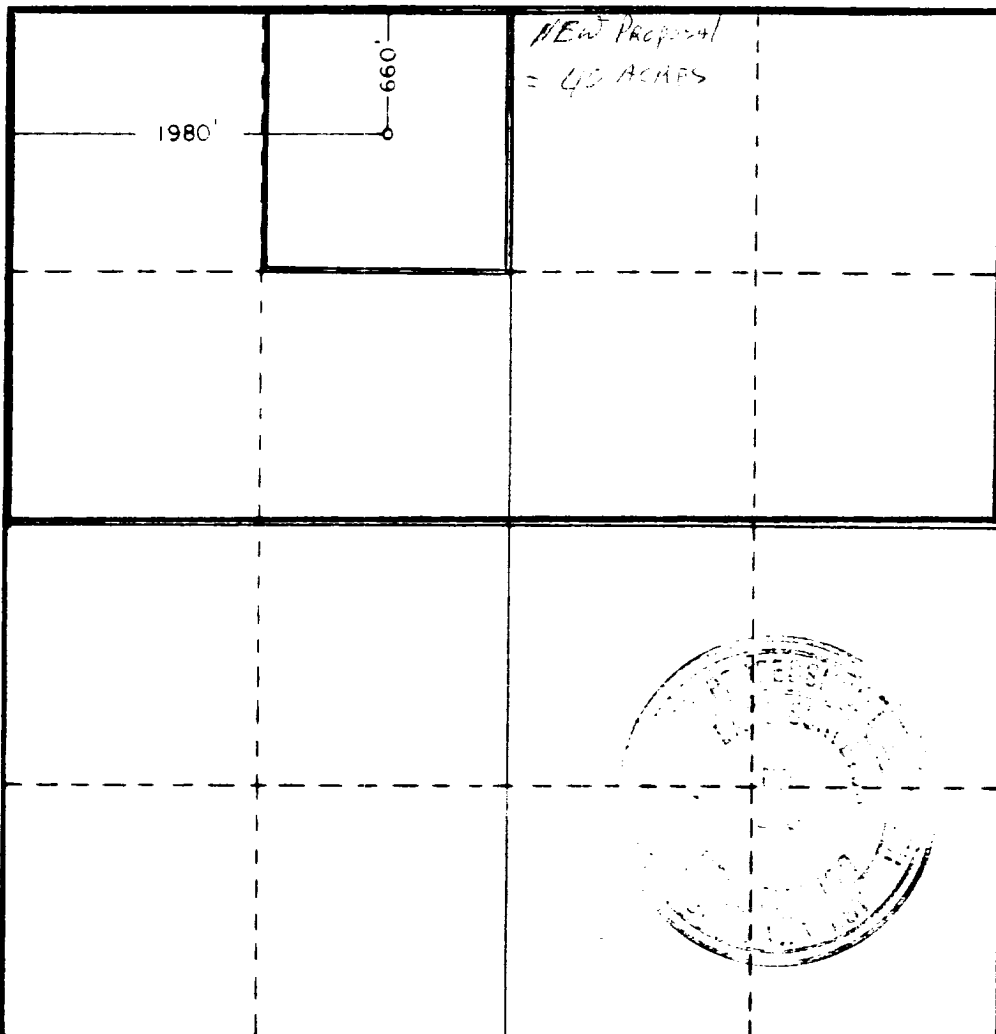

CERTIFICATION

I hereby certify that the information contained herein is true and complete to the best of my knowledge and belief

*B. J. Williams*

Name  
B. J. Williams

Position  
Division Operations Manager

Company  
Pogo Producing Company

Date  
5/6/85

I hereby certify that the well location shown on this plat was plotted from field notes of actual surveys made by me or under my supervision, and that the same is true and correct to the best of my knowledge and belief.

Date Surveyed  
APRIL 25 & 26, 1985

Registered Professional Engineer  
and/or Land Surveyor

*John W. West*

Certificate No. JOHN W. WEST, 676  
RONALD J. FINSON 3239