

NO. OF COPIES RECEIVED	
DISTRIBUTION	
SANTA FE	<input checked="" type="checkbox"/>
FILE	<input checked="" type="checkbox"/>
U.S.G.S.	<u>2</u>
LAND OFFICE	<input checked="" type="checkbox"/>
OPERATOR	<input checked="" type="checkbox"/>

NEW MEXICO OIL CONSERVATION COMMISSION

RECEIVED BY

AUG 01 1985

O. C. D.
ARTESIA, OFFICEForm O-101
Revised 1-1-85

15. Indicate Type of Lease STATE <input type="checkbox"/> FEE <input checked="" type="checkbox"/>
16. Oil & Gas Lease No.
17. Unit Agreement Name
18. Farm or Lease Name Merland C
19. Well No. 2
20. Field and Pool, or Wildcat South Carlsbad-Delaware, X
21. County Eddy
22. Proposed Depth 4550'
23. Formation Delaware
24. Rotary or C.T. Rotary
25. Elevations (Show whether DF, RT, etc.) 3165' GR
26. Kind & Status Plug. Bond Required/Approved
27. Drilling Contractor Unknown
28. Approx. Date Work will start After permit approval

APPLICATION FOR PERMIT TO DRILL, DEEPEN, OR PLUG BACK

1a. Type of Work b. Type of Well DRILL <input checked="" type="checkbox"/> DEEPEN <input type="checkbox"/> PLUG BACK <input type="checkbox"/> OIL WELL <input checked="" type="checkbox"/> GAS WELL <input type="checkbox"/> OTHER <input type="checkbox"/> SINGLE ZONE <input type="checkbox"/> MULTIPLE ZONE <input type="checkbox"/>	2. Name of Operator Cities Service Oil and Gas Corporation ✓	3. Address of Operator P.O. Box 1919 - Midland, Texas	4. Location of Well UNIT LETTER <u>L</u> LOCATED <u>1980</u> FEET FROM THE <u>South</u> LINE AND <u>660</u> FEET FROM THE <u>West</u> LINE OF SEC. <u>19</u> T. <u>22S</u> R. <u>27E</u> NMPM	5. Proposed Depth 4550'	6. Formation Delaware	7. Rotary or C.T. Rotary
23. PROPOSED CASING AND CEMENT PROGRAM						

SIZE OF HOLE	SIZE OF CASING	WEIGHT PER FOOT	SETTING DEPTH	SACKS OF CEMENT	EST. TOP
12-1/4"	8-5/8"	24#	600'	550	Circulated
7-7/8"	5-1/2"	14#	4550'	1050	Circulated

It is proposed to drill this well to a T.D. of 4550' and test the Delaware Formation. The blowout prevention program is as follows:

1. One set of blind rams
2. One set of drill pipe rams

APPROVAL VALID FOR 180 DAYS
PERMIT EXPIRES 2-2-86
UNLESS DRILLING UNDERWAY

The acreage dedicated to this well has not been assigned to any gas purchaser.

Posted IDI
API # NL
8-9-85

IN ABOVE SPACE DESCRIBE PROPOSED PROGRAM: IF PROPOSAL IS TO DEEPEN OR PLUG BACK, GIVE DATA OF PRESENT PRODUCTIVE ZONE AND PROPOSED NEW PRODUCTIVE ZONE. GIVE BLOWOUT PREVENTER PROGRAM, IF ANY.

I hereby certify that the information above is true and complete to the best of my knowledge and belief.

Signed Elma Stutz Title Reg. Opr. Mgr. - Prod. Date 7-31-85

(This space for State Use)

Original Signed By
Les A. Clements

APPROVED BY _____ TITLE _____ DATE AUG 1 1985
Supervisor District 11

CONDITIONS OF APPROVAL, IF ANY:

**NEW MEXICO OIL CONSERVATION COMMISSION
WELL LOCATION AND ACREAGE DEDICATION PLAT**

Form C-102
Supersedes C-128
Effective 1-1-65

All distances must be from the outer boundaries of the Section.

Operator CITIES SERVICE OIL & GAS CO.			Lease MERLAND "C"		Well No. 2
Unit Letter L	Section 19	Township 22 SOUTH	Range 27 EAST	County EDDY	
Actual Footage Location of Well: 1980 feet from the SOUTH line and 660 feet from the WEST line					
Ground Level Elev. 3165.0'	Producing Formation Delaware		Pool Carlsbad - Delaware, South		Dedicated Acreage: 40 Acres

1. Outline the acreage dedicated to the subject well by colored pencil or hachure marks on the plat below.
2. If more than one lease is dedicated to the well, outline each and identify the ownership thereof (both as to working interest and royalty).
3. If more than one lease of different ownership is dedicated to the well, have the interests of all owners been consolidated by communitization, unitization, force-pooling, etc?

☐ Yes ☐ No If answer is "yes," type of consolidation _____

If answer is "no," list the owners and tract descriptions which have actually been consolidated. (Use reverse side of this form if necessary.) _____

No allowable will be assigned to the well until all interests have been consolidated (by communitization, unitization, forced-pooling, or otherwise) or until a non-standard unit, eliminating such interests, has been approved by the Commission.

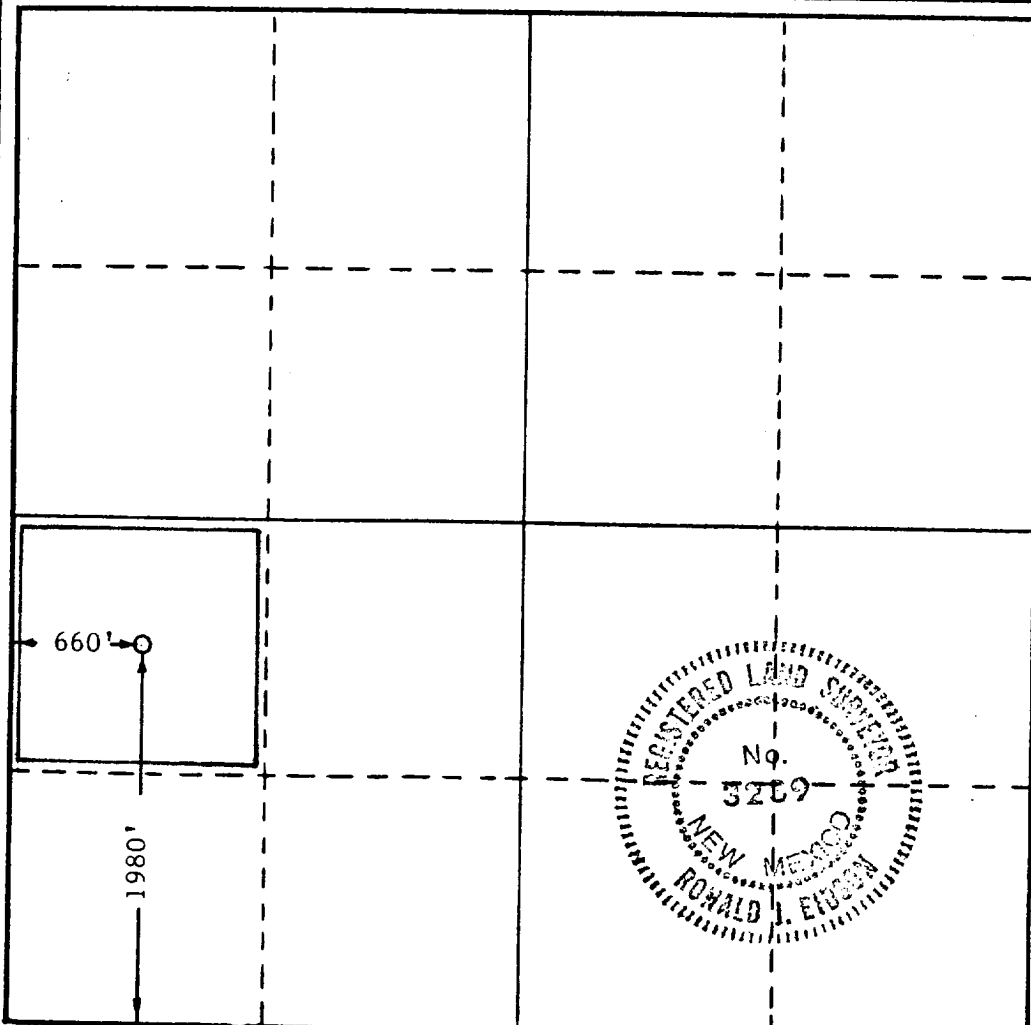

CERTIFICATION

I hereby certify that the information contained herein is true and complete to the best of my knowledge and belief.

Name *Elmer Startz*
Position

Reg. Opr. Mgr. - Prod.

Company
Cities Service O&G Corp.

Date
July 31, 1985

I hereby certify that the well location shown on this plat was plotted from field notes of actual surveys made by me or under my supervision, and that the same is true and correct to the best of my knowledge and belief.

Date Surveyed
July 30, 1985

Registered Professional Engineer
and/or Land Surveyor

Ronald J. Eidson
Certificate No. **JOHN W. WEST, 676**
RONALD J. EIDSON, 3239

