

UNITED STATES
DEPARTMENT OF THE INTERIOR
BUREAU OF LAND MANAGEMENT

SUBMIT IN DUPLICATE*
(Other instructions on
reverse side)

Form approved.
Budget Bureau No. 1004-0136
Expires August 31, 1985

APPLICATION FOR PERMIT TO DRILL, DEEPEN, OR PLUG BACK

1a. TYPE OF WORK

DRILL ☐

DEEPEN ☐

PLUG BACK ☒

b. TYPE OF WELL

OIL
WELL ☐

GAS
WELL ☒

OTHER

SINGLE
ZONE ☐

MULTIPLE
ZONE ☐

2. NAME OF OPERATOR

Exxon Corporation

Attn: David A. Murray

3. ADDRESS OF OPERATOR

P. O. Box 1600, Midland, TX 79702

4. LOCATION OF WELL (Report location clearly and in accordance with any State regulations)
At surface

2479' FSL and 1880' FWL of Sec.

At proposed prod. zone

14. DISTANCE IN MILES AND DIRECTION FROM NEAREST TOWN OR POST OFFICE*

5 miles SW from Carlsbad

10. DISTANCE FROM PROPOSED*
LOCATION TO NEAREST
PROPERTY OR LEASE LINE, FT.
(Also to nearest drlg. unit line, if any)

1880' FWL

18. DISTANCE FROM PROPOSED LOCATION*
TO NEAREST WELL, DRILLING, COMPLETED,
OR APPLIED FOR, ON THIS LEASE, FT.

None

16. NO. OF ACRES IN LEASE

1440.84

19. PROPOSED DEPTH

10,857

17. NO. OF ACRES ASSIGNED
TO THIS WELL

320

20. ROTARY OR CABLE TOOLS

N/A

21. ELEVATIONS (Show whether DF, RT, GR, etc.)

FR 3695'

22. APPROX. DATE WORK WILL START*

23.

PROPOSED CASING AND CEMENTING PROGRAM

SIZE OF HOLE	SIZE OF CASING	WEIGHT PER FOOT	SETTING DEPTH	QUANTITY OF CEMENT
26	20	94	85	250 SX
17 1/2	13 3/8	54.5	1510	2635 SX
12 1/4	9 5/8	40	2604	775 SX
8 1/2	5	20.8	11665	2800 SX

This well is currently completed in the Sheep Draw Morrow Gas field. Exxon proposes to set a CIBP above the Morrow, then perforate and stimulate the Atoka. The Atoka will be produced until the Morrow and Atoka BHP are more nearly equal. At that time the two zones will be commingled.

BOPs will be Class 1.

IN ABOVE SPACE DESCRIBE PROPOSED PROGRAM: If proposal is to deepen or plug back, give data on present productive zone and proposed new productive zone. If proposal is to drill or deepen directionally, give pertinent data on subsurface locations and measured and true vertical depths. Give blowout preventer program, if any.

24.

SIGNED

David A. Murray
David A. Murray

TITLE

Permits Supervisor

DATE

5-29-87

PERMIT NO.

APPROVAL DATE

TITLE

Ray G. ...
CARLSBAD RESOURCE AREA

DATE

6-16-87

APPROVED BY

CONDITIONS OF APPROVAL, IF ANY:

*See Instructions On Reverse Side

Exxon Lse. No. _____

NEW MEXICO OIL CONSERVATION COMMISSION

Form C-102
Supersedes C-128
Effective 1-1-65

State Lse. No. _____

WELL LOCATION AND ACREAGE DEDICATION PLAT

Federal Lse. No. NM 0453201

All distances must be from the outer boundaries of the Section.

Operator Exxon Corporation			Lease SQUAW FEDERAL		Well No. 3
Unit Letter K	Section 1	Township 23 S	Range 25 E	County EDDY	
Actual Footage Location of Well: 2479' feet from the South line and 1880' feet from the West line					
Ground Level Elev. 3695	Producing Formation ATOKA		Pool UNDES. SHEEP DRAW GAS		Dedicated Acreage: 320 Acres

1. Outline the acreage dedicated to the subject well by colored pencil or hachure marks on the plat below.

2. If more than one lease is dedicated to the well, outline each and identify the ownership thereof (both as to working interest and royalty).

3. If more than one lease of different ownership is dedicated to the well, have the interests of all owners been consolidated by communitization, unitization, force-pooling, etc?

☐ Yes ☐ No If answer is "yes," type of consolidation _____

If answer is "no," list the owners and tract descriptions which have actually been consolidated. (Use reverse side of this form if necessary.) _____

No allowable will be assigned to the well until all interests have been consolidated (by communitization, unitization, forced-pooling, or otherwise) or until a non-standard unit, eliminating such interests, has been approved by the Commission.

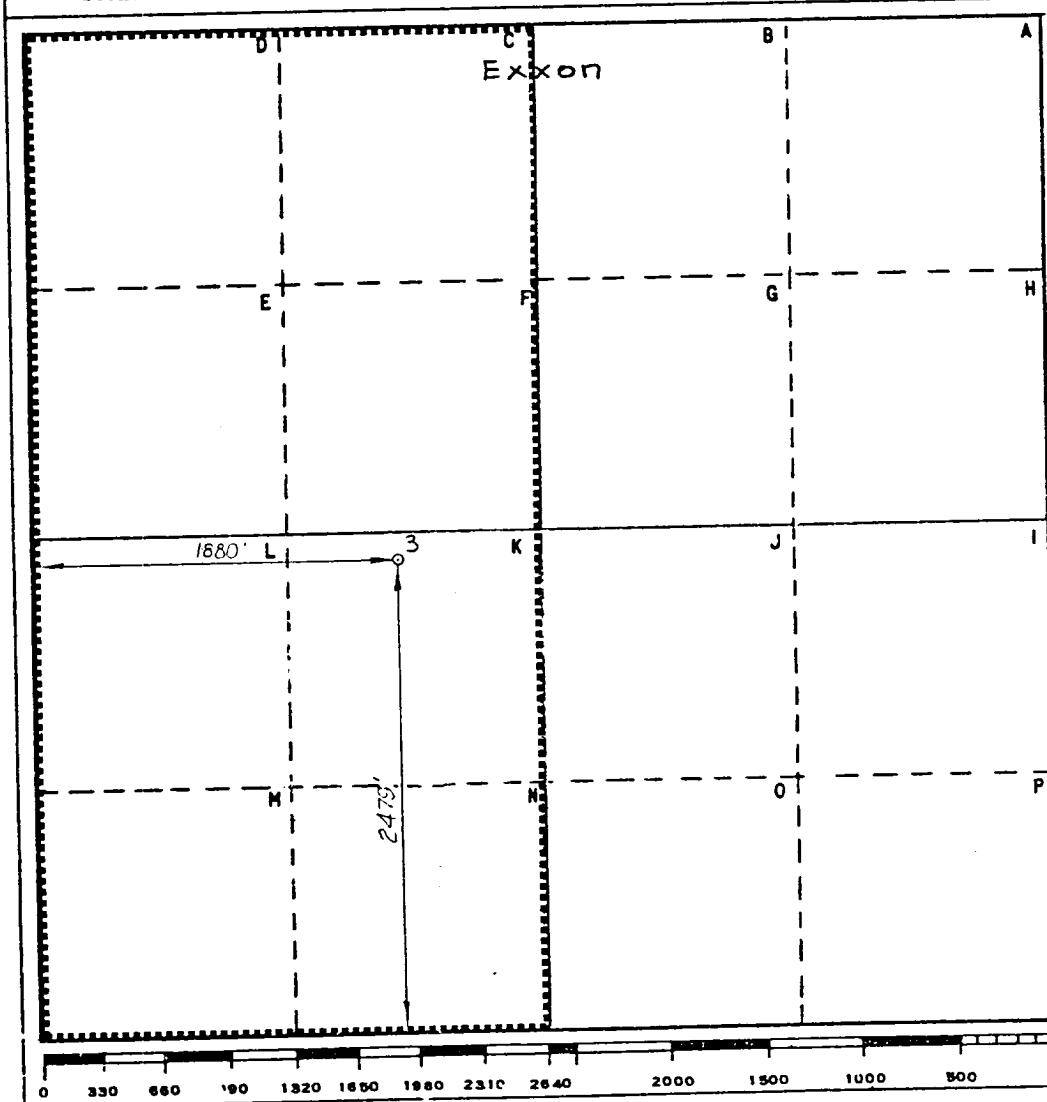

CERTIFICATION

I hereby certify that the information contained herein is true and complete to the best of my knowledge and belief.

Name

David S. Munday

Position

UNIT HEAD

Company Exxon Corporation

Box 1600 Midland, Texas

Date

I hereby certify that the well location shown on this plat was plotted from field notes of actual surveys made by me or under my supervision and that the same is true and correct to the best of my knowledge and belief.

Date Surveyed

7-25-85

Registered Professional Engineer
and/or Land Surveyor*Bruce R. Pennell*

Certificate No.

9062

C.E. Sec. File No. W-A-F-144