

Exxon Lse. No. _____
State Lse. No. _____
Federal Lse. No. _____

NEW MEXICO OIL CONSERVATION COMMISSION
WELL LOCATION AND ACREAGE DEDICATION PLAT

Form C-102
Supersedes C-128
Effective 1-1-65

All distances must be from the outer boundaries of the Section.

Operator Exxon Corporation ✓		Lease N.M. "EU" STATE COM		Well No. 1
Unit Letter J	Section 26	Township 23 S	Range 26 E	County EDDY

Actual Footage Location of Well:

1980 feet from the South line and 1980 feet from the East line

Ground Level Elev. 3243'	Producing Formation MORROW	Pool SOUTH CARLSBAD	Dedicated Acreage: 320 Acres
-----------------------------	-------------------------------	------------------------	---------------------------------

1. Outline the acreage dedicated to the subject well by colored pencil or hachure marks on the plat below.
2. If more than one lease is dedicated to the well, outline each and identify the ownership thereof (both as to working interest and royalty).
3. If more than one lease of different ownership is dedicated to the well, have the interests of all owners been consolidated by communitization, unitization, force-pooling, etc?

☐ Yes ☐ No If answer is "yes," type of consolidation COMMUNITIZATION PENDING

If answer is "no," list the owners and tract descriptions which have actually been consolidated. (Use reverse side of this form if necessary.) _____

No allowable will be assigned to the well until all interests have been consolidated (by communitization, unitization, forced-pooling, or otherwise) or until a non-standard unit, eliminating such interests, has been approved by the Commission.

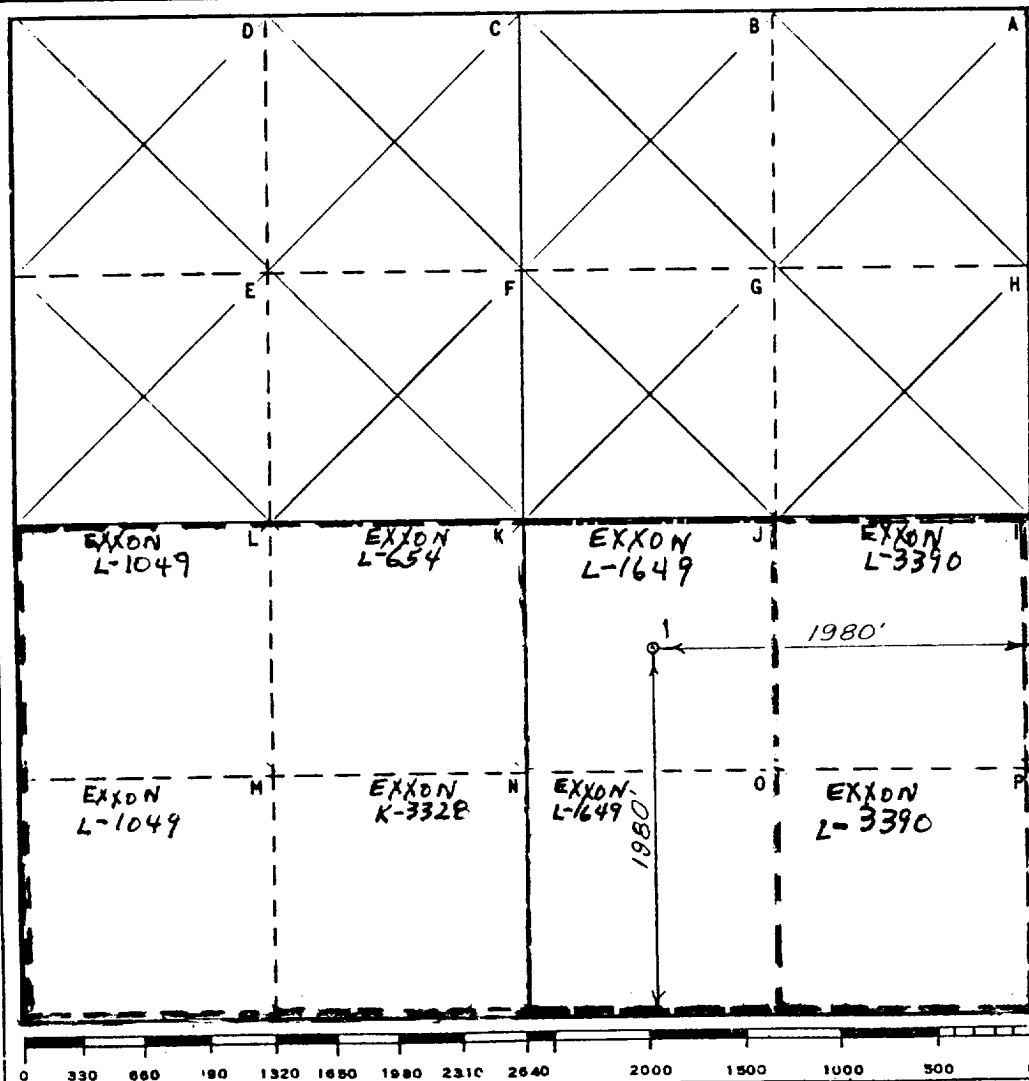

CERTIFICATION

I hereby certify that the information contained herein is true and complete to the best of my knowledge and belief.

Name <i>Bruce R. Pennell</i>
Position UNIT HEAD
Company Exxon Corporation Box 1600 Midland, Texas
Date 11-19-85

I hereby certify that the well location shown on this plat was plotted from field notes to actual survey made by me or under my supervision and that the same is true and correct to the best of my knowledge and belief.

Date Surveyed 5-10-85
Registered Professional Engineer and/or Land Surveyor <i>Bruce R. Pennell</i>
Certificate No. #9062

9.5 miles N.E. of Whites City, New Mexico

C.E. Sec. File No. W-A-8929