

NO. OF COPIES RECEIVED	
DISTRIBUTION	
SANTA FE	
FILE	
U.S.G.S.	
LAND OFFICE	
OPERATOR	

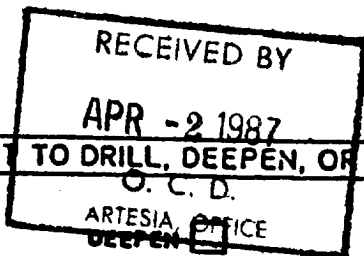

3A. Indicate Type of Lease

STATE ☒ FEDERAL ☐

3. State Oil & Gas Lease No.

05229

APPLICATION FOR PERMIT TO DRILL, DEEPEN, OR PLUG BACK

1. Type of Work

2. Type of Well

DRILL ☒

PLUG BACK ☐

OIL WELL ☒

GAS WELL ☐

OTHER

SINGLE ZONE ☒

MULTIPLE ZONE ☐

3. Name of Operator

Texaco Producing Inc.

4. Address of Operator

P. O. Box 728, Hobbs, New Mexico 88240

5. Location of Well

UNIT LETTER F LOCATED 2310 FEET FROM THE North LINE

6. 1980

FEET FROM THE West LINE OF SEC. 16 TWP. 23-S REC. 30-E NMPM

7. Unit Agreement Name

8. Farm or Lease Name

Forty-Niner Ridge Unit

9. Well No.

3

10. Field and Pool, or Wildcat
Forty-Niner Ridge
Delaware

12. County

Eddy

11. Elevations (Show whether DE, KT, etc.)

3124' GR

21A. Kind & Status Plug. Bond

Blanket DL

19. Proposed Depth

6400'

19A. Formation

Cherry Canyon

20. Rotary or C.T.

Rotary

22. Approx. Date Work will start

May, 1987

PROPOSED CASING AND CEMENT PROGRAM

SIZE OF HOLE	SIZE OF CASING	WEIGHT PER FOOT	SETTING DEPTH	SACKS OF CEMENT	EST. TOP
17-1/2"	13-3/8"	54.5#	400'	600	Circulate
12-1/4"	8-5/8"	2200'-24#	3200' 35.7'	1500	Circulate
7-7/8"	5-1/2"	1000'-28# 15.5#	6400'	950	Circulate

CEMENTING PROGRAM

Surface Casing: 600 sacks Class "H" with 2% CaCl (15.6 ppg, 1.18 cu. ft./sx).

Intermediate Casing: 1300 sacks Lite Weight w/15# Salt and 1/4# Flocele (12.7 ppg, 210 cu. ft./sx.) followed by 200 sacks Class "H" w/1/4# Flocele (15.6 ppg, 1.18 cu. ft./sx.).

Production Casing: 750 sacks Lite Weight w/1/4# Flocele (12.3 ppg, 2.00 cu. ft./sx.) followed by 200 sacks Class "H" w/1/4# Flocele (15.6 ppg, 1.18 cu. ft./sx.).

There are no other wells in this 1/4, 1/4 Section. UNLESS DRILLING UNDERWAY

ABOVE SPACE DESCRIBE PROPOSED PROGRAM IF PROPOSAL IS TO DEEPEN OR PLUG BACK, GIVE DATA ON PRESENT PRODUCTIVE ZONE AND PROPOSED NEW PRODU.

I hereby certify that the information above is true and complete to the best of my knowledge and belief.

W. B. Cade

Title District Oper. Manager

Date March 27, 1987

(This space for State Use)

APPROVED BY Mike Williams

TITLE OIL AND GAS INSPECTOR

DATE SEP 7 1987

CONDITIONS OF APPROVAL, IF ANY:

1. 13 3/8" O.D. in sufficient

2. 13 3/8" O.D. in sufficient

3. 13 3/8" O.D. in sufficient

All distances must be from the outer boundaries of the Section.

Operator Texaco Producing Inc.		Lease Forty Niner Ridge Unit		Well No. 3
Unit Letter F	Section 16	Township 23-S	Range 30-E	County Eddy
Actual Footage Location of Well: 2310 feet from the North line and 1980 feet from the West line				
Ground Level Elev. 3124'	Producing Formation Cherry Canyon	Pool Forty Niner Ridge Delaware	Dedicated Acreage: 40 Acres	

1. Outline the acreage dedicated to the subject well by colored pencil or hatchure marks on the plat below.
2. If more than one lease is dedicated to the well, outline each and identify the ownership thereof (both as to working interest and royalty).
3. If more than one lease of different ownership is dedicated to the well, have the interests of all owners been consolidated by communitization, unitization, force-pooling, etc? O. C. D.

☒ Yes ☐ No If answer is "yes," type of consolidation Unitization

If answer is "no," list the owners and tract descriptions which have actually been consolidated. (Use reverse side of this form if necessary.)

No allowable will be assigned to the well until all interests have been consolidated (by communitization, unitization, forced-pooling, or otherwise) or until a non-standard unit, eliminating such interests, has been approved by the Division.

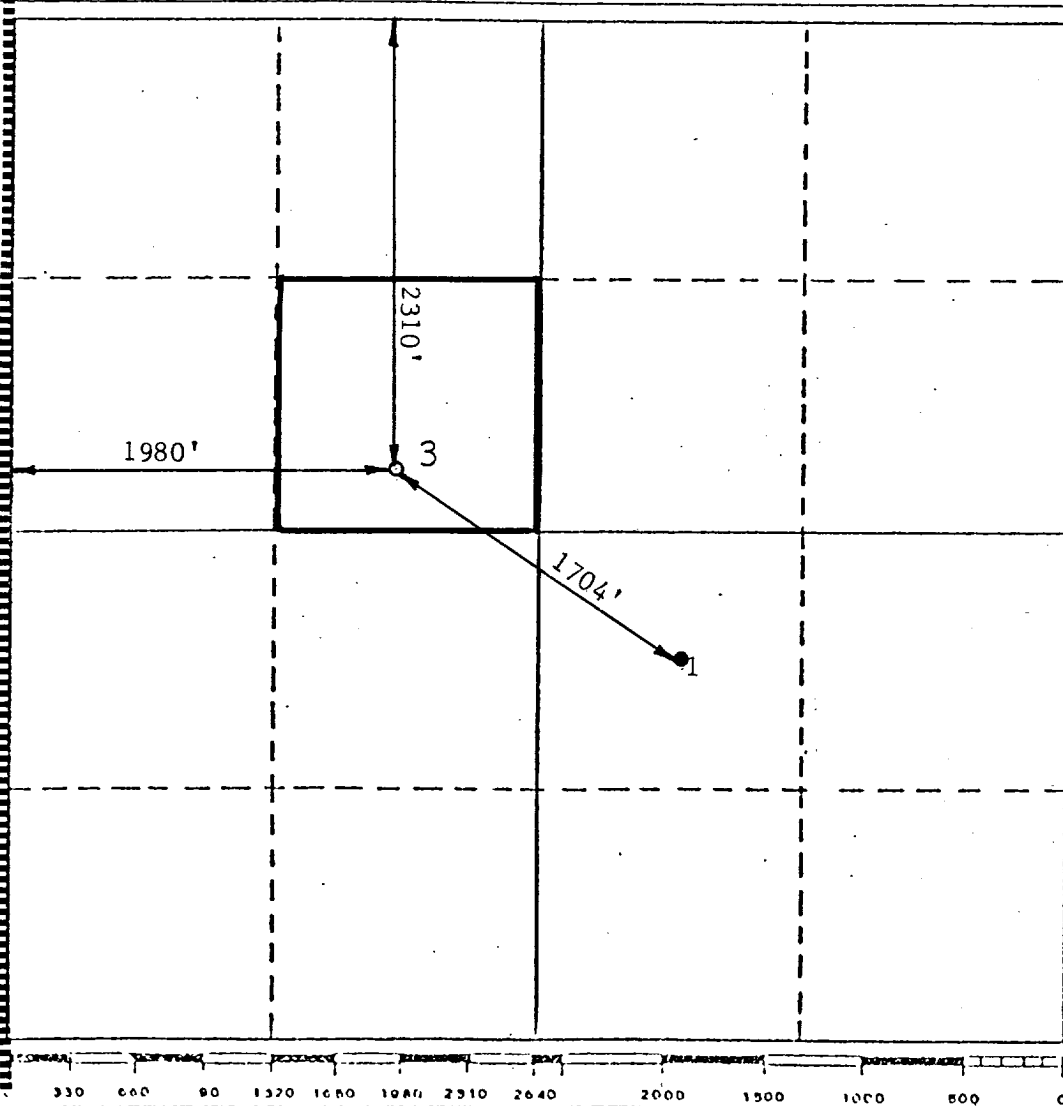

CERTIFICATION

I hereby certify that the information contained herein is true and complete to the best of my knowledge and belief.

B. L. Eiland

Name

B. L. Eiland

Position

Division Surveyor

Company

Texaco Producing Inc.

Date

March 24, 1987

I hereby certify that the well location shown on this plat was plotted from field notes of actual surveys made by me or under my supervision, and that the same is true and correct to the best of my knowledge and belief.

Date Surveyed NEW

March 23, 1987

Registered Professional Engineer

and/or Land Surveyor

B. L. Eiland
B. L. Eiland

Certificate No.

4386

CONDITION II-B 3000 WP
FOR AIR DRILLING OR
WHERE YATES AIR BLOWS ARE EXPECTED

H₂S TRIM REQUIRED
YES _____ NO _____

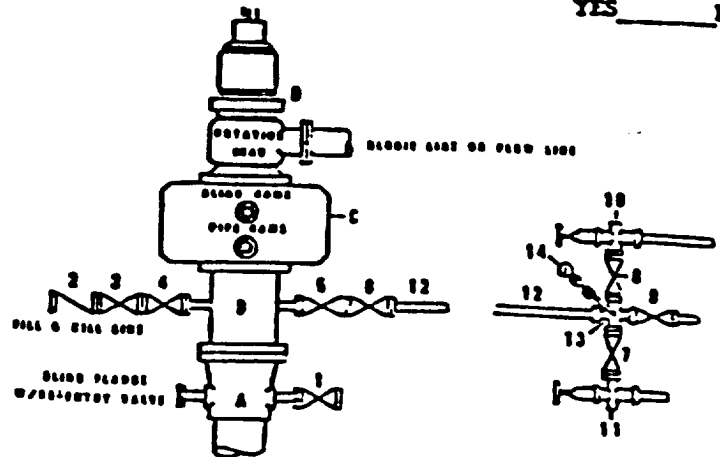

FILLING CONTROL

MATERIAL LIST - CONDITION II - B
FOR AIR DRILLING

- A Texaco Wellhead
- B 3000# W.P. drilling spool with a 2" minimum flanged outlet for kill-line and 3" minimum flanged outlet for choke line
- C 3000# W.P. Dual ram type preventer, hydraulic operated with 1" steel, 3000# W.P. control lines (where sub-structure height is adequate, 2-3000# W.P. single ram type preventers may be utilized.)
- D Rotating Head and extended Electric Line.
- 1,3,4, 7,8 2" minimum 3000# W.P. flanged full opening steel gate valve, or Halliburton Le Torr Plug valve.
- 2 2" minimum 3000# W.P. back pressure valve
- 3,6,9 3" minimum 3000# W.P. flanged full opening steel gate valve, or Halliburton Le Torr Plug valve.
- 12 3" minimum schedule 80, Grade "B", seamless line pipe
- 13 2" minimum x 3" minimum 3000# W.P. flanged cross
- 10, 11 2" minimum 3000# W.P. adjustable choke bodies
- 14 Cameron Mud Gauge or equivalent (location optional in choke line.)

DATE	DATE	REV. NO.	REV. NO.
DESIGNED BY			
CHECKED BY			
APPROVED BY			



TEXACO, INC.
PRODUCING DEPARTMENT (SICUT)
MIDLAND, TEXAS



EXHIBIT C



Texaco USA

P.O. Box 728
Hobbs NM 88240
505 390 7191

March 27, 1987

IMCC
P. O. Box 71
Carlsbad, New Mexico 88220

RE: Forty-Niner Ridge Unit Well No. 3
Eddy County, New Mexico

Gentlemen:

In accordance with Oil Conservation Commission Order No. R-111A, Texaco Producing Inc. wishes to notify you of our application to drill the referenced well. The well will be located 2310' FNL and 1980' FWL of Section 16, T-23-S, R-30-E and will be drilled to a total depth of 6400'.

A copy of Forms C-101 and C-102 are attached for your information. If you have any questions, please contact this office.

Yours very truly,

W. B. Cade
District Operations Manager

LDR:JRB

Attachments



Texaco USA

P.O. Box 728
Hobbs NM 88240
505 393 7191

March 27, 1987

Potash Producers
P. O. Box 511
Carlsbad, New Mexico 88220

RE: Forty-Niner Ridge Unit Well No. 3
Eddy County, New Mexico

Gentlemen:

In accordance with Oil Conservation Commission Order No. R-111A, Texaco Producing Inc. wishes to notify you of our application to drill the referenced well. The well will be located 2310' FNL and 1980' FWL of Section 16, T-23-S, R-30-E and will be drilled to a total depth of 6400'.

A copy of Forms C-101 and C-102 are attached for your information. If you have any questions, please contact this office.

Yours very truly,

W. B. Cade
District Operations Manager

LDR:JRB

Attachments