

(November 1983)
(Formerly 9-351C)

UNITED STATES
DEPARTMENT OF THE INTERIOR
BUREAU OF LAND MANAGEMENT

(Other Instruct on
reverse side)

30-015-25590

Budget Bureau No. 1004-0136
Expires August 31, 1985

APPLICATION FOR PERMIT TO DRILL, DEEPEN, OR PLUG BACK

1a. TYPE OF WORK

DRILL ☐

DEEPEN ☐

PLUG BACK ☐

b. TYPE OF WELL

OIL
WELL ☒

GAS
WELL ☐

OTHER

SINGLE
ZONE ☒

MULTIPLE
ZONE ☐

2. NAME OF OPERATOR

Mountain States Petroleum Corporation

3. ADDRESS OF OPERATOR

P. O. Box 1936 Roswell, NM 88201

4. LOCATION OF WELL (Report location clearly and in accordance with any State requirements.)

At surface

2180' FNL & 2080' FEL

At proposed prod. zone

Same

14. DISTANCE IN MILES AND DIRECTION FROM NEAREST TOWN OR POST OFFICE*

4.2 nukes NE of Loving, NM

15. DISTANCE FROM PROPOSED*

LOCATION TO NEAREST
PROPERTY OR LEASE LINE, FT.

(Add to nearest drlg. unit line, if any.)

660'

16. DISTANCE FROM PROPOSED LOCATION*

TO NEAREST WELL, DRILLING COMPLETED,
OR ADJACENT FOR ON THIS LEASE, FT.

None

16. NO. OF ACRES IN LEASE

480 ac. farmout

19. PROPOSED DEPTH

3,900

17. NO. OF ACRES ASSIGNED
TO THIS WELL

40

20. ROTARY OR CABLE TOOLS

Rotary

21. ELEVATIONS (Show whether DF, RT, GR, etc.)

3101 GR

22. APPROX. DATE WORK WILL START*

March 6, 1986

PROPOSED CASING AND CEMENTING PROGRAM

SIZE OF HOLE	SIZE OF CASING	WEIGHT PER FOOT	SETTING DEPTH	QUANTITY OF CEMENT
11-1/4"	8-5/8"	24.0	400	250 sx Class C or circulate
7-7/8"	5-1/2"	14.0	3900	300 sx Class H w/additives

Mud Program:

0 - 400' Spud mud, fresh water & native mud.
400 - 3500' Cut brine water and native mud.
3500 - 3900' Mudup with saltwater gel. Wt 9.5, Visc. 40, WL 10cc

BOP Program:

A 2000 psi 600 series double hydraulic operated BOP will be used and operationally tested daily. See Exhibit "D", attached.

IN ABOVE SPACE DESCRIBE PROPOSED PROGRAM: If proposal is to deepen or plug back, give data on present productive zone and proposed new productive zone. If proposal is to drill or deepen directionally, give pertinent data on subsurface locations and measured and true vertical depths. Give blowout preventer program, if any.

SIGNED Kay C. Higgins

TITLE Geologist

DATE 03/04/86

(This space for Federal or State office use)

PERMIT NO.

APPROVAL DATE

APPROVED BY

TITLE

DATE

CONDITIONS OF APPROVAL, IF ANY:

APPROVAL SUBJECT TO
GENERAL REQUIREMENTS AND
SPECIAL STIPULATIONS

*See Instructions On Reverse Side

ATTACHED

Title 18 U.S.C. Section 1001, makes it a crime for any person knowingly and willfully to make to any department or agency of the United States any false, fictitious or fraudulent statements or representations as to any matter within its jurisdiction.

WELL LOCATION AND ACREAGE DEDICATION PLAT

Supersedes C-128
Effective 1-1-65

All distances must be from the outer boundaries of the Section.

Operator Mountain States Petroleum Company			Lease MSPC , Santa Fe Federal		Well No. 1
Unit Letter G	Section 35	Township 22 South	Range 28 East	County Eddy County	
Actual Footage Location of Well: 2080 feet from the North line and 2080 feet from the East line					
Ground Level Elev. 3101.0	Producing Formation <i>Permian</i>	Pool <i>Wilcox</i>	Dedicated Acreage: 4.8 Acres		

1. Outline the acreage dedicated to the subject well by colored pencil or hatchure marks on the plat below.
2. If more than one lease is dedicated to the well, outline each and identify the ownership thereof (both as to working interest and royalty).
3. If more than one lease of different ownership is dedicated to the well, have the interests of all owners been consolidated by communitization, unitization, force-pooling, etc?

☐ Yes ☐ No If answer is "yes," type of consolidation _____

If answer is "no," list the owners and tract descriptions which have actually been consolidated. (Use reverse side of this form if necessary.) _____

No allowable will be assigned to the well until all interests have been consolidated (by communitization, unitization, forced-pooling, or otherwise) or until a non-standard unit, eliminating such interests, has been approved by the Commission.

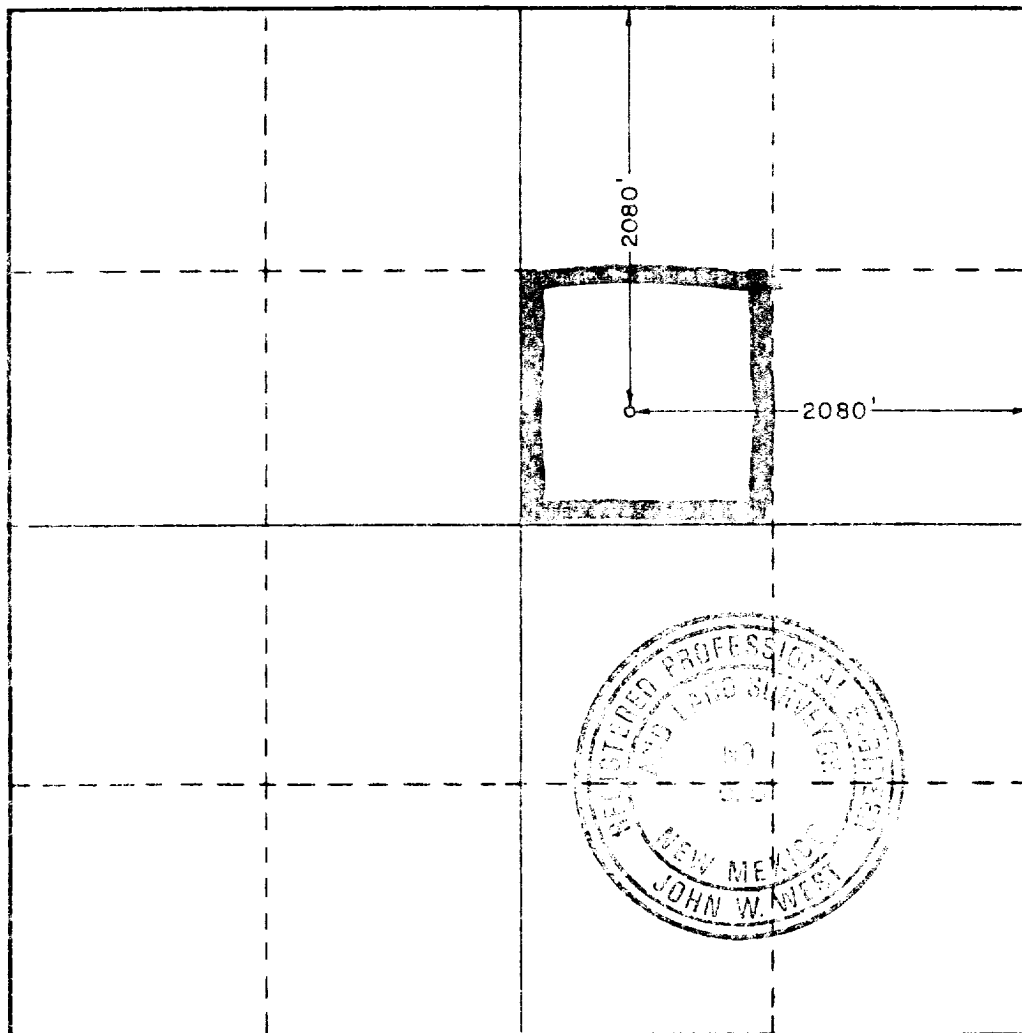

CERTIFICATION

I hereby certify that the information contained herein is true and complete to the best of my knowledge and belief

Kay C. Havenor
Name

Kay C. Havenor

Position
Geologist

Company
Mountain State Petroleum

Date
March 4, 1986

I hereby certify that the well location shown on this plat was plotted from field notes of actual surveys made by me or under my supervision, and that the same is true and correct to the best of my knowledge and belief.

Date Surveyed
March 4, 1986

Registered Professional Engineer:
and/or Land Surveyor

John W. West

Certificate No. JOHN W. WEST, 676
RONALD J. EIDSON, 3239

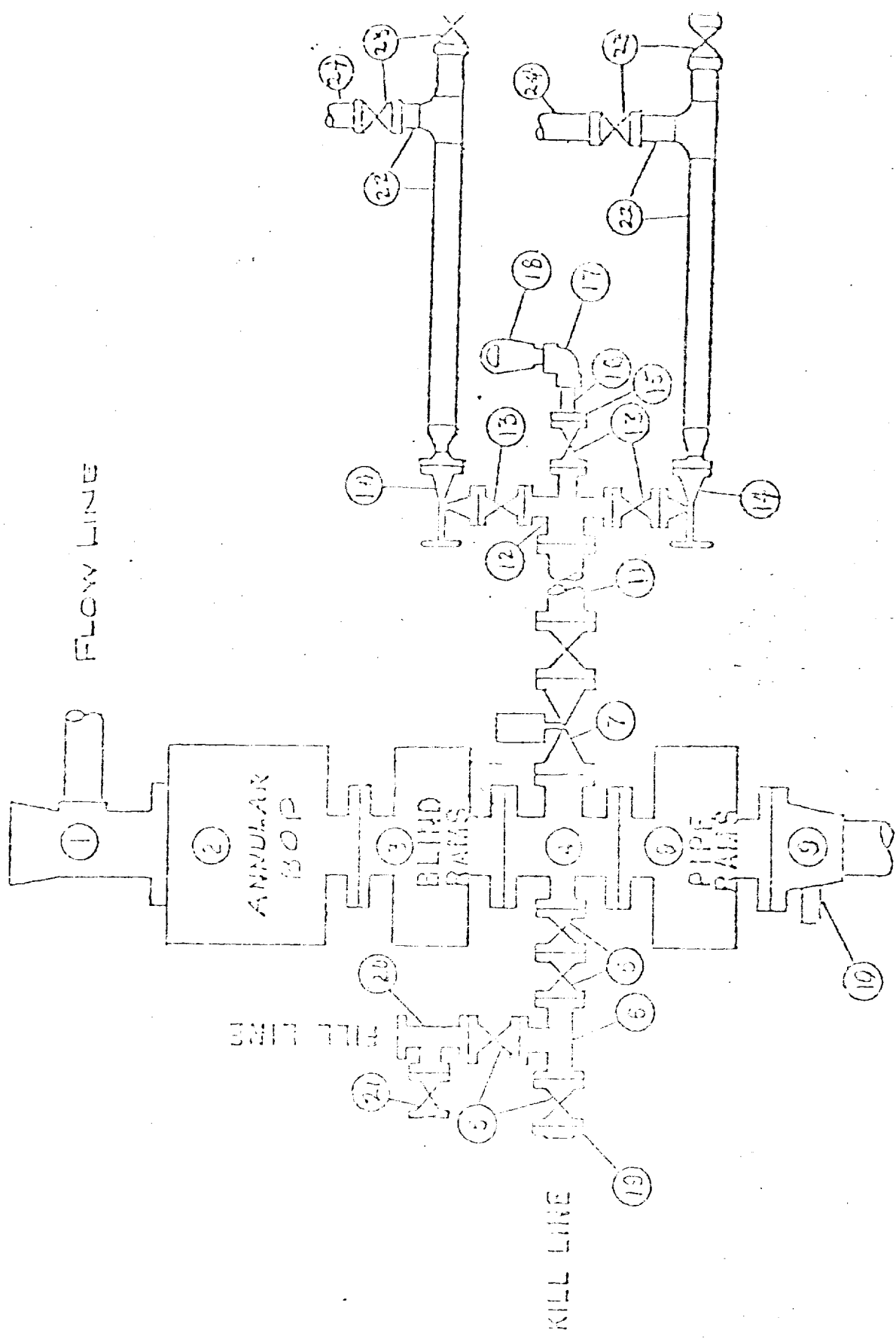

Mountain States Petroleum Corporation
Santa Fe Federal No. 1

Exhibit "D"

APPLICATION FOR DRILLING

MOUNTAIN STATES PETROLEUM CORPORATION
Santa Fe Federal No. 1
~~2080'~~ FNL & ~~2080'~~ FEL Sec. 35, T22S-R28E
Eddy County, New Mexico
Lease No.: NM-19842
(Wildcat well)

In conjunction with Form 9-331C, Application for Permit to Drill the subject well, Mountain States Petroleum Corporation submits the following items of pertinent information in accordance with BLM requirements:

1. The geologic surface formation is Permian with quarternary alluvium and other surficial deposits.
2. The estimated tops of geologic markers are as follows:

Top of Salt	480'
Base of Salt	1110'
Lamar Lime	2715'
Bell Canyon	2750'
Cherry Canyon	3750'
3. The estimated depth at which anticipated water, oil or gas formations are expected to be encountered:

Water:	Random water sands from surface to 250'
Gas:	None
Oil:	Delaware Sands 2750' to TD
4. Proposed casing program: See Form 9-331C.
5. Pressure Control Equipment: See Form 9-331C and Exhibit "E".
6. Mud Program: See Form 9-331C.
7. Auxiliary Equipment: Blowout preventer, gas detector, kelly cock.
8. Testing, logging and coring program:

Logging:	Gamma Ray, Comp. Density/Neutron, Laterolog
Drill stem testing:	none anticipated
Coring:	Possible sidewall cores in Delaware Sand.

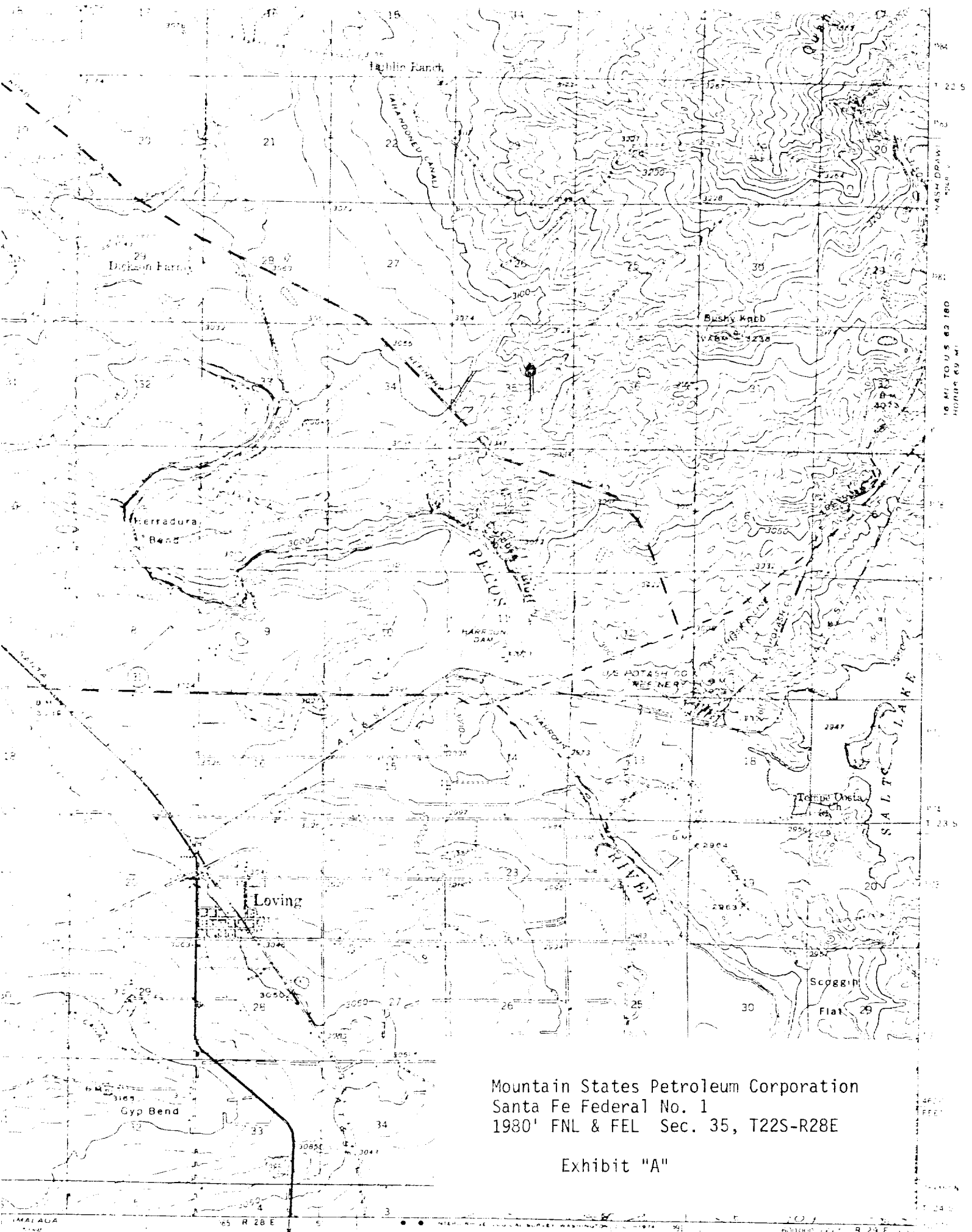

Mountain States Petroleum Corporation
Santa Fe Federal No. 1
1980' FNL & FEL Sec. 35, T22S-R28E

Exhibit "A"

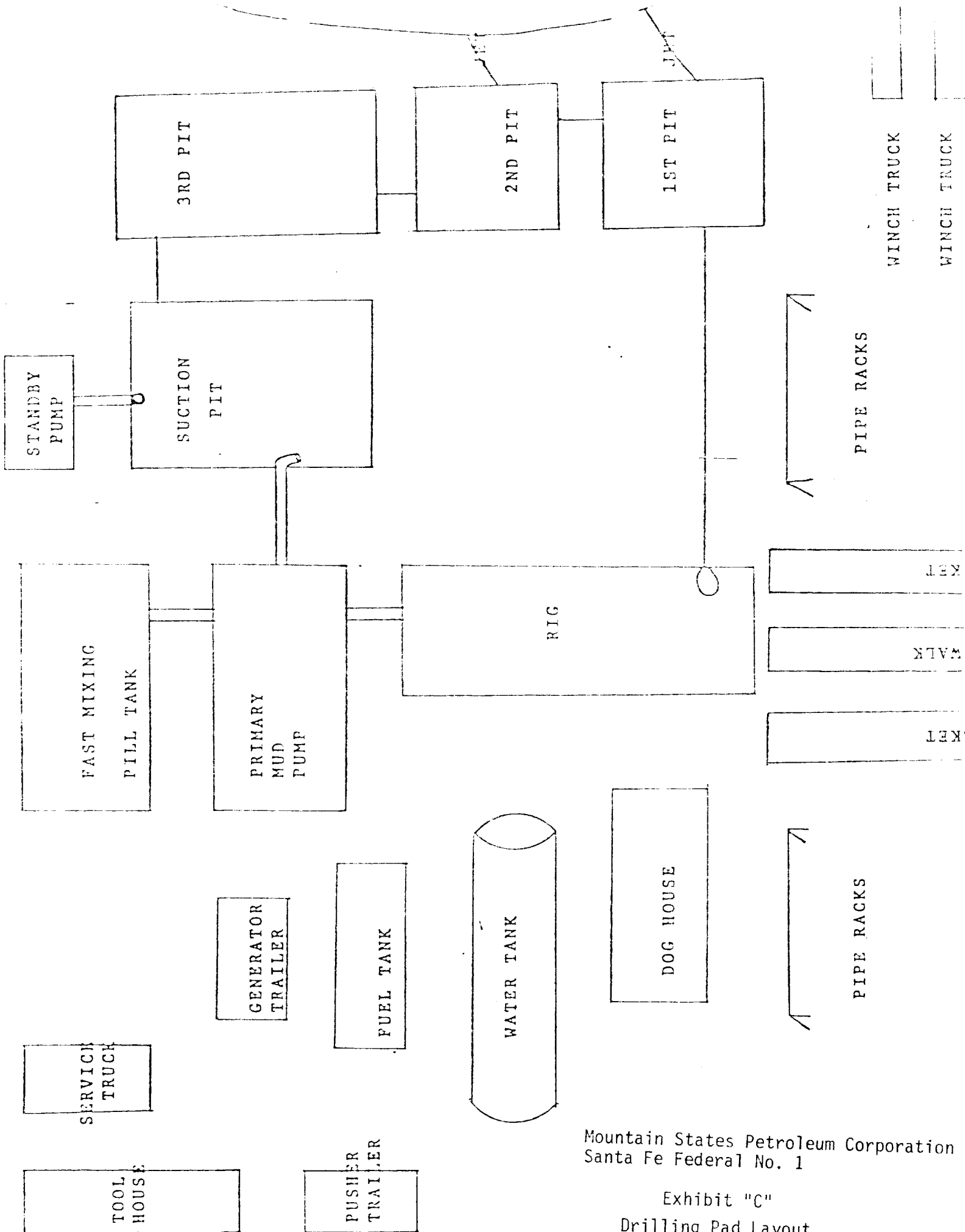

Mountain States Petroleum Corporation
Santa Fe Federal No. 1

Exhibit "C"
Drilling Pad Layout