

STATE OF NEW MEXICO
ENERGY AND MINERALS DEPARTMENT

OIL CONSERVATION DIVISION

50-015-25613

Form C-101
Revised 10-1-78

NO. OF COPIES RECEIVED	
DISTRIBUTION	
SANTA FE	
FILE	
U.S.G.S.	
LAND OFFICE	
OPERATOR	

P. O. BOX 2088

SANTA FE, NEW MEXICO 87501

RECEIVED BY

APR 15 1986

5A. Indicate Type of Lease
STATE ☒ FEE ☐
5. State Oil & Gas Lease No.
LG-3595

APPLICATION FOR PERMIT TO DRILL, DEEPEN, OR PLUG BACK

1a. Type of Work DRILL <input checked="" type="checkbox"/> DEEPEN <input type="checkbox"/> PLUG BACK <input type="checkbox"/>		7. Unit Agreement Name
b. Type of Well OIL WELL <input checked="" type="checkbox"/> GAS WELL <input type="checkbox"/> OTHER <input type="checkbox"/> SINGLE ZONE <input type="checkbox"/> MULTIPLE ZONE <input type="checkbox"/>		8. Farm or Lease Name Amoco State
2. Name of Operator MAX WILSON, INC. 505-623-0507		9. Well No. 1
3. Address of Operator P. O. Drawer 1978 - Roswell, NM 88201		10. Field and Pool, or Wildcat Wildcat - Williams
4. Location of Well UNIT LETTER J LOCATED 1,980' FEET FROM THE South LINE AND 1,980' FEET FROM THE East LINE OF SEC. 31 TWP. 24S RGC. 28E NMPM		12. County Eddy
19. Proposed Depth 4,200'		19A. Formation Cherry Canyon
20. Rotary or C.T. Rotary		
21. Elevations (show whether DF, RT, etc.) 3,021'	21A. Kind & Status Plug. Bond C/W Well	21B. Drilling Contractor Salazar Bros. Drlg. Co.
		22. Approx. Date Work will start 5/1/86

23.

PROPOSED CASING AND CEMENT PROGRAM

SIZE OF HOLE	SIZE OF CASING	WEIGHT PER FOOT	SETTING DEPTH	SACKS OF CEMENT	EST. TOP
12-1/4"	8-5/8"	24#	300'	350 sx	cir.
7-7/8"	4 1/2"	9.5#	4,200'	400 sx	

Received
NO. 101
4-15-86

APPROVAL VALID FOR 180 DAYS
RECEIVED 10-23-86
UNDERWAY

IN ABOVE SPACE DESCRIBE PROPOSED PROGRAM; IF PROPOSAL IS TO DEEPEN OR PLUG BACK, GIVE DATA ON PRESENT PRODUCTIVE ZONE AND PROPOSED NEW PRODUCTIVE ZONE. GIVE BLOWOUT PREVENTER PROGRAM IF ANY.

I hereby certify that the information above is true and complete to the best of my knowledge and belief.

Signed BY: MAX WILSON, INC. Title President Date 4/9/86

(This space for State Use)

APPROVED BY: Original Signed By Mike Williams TITLE Oil & Gas Inspector DATE APR 23 1986

CONDITIONS OF APPROVAL, IF ANY

W MEXICO OIL CONSERVATION COMMISSION
WELL LOCATION AND ACREAGE DEDICATION PLAT

Form C-102
Supersedes C-128
Effective 1-1-65

All distances must be from the outer boundaries of the Section.

Operator MAX WILSON, INC.		Lease AMOCO-STATE		Well No. 1
Unit Letter "J"	Section 31	Township 24-S	Range 28-E	County EDDY
Actual Footage Location of Well: <div style="display: flex; justify-content: space-between;"> 1980 feet from the SOUTH line and 1980 feet from the EAST line </div>				
Ground Level Elev. 3021	Producing Formation CHERRY CANYON	Pool WILDCAT - De laune	Dedicated Acreage: 40 Acres	

1. Outline the acreage dedicated to the subject well by colored pencil or hachure marks on the plat below.
2. If more than one lease is dedicated to the well, outline each and identify the ownership thereof (both as to working interest and royalty).
3. If more than one lease of different ownership is dedicated to the well, have the interests of all owners been consolidated by communitization, unitization, force-pooling, etc?

☐ Yes ☐ No If answer is "yes," type of consolidation _____

If answer is "no," list the owners and tract descriptions which have actually been consolidated. (Use reverse side of this form if necessary.) _____

No allowable will be assigned to the well until all interests have been consolidated (by communitization, unitization, forced-pooling, or otherwise) or until a non-standard unit, eliminating such interests, has been approved by the Commission.

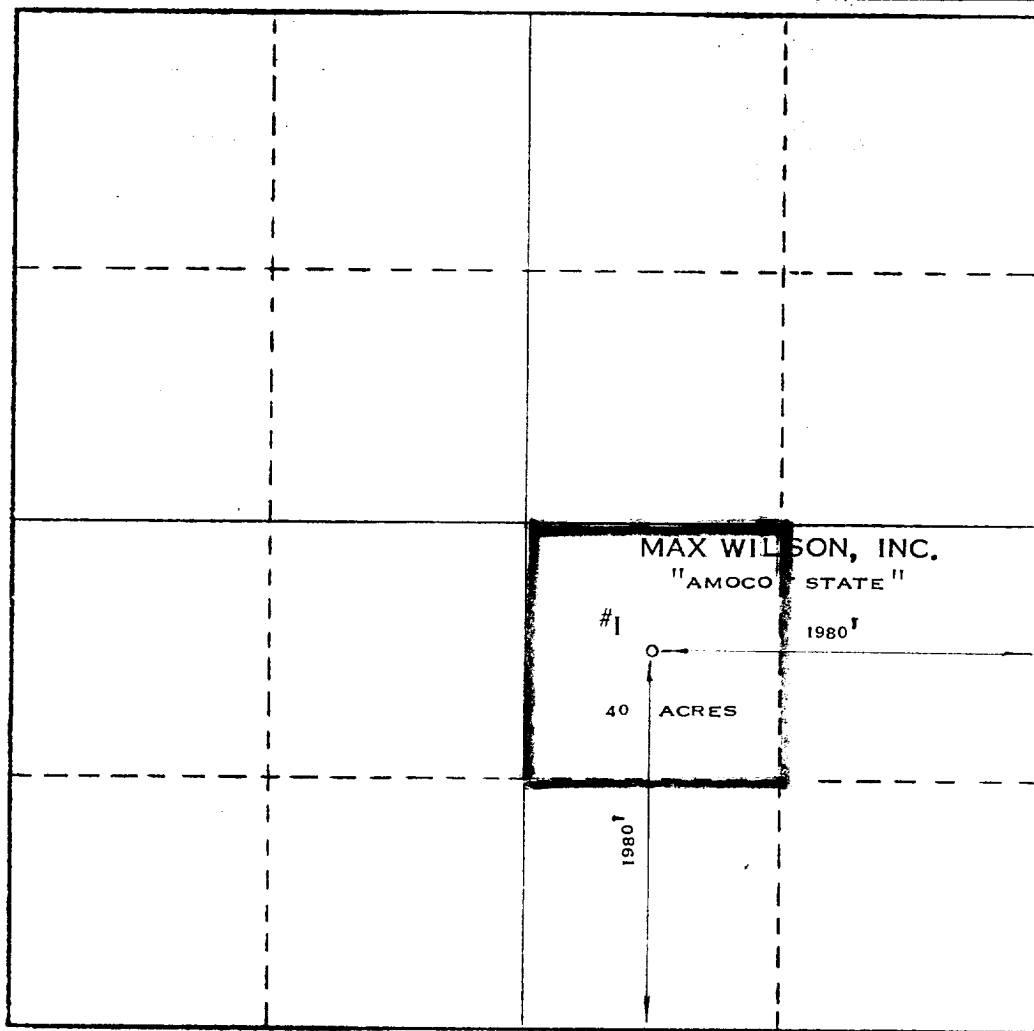

CERTIFICATION

I hereby certify that the information contained herein is true and complete to the best of my knowledge and belief.

Name *[Signature]*
 Position
President
 Company
Max Wilson, Inc.
 Date
4/9/86

I hereby certify that the well location shown on this plat was plotted from field notes of actual surveys made by me or under my supervision, and that the same is true and correct to the best of my knowledge and belief.

Date Surveyed
MARCH 12, 1986

Registered Professional Engineer
 and/or Land Surveyor
[Signature]
MAX A. SCHUMANN

Certificate No. **1510**

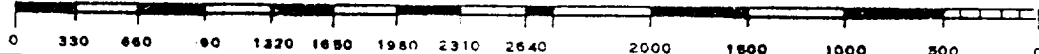

Blowout Preventer

EXHIBIT B

MAX WILSON, INC.

NO. 1 AMOCO STATE
1,980' FSL and 1,980' FEL
Section 31
T.24S R.28E
Eddy County, New Mexico

- ① 3" SERIES 1500 VALVE
- ② 2" SERIES 1500 VALVE
- ③ 2" MUD PRESSURE GAUGE ON 3" X 3" X 2" SERIES 1500 STEEL TEE
- ④ 3" SERIES 1500 X 2" SERIES 1500 STEEL CROSS
- ⑤ 2" SERIES 1500 POSITIVE CHOKE
- ⑥ 2" SERIES 1500 ADJUSTABLE CHOKE

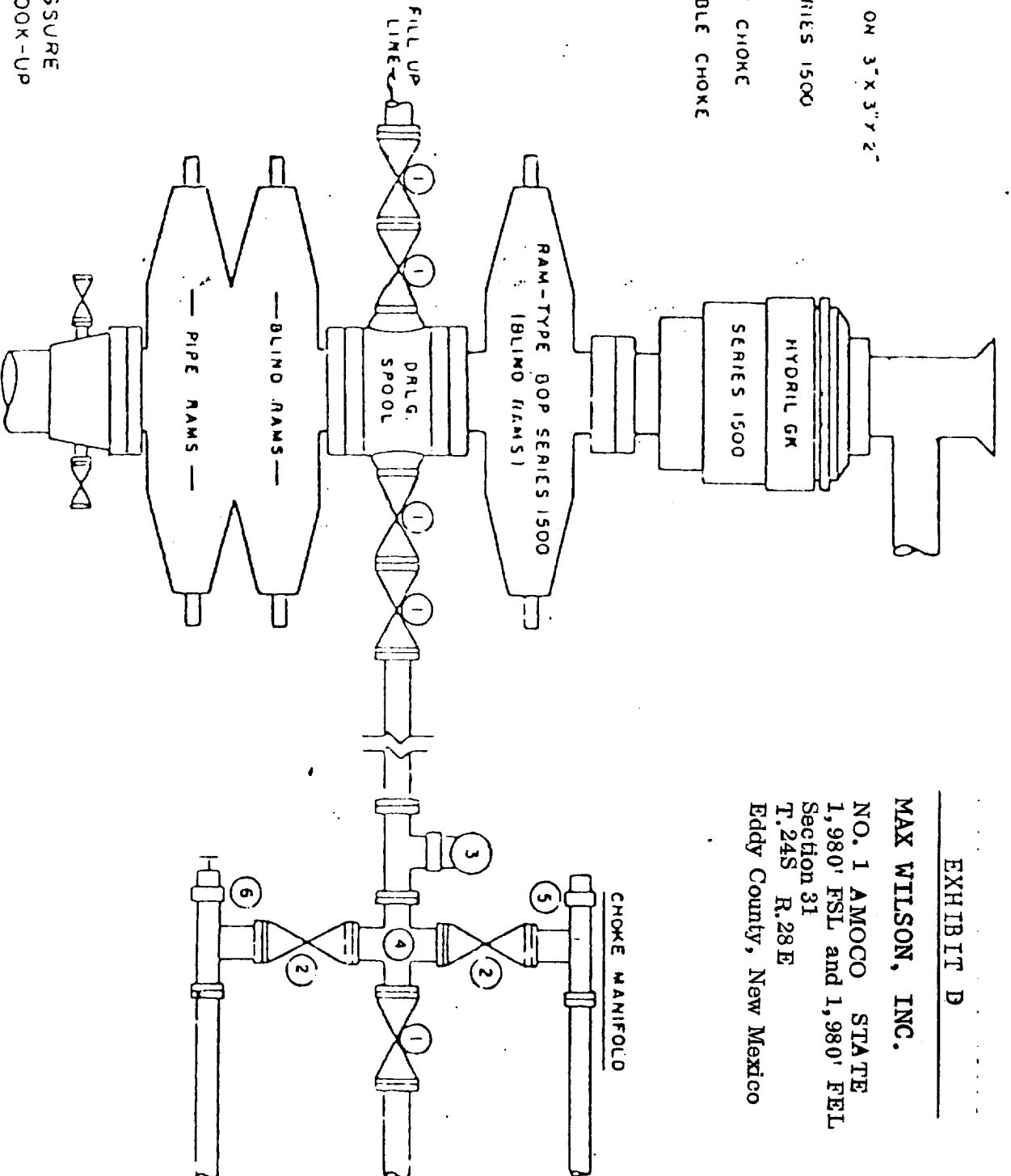

5000 PSI WORKING PRESSURE
BLOWOUT PREVENTER HOOK-UP
(SERIES 1500 FLANGES OR BETTER)