

STATE OF NEW MEXICO
ENERGY AND MINERALS DEPARTMENT

OIL CONSERVATION DIVISION
P. O. BOX 2088
SANTA FE, NEW MEXICO 87501

Form C-101
Revised 10-1-78

1. NO. OF COPIES RECEIVED	
DISTRIBUTION	
SANTA FE	
FILE	
U.S.G.S.	
LAND OFFICE	
OPERATOR	

RECEIVED BY
JUL -7- 1987
O. C. D.
ARTESIA OFFICE

5A. Indicate Type of Lease
STATE ☒ PER ☐
5. State Oil & Gas Lease No.
K-3271

APPLICATION FOR PERMIT TO DRILL, DEEPEN, OR PLUG BACK

1a. Type of Work b. Type of Well DRILL <input checked="" type="checkbox"/> DEEPEN <input type="checkbox"/> PLUG BACK <input type="checkbox"/> OIL WELL <input checked="" type="checkbox"/> GAS WELL <input type="checkbox"/> OTHER <input type="checkbox"/> SINGLE ZONE <input checked="" type="checkbox"/> MULTIPLE ZONE <input type="checkbox"/>		7. Unit Agreement Name
2. Name of Operator Phillips Petroleum Company		8. Farm or Lease Name James-A
3. Address of Operator Room 401, 4001 Penbrook St. Odessa, Texas 79762		9. Well No. 4
4. Location of Well UNIT LETTER <u>G</u> LOCATED <u>1980</u> FEET FROM THE <u>North</u> LINE <u>1980</u> FEET FROM THE <u>East</u> LINE OF SEC. <u>2</u> TWP. <u>22S</u> RGE. <u>30E</u> NMPM		10. Field and Pool, or Wildcat Cabin Lake Delaware
		12. County Eddy
19. Proposed Depth 7500'		19A. Formation Delaware
20. Rotary or C.T. Rotary		
21. Elevations (Show whether DF, KT, etc.) 3182.8' (Unprepared)	21A. Kind & Status Plug. Bond Blanket	21B. Drilling Contractor Will advise later
22. Approx. Date Work will start Upon Approval		

23.

PROPOSED CASING AND CEMENT PROGRAM

SIZE OF HOLE	SIZE OF CASING	WEIGHT PER FOOT	SETTING DEPTH	SACKS OF CEMENT	EST. TOP
17-1/2"	13-3/8"	54.5# K-55	400'	650 sk "C"	Surface
12-1/4"	8-5/8"	24# K-55	3500'	1200 sk "C"	Surface
7-7/8"	5-1/2"	15.5# K-55	7500'	900 sk "C"	3300'

Use Mud Additives as required for control.

BOP Equipment: Series 900, 3000# WP (See attached schematic-Figure 7-9 or 7-10)

APPROVAL VALID FOR 180 DAYS
EXPIRES 1-8-88
UNLESS DRILLING UNDERWAY

cc: Mississippi Chemical - P.O. Box 101, Carlsbad, NM 88220
International Minerals & Chemical Corp. P.O. Box 71, Carlsbad, NM 88220

IN ABOVE SPACE DESCRIBE PROPOSED PROGRAM: IF PROPOSAL IS TO DEEPEN OR PLUG BACK, GIVE DATA ON PRESENT PRODUCTIVE ZONE AND PROPOSED NEW PRODUCTIVE ZONE. GIVE BLOWOUT PREVENTER PROGRAM, IF ANY.

I hereby certify that the information above is true and complete to the best of my knowledge and belief.

Signed Ralph J. Roper R. J. Roper Title Eng. Supervisor, Reservoir Date 7/7/87

(This space for State Use)

APPROVED BY Mike Williams TITLE Oil & Gas Inspector DATE JUL 8 1987
Original Signed By
CONDITIONS OF APPROVAL, IF ANY

N. MEXICO OIL CONSERVATION COMMISS
WELL LOCATION AND ACREAGE DEDICATION PLAT

Form C-102
Supersedes C-128
Effective 1-1-65

All distances must be from the outer boundaries of the Section.

Operator PHILLIPS PETROLEUM COMPANY		Lease JAMES "A"		Well No. 4	
Unit Letter G	Section 2	Township 22 SOUTH	Range 30 EAST	County EDDY	
Actual Footage Location of Well: 1980 feet from the NORTH line and 1980 feet from the EAST line					
Ground Level Elev. 3182.8	Producing Formation Delaware	Pool Cabin Lake Delaware		Dedicated Acreage: 40 Acres	

1. Outline the acreage dedicated to the subject well by colored pencil or hachure marks on the plat below.
2. If more than one lease is dedicated to the well, outline each and identify the ownership thereof (both as to working interest and royalty).
3. If more than one lease of different ownership is dedicated to the well, have the interests of all owners been consolidated by communitization, unitization, force-pooling, etc?

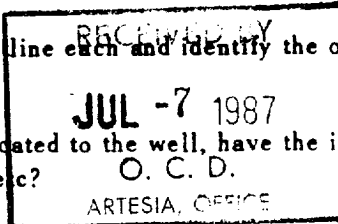

☐ Yes ☐ No If answer is "yes," type of consolidation _____

If answer is "no," list the owners and tract descriptions which have actually been consolidated. (Use reverse side of this form if necessary.) _____

No allowable will be assigned to the well until all interests have been consolidated (by communitization, unitization, forced-pooling, or otherwise) or until a non-standard unit, eliminating such interests, has been approved by the Commission.

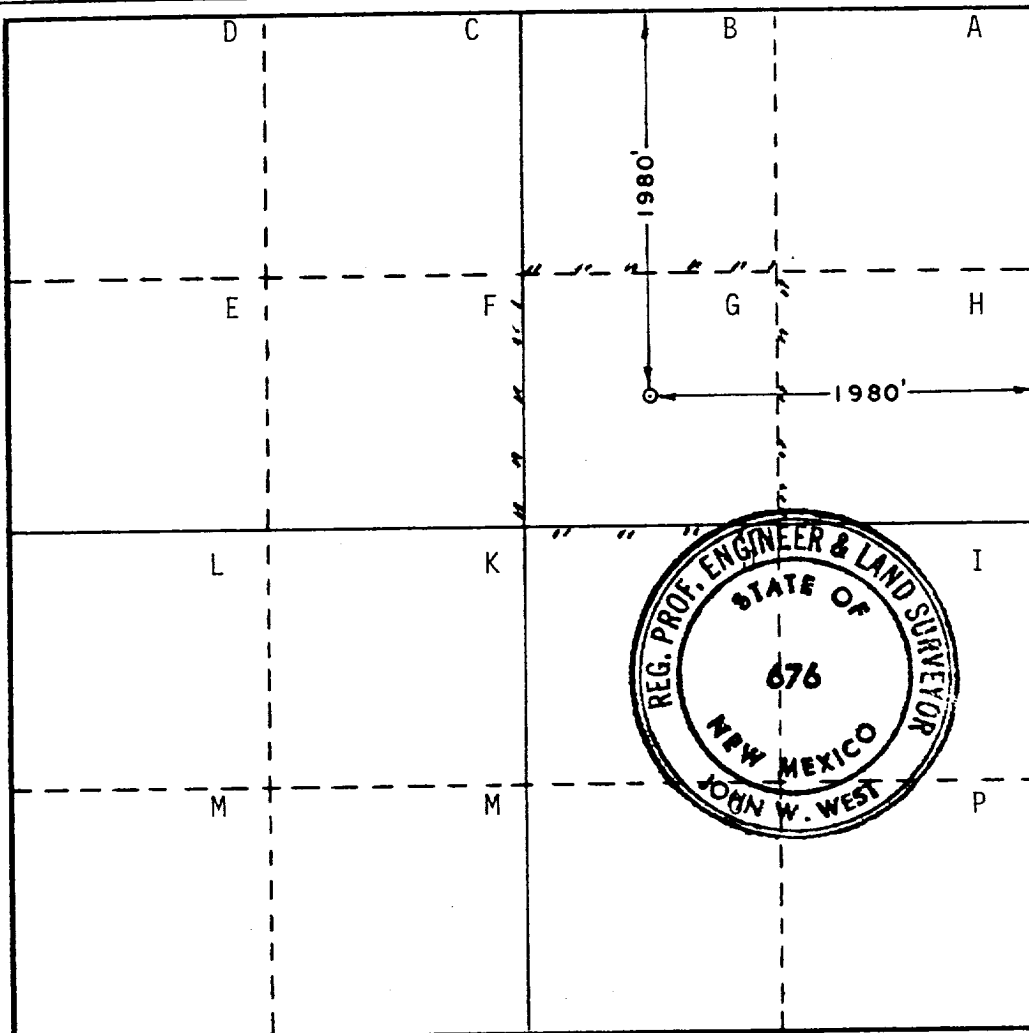

CERTIFICATION

I hereby certify that the information contained herein is true and complete to the best of my knowledge and belief.

Ralph J. Roper

Name
R. J. Roper

Position
Eng. Supervisor, Reservoir

Company
Phillips Petroleum Co.

Date
7/7/87

I hereby certify that the well location shown on this plat was plotted from field notes of actual surveys made by me or under my supervision, and that the same is true and correct to the best of my knowledge and belief.

Date Surveyed
MAY 20, 1987

Registered Professional Engineer and/or Land Surveyor

John W. West

Certificate No. **JOHN W. WEST, 676**
RONALD J. EIDSON, 3239

90560

FIELD PRACTICES AND STANDARDS

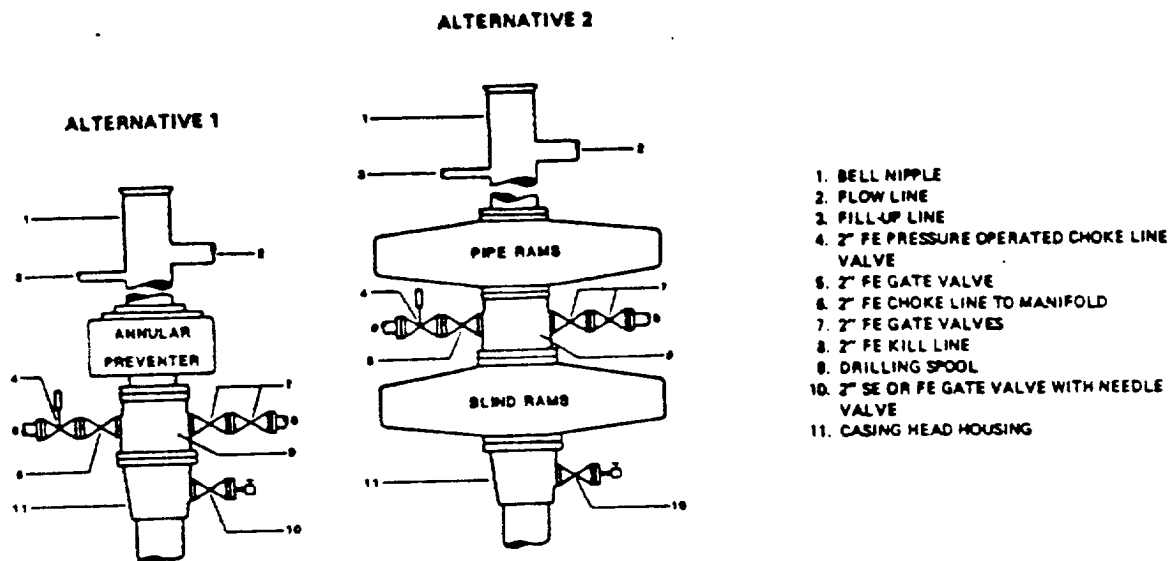

NOTE: THE DRILLING SPOOL MAY BE LOCATED BELOW BOTH SETS OF RAMS IF A DOUBLE PREVENTER IS USED AND IT DOES NOT HAVE SUITABLE OUTLETS BETWEEN RAMS

Figure 7-9. Standard Hydraulic Blowout Preventer Assembly (2 M or 3 M Working Pressure) Alternative 1

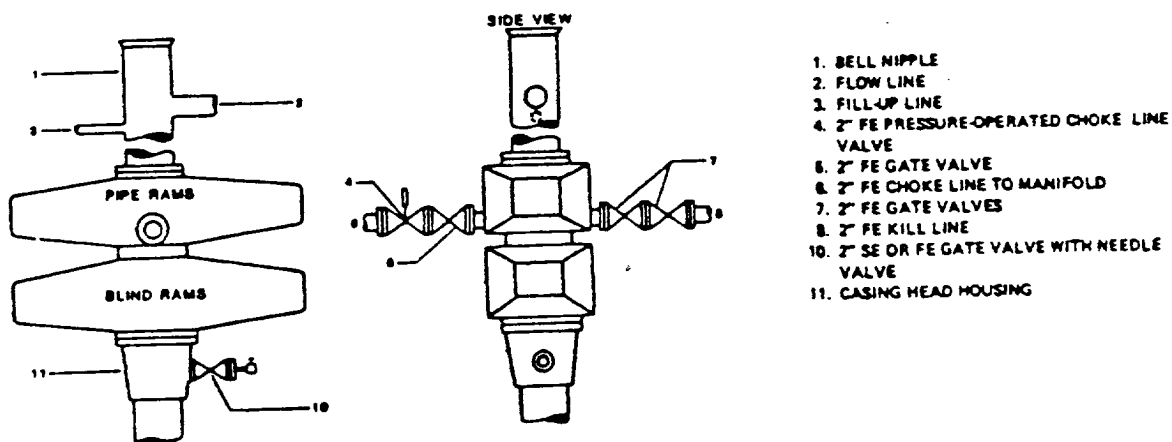

Figure 7-10. Standard Hydraulic Blowout Preventer Assembly (2 M or 3 M Working Pressure) Alternative 3 (without Drilling Spool)