

STATE OF NEW MEXICO
ENERGY AND MINERALS DEPARTMENT

OIL CONSERVATION DIVISION

P. O. BOX 2088
SANTA FE, NEW MEXICO 87501

30-015-25838
Form C-101
Revised 10-1-78

NO. OF COPIES RECEIVED	
DISTRIBUTION	
SANTA FE	
FILE	
U.S.G.S.	
LAND OFFICE	
OPERATOR	

RECEIVED

OCT 29 '87

5A. Indicate Type of Lease	STATE <input checked="" type="checkbox"/> FEE <input type="checkbox"/>
5. State Oil & Gas Lease No.	

APPLICATION FOR PERMIT TO DRILL, DEEPEN, OR PLUG BACK

1a. Type of Work b. Type of Well OIL WELL <input checked="" type="checkbox"/> GAS WELL <input type="checkbox"/> OTHER <input type="checkbox"/> DRILL <input checked="" type="checkbox"/> DEEPEN <input type="checkbox"/> PLUG BACK <input type="checkbox"/> SINGLE ZONE <input type="checkbox"/> MULTIPLE ZONE <input type="checkbox"/>		7. Unit Agreement Name
2. Name of Operator DINERO OPERATING COMPANY		8. Farm or Lease Name Dinero State
3. Address of Operator P.O. Drawer 10505, Midland, Texas 79702		9. Well No. 3
4. Location of Well UNIT LETTER 0 LOCATED 1650 FEET FROM THE East LINE AND 660 FEET FROM THE South LINE OF SEC. 16 TWP. 22S RGE. 28E NMPM		10. Field and Pool, or Wildcat Wildcat DELAWARE
12. County Eddy		
19. Proposed Depth 4500'		19A. Formation Delaware
20. Rotary or C.T. Rotary		
21. Elevations (Show whether DF, RT, etc.) 3073.8	21A. Kind & Status Plug. Bond	21B. Drilling Contractor Tinsley and Son
22. Approx. Date Work will start November 15, 1987		

23.

PROPOSED CASING AND CEMENT PROGRAM

SIZE OF HOLE	SIZE OF CASING	WEIGHT PER FOOT	SETTING DEPTH	SACKS OF CEMENT	EST. TOP
12 1/4	8 5/8	24#	400	400 sxs	Circ.
7 7/8	4 1/2	10.5#	4500	1100 sxs	Circ.

Post 10#
DELAWARE
1-2-87

APPROVED FOR 180 DAYS
5-17-88
UNLESS DRILLING UNDERWAY

IN ABOVE SPACE DESCRIBE PROPOSED PROGRAM: IF PROPOSAL IS TO DEEPEN OR PLUG BACK, GIVE DATA ON PRESENT PRODUCTIVE ZONE AND PROPOSED NEW PRODUCTIVE ZONE. GIVE BLOWOUT PREVENTER PROGRAM, IF ANY.

I hereby certify that the information above is true and complete to the best of my knowledge and belief.

Signed Dana Ralston Title Production Clerk Date 10/28/87

(This space for State Use)

Original Signed By

Mike Williams

Oil & Gas Inspector

APPROVED BY _____ TITLE _____ DATE NOV 17 1987

CONDITIONS OF APPROVAL, IF ANY:

NEW MEXICO OIL CONSERVATION COMM.
WELL LOCATION AND ACREAGE DEDICATION PLAT

Form C-102
Supersedes C-128
Effective 1-1-65

All distances must be from the outer boundaries of the Section.

Operator Dinero Operating Company		Lease Dinero State		Well No. 3
Unit Letter 0	Section 16	Township 22 South	Range 28 East	County Eddy
Actual Footage Location of Well: 660 feet from the south line and 1650 feet from the east line				
Ground Level Elev. 3073.8	Producing Formation DELTA	Pool WILL CAT DELAWARE	Dedicated Acreage: 40 Acres	

1. Outline the acreage dedicated to the subject well by colored pencil or hachure marks on the plat below.
2. If more than one lease is dedicated to the well, outline each and identify the ownership thereof (both as to working interest and royalty).
3. If more than one lease of different ownership is dedicated to the well, have the interests of all owners been consolidated by communitization, unitization, force-pooling, etc?

☐ Yes ☐ No If answer is "yes," type of consolidation _____

If answer is "no," list the owners and tract descriptions which have actually been consolidated. (Use reverse side of this form if necessary.) _____

No allowable will be assigned to the well until all interests have been consolidated (by communitization, unitization, forced-pooling, or otherwise) or until a non-standard unit, eliminating such interests, has been approved by the Commission.

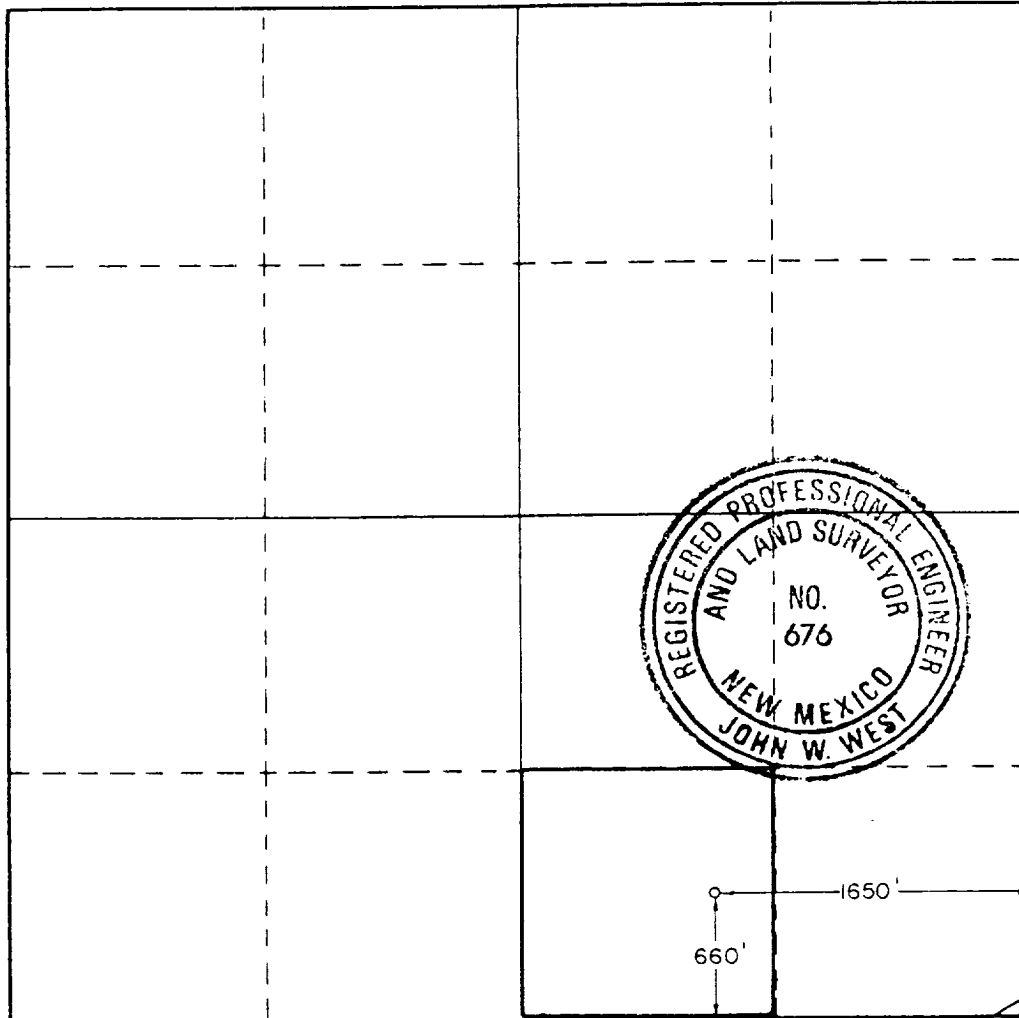

CERTIFICATION

I hereby certify that the information contained herein is true and complete to the best of my knowledge and belief.

Dana Ralston

Name
Dana Ralston

Position
Production Clerk

Company
Dinero Operating Company

Date
October 28, 1987

I hereby certify that the well location shown on this plat was plotted from field notes of actual surveys made by me or under my supervision, and that the same is true and correct to the best of my knowledge and belief.

Date Surveyed
October 20, 1987

Registered Professional Engineer
and/or Land Surveyor

John W. West

Certificate No. JOHN W. WEST, 676
RONALD J. EIDSON, 3239

Blow-out-preventers hydraulic and choke manifold all H-100 Series.

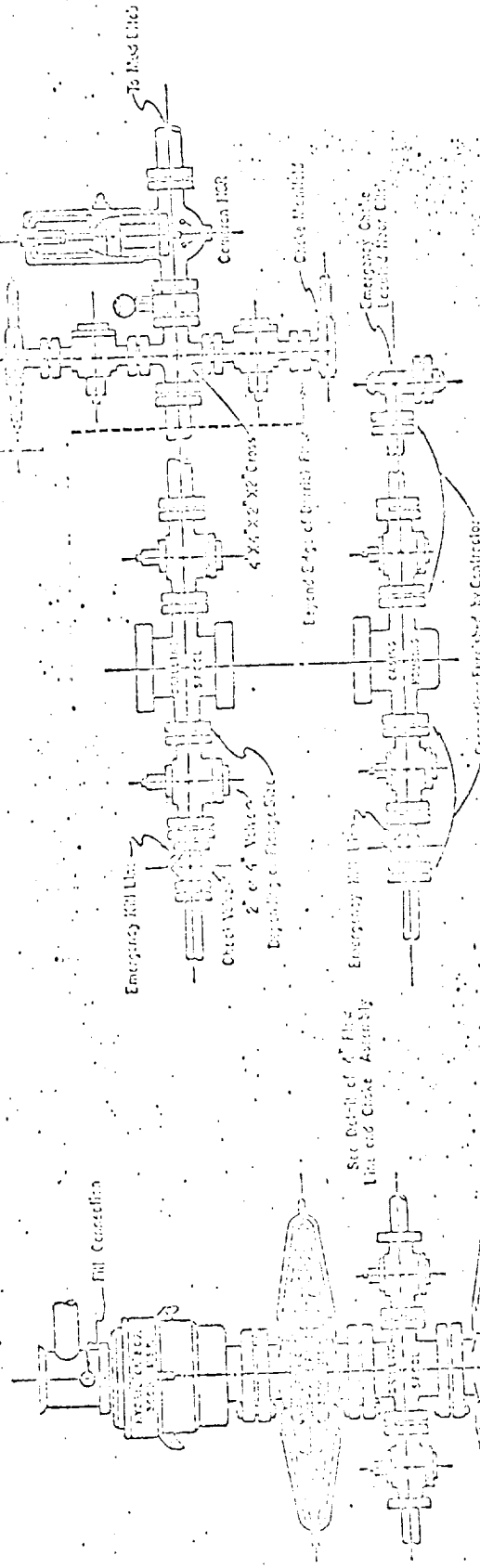

5,000 PSI WORKING PRESSURE
KILL, CHOKES, AND FILL CONNECTIONS
API Series 500 Flanges or Better

DETAIL OF 4" FLOW LINE CHOKES ASSEMBLY

Minimum assembly for 5,000 PSI working pressure will consist of three preventers. The bottom and middle preventers may be General

5,000 PSI WORKING PRESSURE
BLOWOUT PREVENTER HOOK-UP
Series 500 Flanges or Better