

Submit to Appropriate  
District Office  
State Lease - 6 copies  
Fee Lease - 5 copies

State of New Mexico  
Energy, Minerals and Natural Resources Department

Form C-101  
Revised 1-1-89

OIL CONSERVATION DIVISION

P.O. Box 2088  
Santa Fe, New Mexico 87504-2088

DISTRICT I  
P.O. Box 1980, Hobbs, NM 88240

DISTRICT II  
P.O. Drawer DD, Artesia, NM 88210

DISTRICT III  
1000 Rio Brazos Rd., Aztec, NM 87410

JAN 16 '90

API NO. (assigned by OCD on New Wells)

30-015-26274

5. Indicate Type of Lease

STATE ☐

FEE ☒

6. State Oil & Gas Lease No.

APPLICATION FOR PERMIT TO DRILL, DEEPEN, OR PLUG BACK

1a. Type of Work:

DRILL ☒

RE-ENTER ☐

DEEPEN ☐

ARTESIAN ☐

PLUG BACK ☐

b. Type of Well:

OIL  
WELL ☒

GAS  
WELL ☐

OTHER ☐

SINGLE  
ZONE ☒

MULTIPLE  
ZONE ☐

2. Name of Operator

BTA OIL PRODUCERS

7. Lease Name or Unit Agreement Name

Pardue -B-, 8808 JV-P

8. Well No.

1

3. Address of Operator

104 South Pecos, Midland, Texas 79701

9. Pool name or Wildcat

Loving East (Delaware)

4. Well Location

Unit Letter -K- : 1711 Feet From The South Line and 1957 Feet From The West Line

Section 11 Township 23-S Range 28-E NMPM Eddy County

10. Proposed Depth

6,300'

11. Formation

Delaware

12. Rotary or C.T.

Rotary

13. Elevations (Show whether DF, RT, GR, etc.)

2,974' GR 2,987' RT

14. Kind & Status Plug. Bond

Blanket

15. Drilling Contractor

Hondo Drlg. Co.

16. Approx. Date Work will start

1-22-90

17. PROPOSED CASING AND CEMENT PROGRAM

SIZE OF HOLE	SIZE OF CASING	WEIGHT PER FOOT	SETTING DEPTH	SACKS OF CEMENT	EST. TOP
12 1/4"	8 5/8"	24#	500'	500 sx	Surface
7 7/8"	5 1/2"	15.5 & 17#	6300'	2000 sx	Surface

BOP - 3000 psi - Attached Schematic

There are no producing wells in this quarter section.

Post FD-1  
1-19-90  
New Loc & APF

APPROVAL VALID FOR 180 DAYS  
EXPIRATION DATE 7/18/90  
BY [Signature] DISTRICT MANAGER

IN ABOVE SPACE DESCRIBE PROPOSED PROGRAM: IF PROPOSAL IS TO DEEPEN OR PLUG BACK, GIVE DATA ON PRESENT PRODUCTIVE ZONE AND PROPOSED NEW PRODUCTIVE ZONE. GIVE BLOWOUT PREVENTER PROGRAM, IF ANY.

I hereby certify that the information above is true and complete to the best of my knowledge and belief.

SIGNATURE Dorothy Houghton TITLE Reg. Administrator DATE 1/15/90

TYPE OR PRINT NAME DOROTHY HOUGHTON TELEPHONE NO. 915/682-375

(This space for State Use)

ORIGINAL SIGNED BY

MIKE WILLIAMS

APPROVED BY SUPERVISOR, DISTRICT II TITLE  DATE JAN 18 1990

CONDITIONS OF APPROVAL, IF ANY:

MEXICO OIL CONSERVATION COMMI. N  
WELL LOCATION AND ACREAGE DEDICATION PLAT

Form C-102  
Supersedes C-128  
Effective 1-1-65

All distances must be from the outer boundaries of the Section.

Operator <b>BTA OIL PRODUCERS</b>			Lease <b>8808 JV-P PARDUE "B"</b>		Well No. <b>1</b>
Unit Letter <b>"K"</b>	Section <b>11</b>	Township <b>-23-S</b>	Range <b>-28-E</b>	County <b>EDDY</b>	
Actual Footage Location of Well: <b>1711</b> feet from the <b>SOUTH</b> line and <b>1957</b> feet from the <b>WEST</b> line					
Ground Level Elev. <b>2974</b>	Producing Formation <b>LOVING EAST</b>		Pool <b>DELAWARE</b>	Dedicated Acreage: <b>40</b> Acres	

1. Outline the acreage dedicated to the subject well by colored pencil or hachure marks on the plat below.
2. If more than one lease is dedicated to the well, outline each and identify the ownership thereof (both as to working interest and royalty).
3. If more than one lease of different ownership is dedicated to the well, have the interests of all owners been consolidated by communitization, unitization, force-pooling, etc?

☐ Yes ☐ No If answer is "yes," type of consolidation \_\_\_\_\_

If answer is "no," list the owners and tract descriptions which have actually been consolidated. (Use reverse side of this form if necessary.) \_\_\_\_\_

No allowable will be assigned to the well until all interests have been consolidated (by communitization, unitization, forced-pooling, or otherwise) or until a non-standard unit, eliminating such interests, has been approved by the Commission.

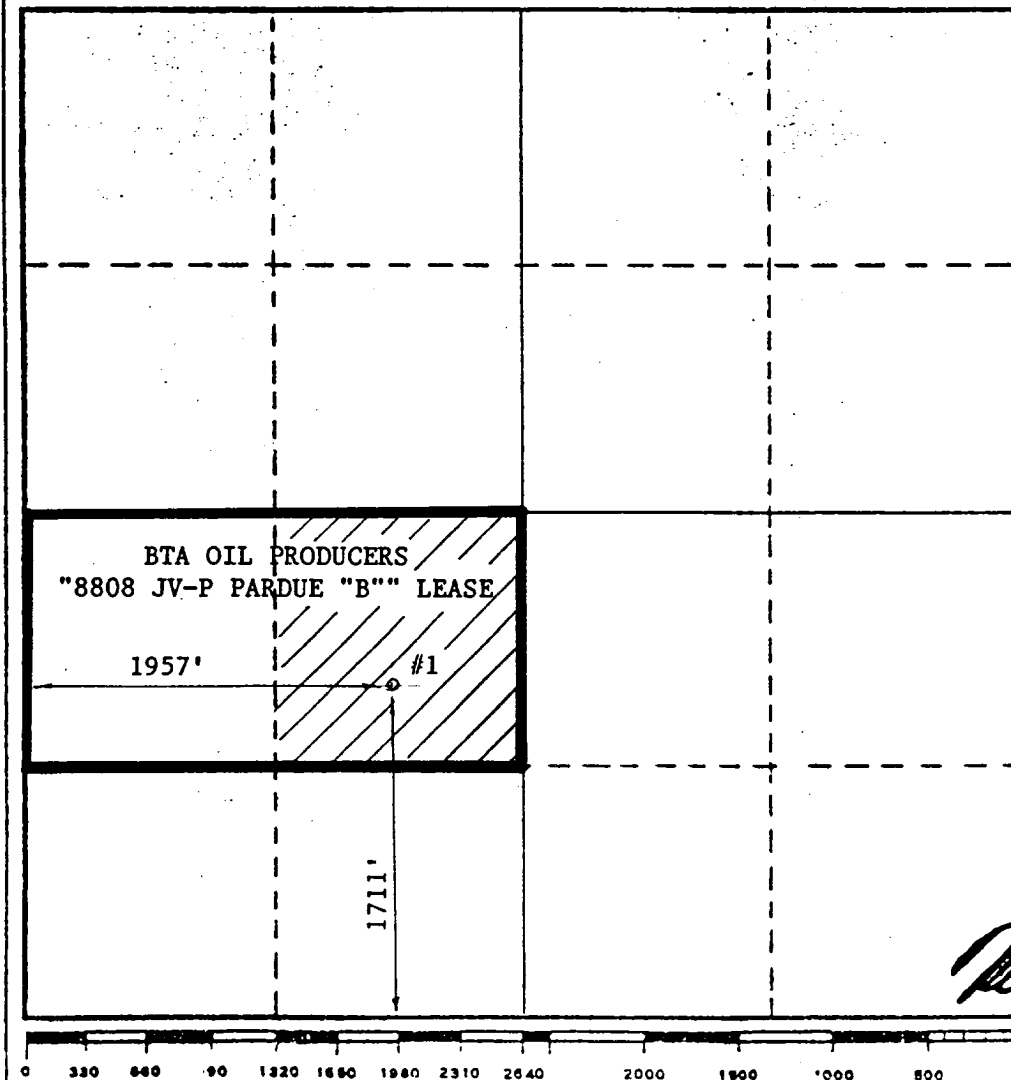

**CERTIFICATION**

I hereby certify that the information contained herein is true and complete to the best of my knowledge and belief.

*Dorothy Houghton*  
Name

DOROTHY HOUGHTON

Position

Reg. Administrator

Company

BTA OIL PRODUCERS

Date

1/15/90

I hereby certify that the well location shown on this plat was plotted from field notes of actual surveys made by me or under my supervision, and that the same is true and correct to the best of my knowledge and belief.

Date Surveyed

JANUARY 12, 1990

Registered Professional Engineer and/or Land Surveyor

*Max A. Schumann, Jr.*  
MAX A. SCHUMANN, JR.

Certificate No.

1510

B T A O I L P R O D U C E R S

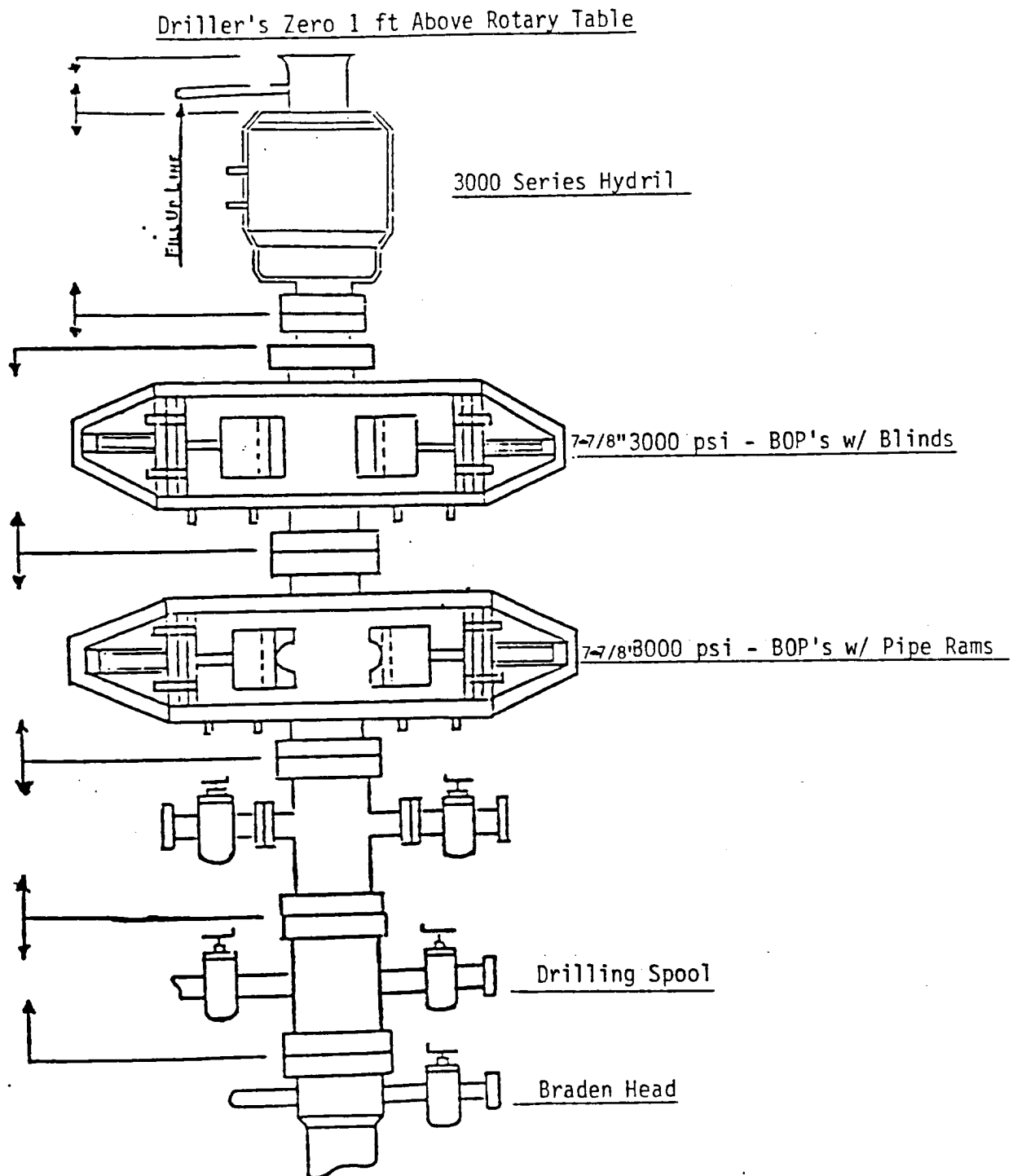

#1, Pardue -B-, 8808 JV-P  
-K-, Sec. 11, T-23-S, R-28-E  
Eddy County, New Mexico