

Submit to Appropriate
District Office
State Lease - 6 copies
Fee Lease - 5 copies

State of New Mexico
Energy, Minerals and Natural Resources Department

Form C-101
Revised 1-1-89

OIL CONSERVATION DIVISION

P.O. Box 2088
Santa Fe, New Mexico 87504-2088

DISTRICT I
P.O. Box 1980, Hobbs, NM 88240

DISTRICT II
P.O. Drawer DD, Artesia, NM 88210

DISTRICT III
1000 Rio Brazos Rd., Aztec, NM 87410

RECEIVED
SEP 23 1991

O. C. D.

API NO. (assigned by OCD on New Wells)

30-015-26841

5. Indicate Type of Lease

STATE ☒

FEE ☐

6. State Oil & Gas Lease No.

VB-54

APPLICATION FOR PERMIT TO DRILL, DEEPEN, OR PLUG BACK

1a. Type of Work:

DRILL ☒

RE-ENTER ☐

DEEPEN ☐

PLUG BACK ☐

b. Type of Well:

OIL
WELL ☒

GAS
WELL ☐

OTHER ☐

SINGLE
ZONE ☐

MULTIPLE
ZONE ☐

7. Lease Name or Unit Agreement Name

Diamond 31 State

2. Name of Operator

Nearburg Producing Company ✓

8. Well No.

1

3. Address of Operator

P. O. Box 823085, Dallas, Texas 75382-3085

9. Pool name or Wildcat

Undesignated Bone Spring

4. Well Location

Unit Letter

I

: 1,980

Feet From The

South

Line and

660

Feet From The

East

Line

Section

31

Township

24S

Range

29E

NMPM

Eddy

County

10. Proposed Depth

9,300'

11. Formation

Bone Spring

12. Rotary or C.T.

Rotary

13. Elevations (Show whether DF, RT, GR, etc.)

2,894.3' GR

14. Kind & Status Plug. Bond

Blanket

15. Drilling Contractor

Undetermined

16. Approx. Date Work will start

October 1, 1991

17. PROPOSED CASING AND CEMENT PROGRAM

SIZE OF HOLE	SIZE OF CASING	WEIGHT PER FOOT	SETTING DEPTH	SACKS OF CEMENT	EST. TOP
17-1/2"	13-3/8"	48#	600'	700	Circulate
12-1/4"	8-5/8"	24#	2,800'	1,100	Circulate
7-7/8"	5-1/2"	17#	9,300'	600	6,000'

Propose to drill the well to sufficient depth to evaluate the Bone Spring formation. After reaching TD, logs will be run and casing set if the evaluation is positive. Perforate, test, and stimulate as necessary to establish production.

BOP Program is attached.

APPROVAL VALID FOR 180 DAYS
PERMIT EXPIRES 3/25/92
UNLESS DRILLING UNDERWAY

IN ABOVE SPACE DESCRIBE PROPOSED PROGRAM: IF PROPOSAL IS TO DEEPEN OR PLUG BACK, GIVE DATA ON PRESENT PRODUCTIVE ZONE AND PROPOSED NEW PRODUCTIVE ZONE. GIVE BLOWOUT PREVENTER PROGRAM, IF ANY.

I hereby certify that the information above is true and complete to the best of my knowledge and belief.

SIGNATURE Mildred Simpkins TITLE Production Analyst DATE 9/18/91

TYPE OR PRINT NAME Mildred Simpkins TELEPHONE NO. 214/739-1778

(This space for State Use)

ORIGINAL SIGNED BY

MIKE WILLIAMS

APPROVED BY SUPERVISOR, DISTRICT II TITLE _____ DATE SEP 25 1991

CONDITIONS OF APPROVAL, IF ANY:

Submit to Appropriate
District Office
State Lease - 4 copies
Fee Lease - 3 copies

State of New Mexico
Energy, Minerals and Natural Resources Department

OIL CONSERVATION DIVISION

P.O. Box 2088
Santa Fe, New Mexico 87504-2088

RECEIVED

SEP 23 1991
Form C-102
Revised 1-1-89

O. C. D.
ARTESIA OFFICE

DISTRICT I
P.O. Box 1980, Hobbs, NM 88240

DISTRICT II
P.O. Drawer DD, Artesia, NM 88210

DISTRICT III
1000 Rio Brazos Rd., Aztec, NM 87410

WELL LOCATION AND ACREAGE DEDICATION PLAT

All Distances must be from the outer boundaries of the section

Operator NEARBURG PRODUCING CO.		Lease DIAMOND 31 STATE		Well No. 1
Unit Letter I	Section 31	Township 24 SOUTH	Range 29 EAST NMPM	County EDDY
Actual Footage Location of Well: 660 feet from the EAST line and 1980 feet from the SOUTH line				
Ground level Elev. 2894.3	Producing Formation Bone Spring	Pool Undesignated Bone Springs	Dedicated Acreage: 40.00 Acres	

1. Outline the acreage dedicated to the subject well by colored pencil or hatchure marks on the plat below.
2. If more than one lease is dedicated to the well, outline each and identify the ownership thereof (both as to working interest and royalty).
3. If more than one lease of different ownership is dedicated to the well, have the interest of all owners been consolidated by communitization, unitization, force-pooling, etc.?
☐ Yes ☐ No If answer is "yes" type of consolidation N/A
If answer is "no" list the owners and tract descriptions which have actually been consolidated. (Use reverse side of this form if necessary.)
No allowable will be assigned to the well until all interests have been consolidated (by communitization, unitization, forced-pooling, or otherwise) or until a non-standard unit, eliminating such interest, has been approved by the Division.

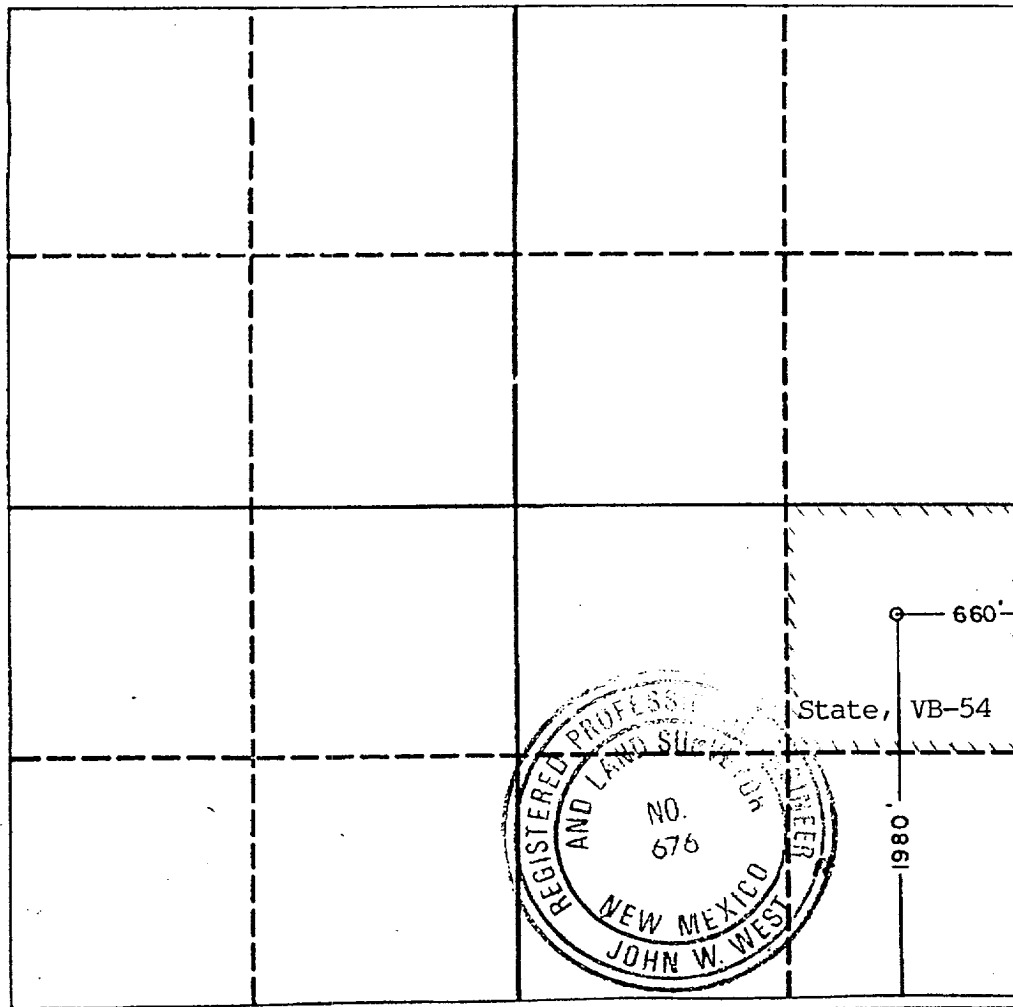

OPERATOR CERTIFICATION

I hereby certify that the information contained herein is true and complete to the best of my knowledge and belief.

Signature Kathie Craft
Printed Name **Kathie Craft**
Position **Land Administrator**
Company **Nearburg Producing Co.**
Date **September 18, 1991**

SURVEYOR CERTIFICATION

I hereby certify that the well location shown on this plat was plotted from field notes of actual surveys made by me or under my supervision, and that the same is true and correct to the best of my knowledge and belief.

Date Surveyed **9-12-91**

Signature & Seal of Professional Surveyor

John W. West
Certificate No. **JOHN W. WEST, 676**
GARY L. JONES R.L.S. 7977

BLOWOUT PREVENTER SKETCH
Nearburg Producing Company
DIAMOND 31 STATE WELL NO. 1

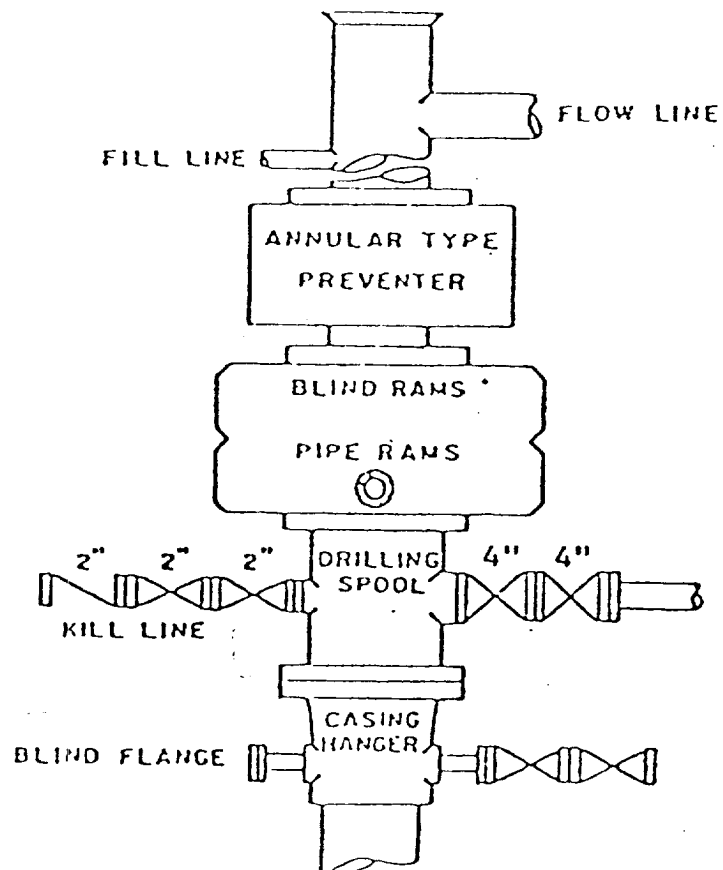

900 SERIES