

UNITED STATES
DEPARTMENT OF THE INTERIOR
BUREAU OF LAND MANAGEMENT

RECEIVED

O. C. D.

SUNDRY NOTICES AND REPORTS ON WELLS

Do not use this form for proposals to drill or to deepen or reentry to a different reservoir.
Use "APPLICATION FOR PERMIT—" for such proposals

FORM APPROVED
Budget Bureau No. 1004-0135
Expires: March 31, 1993

5. Lease Designation and Serial No.
NM-15433

6. If Indian, Allottee or Tribe Name

7. If Unit or CA, Agreement Designation

8. Well Name and No.
NEL FEDERAL NO. 5

9. API Well No.
30-015-26933

10. Field and Pool, or Exploratory Area
Und. East Loving Delaware

11. County or Parish, State

Eddy County, New Mexico

SUBMIT IN TRIPLICATE

CONFIDENTIAL

1. Type of Well

☒ Oil Well ☐ Gas Well ☐ Other

2. Name of Operator

Pogo Producing Company

3. Address and Telephone No.

P. O. Box 10340 Midland, Texas 79702-7340 915/682-6822

4. Location of Well (Footage, Sec., T., R., M., or Survey Description)

2310' FSL and 330' FEL
Section 9, T-23-S, R-28-E

12. CHECK APPROPRIATE BOX(s) TO INDICATE NATURE OF NOTICE, REPORT, OR OTHER DATA

TYPE OF SUBMISSION

☐ Notice of Intent
☒ Subsequent Report
☐ Final Abandonment Notice

TYPE OF ACTION

☐ Abandonment
☐ Recompletion
☐ Plugging Back
☐ Casing Repair
☐ Altering Casing
☒ Other Production casing
☐ Change of Plans
☐ New Construction
☐ Non-Routine Fracturing
☐ Water Shut-Off
☐ Conversion to Injection
☐ Dispose Water

(Note: Report results of multiple completion on Well Completion or Recompletion Report and Log form.)

13. Describe Proposed or Completed Operations (Clearly state all pertinent details, and give pertinent dates, including estimated date of starting any proposed work. If well is directionally drilled, give subsurface locations and measured and true vertical depths for all markers and zones pertinent to this work.)

Drill 7-7/8" hole to TD @ 6310', TD well @ 01:00 hrs CDT, March 2, 1992. Ran logs, ran 151 jts 15.50# J-55 LT&C casing, GS @ 6310', FC @ 6265', cement stage tool @ 3086', Halliburton cemented 1st stage w/910 sx premium cmt, plug down @ 03:00 hrs CST, March 4, 1992, lost partial returns, did not circ cement thru DV tool 6 hrs WOC, Howco cemented 2nd stage with 1550 sx Howco lite w/6# salt and 1/2# flocele - 12.2 ppg, tail cement with 100 sx premium cement, 14.8 ppg, closed DV tool, circ 350 sx. cement.

14. I hereby certify that the foregoing is true and correct.

Signed

[Signature]

Title

Division Operations Supervisor

Date

3/27/92

(This space for Federal or State office use)

Approved by

Title

Date

Conditions of approval, if any:

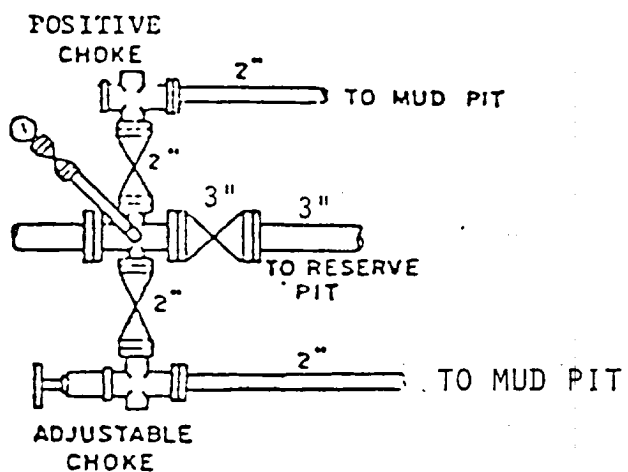
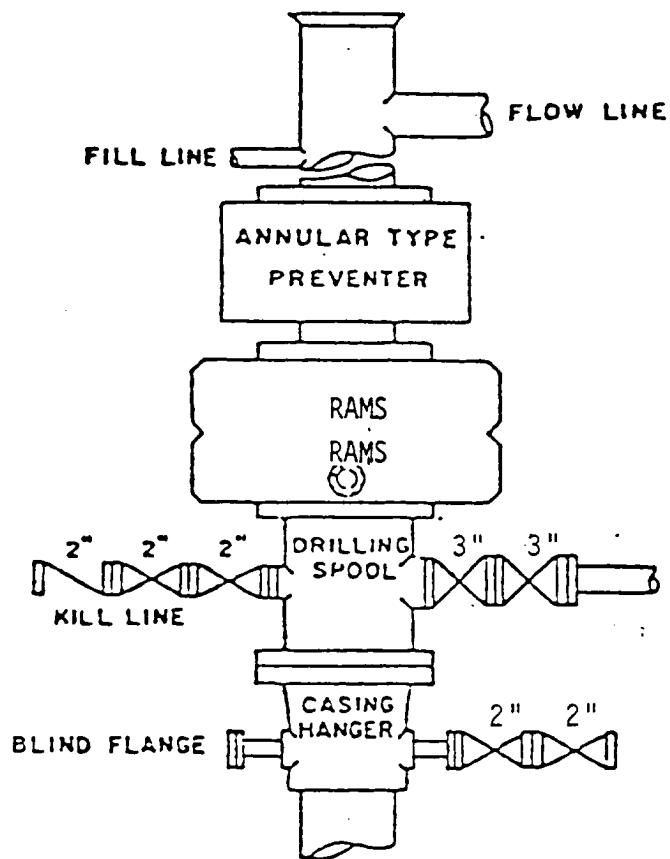

BOP STACK

3000 PSI WORKING PRESSURE

BOP ARRANGEMENT

SURFACE USE AND OPERATIONS PLAN

FOR

POGO PRODUCING COMPANY
NEL LEASE WELL NO. 5
2310' FSL & 330' FEL SEC. 9, T. 23 S., R. 28 E.
EDDY COUNTY, NEW MEXICO

LOCATED: Three miles north-northeast of Loving, New Mexico.

FEDERAL LEASE NUMBER: NM-15433.

LEASE ISSUED: June 1, 1972. Lease is in producing status.

ACRES IN LEASE: 360.

RECORD LESSEE: Pogo Producing Company.

SURFACE OWNERSHIP: Federal.

GRAZING PERMITTEE: Curtis K. Skeen
1508 Riverside Drive
Carlsbad, New Mexico 88220

POOL: Undesignated East Loving Delaware.

POOL RULES: Statewide. 40 acre spacing for oil.

EXHIBITS: A. Road map
B. Plat Showing Existing Wells and Existing Roads
C. Drilling Rig Layout
D. Topo Plat

1. EXISTING ROADS:

A. Exhibit "A" is a portion of a road map showing the location of the proposed well as staked. Point "A" on the plat is on US-285 at Mile Marker 23.4, approximately 10 miles southeast of Carlsbad, New Mexico, where State highway 31 goes east. To go to the proposed well site from this point, go east on State 31 2 miles to Mile Marker 2 where a caliche road goes north. Exit State 31 to the north through the cattle guard (also see Exhibits "B" and "D") and go 0.4 mile to arrive at Pogo's NEL Com No. 1 on the west side of the road at about 120 feet. Continue north about 300 feet and the proposed well site will be on the east side of the road at a distance of about 300 feet.

B. Exhibit "B" shows existing pertinent roads in the vicinity of the proposed well site. Existing roads are color coded.

2. PLANNED ACCESS ROAD:

A. Length and Width: The access route, north off State Highway 31, is shown on Exhibits "A", "B", and "D". The new road will be 12 feet wide and about 80 feet long, and labeled and color coded red on Exhibit "B". The centerline of the proposed new road is staked and flagged.

B. Surfacing Material: Caliche will be used if the on-site material is not suitable.

C. Maximum Grade: Less than one percent.

D. Turnouts: Not needed.

E. Drainage Design: The new road will be crowned with drainage to the side.

F. Culverts: None needed.

G. Cuts and Fills: Not required.

H. Gates and Cattle Guards: None needed. No fences involved.

3. LOCATION OF EXISTING WELLS:

A. Existing wells in the immediate area are shown on Exhibit "B".

4. LOCATION OF EXISTING AND/OR PROPOSED FACILITIES:

A. Production from this well will be delivered to the existing lease tank battery located at well No. 1. The flow line will be 3" SDR-7 polyethylene pipe laid on the ground alongside the road, and will extend from the well to the tank battery as shown on Exhibit "B". Anticipated flow line pressure is 60 psi.

B. The proposed electric line will extend from the well about 130 feet east to a point 50 feet west of the east line of Section 9 and then south about 700 feet to tie in to the existing electric line as indicated on Exhibit "B". Primary line voltage will be 12,000 volts.

5. LOCATION AND TYPE OF WATER SUPPLY:

A. It is not planned that a water well will be drilled. Water necessary for drilling operations will be purchased and trucked to the well site, or will be moved to the well site by temporary pipeline laid on the ground alongside existing and proposed roads.

6. SOURCE OF CONSTRUCTION MATERIALS:

A. Caliche needed for construction work will be taken from an existing pit on privately owned land in the NW $\frac{1}{4}$ SW $\frac{1}{4}$ of Section 10, T.23 S., R.28 E., Eddy County, New Mexico. Caliche will be trucked to the location over existing and proposed roads.

7. METHODS OF HANDLING WASTE MATERIAL:

A. Drill cuttings will be disposed of in the drilling pits.

B. Drilling fluids will be allowed to evaporate in the drilling pits until the pits are dry.

C. Water produced during tests will be disposed of in the drilling pits or will be stored in tanks for disposal in an approved disposal system.

D. Oil produced during tests will be stored in test tanks until sold.

E. All trash, junk, and other waste material will be contained in trash cages or bins to prevent scattering and will be removed and deposited in an approved sanitary land fill.

8. ANCILLARY FACILITIES:

A. None necessary.

9. WELL SITE LAYOUT:

A. Exhibit "C" shows the relative location and dimensions of the well pad, mud pits, reserve pit, and waste pit, and the location of major drilling rig components.

B. The drilling rig will be oriented to V-door south to minimize any impact on existing drainages, and a berm will be constructed to contain a possible pit spill as indicated on Exhibit "C".

10. PLANS FOR RESTORATION OF THE SURFACE:

A. After completion of drilling and/or completion operations, all equipment and other material not needed for operations will be removed from the well site. Pits will be filled and the location will be cleaned of all trash and junk to leave the well site in an as aesthetically pleasing condition as possible.

B. Any unguarded pits containing fluids will be fenced.

C. After abandonment, all equipment, trash, and junk will be removed and the well site will be cleaned. Any special rehabilitation requirements of the surface management agency will be complied with and accomplished as rapidly as possible.

11. OTHER INFORMATION:

A. Topography: The general area of the proposed well site is a gently undulating landscape. In the immediate area of the well site land slope is to the south and east.

B. Soil: Top soil in the immediate area of the well site is a gravelly loam.

C. Flora and Fauna: The vegetative cover is moderate and includes mesquite, javelina bush, yucca, weeds, and range grasses. Wildlife in the area is that typical of semi-arid desert land, and includes coyotes, rabbits, rodents, reptiles, dove and quail.

D. Ponds and Streams: The Pecos River at its nearest point is about 0.6 mile to the north. However, land slope at the well site is to the south and east toward the Pecos river at a distance of about 1.4 miles. There are no other lakes, ponds or streams in the area .

E. Residences and Other Structures: The nearest occupied dwelling is about 1/2 mile south-southeast of the proposed well site.

F. Archaeological, Historical, and Cultural Sites: None observed in the area. However, an archaeological reconnaissance is to be accomplished and a report furnished.

G. Land Use: Oil and gas drilling and production operations, grazing, and wildlife habitat.

H. Surface Ownership: Federal.

12. OPERATOR'S REPRESENTATIVE:

Richard L. Wright
Drilling and Production Superintendent
Pogo Producing Company
P. O. Box 10340
Midland, Texas 79702
Office Phone: 915-682-6822

13. CERTIFICATION:

I hereby certify that I, or persons under my direct supervision, have inspected the proposed drill site and access route; that I am familiar with the conditions which currently exist; that the statements made in this plan are, to the best of my knowledge, true and correct; and, that the work associated with the operations proposed herein will be performed by Pogo Producing Company and its contractors and sub-contractors in conformity with this plan and the terms and conditions under which it is approved. This statement is subject to the provisions of 18 U.S.C. 1001 for the filing of a false statement.

January 10, 1992
Date:

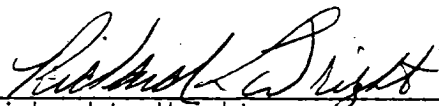

Richard L. Wright
Drilling and Production Supt.

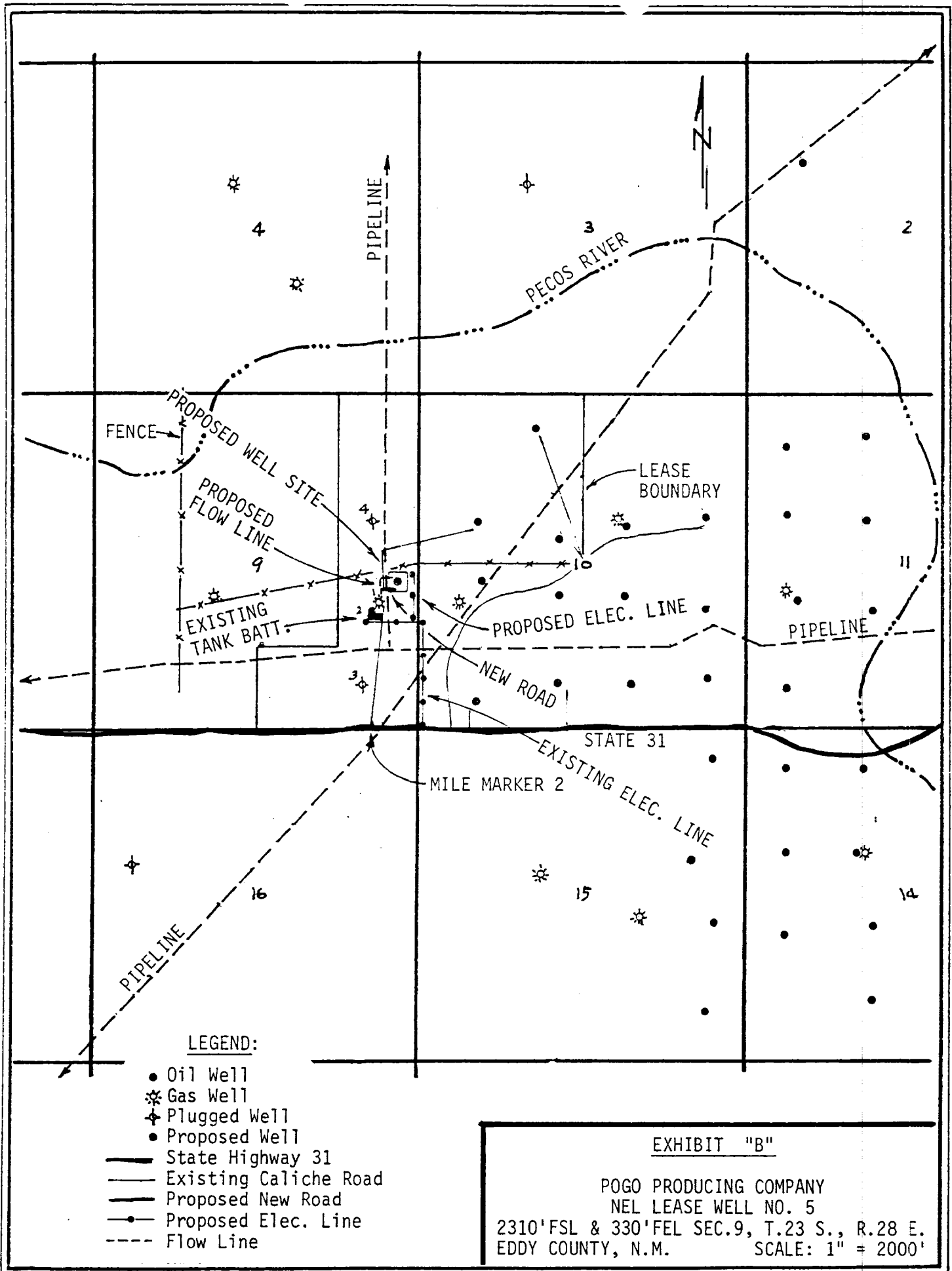

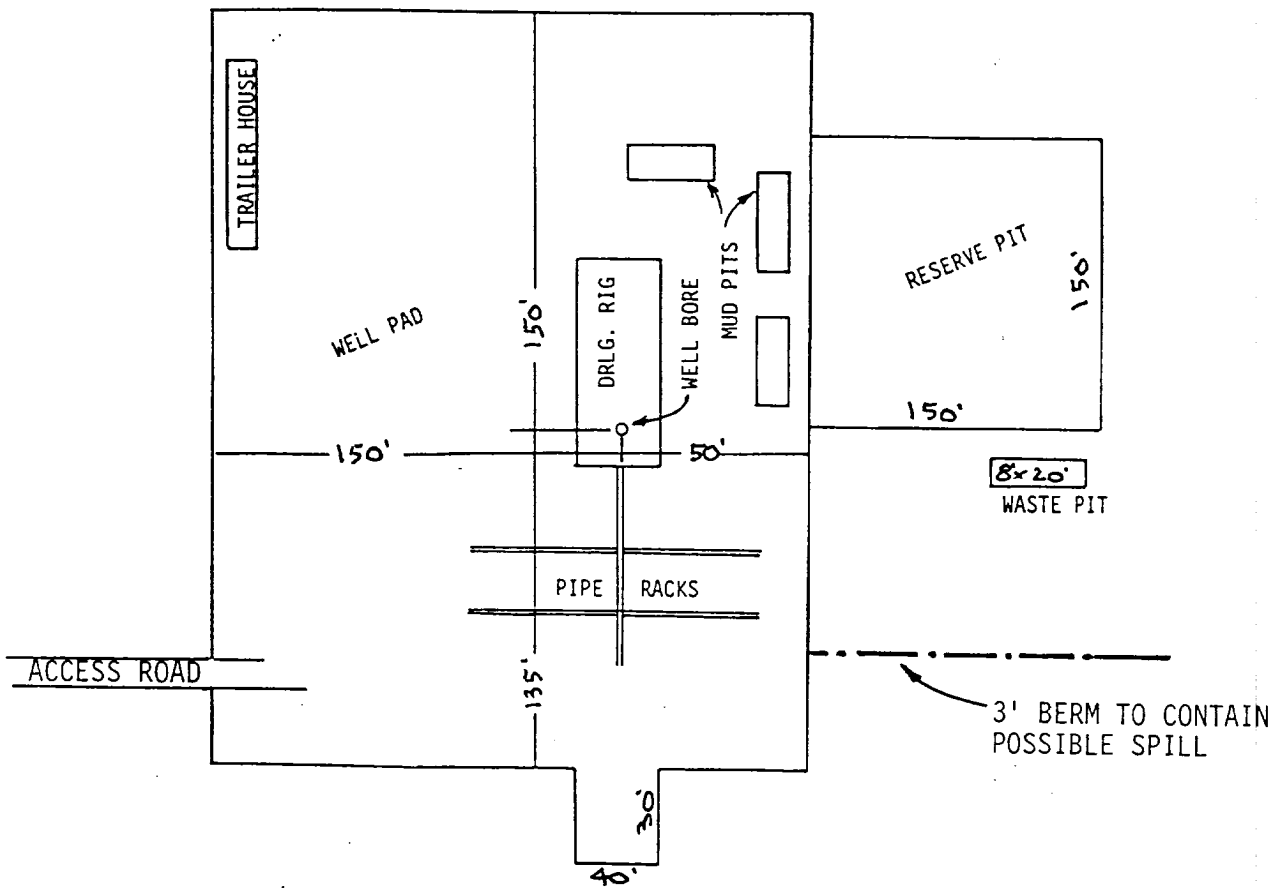

EXHIBIT "C"

POGO PRODUCING COMPANY
NEL LEASE WELL NO. 5
DRILLING RIG LAYOUT
SCALE: None

